

GAS-EXITS		
54A PHILLIPS 66	54B PHILLIPS 66 DELI MART	54B BP DIESEL
54B MARATHON	54A KROGER FUEL	53 MOTO MART

ATTRACTION— EXIT 54A		
THE PAVILION	UNIVERSITY MALL	SALINE CREEK
RENT ONE	SIU ARENA	

ATTRACTIONS - EXITS		
54B THE PAVILION	54B UNIVERSITY MALL	54B
54A SALINE CREEK	54B RENT ONE	54B SIU ARENA

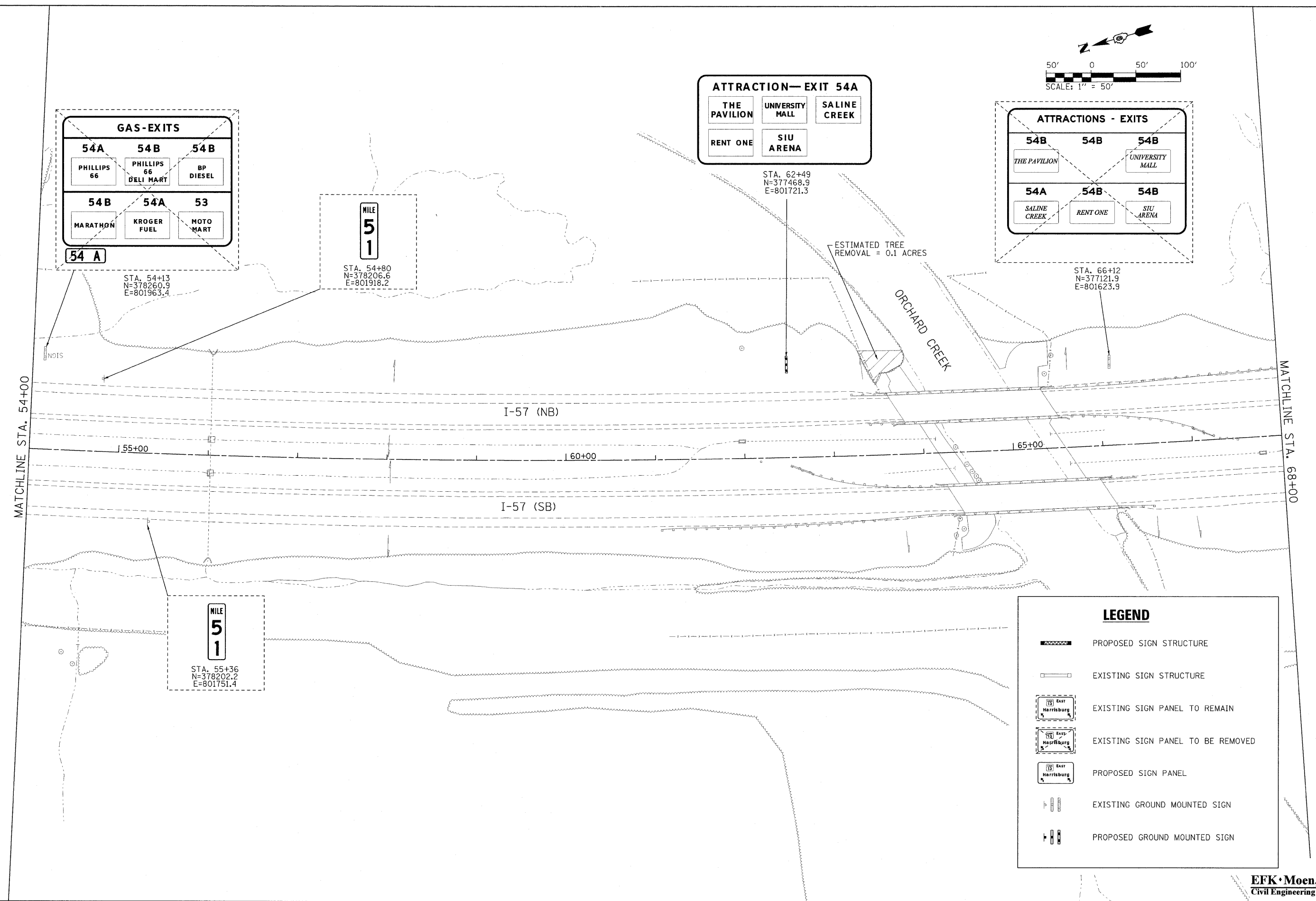

MATCHLINE STA. 54+00

MATCHLINE STA. 68+00

MILE
51
STA. 55+36
N=378202.2
E=801751.4

MILE
51
STA. 54+80
N=378206.6
E=801918.2

STA. 62+49
N=377468.9
E=801721.3

STA. 66+12
N=377121.9
E=801623.9

ESTIMATED TREE
REMOVAL = 0.1 ACRES

ORCHARD CREEK

LEGEND	
	PROPOSED SIGN STRUCTURE
	EXISTING SIGN STRUCTURE
	EXISTING SIGN PANEL TO REMAIN
	EXISTING SIGN PANEL TO BE REMOVED
	PROPOSED SIGN PANEL
	EXISTING GROUND MOUNTED SIGN
	PROPOSED GROUND MOUNTED SIGN

EFK•Moen, LLC
Civil Engineering Design

FILE NAME = ...D978182-sht-sign826-157.dgn	USER NAME = Brad Downen	DESIGNED - LE/JD	REVISED -	STATE OF ILLINOIS DEPARTMENT OF TRANSPORTATION	SIGN PLAN INTERSTATE 57	F.A. RTE.	SECTION	COUNTY	TOTAL SHEETS	SHEET NO.
		DRAWN - MK	REVISED -			•	(X1-6-2)HBK-2, HB-1,2; (IX-1)R-1	WILLIAMSON	968	438
		CHECKED - SD	REVISED -			•	F.A.I. 57 AND F.A.P. 331			CONTRACT NO. 78182
		DATE - 10/07/11	REVISED -							ILLINOIS FED. AID PROJECT
						SCALE: 1" = 50'	SHEET NO. 26 OF 43 SHEETS	STA. 54+00 TO STA. 68+00		