

Marion EXITS	
Main St	3
Illinois 13	3½
Morgan Avenue	3¾

STA. 128+85
N=370893.0
E=801257.9

LODGING-EXITS		
54A DAYS INN	53 HOLIDAY INN EXPRESS	54A GRAY PLAZA MOTEL
54B MOTEL 6	54B COUNTRY INN&SUITES	54B HAMPTON INN

STA. 133+55
N=370423.3
E=801257.2

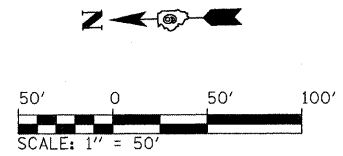

MATCHLINE STA. 126+00

MATCHLINE STA. 140+00

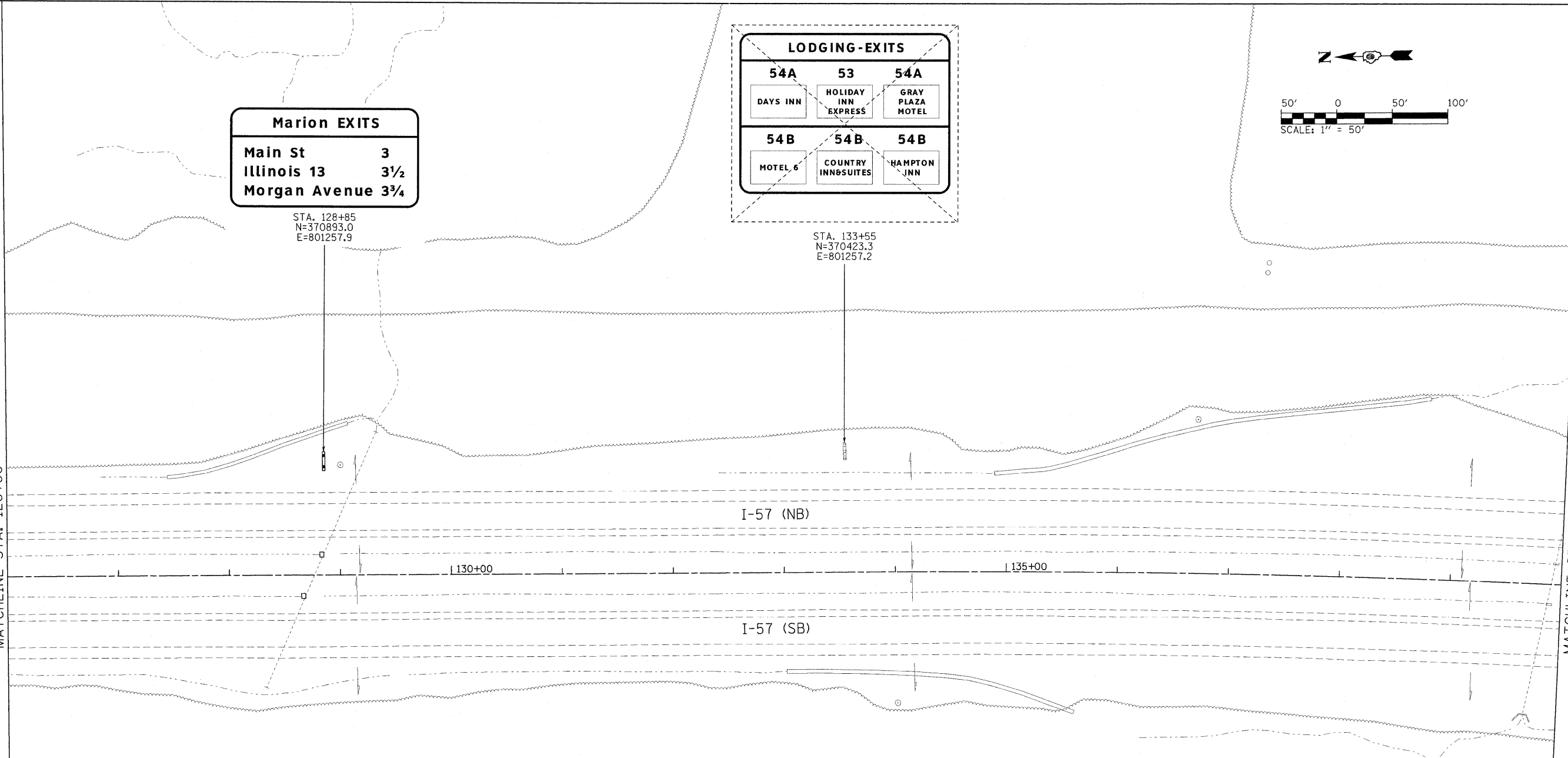

LEGEND	
	PROPOSED SIGN STRUCTURE
	EXISTING SIGN STRUCTURE
	EXISTING SIGN PANEL TO REMAIN
	EXISTING SIGN PANEL TO BE REMOVED
	PROPOSED SIGN PANEL
	EXISTING GROUND MOUNTED SIGN
	PROPOSED GROUND MOUNTED SIGN

EFK·Moen, LLC
Civil Engineering Design

FILE NAME = ...AD978182-sht-sign831-157.dgn	USER NAME = Brad Downen	DESIGNED - LE/JD	REVISED -	STATE OF ILLINOIS DEPARTMENT OF TRANSPORTATION	SIGN PLAN INTERSTATE 57	F.A. RTE.	SECTION	COUNTY	TOTAL SHEETS	SHEET NO.
		DRAWN - MK	REVISED -			* 01-6-21HBK-2, HB-1,2; 01X-1R-1	WILLIAMSON	968	443	
		CHECKED - SD	REVISED -			* F.A.I. 57 AND F.A.P. 331	CONTRACT NO. 78182			
		DATE - 10/07/11	REVISED -			ILLINOIS FED. AID PROJECT				
					SCALE: 1" = 50'	SHEET NO. 31 OF 43 SHEETS		STA. 126+00 TO STA. 140+00		