

DATE	
BY	
FINAL SURVEY	
SURVEYED	
PLOTTED	
NOTE BOOK	
AREAS CHECKED	
NO.	

DATE	
BY	
ORIGINAL SURVEY	
SURVEYED	
PLOTTED	
NOTE BOOK	
AREAS CHECKED	
NO.	

STA. 300+02, RT.
I-57
N=406023.8
E=807140.3

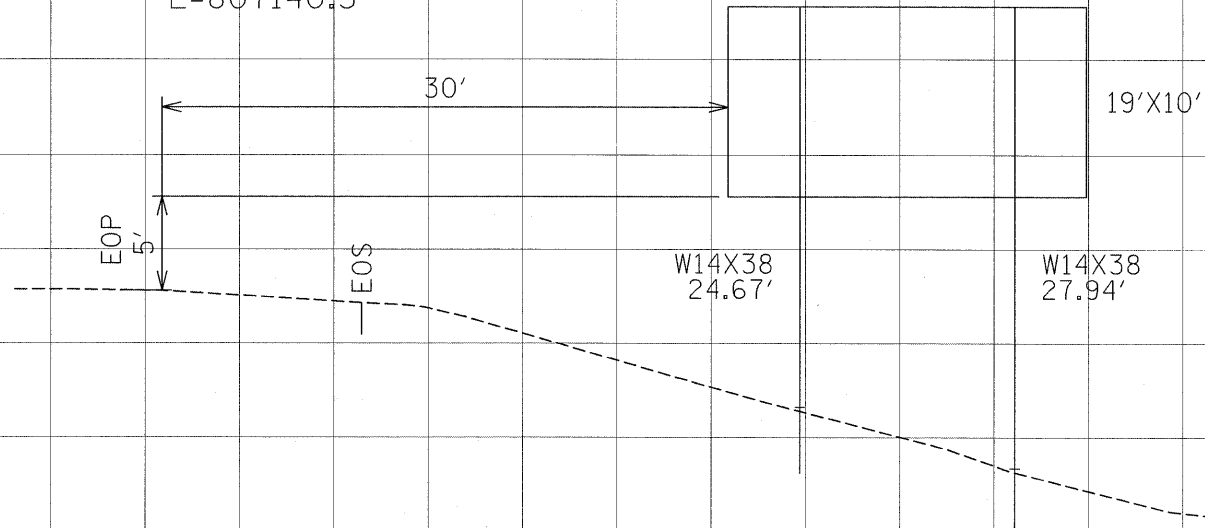

STA. 307+62, RT.
I-57
N=405263.7
E=807138.1

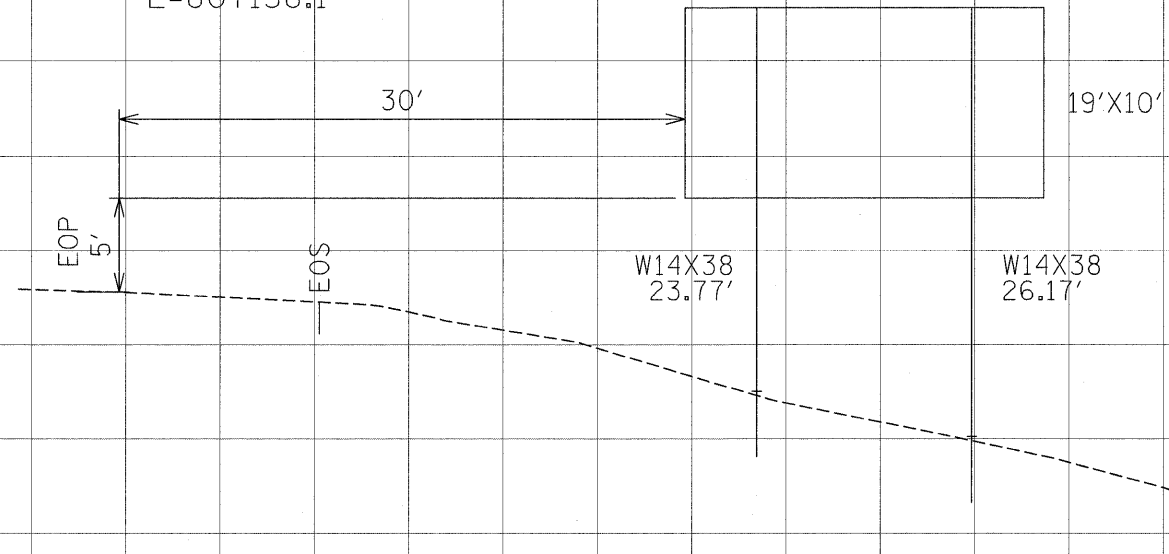

STA. 316+06, RT.
I-57
N=404424.4
E=807120.6

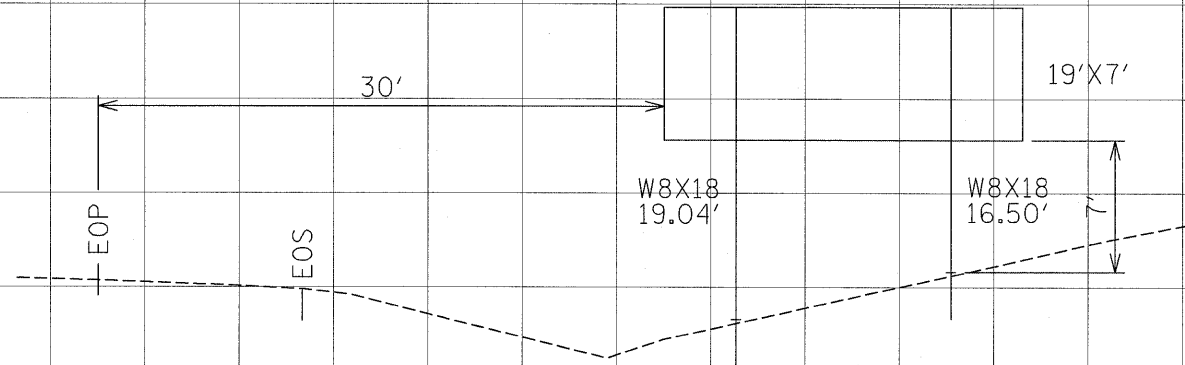

STA. 324+14, RT.
I-57
N=403626.4
E=807052.2

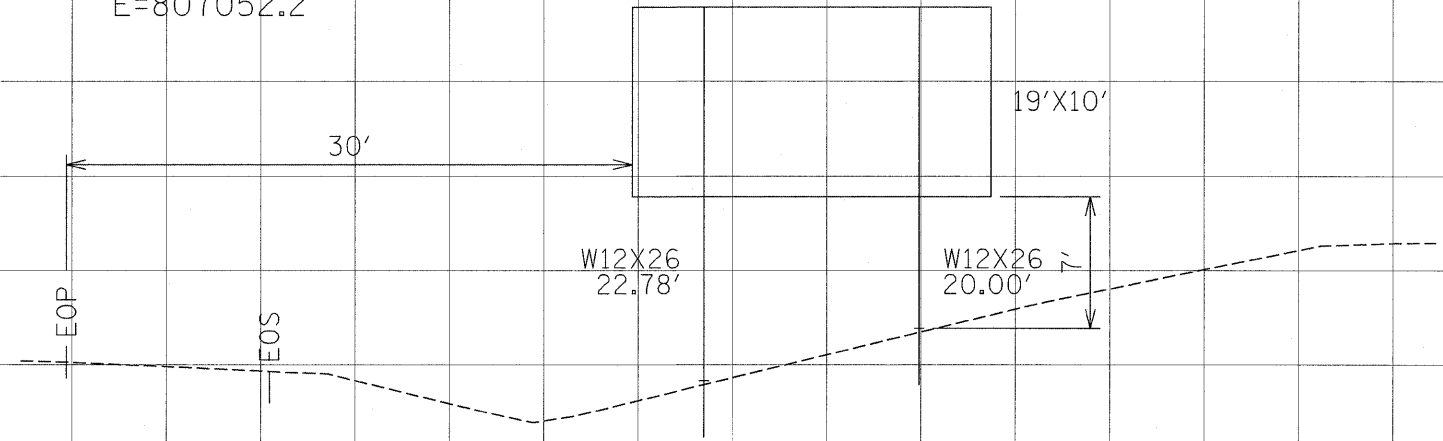

EFK Moen, LLC
Civil Engineering Design

FILE NAME = ...\\D978182-sht-sign108-122-Ground Mount Xsec.dgn

USER NAME = Brad Downen
PLOT SCALE = 5,0000' / IN.
PLOT DATE = 10/10/2011

DESIGNED - JD
DRAWN - MK
CHECKED - SD
DATE - 10/07/11

REVISED -
REVISED -
REVISED -
REVISED -

STATE OF ILLINOIS
DEPARTMENT OF TRANSPORTATION

GROUND MOUNT SIGN CROSS SECTIONS

SCALE: 1"V = 1'H SHEET NO. 2 OF 15 SHEETS STA. TO STA.

F.A. RTE.	SECTION	COUNTY	TOTAL SHEETS	SHEET NO.
•	0X1-6-2HKB-2,HB-1,2X1X-1R-1	WILLIAMSON	968	522
• F.A.I. 57 AND F.A.P. 331			CONTRACT NO. 78182	
ILLINOIS FED. AID PROJECT				