

Bench Mark: IDOT District 9 Survey Control Point for I-57, Point No. NDCP11. Aluminum Permanent Survey Marker (PSM) set in concrete cap stamped "CP11 1489+00", located in existing I-57 median north of existing bridges over new Route 13. 2.10' Right of the Existing I-57 CL at Sta. 1489+04.61
Elevation = 470.197

Existing Structures: None

STATION 9+96.56
BUILT 20__ BY
STATE OF ILLINOIS
F.A.I. RTE. 57 SEC. (XI-6-2)HB-2
LOADING HL-93
STRUCTURE NO. 100-0098

NAME PLATE
See Std. 515001

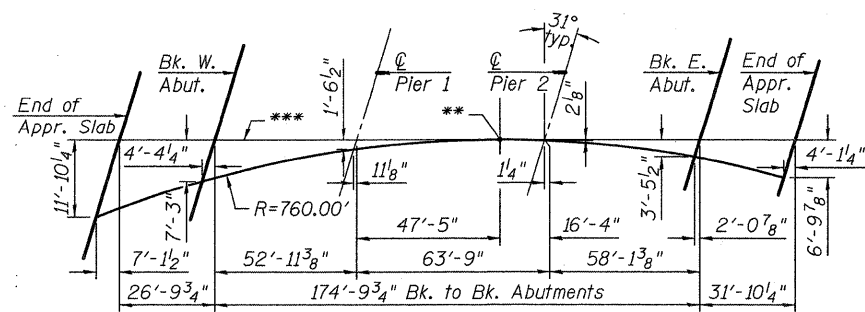

OFFSET SKETCH

** @ Ramp J Sta. 9+96.56 =
@ Ramp A Sta. 19+28.55
*** Local Tangent @ Sta. 9+96.56

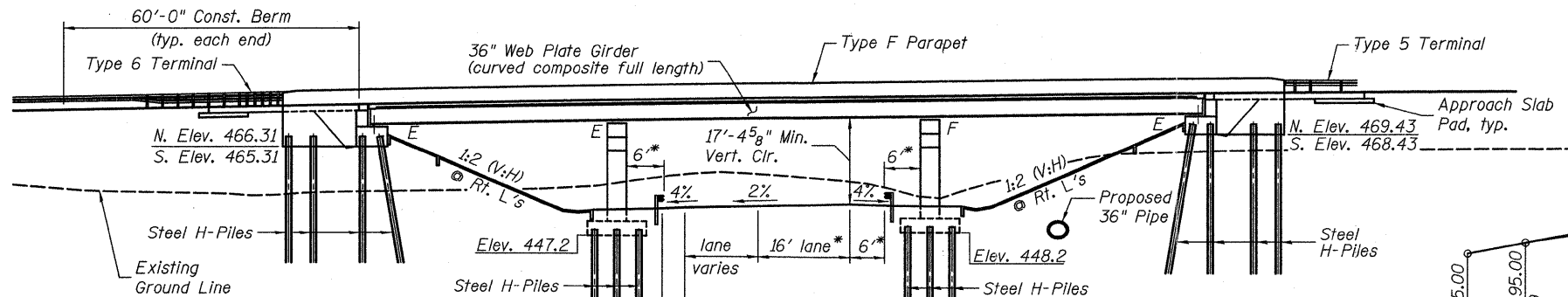

ELEVATION

* Measured at Rt. L's.

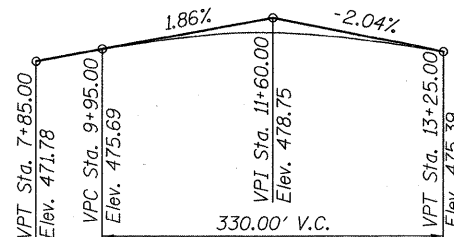

PROFILE GRADE
(Ramp J)

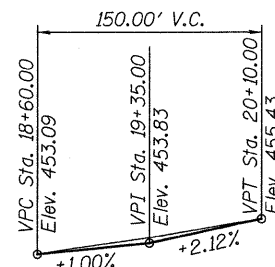

PROFILE GRADE
(Ramp A)

Legend:

Exst. Underground Electric Line

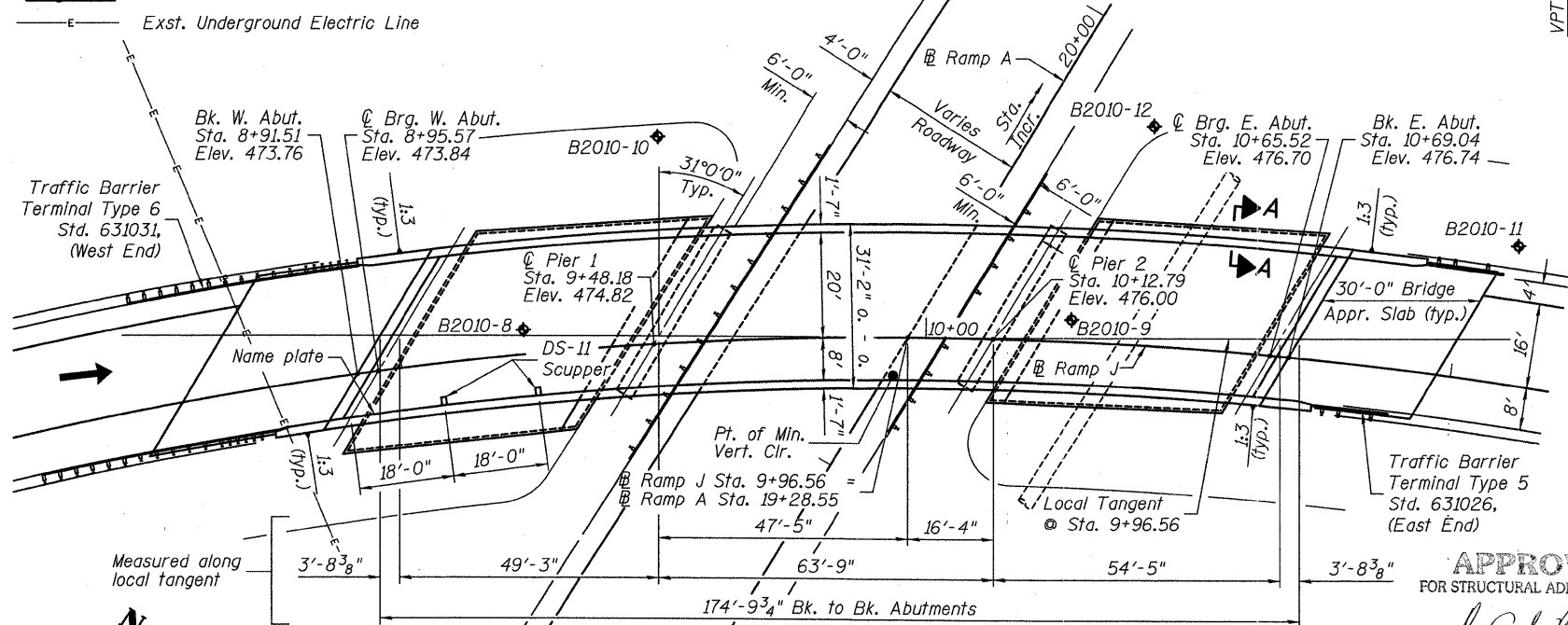

PLAN

TOTAL BILL OF MATERIAL

ITEM	UNIT	SUPER	SUB	TOTAL
Porous Granular Embankment, Special	Cu. Yd.		95	95
Structure Excavation	Cu. Yd.		338	338
Concrete Structures	Cu. Yd.		302.1	302.1
Concrete Superstructure	Cu. Yd.	278.4		278.4
Bridge Deck Grooving	Sq. Yd.	682		682
Concrete Encasement	Cu. Yd.		7.7	7.7
Protective Coat	Sq. Yd.	907		907
Furnishing and Erecting Structural Steel	L. Sum	0.04		0.04
Stud Shear Connectors	Each	3600		3600
Reinforcement Bars, Epoxy Coated	Pound	66220	59540	125760
Bar Splicers	Each		67	67
Slopedwall 4 inch	Sq. Yd.		428	428
Furnishing Steel Piles HP12x53	Foot		1230	1230
Driving Piles	Foot		1230	1230
Test Pile Steel HP12x53	Each		4	4
Pile Shoes	Each		48	48
Name Plates	Each	1		1
Preformed Joint Strip Seal	Foot	71		71
Elastomeric Bearing Assembly, Type I	Each	10		10
Elastomeric Bearing Assembly, Type II	Each	5		5
Anchor Bolts, 5/8"	Each	10		10
Anchor Bolts, 1"	Each	30		30
Concrete Sealer	Sq. Ft.		2807	2807
Geocomposite Wall Drain	Sq. Yd.		53	53
Pipe Underdrains for Structures 4"	Foot		116	116
Drainage Scuppers, DS-11	Each	2		2
Mechanical Splicers	Each		362	362

APPROVED
FOR STRUCTURAL ADEQUACY ONLY
Chris Lineman
ENGINEER OF BRIDGES AND STRUCTURES



DESIGN SPECIFICATIONS

2010 AASHTO LRFD
Bridge Design Specifications
with 2010 Interims
LOADING HL-93
Allow 50#/sq. ft. for
future wearing surface.

DESIGN STRESSES
FIELD UNITS

f'c = 3,500 psi
fy = 60,000 psi (Reinforcement)
fy = 50,000 psi (M270 Grade 50)

CURVE DATA

(Ramp J)
Δ = 53°16'45" (RT)
D = 7°32'20"
T = 381.24'
L = 706.72'
E = 90.26'
R = 760.00'
S.E. = 8.0%
P.C. = Sta. 4+54.82
P.T. = Sta. 11+61.54
P.I. = Sta. 8+36.06

Signed: *CS*
Date: 9/28/2011
License Expires: 11/30/2012

SEISMIC DATA

Seismic Performance Zone (SPZ) = 2
Design Spectral Acceleration at 1.0 sec.
(SD1) = 0.277g
Design Spectral Acceleration at 0.2 sec.
(SDS) = 0.759g
Soil Site Class = C

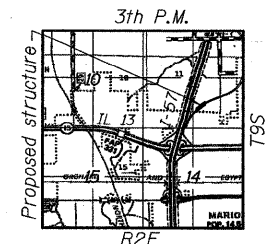

LOCATION SKETCH

GENERAL PLAN & ELEVATION
FAI 57 RAMP J OVER RAMP A
SECTION (XI-6-2)HB-2
WILLIAMSON COUNTY
STA. 9+96.56
STRUCTURE NO. 100-0098

EFK Moen, LLC
Civil Engineering Design
331 Salem Place, Suite 225
Fairview Heights, IL 62208
Phone 618-206-4250

FILE NAME = 1000098-78182-001-GPE.dgn
PLOT SCALE = 1/4" = 1'-0"
PLOT DATE = 9/28/2011

DESIGNED - CTW
CHECKED - CDL
DRAWN - DP
DATE - 9/28/2011

REVISIONS
REVISIONS
REVISIONS
REVISIONS

STATE OF ILLINOIS
DEPARTMENT OF TRANSPORTATION

GENERAL PLAN & ELEVATION
STRUCTURE NO. 100-0098

SHEET NO. 1 OF 33 SHEETS

F.A.I. RTE.	SECTION	COUNTY	TOTAL SHEETS	SHEET NO.
57	(XI-6-2)HB-2	WILLIAMSON	968	684
CONTRACT NO. 78182				
ILLINOIS FED. AID PROJECT				