

**DEAD LOAD DEFLECTION DIAGRAM**

(Includes weight of concrete only.)

\* See sheet 14 of 33 for span dimensions.  
The above deflections are not to be used in the field if the engineer is working from the grade elevations adjusted for dead load deflections as shown below.

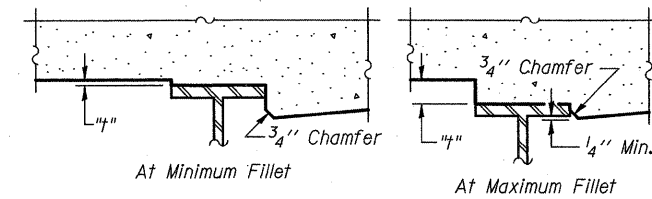

To determine "t": After all structural steel has been erected, elevations of the top flanges of the beams shall be taken at intervals shown below. These elevations subtracted from the "Theoretical Grade Elevations Adjusted For Dead Load Deflection" shown below, minus slab thickness, equals the fillet heights "t" above top flange of beams.

**FILLET HEIGHTS**

**BEAM 1**

Location	Station	Offset	Theoretical Grade Elevations	Theoretical Grade Elevations Adjusted For Dead Load Deflection
Bk. West Abut.	9+06.11	-18.67	475.53	475.53
☉ Brg West Abut.	9+10.01	-18.67	475.60	475.60
A	9+19.77	-18.67	475.78	475.80
B	9+29.53	-18.67	475.96	475.98
C	9+39.29	-18.67	476.14	476.16
D	9+49.05	-18.67	476.33	476.33
☉ Pier 1	9+60.70	-18.67	476.54	476.54
E	9+70.46	-18.67	476.72	476.73
F	9+80.23	-18.67	476.90	476.92
G	9+89.99	-18.67	477.09	477.11
H	9+99.75	-18.67	477.27	477.29
I	10+09.51	-18.67	477.44	477.45
☉ Pier 2	10+23.17	-18.67	477.66	477.66
J	10+32.93	-18.67	477.80	477.81
K	10+42.69	-18.67	477.93	477.95
L	10+52.45	-18.67	478.05	478.08
M	10+62.21	-18.67	478.16	478.18
☉ Brg East Abut.	10+74.31	-18.67	478.28	478.28
Bk. East Abut.	10+77.72	-18.67	478.31	478.31

**BEAM 2**

Location	Station	Offset	Theoretical Grade Elevations	Theoretical Grade Elevations Adjusted For Dead Load Deflection
Bk. West Abut.	9+01.26	-12.33	474.93	474.93
☉ Brg West Abut.	9+05.21	-12.33	475.00	475.00
A	9+15.05	-12.33	475.19	475.20
B	9+24.89	-12.33	475.37	475.39
C	9+34.73	-12.33	475.55	475.57
D	9+44.57	-12.33	475.74	475.74
☉ Pier 1	9+56.54	-12.33	475.96	475.96
E	9+66.38	-12.33	476.14	476.15
F	9+76.22	-12.33	476.32	476.34
G	9+86.06	-12.33	476.51	476.53
H	9+95.90	-12.33	476.69	476.71
I	10+05.74	-12.33	476.87	476.88
☉ Pier 2	10+19.72	-12.33	477.10	477.10
J	10+29.56	-12.33	477.24	477.25
K	10+39.40	-12.33	477.38	477.40
L	10+49.24	-12.33	477.51	477.53
M	10+59.08	-12.33	477.62	477.64
☉ Brg East Abut.	10+71.38	-12.33	477.75	477.75
Bk. East Abut.	10+74.83	-12.33	477.78	477.78

**BEAM 3 & ☉ ROADWAY**

Location	Station	Offset	Theoretical Grade Elevations	Theoretical Grade Elevations Adjusted For Dead Load Deflection
Bk. West Abut.	8+96.30	-6.00	474.33	474.33
☉ Brg West Abut.	9+00.31	-6.00	474.41	474.41
A	9+10.23	-6.00	474.59	474.60
B	9+20.15	-6.00	474.78	474.80
C	9+30.08	-6.00	474.96	474.98
D	9+40.00	-6.00	475.14	475.15
☉ Pier 1	9+52.29	-6.00	475.37	475.37
E	9+62.21	-6.00	475.56	475.56
F	9+72.13	-6.00	475.74	475.76
G	9+82.06	-6.00	475.93	475.95
H	9+91.98	-6.00	476.11	476.13
I	10+01.90	-6.00	476.29	476.30
☉ Pier 2	10+16.19	-6.00	476.53	476.53
J	10+26.11	-6.00	476.69	476.69
K	10+36.03	-6.00	476.83	476.85
L	10+45.96	-6.00	476.96	476.98
M	10+55.88	-6.00	477.08	477.10
☉ Brg East Abut.	10+68.40	-6.00	477.21	477.21
Bk. East Abut.	10+71.88	-6.00	477.24	477.24

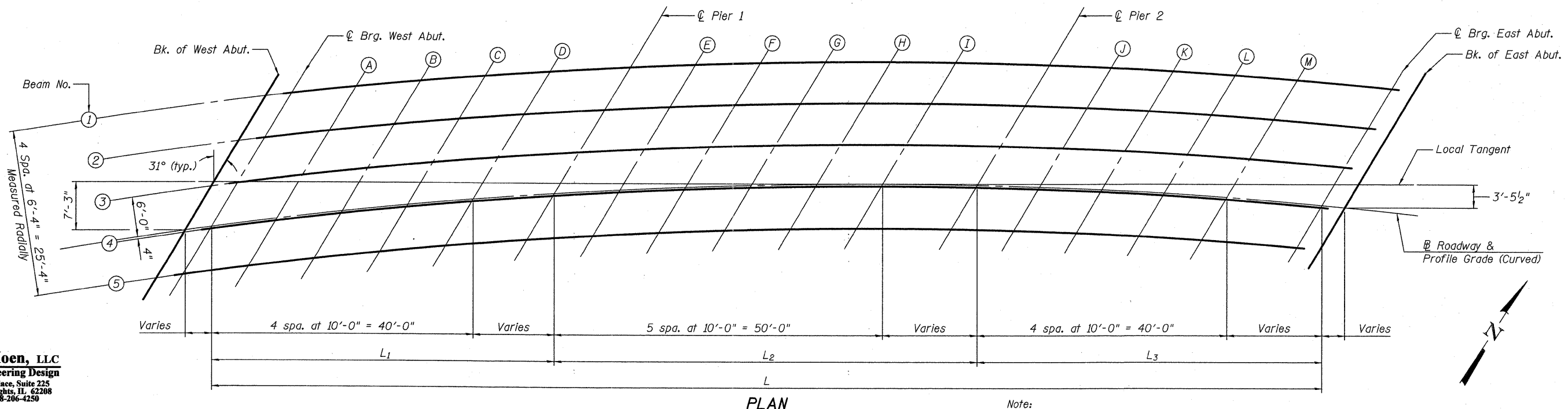

**PLAN**

Note: For dimension L<sub>1</sub>, L<sub>2</sub>, L<sub>3</sub> and L, see Sheet 14 of 33.

**EFK Moen, LLC**  
Civil Engineering Design  
331 Salem Place, Suite 225  
Fairview Heights, IL 62208  
Phone 618-206-4250

FILE NAME = 1000098-78182-004-TOSL.Elev.dgn	USER NAME = jo	DESIGNED - CTW	REVISD -	<b>STATE OF ILLINOIS DEPARTMENT OF TRANSPORTATION</b>	<b>TOP OF SLAB ELEVATIONS STRUCTURE NO. 100-0098</b>	F.A.T. RTE. 57	SECTION (X1-6-2)HB-2	COUNTY WILLIAMSON	TOTAL SHEETS 968	SHEET NO. 687	
PLOT SCALE = 0.1/0.0000 '1' / IN.	DRAWN - DP	CHECKED - CDL	REVISD -			CONTRACT NO. 78182					
PLOT DATE = 9/7/2011	DATE - 9/7/2011	DRAWN - DP	REVISD -			ILLINOIS FED. AID PROJECT					
SHEET NO. 4 OF 33 SHEETS											