

SECTION A-A

BEAM DIMENSION (feet)

| Beam | Radius | A <sub>1</sub> | A <sub>2</sub> | B <sub>1</sub> | B <sub>2</sub> | B <sub>3</sub> | C <sub>1</sub> | C <sub>2</sub> | L <sub>1</sub> | L <sub>2</sub> | L <sub>3</sub> | L      |
|------|--------|----------------|----------------|----------------|----------------|----------------|----------------|----------------|----------------|----------------|----------------|--------|
| 1    | 778.67 | 40.51          | 11.43          | 11.84          | 39.96          | 12.20          | 12.06          | 40.33          | 51.94          | 64.00          | 52.39          | 168.33 |
| 2    | 772.33 | 40.97          | 11.19          | 11.87          | 40.18          | 12.15          | 12.07          | 40.43          | 52.16          | 64.21          | 52.51          | 168.88 |
| 3    | 766.00 | 41.17          | 11.23          | 11.90          | 40.33          | 12.18          | 12.09          | 40.53          | 52.39          | 64.41          | 52.62          | 169.42 |
| 4    | 759.67 | 41.36          | 11.27          | 11.92          | 40.48          | 12.21          | 12.10          | 40.64          | 52.63          | 64.62          | 52.74          | 169.99 |
| 5    | 753.33 | 41.57          | 11.31          | 11.83          | 40.76          | 12.25          | 12.28          | 40.59          | 52.88          | 64.84          | 52.87          | 170.58 |

Note:  
 See sheet 16 of 33 for tables detailing layout dimensions, diaphragm spacing and shear stud spacing for each beam.  
 See sheet 15 of 33 for additional steel details.  
 All diaphragms between beams shall be installed with erection pins and bolts in accordance with the erection plan approved by the Engineer. Individual diaphragms at supports may be temporarily disconnected to install bearing anchor rods.  
 Load carrying components designated "NTR" shall conform to the Supplemental Requirements for Notch Toughness, Zone 2.

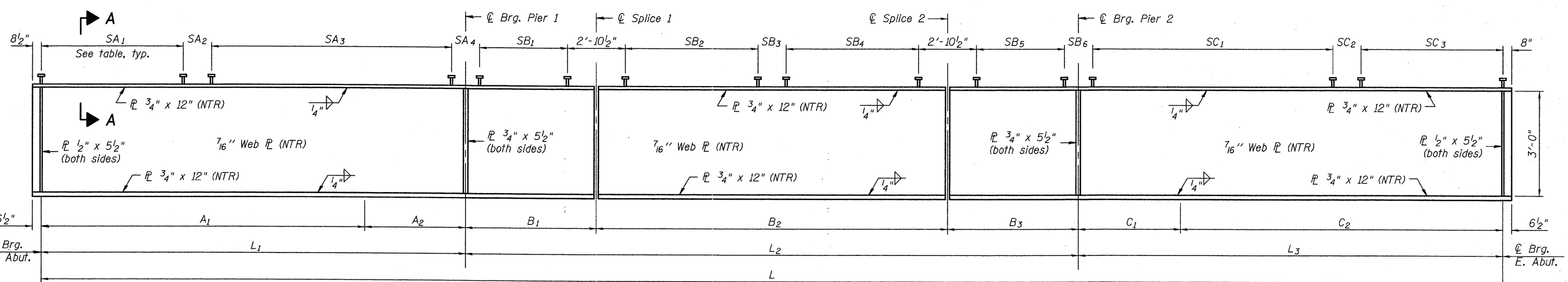

GIRDER ELEVATION

"NTR" denotes plates to which notch toughness requirements are applicable.

**EFK Moen, LLC**  
 Civil Engineering Design  
 331 Salem Place, Suite 225  
 Fairview Heights, IL 62208  
 Phone 618-206-4250

PRINT DATE: 9/7/2011 2:18:45 PM z:\100098-78182-014-Stl-Framing.dgn  
 z:\100098-78182-014-Stl-Framing.dgn  
 z:\100098-78182-014-Stl-Framing.dgn  
 z:\100098-78182-014-Stl-Framing.dgn

|  |                 |                |                           |   |  |                    |                      |                   |                  |               |
|--|-----------------|----------------|---------------------------|---|--|--------------------|----------------------|-------------------|------------------|---------------|
| FILE NAME = 100098-78182-014-Stl-Framing.dgn | USER NAME = jo  | DESIGNED - CTW | REVISD -                  | <b>STATE OF ILLINOIS<br/>DEPARTMENT OF TRANSPORTATION</b> | <b>STRUCTURAL STEEL<br/>STRUCTURE NO. 100-0098</b> | F.A.I. RTE. 57     | SECTION (X1-6-2)HB-2 | COUNTY WILLIAMSON | TOTAL SHEETS 968 | SHEET NO. 697 |
| PLOT SCALE = 0.1" = 1' IN.                   | CHECKED - CDL   | REVISD -       | SHEET NO. 14 OF 33 SHEETS |   |  | CONTRACT NO. 78182 |                      |                   |                  |               |
| PLOT DATE = 9/7/2011                         | DRAWN - DP      | REVISD -       | ILLINOIS FED. AID PROJECT |   |  |                    |                      |                   |                  |               |
|  | DATE - 9/7/2011 | REVISD -       |                           |   |  |                    |                      |                   |                  |               |