

FINAL SURVEY	SURVEYED	BY	DATE
NOTE BOOK	PLOTTED		
NO.	TEMPLATE		
	AREAS CHECKED		

ORIGINAL SURVEY	SURVEYED	BY	DATE
NOTE BOOK	PLOTTED		
NO.	TEMPLATE		
	AREAS CHECKED		

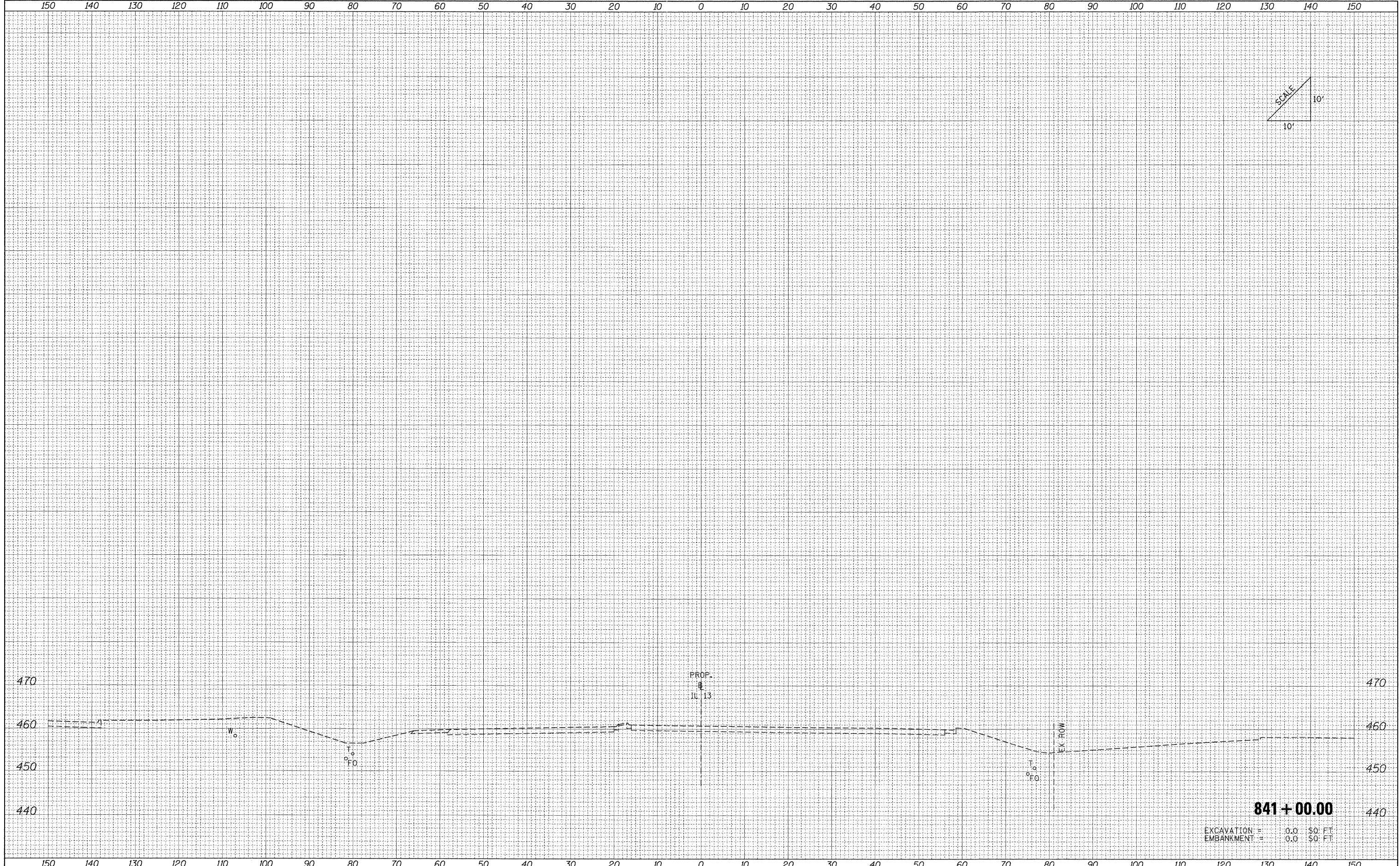
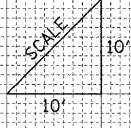

FILE NAME = ...D978182-sh1-XCS_IL13.dgn

USER NAME = Rob Heady	DESIGNED - MJO	REVISED -
	DRAWN - MJO	REVISED -
PLOT SCALE = 10.0000 / IN.	CHECKED - BJD	REVISED -
PLOT DATE = 10/10/2011	DATE - 10/07/11	REVISED -

**STATE OF ILLINOIS
DEPARTMENT OF TRANSPORTATION**

CROSS SECTIONS: F.A.P 331 (IL 13)

SCALE: SHEET NO. OF SHEETS STA. 841+00.00 TO STA. 841+00.00

F.A. RTE.	SECTION	COUNTY	TOTAL SHEETS	SHEET NO.
•	(X1-6-2)HBK-2, HB-1.2; (1X-1R-1	WILLIAMSON	968	875
•	F.A.I. 57 AND F.A.P. 331			CONTRACT NO. 78182
FED. ROAD DIST. NO.		ILLINOIS FED. AID PROJECT		