

DATE	
BY	
FINAL SURVEY	
SURVEYED	
PLOTTED	
NOTE BOOK	
REVISIONS	
AREAS CHECKED	
NO.	

DATE	
BY	
ORIGINAL SURVEY	
SURVEYED	
PLOTTED	
NOTE BOOK	
REVISIONS	
AREAS CHECKED	
NO.	

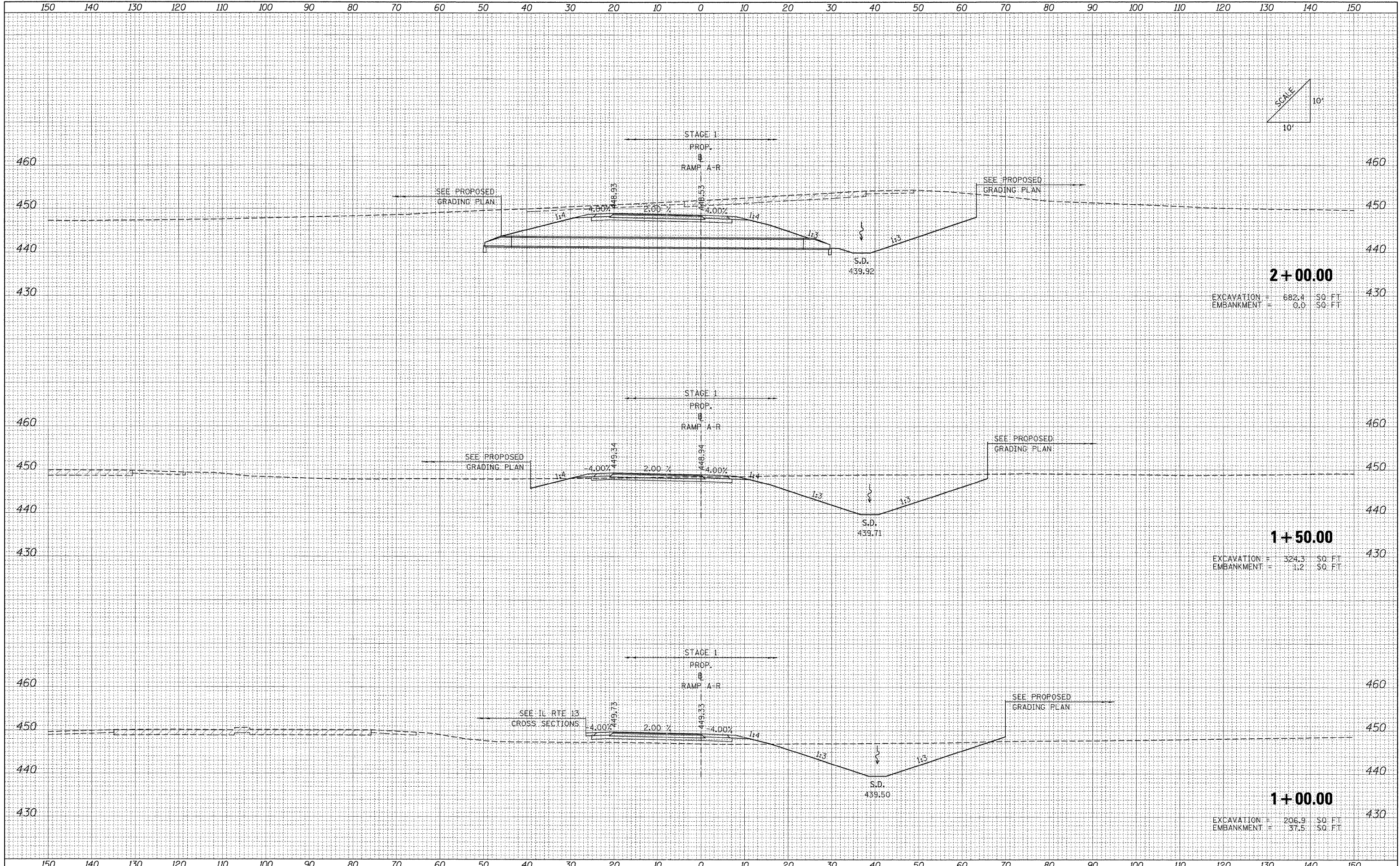

2+00.00
 EXCAVATION = 682.4 SQ. FT.
 EMBANKMENT = 0.0 SQ. FT.

1+50.00
 EXCAVATION = 324.3 SQ. FT.
 EMBANKMENT = 1.2 SQ. FT.

1+00.00
 EXCAVATION = 206.9 SQ. FT.
 EMBANKMENT = 37.5 SQ. FT.

FILE NAME = ...D978182-sh1-XCS_RAMP1.dgn	USER NAME = Rob Heady	DESIGNED - MJO	REVISED -	STATE OF ILLINOIS DEPARTMENT OF TRANSPORTATION	CROSS SECTIONS: RAMP A-R	F.A. RTE.	SECTION	COUNTY	TOTAL SHEETS	SHEET NO.
PLOT SCALE = 10.0000' / IN.	DRAWN - MJO	REVISIONS -	• 0X1-6-2HKB-2, HB-1,2; 0X-1R-1			WILLIAMSON	968	888		
PLOT DATE = 10/10/2011	CHECKED - BJD	REVISIONS -	• F.A.I. 57 AND F.A.P. 331			CONTRACT NO. 78182				
	DATE - 10/07/11	REVISIONS -	FED. ROAD DIST. NO.			ILLINOIS FED. AID PROJECT				