

STATE OF ILLINOIS  
DEPARTMENT OF TRANSPORTATION  
DIVISION OF HIGHWAYS

PLANS FOR PROPOSED  
FEDERAL AID HIGHWAY

F.A.U. 5952 (US 6)  
EDGEWATER DR. TO LAKEWOOD DR.  
CITY OF MORRIS  
SECTION 10-00083-00-TL  
PROJECT M-5047(010)  
GRUNDY COUNTY  
C-93-083-11

F.A.U. RTE.	SECTION	COUNTY	TOTAL SHEETS	SHEET NO.
5952	10-00083-00-TL	GRUNDY	70	1
FED. ROAD DIST. NO.	ILLINOIS	CONTRACT NO. 87486		

71 (2)

INDEX OF SHEETS

- 1. COVER SHEET
- 2. GENERAL NOTES AND TRAFFIC CONTROL
- 3.-3A. TYPICAL SECTIONS
- 4.-5. SUMMARY OF QUANTITIES
- 6.-7. SCHEDULE OF QUANTITIES
- 8.-12. REMOVAL PLANS
- 13.-18. PLAN AND PROFILE (US 6)
- 19.-21. PLAN AND PROFILE (SIDE STREETS)
- 22.-30. PAVEMENT MARKING AND SIGN PLANS
- 31.-36. TRAFFIC SIGNAL PLANS
- 37. INTERSECTION DETAILS
- 38.-43. DETAILS
- 44.-61. CROSS SECTIONS (US 6)
- 62.-70. CROSS SECTIONS (SIDE STREETS)

HIGHWAY STANDARDS

- 000001-06 STANDARD SYMBOLS, ABBREVIATIONS AND PATTERNS
- 280001-06 TEMPORARY EROSION CONTROL SYSTEMS
- 424001-06 PERPENDICULAR CURB RAMPS FOR SIDEWALKS
- 424011 CORNER PARALLEL CURB RAMPS FOR SIDEWALKS
- 482001-02 HMA SHOULDER ADJACENT TO FLEXIBLE PAVEMENT
- 482011-03 HMA SHOULDER STRIPS/SHOULDERS WITH RESURFACING OR WIDENING AND RESURFACING PROJECTS
- 542301-03 PRECAST REINFORCED CONCRETE FLARED END SECTION
- 542306-02 PRECAST REINFORCED CONCRETE ELLIPTICAL FLARED END SECTION
- 542401-01 METAL END SECTION FOR PIPE CULVERTS
- 542406-01 METAL END SECTION FOR PIPE ARCHES
- 602301-03 INLET, TYPE A
- 602401-03 MANHOLE, TYPE A
- 602601-02 PRECAST REINFORCED CONCRETE FLAT SLAB TOP
- 602701-02 MANHOLE STEPS
- 604001-03 FRAME AND LIDS, TYPE 1
- 604036-02 GRATE, TYPE 8
- 606001-04 CONCRETE CURB TYPE B AND COMBINATION CONCRETE CURB AND GUTTER
- 701001-02 OFF-ROAD OPERATIONS, 2L, 2W, MORE THAN 15' (4.5 M) AWAY
- 701006-03 OFF-ROAD OPERATIONS, 2L, 2W, 15' (4.5 M) TO 24" (600 MM) FROM PAVEMENT EDGE
- 701011-02 OFF-ROAD MOVING OPERATIONS, 2L, 2W, DAY ONLY
- 701201-04 LANE CLOSURE, 2L, 2W, DAY ONLY, FOR SPEEDS > 45 MPH
- 701301-04 LANE CLOSURE, 2L, 2W, SHORT TIME OPERATIONS
- 701306-03 LANE CLOSURE, 2L, 2W, SLOW MOVING OPERATIONS DAY ONLY, FOR SPEEDS > 45 MPH
- 701311-03 LANE CLOSURE, 2L, 2W, MOVING OPERATIONS - DAY ONLY
- 701326-04 LANE CLOSURE, 2L, 2W, PAVEMENT WIDENING, FOR SPEEDS > 45 MPH
- 701501-06 URBAN LANE CLOSURE, 2L, 2W, UNDIVIDED
- 701502-04 URBAN LANE CLOSURE, 2L, 2W, WITH BIDIRECTIONAL LEFT TURN LANE
- 701901-02 TRAFFIC CONTROL DEVICES
- 720001-01 SIGN PANEL MOUNTING DETAILS
- 720006-02 SIGN PANEL ERECTION DETAILS
- 720016-03 MAST ARM MOUNTED STREET NAME SIGNS
- 780001-03 TYPICAL PAVEMENT MARKINGS
- 781001-03 TYPICAL APPLICATIONS RAISED REFLECTIVE PAVEMENT MARKERS
- 805001-01 ELECTRICAL SERVICE INSTALLATION DETAILS
- 814001-02 HANDHOLES
- 814006-02 DOUBLE HANDHOLES
- 857001-01 STANDARD PHASE DESIGNATION DIAGRAMS AND PHASE SEQUENCES
- 862001-01 UNINTERRUPTIBLE POWER SUPPLY (UPS)
- 873001-02 TRAFFIC SIGNAL GROUNDING & BONDING
- 877001-05 STEEL MAST ARM ASSEMBLY AND POLE 16' THROUGH 55'
- 877011-05 STEEL COMBINATION MAST ARM ASSEMBLY AND POLE 16' THROUGH 55'
- 877012-02 STEEL COMBINATION MAST ARM ASSEMBLY AND POLE 56' THROUGH 75'
- 878001-09 CONCRETE FOUNDATION DETAILS
- 880001-04 SPAN WIRE MOUNTED SIGNALS AND FLASHING BEACON INSTALLATION
- 880006-01 TRAFFIC SIGNAL MOUNTING DETAILS
- 886001-01 DETECTOR LOOP INSTALLATIONS
- 886006-01 TYPICAL LAYOUT FOR DETECTION LOOPS

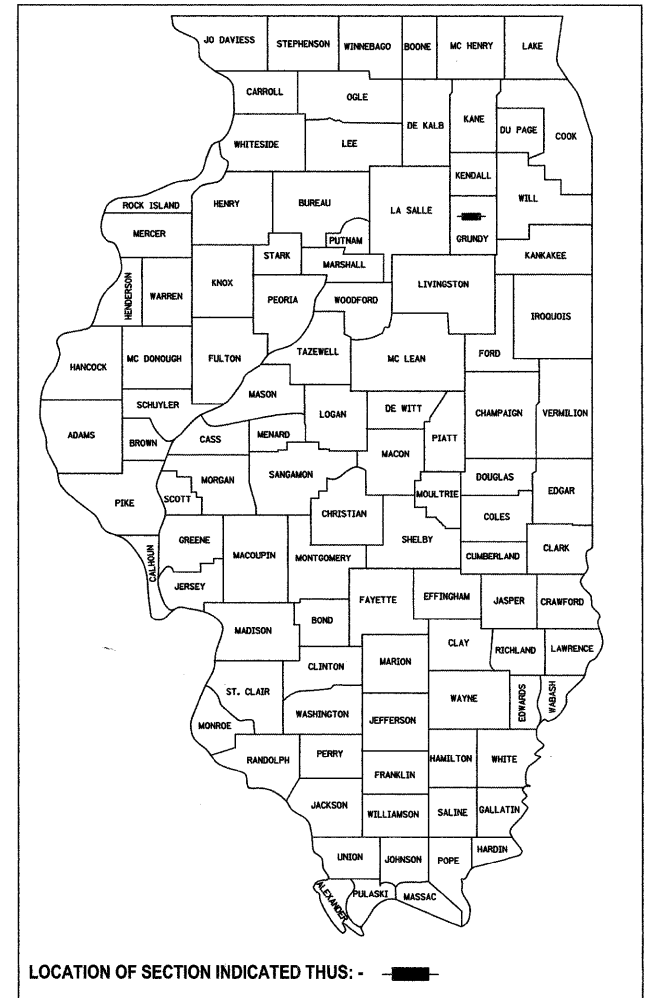

LOCATION OF SECTION INDICATED THUS: - ■ -

FAU 5952 (US 6)  
FUNCTION CLASSIFICATION: MINOR ARTERIAL  
ADT= 10400 (2011)  
POSTED SPEED 45 MPH

EDGEWATER DRIVE  
FUNCTION CLASSIFICATION: LOCAL ROAD  
ADT= 3230 (2011)  
POSTED SPEED 25 MPH

LAKEWOOD DRIVE  
FUNCTION CLASSIFICATION: LOCAL ROAD  
ADT= 1730 (2011)  
POSTED SPEED 25 MPH

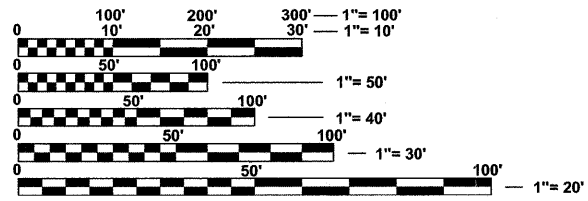

FULL SIZE PLANS HAVE BEEN PREPARED USING STANDARD ENGINEERING SCALES. REDUCED SIZED PLANS WILL NOT CONFORM TO STANDARD SCALES. IN MAKING MEASUREMENTS ON REDUCED PLANS, THE ABOVE SCALES MAY BE USED.

J.U.L.I.E.  
JOINT UTILITY LOCATION INFORMATION FOR EXCAVATION  
1-800-892-0123  
OR 811

CONTRACT NO. 87486

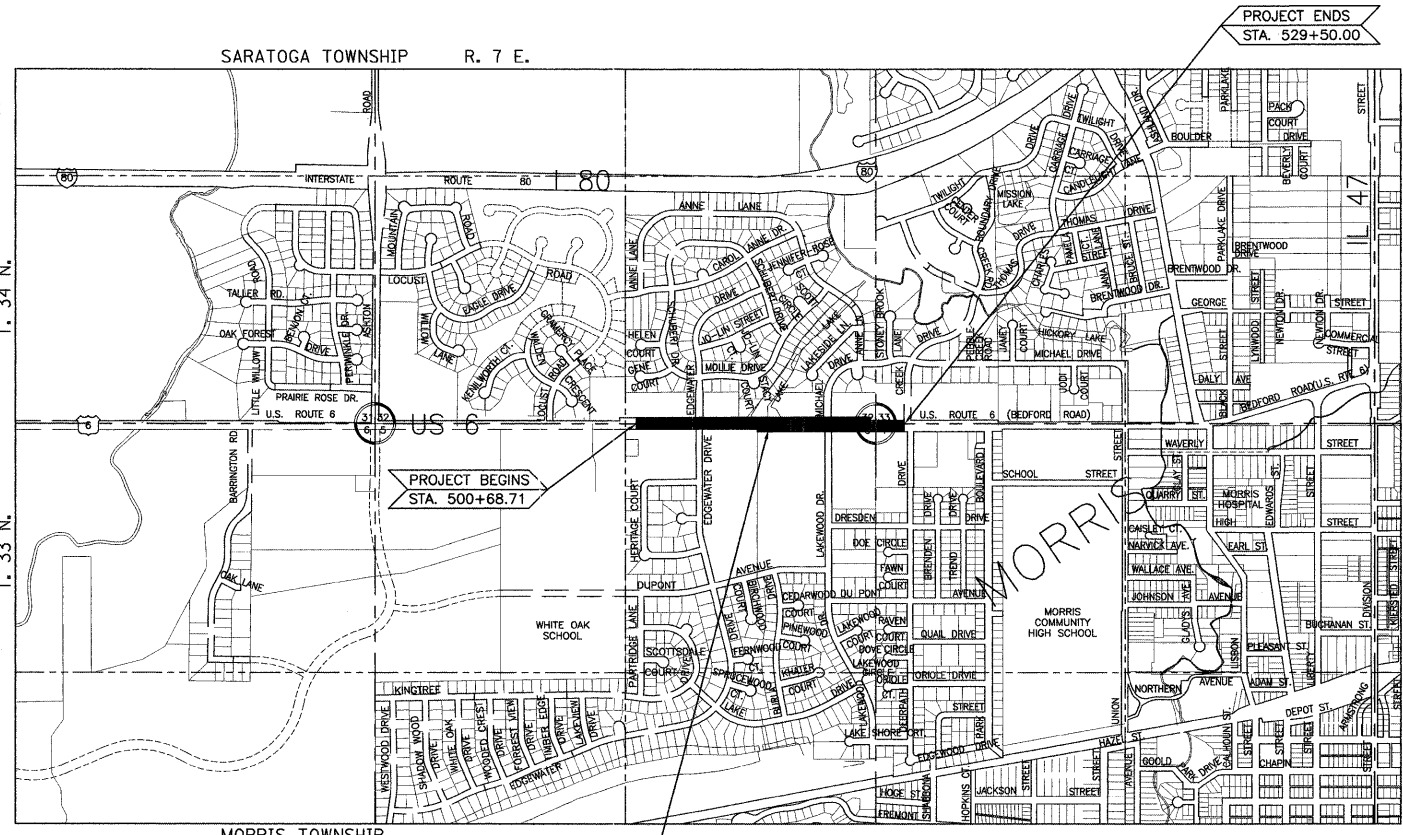

PROJECT LOCATION

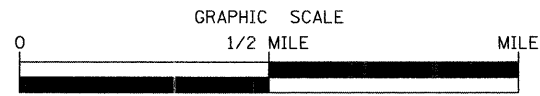

NET LENGTH OF SECTION 2881.29 (0.546 MILES)  
GROSS LENGTH OF SECTION 2881.29 (0.546 MILES)

10/20/2011  
date  
JAMES K. CLINARD  
LICENSED PROFESSIONAL ENGINEER  
NO. 062-041793  
STATE OF ILLINOIS  
expires 11-30-2011  
signature  
PROFESSIONAL DESIGN FIRM  
LICENSE NO. 184-001717

STATE OF ILLINOIS  
DEPARTMENT OF TRANSPORTATION  
DIVISION OF HIGHWAYS

SUBMITTED 10-27-2011  
date  
[Signature]  
MAYOR, CITY OF MORRIS

PASSED 10-28-2011  
date  
[Signature]  
DISTRICT 3 IMPLEMENTATION ENGINEER

RELEASED FOR BID BASED ON LIMITED REVIEW 10-28-2011  
date  
[Signature]  
DEPUTY DIRECTOR OF HIGHWAYS, REGION 2 ENGINEER

JAMES K. CLINARD  
CHAMBLIN & ASSOCIATES  
815.223.3344