

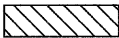



-  HOT-MIX ASPHALT SURFACE REMOVAL, BUTT JOINT
-  HOT-MIX ASPHALT SURFACE REMOVAL, 1 1/2"
-  SHOULDER REMOVAL
-  SIDEWALK REMOVAL
-  PAVEMENT REMOVAL & DRIVEWAY PAVEMENT REMOVAL
-  COMBINATION CONCRETE CURB & GUTTER REMOVAL

STA. 100+00.00 (EDGEWATER DRIVE (SOUTH)) =
STA. 508+50.60 (US RTE 6)

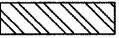

CHAMBLIN & ASSOCIATES, INC. © 2010
 Drawing Name: C:\Users\jmorris\Documents\STU\CAD\PLANS-STU\011-REMEDOC-WASH.dwg, Last Modified: Oct. 13, 2011 - 9:30am Plotted on: Oct. 13, 2011 - 10:07am by nancq

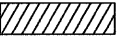
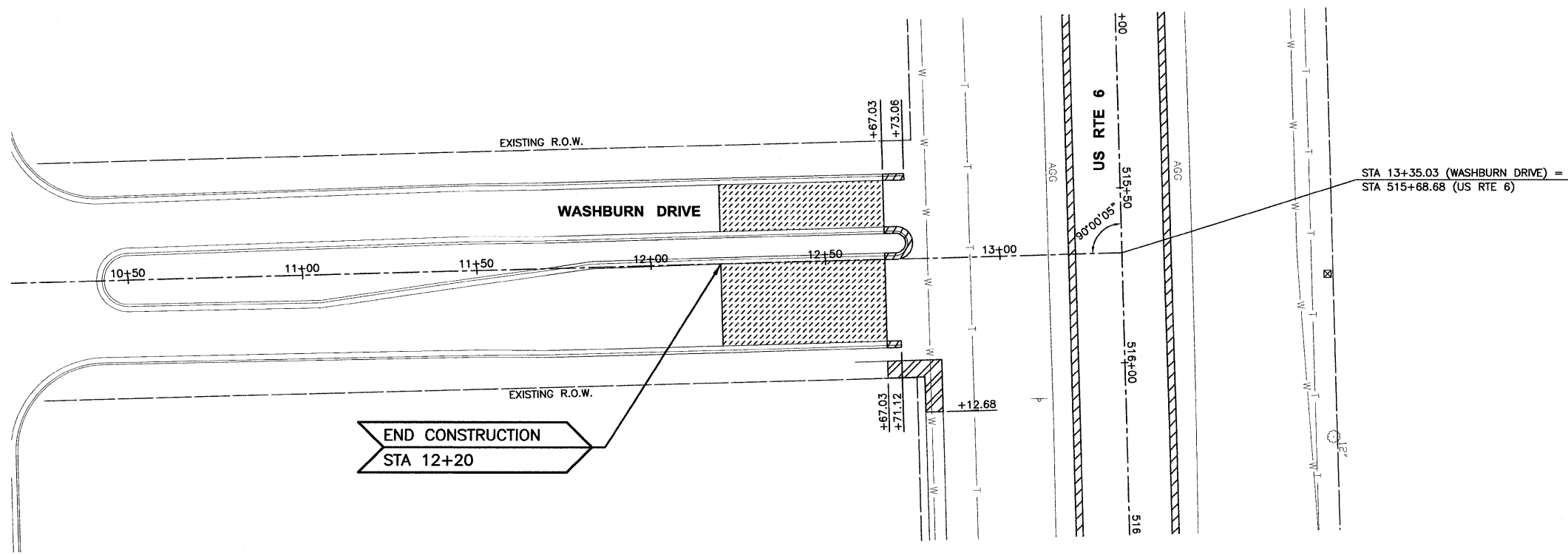
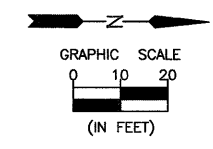
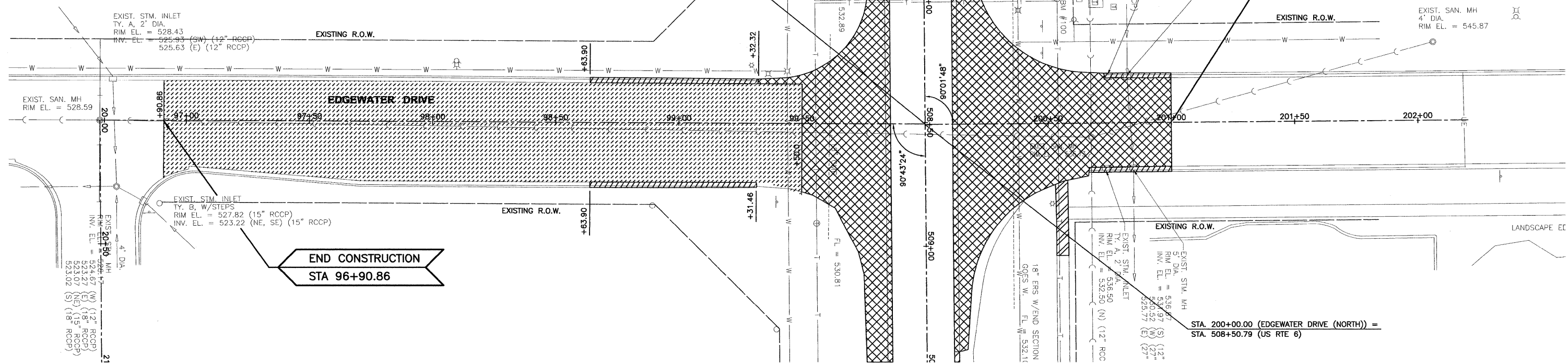
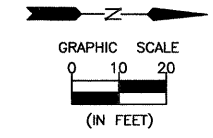
DRAWN BY: CHAMS	REVISIONS			
CHECKED BY: JKC	LEVEL	BY	DATE	DESCRIPTION
DATE: 10/11				

CHAMBLIN & ASSOCIATES
PERU MORRIS ILLINOIS

FAU 5952 (US 6)
SECTION 10-00083-00-TL
CITY OF MORRIS
GRUNDY COUNTY

REMOVAL PLANS
EDGEWATER DRIVE AND
WASHBURN DRIVE

CONSTRUCTION
PLANS

CONTRACT NO. 87486

CURRENT AS OF: 10/11	
SCALE: AS NOTED	SHEET 11
FILE NO.: 6969.00 Y-	OF 70