

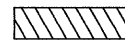





-  HOT-MIX ASPHALT BASE COURSE WIDENING
-  HOT-MIX ASPHALT SURFACE REMOVAL, BUTT JOINT
-  PCC BASE COURSE WIDENING
-  PCC DRIVEWAY, 8"
-  TEMPORARY DITCH CHECK
-  INLET AND PIPE PROTECTION



CHAMLIN & ASSOCIATES, INC. © 2010
Drawing Name: G:\Users\jv\9869-00-Morris-STU\CD\PLANS-STU\013-PP48-504.dwg Last Modified: Oct 13, 2011 - 8:50am Plotted on: Oct 13, 2011 - 10:17am by nancq

DRAWN BY: CHAMS	REVISIONS		
CHECKED BY: JKC	LEVEL	BY	DATE
DATE: 10/11			

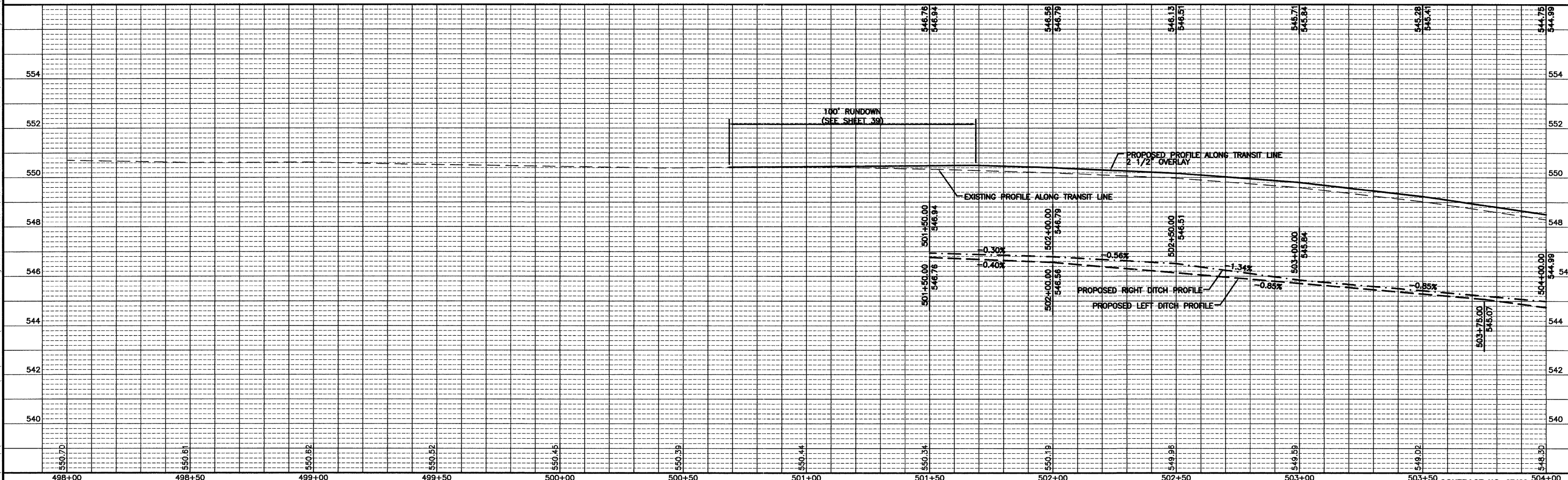
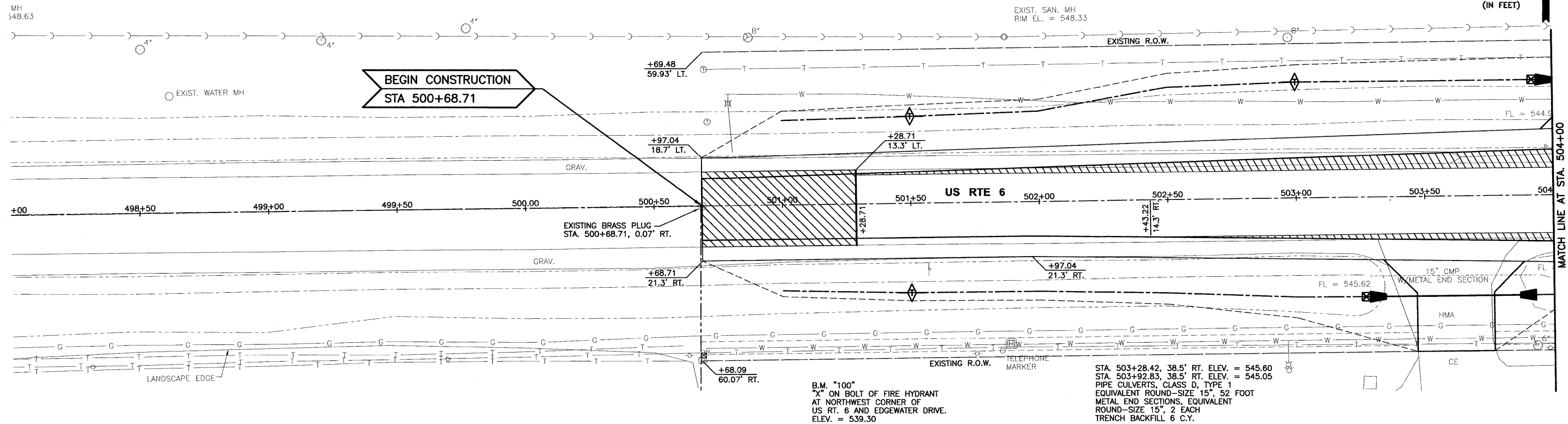
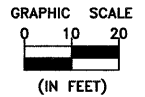
CHAMLIN & ASSOCIATES
PERU MORRIS ILLINOIS

FAU 5952 (US 6)
SECTION 10-00083-00-TL
CITY OF MORRIS
GRUNDY COUNTY

PLAN AND PROFILE
US 6
STA. 500+68.71 TO STA. 504+00

CONSTRUCTION PLANS

CURRENT AS OF: 10/11	SHEET 13
SCALE: AS NOTED	OF 70
FILE NO.: 6969.00 Y-	

CONTRACT NO. 87486