

STA. 512+07.00, 37.50' LT. ELEV. = 527.55
 STA. 512+77.95, 36.84' LT. ELEV. = 527.00
 PIPE CULVERTS, CLASS D, TYPE 1
 EQUIVALENT ROUND-SIZE 18" 59 FOOT
 METAL END SECTIONS, EQUIVALENT
 ROUND-SIZE 18" 2 EACH
 TRENCH BACKFILL 9 C.Y.

RIM 532.09
 INV 526.26(NE)
 INV 524.53(E)
 INV 524.42(W)

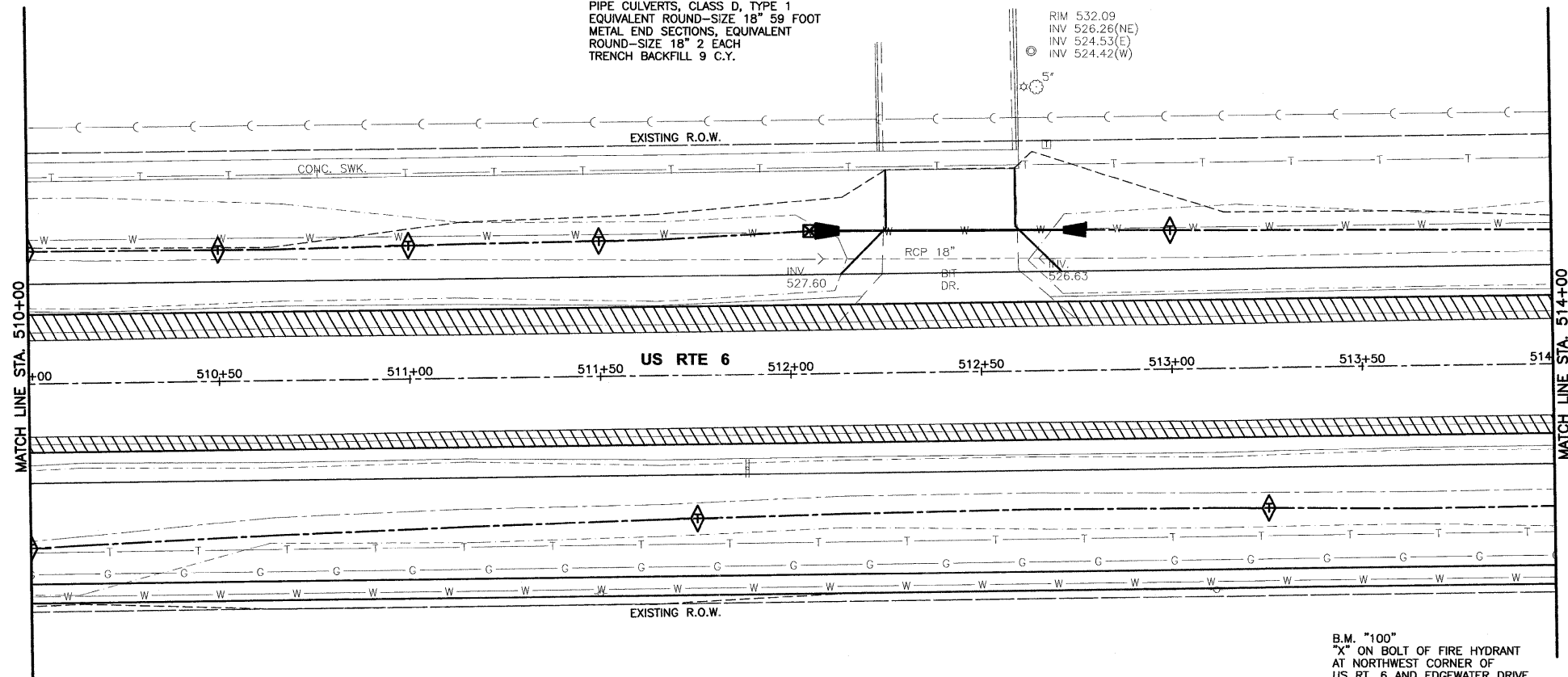
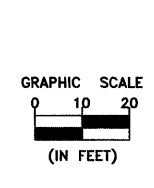

- HOT-MIX ASPHALT BASE COURSE WIDENING
- HOT-MIX ASPHALT SURFACE REMOVAL, BUTT JOINT
- PCC BASE COURSE WIDENING
- PCC DRIVEWAY, 8"
- TEMPORARY DITCH CHECK
- INLET AND PIPE PROTECTION

B.M. "100"
 "X" ON BOLT OF FIRE HYDRANT
 AT NORTHWEST CORNER OF
 US RT. 6 AND EDGEWATER DRIVE.
 ELEV. = 539.30

CHAMLIN & ASSOCIATES, INC. © 2010
 Drawing Location: C:\Users\jchamlin\Documents\Projects\10-00083-00-TL\10-00083-00-TL.dwg
 Plot Date: Oct 13, 2011 9:24am
 Plot Size: 10.00x15.00

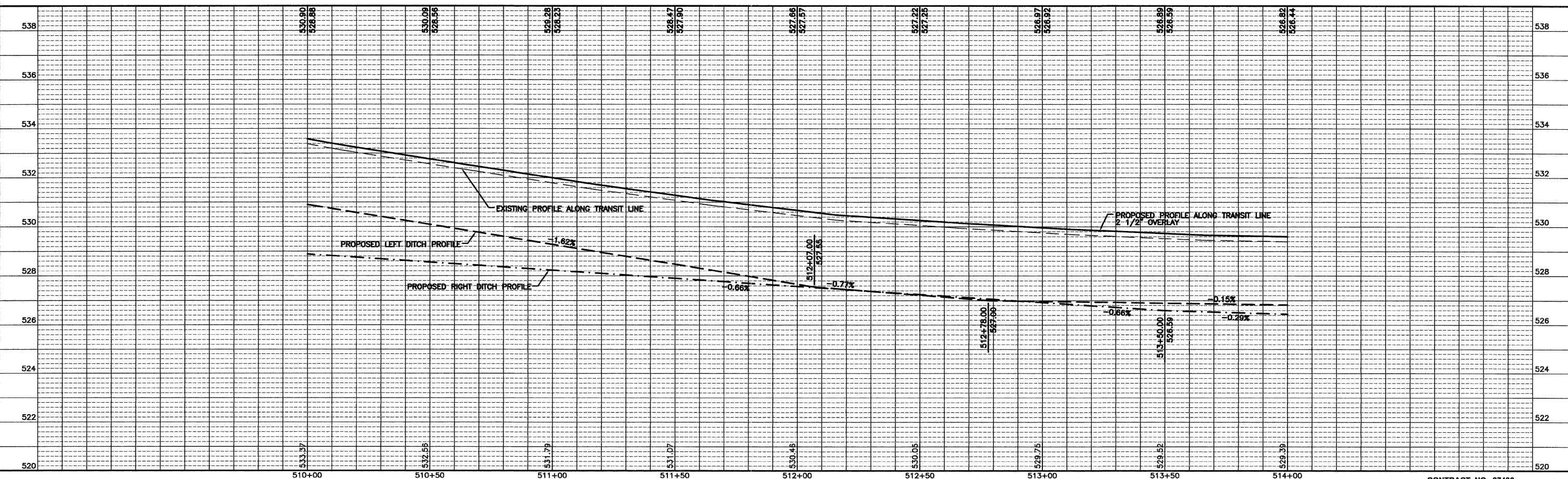

DRAWN BY: CHAMS	REVISIONS		
CHECKED BY: JKC	LEVEL	BY	DATE
DATE: 10/11			

CHAMLIN & ASSOCIATES
 PERU MORRIS ILLINOIS

FAU 5952 (US 6)
 SECTION 10-00083-00-TL
 CITY OF MORRIS
 GRUNDY COUNTY

PLAN AND PROFILE
 US 6
 STA. 510+00 TO STA. 514+00

CONSTRUCTION PLANS

CURRENT AS OF: 10/11	SHEET 15
SCALE: AS NOTED	OF 70
FILE NO.: 6969.00 Y-	

CONTRACT NO. 87486