

RELOCATED SIGNS SHALL BE LOCATED IN ACCORDANCE WITH HIGHWAY STANDARD 720006

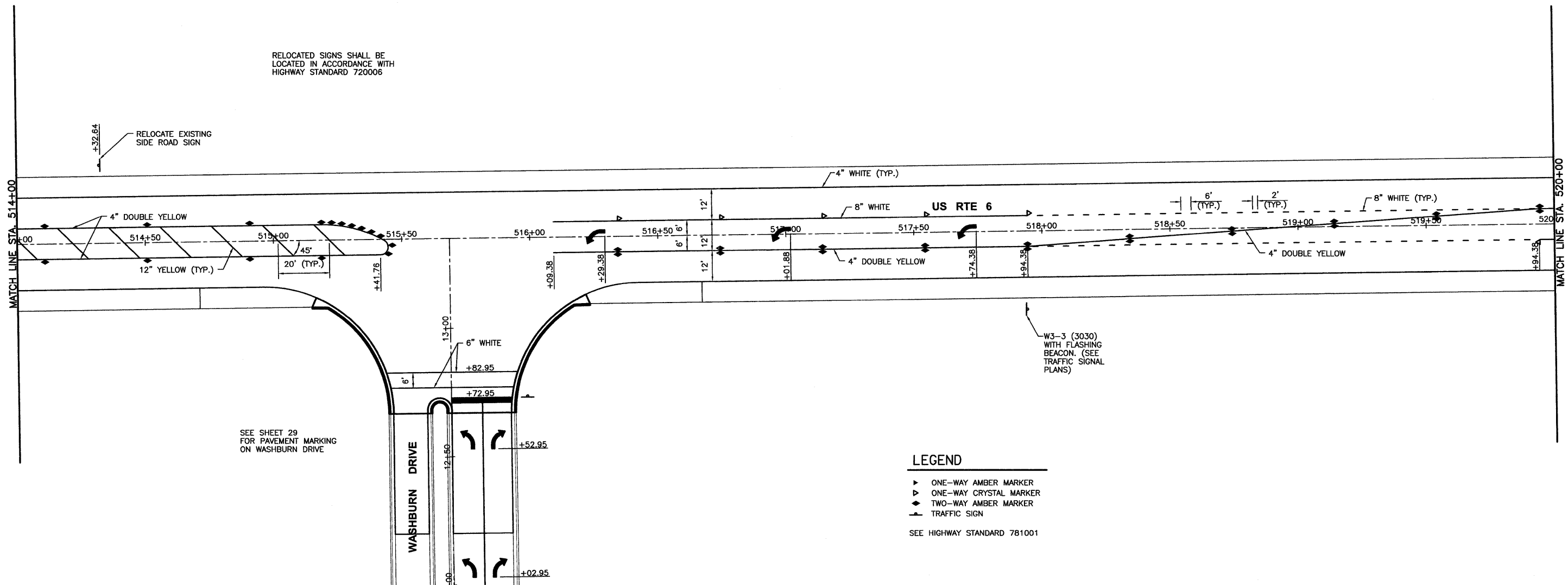

- LEGEND**
- ▶ ONE-WAY AMBER MARKER
  - ▷ ONE-WAY CRYSTAL MARKER
  - ◄ TWO-WAY AMBER MARKER
  - TRAFFIC SIGN
- SEE HIGHWAY STANDARD 781001

SEE SHEET 29 FOR PAVEMENT MARKING ON WASHBURN DRIVE

CHAMBLIN & ASSOCIATES, INC. © 2010  
 DRAWN BY: CHAMS  
 CHECKED BY: JKC  
 DATE: 10/11  
 PROJECT: FAU 5952 (US 6) SECTION 10-00083-00-TL CITY OF MORRIS GRUNDY COUNTY  
 FILE NO.: 6969.00 Y- OF 70

LEVEL	BY	DATE	REVISIONS	
			DESCRIPTION	

**CHAMBLIN ASSOCIATES**  
 PERU MORRIS ILLINOIS

FAU 5952 (US 6)  
 SECTION 10-00083-00-TL  
 CITY OF MORRIS  
 GRUNDY COUNTY

PAVEMENT MARKING AND SIGN PLANS  
 US 6  
 STA. 514+00 TO STA. 520+00

<b>CONSTRUCTION PLANS</b>	CURRENT AS OF: 10/11	
	SCALE: AS NOTED	SHEET 25
	FILE NO.: 6969.00 Y-	OF 70

CONTRACT NO. 87486