

STATE OF ILLINOIS  
DEPARTMENT OF TRANSPORTATION

F.A. #	SECTION	COUNTY	TOTAL SHEETS	SHEET NO.
VAR	4	VARIOUS	27	1
		ILLINOIS	CONTRACT NO. 72J36	

D6 GUARDRAIL END REPLACEMENT 2017

D-96-074-16

INDEX OF SHEETS

- 1 COVER SHEET
- 2 GENERAL NOTES
- 3 SUMMARY OF QUANTITIES
- 4-6 LOGAN COUNTY
- 7-11 SANGAMON COUNTY
- 12-18 MACOUPIN COUNTY
- 19-27 MONTGOMERY COUNTY

PROPOSED  
HIGHWAY PLANS

VARIOUS ROUTES  
SECTION: D6 GUARDRAIL END REPL 2017  
PROJECT ACHSIP-000V(086)  
GUARDRAIL TERMINAL REPLACEMENT  
VARIOUS COUNTIES IN DISTRICT 6

C-96-074-16

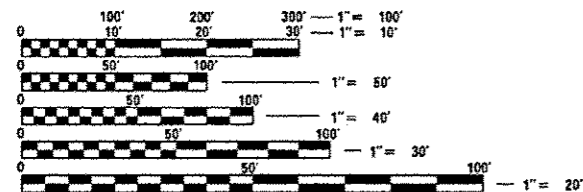
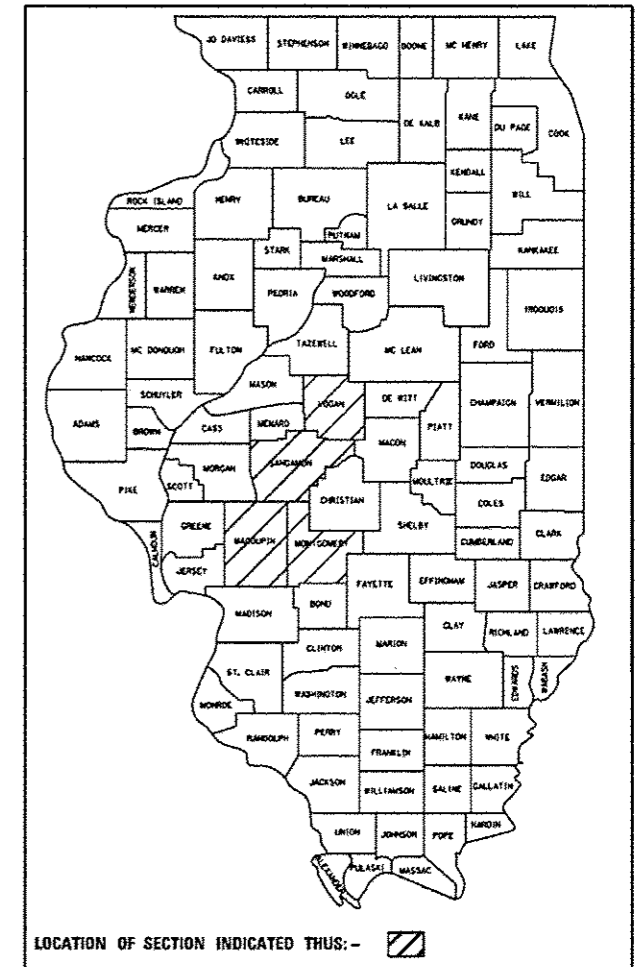

FULL SIZE PLANS HAVE BEEN PREPARED USING STANDARD ENGINEERING SCALES. REDUCED SIZED PLANS WILL NOT CONFORM TO STANDARD SCALES. IN MAKING MEASUREMENTS ON REDUCED PLANS, THE ABOVE SCALES MAY BE USED.

J.U.L.I.E.  
JOINT UTILITY LOCATION INFORMATION FOR EXCAVATION  
1-800-892-0123  
OR 811

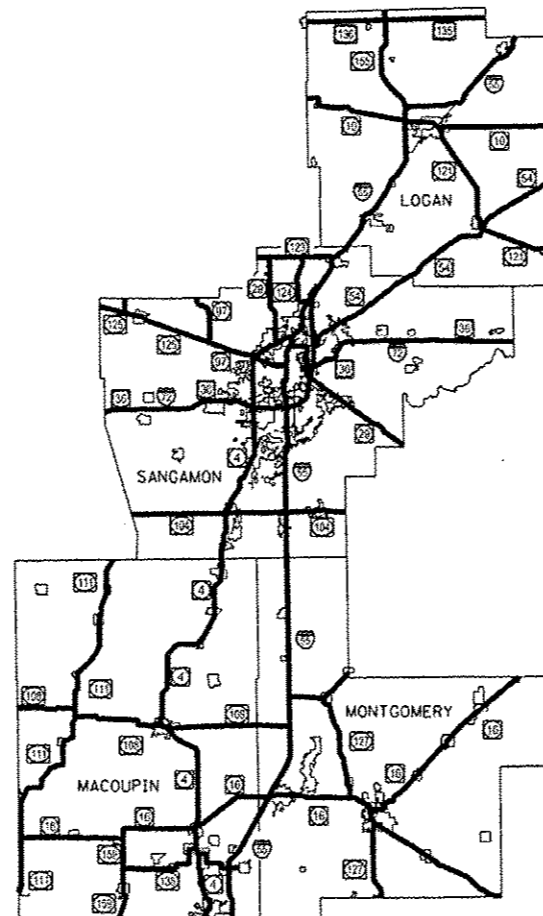

PROJECT ENGINEER: KEITH DONOVAN (217)782-4761  
PROJECT MANAGER: TOM COX (217)557-6349

CONTRACT NO. 72J36

STATE OF ILLINOIS  
DEPARTMENT OF TRANSPORTATION

SUBMITTED OCTOBER 21 2016  
*Jeffrey M. South* REGIONAL ENGINEER  
Dec 9 2016  
*Maureen M. Addis* ENGINEER OF DESIGN AND ENVIRONMENT  
Dec 9 2016  
*Maureen M. Addis* 2  
DIRECTOR OF PROGRAM DEVELOPMENT

PRINTED BY THE AUTHORITY  
OF THE STATE OF ILLINOIS

GENERAL NOTES

- 1 THIS PROJECT IS LOCATED ON VARIOUS ROUTES IN LOGAN, SANGAMON, MACOUPIN, AND MONTGOMERY COUNTIES WITHIN REGION 4-DISTRICT 6. THE WORK INCLUDED IN THIS SECTION CONSISTS OF VARIOUS TYPES OF GUARDRAIL TERMINAL REMOVAL, REPLACEMENT AND ALL OTHER WORK NECESSARY TO COMPLETE THIS SECTION.
- 2 THE LOCATIONS AS SHOWN ON THE LOCATION MAPS ARE FOR INFORMATION ONLY. THE CONTRACTOR AND RESIDENT ENGINEER SHOULD FIND SPECIFIC TERMINAL LOCATIONS USING THE LATITUDE AND LONGITUDE COORDINATES LOCATED ON THE LOCATION MAP TABLES. ALTERNATE ELECTRONIC LOCATION MAPS CAN BE OBTAINED BY CONTACTING THE PROJECT MANAGER LISTED ON THE COVER SHEET. BOTH ARCGIS WEB MAPS AND GIS SHAPE FILES ARE AVAILABLE IF DESIRED. ELECTRONIC LOCATION MAPS ARE PROVIDED TO SERVE AS AN AID TO THE CONTRACTOR IN LOCATING GUARDRAIL TERMINALS. IT IS ULTIMATELY THE CONTRACTOR'S RESPONSIBILITY TO ENSURE THAT THE CORRECT TERMINALS ARE LOCATED USING THE PLANS, COORDINATE INFORMATION, AND IF DESIRED, THE ELECTRONIC LOCATION MAPS.
- 3 REMOVAL OF MATERIALS SHALL INCLUDE DISMANTLING, LOADING, HAULING AND DISPOSAL. THE WORK SITE SHALL BE LEFT IN A SAFE AND ORDERLY CONDITION.
- 4 NO MATERIAL SHALL BE LEFT ON OR NEAR THE ROADWAY DURING NON-WORKING HOURS.
- 5 FURNISHED EXCAVATION, AS SHOWN, IS FOR CONSTRUCTING THE PROPOSED SHOULDER WIDENING TRANSITION FOR TYPE 1 (SPECIAL) GUARDRAIL TERMINALS (STANDARD 630301), AS NEEDED. QUANTITIES SHOWN ARE APPROXIMATE.
- 6 REMOVED GUARDRAIL THAT IS NOT REPLACED ON THE SAME DAY MUST BE DELINEATED WITH LIGHTED BARRICADES AT NO ADDITIONAL COST TO THE DEPARTMENT. NO LOCATIONS SHALL BE LEFT WITHOUT EITHER LIGHTED BARRICADES OR RESTORED GUARDRAIL AT ANY TIME.
- 7 GUARDRAIL MARKERS SHALL NOT BE ATTACHED TO TERMINAL SECTIONS.
- 8 ILLINOIS STATE LAW REQUIRES A 48 HOUR NOTICE TO BE GIVEN TO UTILITIES BEFORE DIGGING. FIELD MARKING OF FACILITIES MAY BE OBTAINED BY CONTACTING J.U.L.I.E. (PH. 800-892-0123) OR FOR NON-MEMBERS, THE UTILITY COMPANY DIRECTLY.
- 9 NO OVERNIGHT LANE CLOSURES WILL BE ALLOWED.
- 10 ALL AREAS DISTURBED BY THE CONTRACTOR SHALL BE SEEDED, AS DIRECTED BY THE ENGINEER, AT THE CONTRACTORS EXPENSE. SEEDING CLASS 2 SHALL BE USED ON AREAS FLATTER THAN 3:1, SEEDING CLASS 3 SHALL BE USED ON AREAS 3:1 AND STEEPER.
- 11 ALL QUANTITIES FOR GUARDRAIL REMOVAL INCLUDE THE REMOVAL OF THE NON COMPLIANT GUARDRAIL TERMINAL END SECTIONS.

HIGHWAY STANDARDS

000001-06	STANDARD SYMBOLS, ABBREVIATIONS AND PATTERNS
630001-11	STEEL PLATE BEAM GUARDRAIL
630106-02	LONG-SPAN GUARDRAIL OVER CULVERT
630111	WEAK POST GUARDRAIL ATTACHED TO CULVERT
630301-07	SHOULDER WIDENING FOR TYPE 1 (SPECIAL) GUARDRAIL TERMINALS
631011-10	TRAFFIC BARRIER TERMINAL, TYPE 2
701006-05	OFF-RD OPERATIONS, 2L, 2W, 15' TO 24" FROM PAVEMENT EDGE
701101-05	OFF-RD OPERATIONS, MULTILANE, 15' TO 24" FROM PAVEMENT EDGE
701201-04	LANE CLOSURE, 2L, 2W, DAY ONLY, FOR SPEEDS >= 45 MPH
701406-11	LANE CLOSURE, FREEWAY/EXPRESSWAY, DAY OPERATIONS ONLY
701421-08	LANE CLOSURE, MULTILANE, DAY OPERATIONS ONLY, FOR SPEEDS >+ 45 MPH TO 55 MPH
701901-06	TRAFFIC CONTROL DEVICES
725001-01	OBJECT AND TERMINAL MARKERS
782006	GUARDRAIL AND BARRIER WALL REFLECTOR MOUNTING DETAILS

DISTRICT SIX

EXAMINED October 3, 20 16

*John C. W...*  
OPERATIONS ENGINEER

EXAMINED October 3 20 16

*Ron Duchambeau*  
PROJECT IMPLEMENTATION ENGINEER

EXAMINED October 13 20 16

*Jeffrey P. Meyer*  
PROGRAM DEVELOPMENT ENGINEER

FILE NAME *	USER NAME * jackee	DESIGNED -	REVISED -	<b>STATE OF ILLINOIS DEPARTMENT OF TRANSPORTATION</b>	<b>GENERAL NOTES</b>	F.A. RTE.	SECTION	COUNTY	TOTAL SHEETS	SHEET NO.	
Default		CHECKED -	REVISED -			VAR	*	VARIOUS	27	2	
	PLOT SCALE * 100.0000' / in.	DATE -	REVISED -			SCALE: _____ SHEET 2 OF 27 SHEETS STA. _____ TO STA. _____		ILLINOIS FED. AID PROJECT CONTRACT NO. <u>T2J36</u>			
	PLOT DATE * 10/21/2016	DATE -	REVISED -			* D6 GUARDRAIL END REPL 2017					



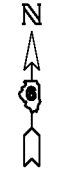
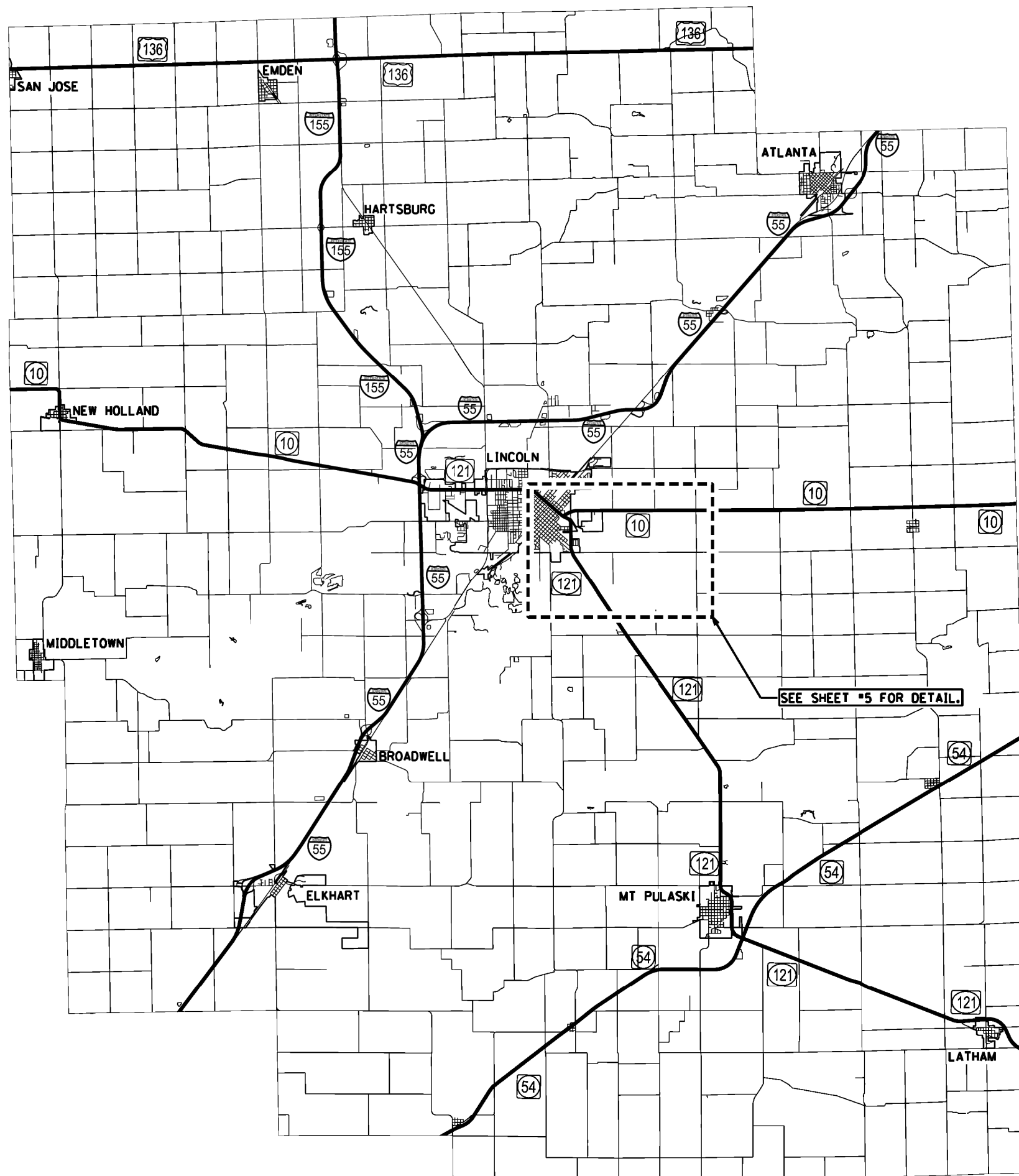

FILE NAME =	USER NAME = jackee	DESIGNED -	REVISED -
p:\11084EBID\INTEG\illinois.gov\PI\DOT\Documents\IDOT Offices\District 6\Projects\0672\Drawings\6A0\Sheets\0672\36-shrt-Logan		DRAWN -	REVISED -
Default	PLOT SCALE = 100.0000' / 1in.	CHECKED -	REVISED -
	PLOT DATE = 10/19/2016	DATE -	REVISED -

**STATE OF ILLINOIS  
DEPARTMENT OF TRANSPORTATION**

**Logan County Location Map**

SCALE: \_\_\_\_\_ SHEET 4 OF 27 SHEETS STA. \_\_\_\_\_ TO STA. \_\_\_\_\_

F.A. RTE.	SECTION	COUNTY	TOTAL SHEETS	SHEET NO.
VAR	*	VARIOUS	27	4
			CONTRACT NO. 72J36	

ILLINOIS FED. AID PROJECT  
\* D6 GUARDRAIL END REPL 2017

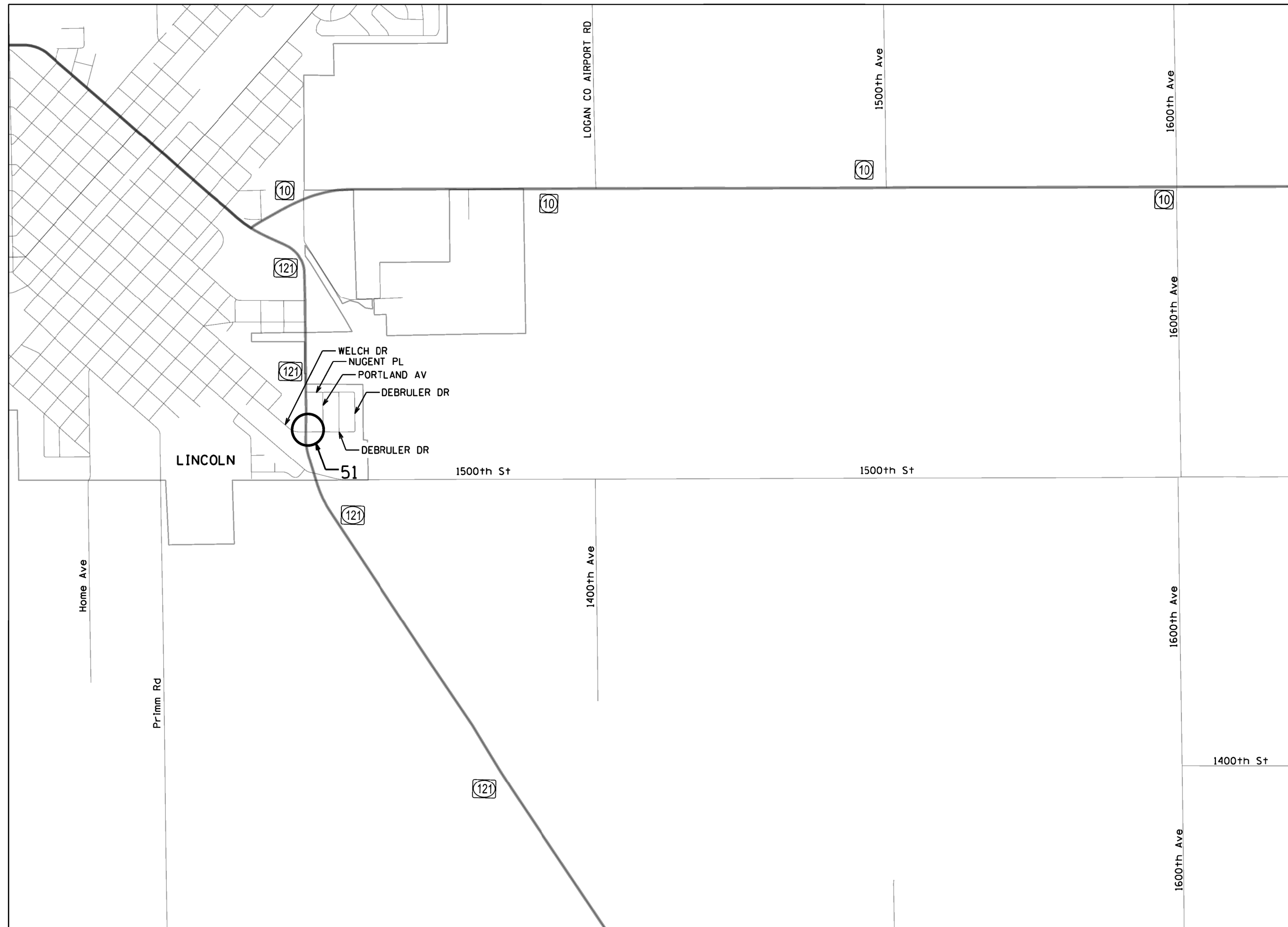

FILE NAME =	USER NAME = jackee	DESIGNED -	REVISED -
pw:\IL\084EBID\TEG\illinois.gov\PI\DOT\Documents\DOT Offices\District 6\Projects\D672\Drawings\6A0\Sheets\0672J36.sht-Logan		DRAWN -	REVISED -
Default	PLOT SCALE = 100.0000' / 1in.	CHECKED -	REVISED -
	PLOT DATE = 10/19/2016	DATE -	REVISED -

**STATE OF ILLINOIS  
DEPARTMENT OF TRANSPORTATION**

**Logan County Location Map**

SCALE: \_\_\_\_\_ SHEET 5 OF 27 SHEETS STA. \_\_\_\_\_ TO STA. \_\_\_\_\_

F.A. RTE.	SECTION	COUNTY	TOTAL SHEETS	SHEET NO.
VAR	*	VARIOUS	27	5
			CONTRACT NO. 72J36	

ILLINOIS FED. AID PROJECT  
\* D6 GUARDRAIL END REPL 2017

# LOGAN COUNTY

MAP LOCATION	ID	ROUTE OR ROAD NAME	TRAVEL DIRECTION	LATITUDE	LONGITUDE	EXISTING TERMINAL TYPE	FURNISHED EXCAVATION	STEEL PLATE BEAM GUARDRAIL, TYPE A, 6 FOOT POSTS	STEEL PLATE BEAM GUARDRAIL, TYPE A, 9 FOOT POSTS	TRAFFIC BARRIER TERMINAL, TYPE 2	TRAFFIC BARRIER TERMINAL, TYPE 1 (SPECIAL) TANGENT	TRAFFIC BARRIER TERMINAL, TYPE 1 (SPECIAL) FLARED	GUARDRAIL REMOVAL	TERMINAL MARKER - DIRECT APPLIED	GUARDRAIL REFLECTORS, TYPE A	VERTICAL ADJUSTMENT OF GUARDRAIL	REMOVE AND REERECT TRAFFIC BARRIER TERMINALS, TYPE 1	WEAK POST GUARDRAIL ATTACHED TO CULVERT	LONG-SPAN GUARDRAIL OVER CULVERT, 25 FT SPAN	
							20400800 CU YD	63000001 FOOT	63000003 FOOT	63100045 EACH	63100167 EACH	63100169 EACH	63200310 FOOT	72501000 EACH	78200005 EACH	X6330900 FOOT	63301990 EACH	63000031 FOOT	63000370 FOOT	
51	9475	IL121	NB	40.138202	-89.348697	Blunt End							50							
<b>TOTALS</b>							-	-	-	-	-	-	50	-	-	-	-	-	-	-

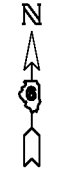
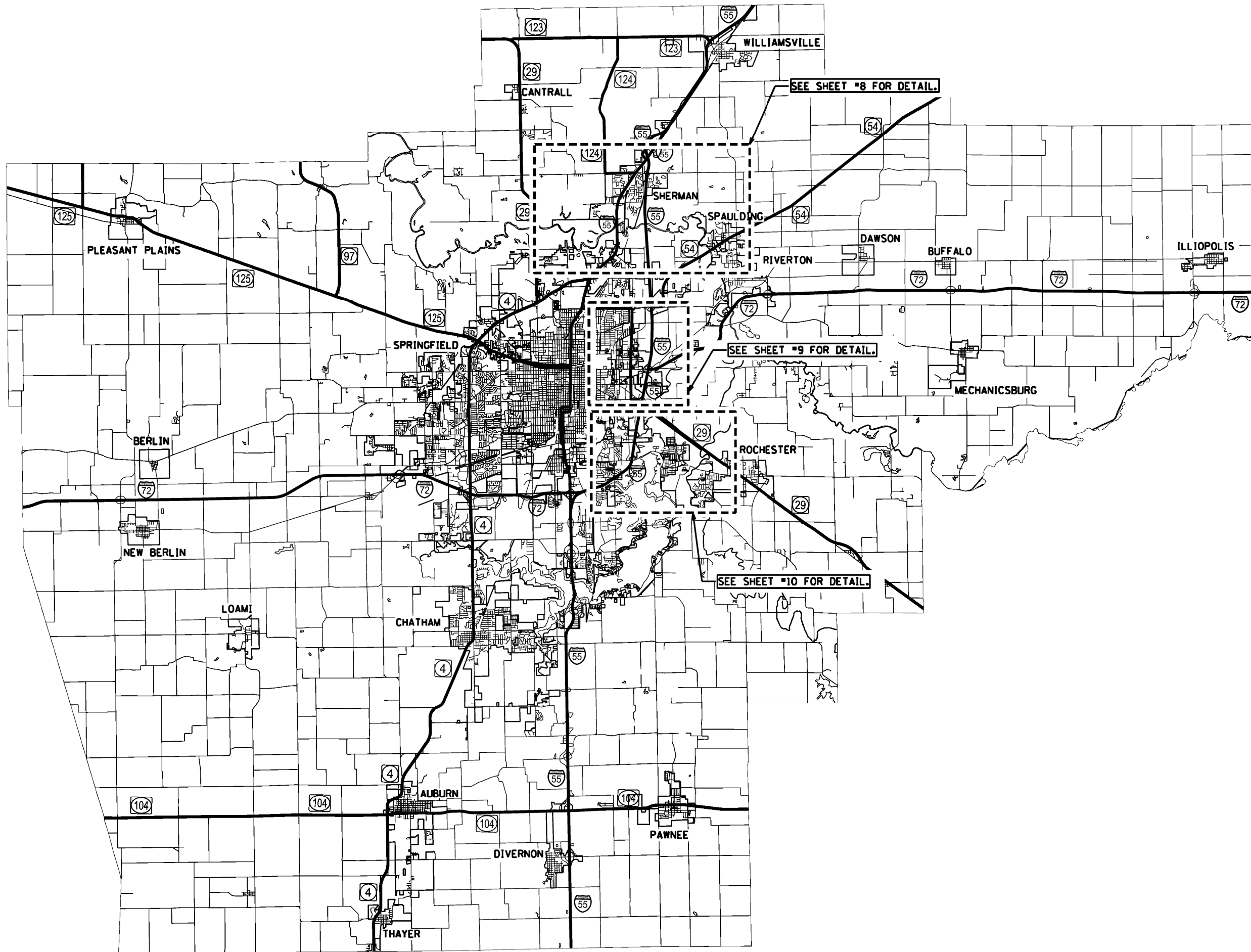

FILE NAME =	USER NAME = jockee	DESIGNED -	REVISED -
pw\j\084EBID\INTEG\illinois.gov\PI\DOT\Documents\DOT Offices\District 6\Projects\D672\Drawings\6A\Sheets\672J36-shr-Songp\REVISED -			
Default	PLOT SCALE = 100.0000' / 1in.	CHECKED -	REVISED -
	PLOT DATE = 10/19/2016	DATE -	REVISED -

**STATE OF ILLINOIS  
DEPARTMENT OF TRANSPORTATION**

**Sangamon County Location Map**

SCALE: \_\_\_\_\_ SHEET 7 OF 27 SHEETS STA. \_\_\_\_\_ TO STA. \_\_\_\_\_

F.A. RTE.	SECTION	COUNTY	TOTAL SHEETS	SHEET NO.
VAR	.	VARIOUS	27	7
			CONTRACT NO. 72J36	

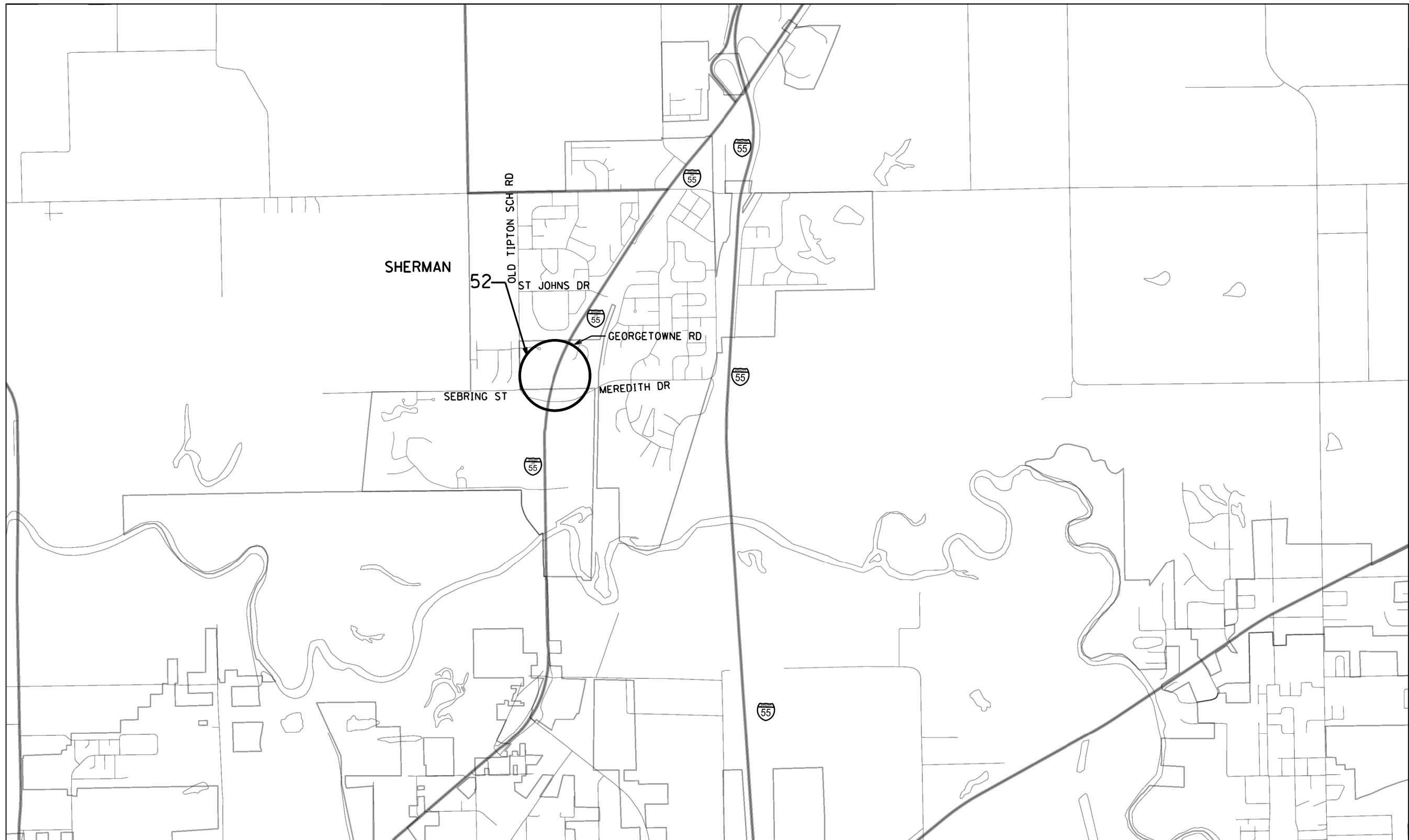

FILE NAME =	USER NAME = jackee	DESIGNED -	REVISED -
p:\11\084EBID\INTEG\Illinois.gov\PI\DOT\Documents\DOT Offices\District 6\Projects\0672\Drawings\6A\Sheets\0672J36-shr-Songh		DRAWN -	REVISED -
Default	PLOT SCALE = 100.0000' / 1in.	CHECKED -	REVISED -
	PLOT DATE = 10/19/2016	DATE -	REVISED -

**STATE OF ILLINOIS  
DEPARTMENT OF TRANSPORTATION**

**Sangamon County Location Map**

SCALE: \_\_\_\_\_ SHEET 8 OF 27 SHEETS STA. \_\_\_\_\_ TO STA. \_\_\_\_\_

F.A. RTE.	SECTION	COUNTY	TOTAL SHEETS	SHEET NO.
VAR	*	VARIOUS	27	8
CONTRACT NO. 72J36				



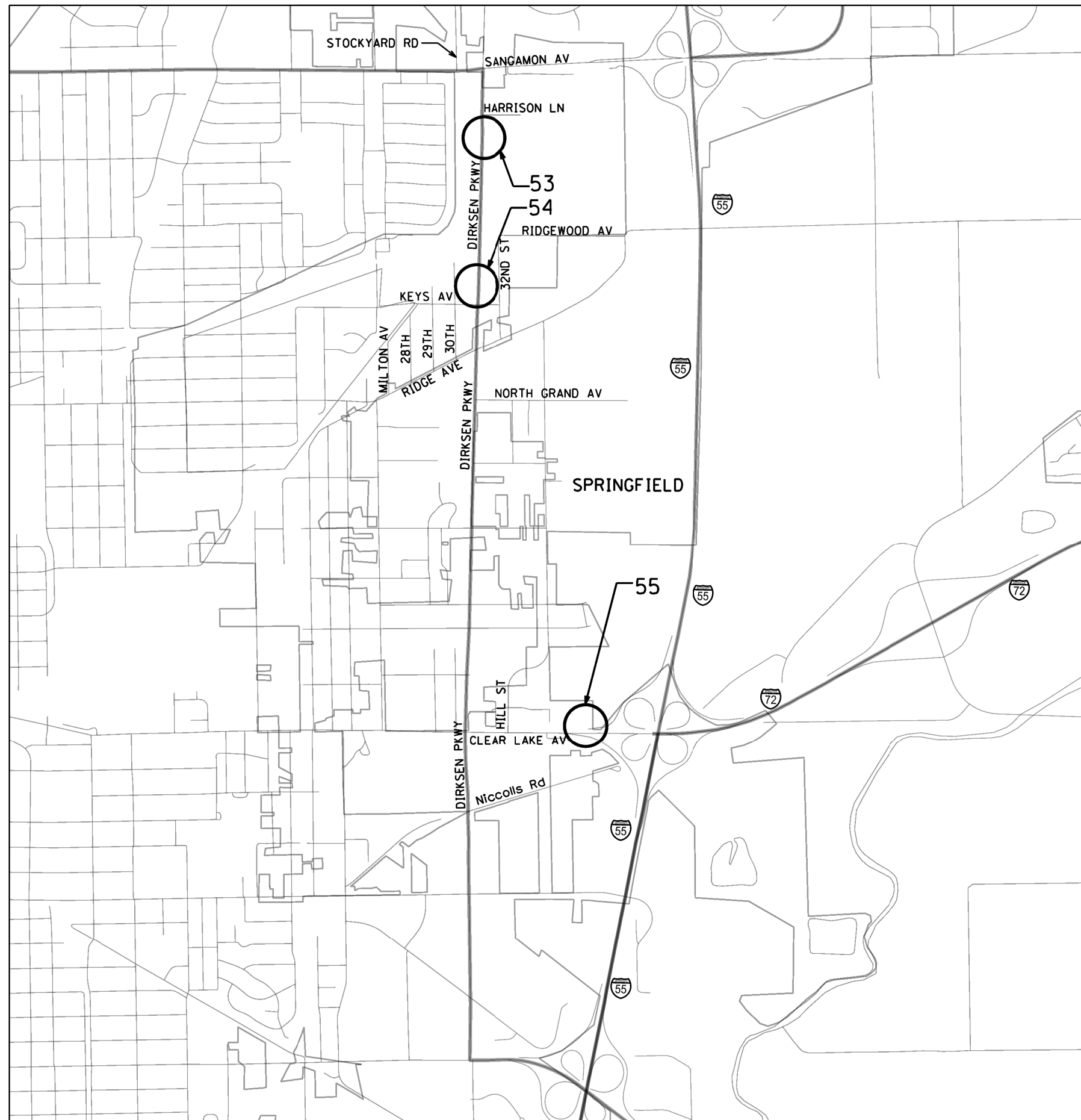

- NOTES:
1. GUARDRAIL ID 10358 AT MAP LOCATION 55 WILL BE REPLACED WITH A TYPE 2 TERMINAL AND WILL BE ATTACHED TO STRUCTURE TO MATCH EXISTING ATTACHMENT. GUARDRAIL WILL BE INSTALLED AT HEIGHT ACCORDING TO STANDARD SPECIFICATIONS.



FILE NAME =	USER NAME = jackee	DESIGNED -	REVISED -	<b>STATE OF ILLINOIS DEPARTMENT OF TRANSPORTATION</b>	<b>Sangamon County Location Map</b>		F.A. RTE.	SECTION	COUNTY	TOTAL SHEETS	SHEET NO.	
Default		CHECKED -	REVISED -		SCALE: _____	SHEET 9	OF 27	SHEETS	STA. _____	TO STA. _____	VAR	CONTRACT NO. 72J36
	PLOT SCALE = 100,000' / 1in.	DATE -	REVISED -									
	PLOT DATE = 10/19/2016		REVISED -									

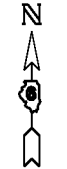
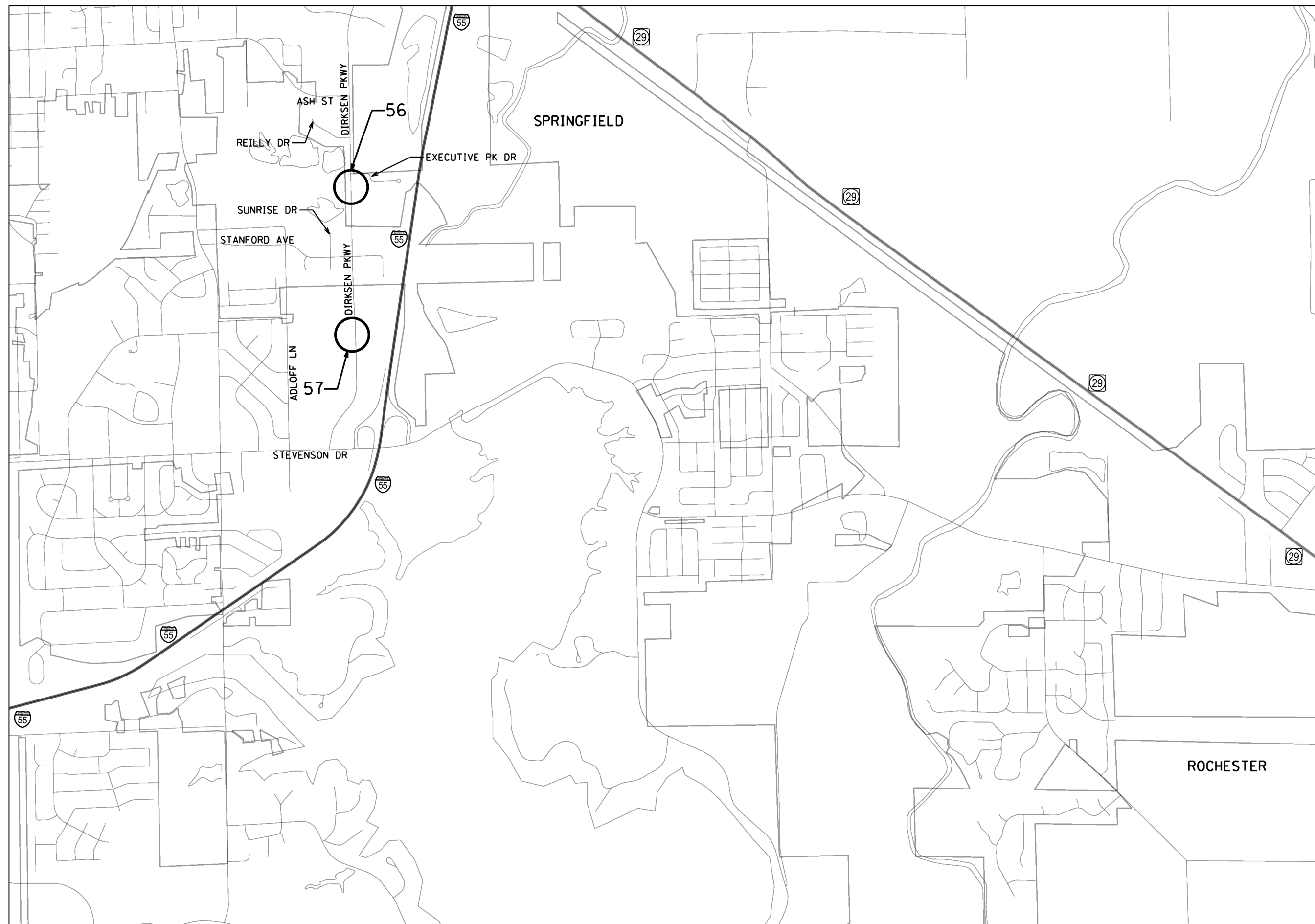

FILE NAME =	USER NAME = jackie	DESIGNED -	REVISED -
p:\11\084EBID\INTEG\illinois.gov\PI\DOT\Documents\DOT Offices\District 6\Projects\0672\Drawings\6A\Sheets\0672J36-ash-Sangam		DRAWN -	REVISED -
Default	PLOT SCALE = 100.0000' / in.	CHECKED -	REVISED -
	PLOT DATE = 10/19/2016	DATE -	REVISED -

**STATE OF ILLINOIS  
DEPARTMENT OF TRANSPORTATION**

**Sangamon County Location Map**

SCALE: \_\_\_\_\_ SHEET 10 OF 27 SHEETS STA. \_\_\_\_\_ TO STA. \_\_\_\_\_

F.A. RTE.	SECTION	COUNTY	TOTAL SHEETS	SHEET NO.
VAR	*	VARIOUS	27	10
			CONTRACT NO. 72J36	
ILLINOIS FED. AID PROJECT				



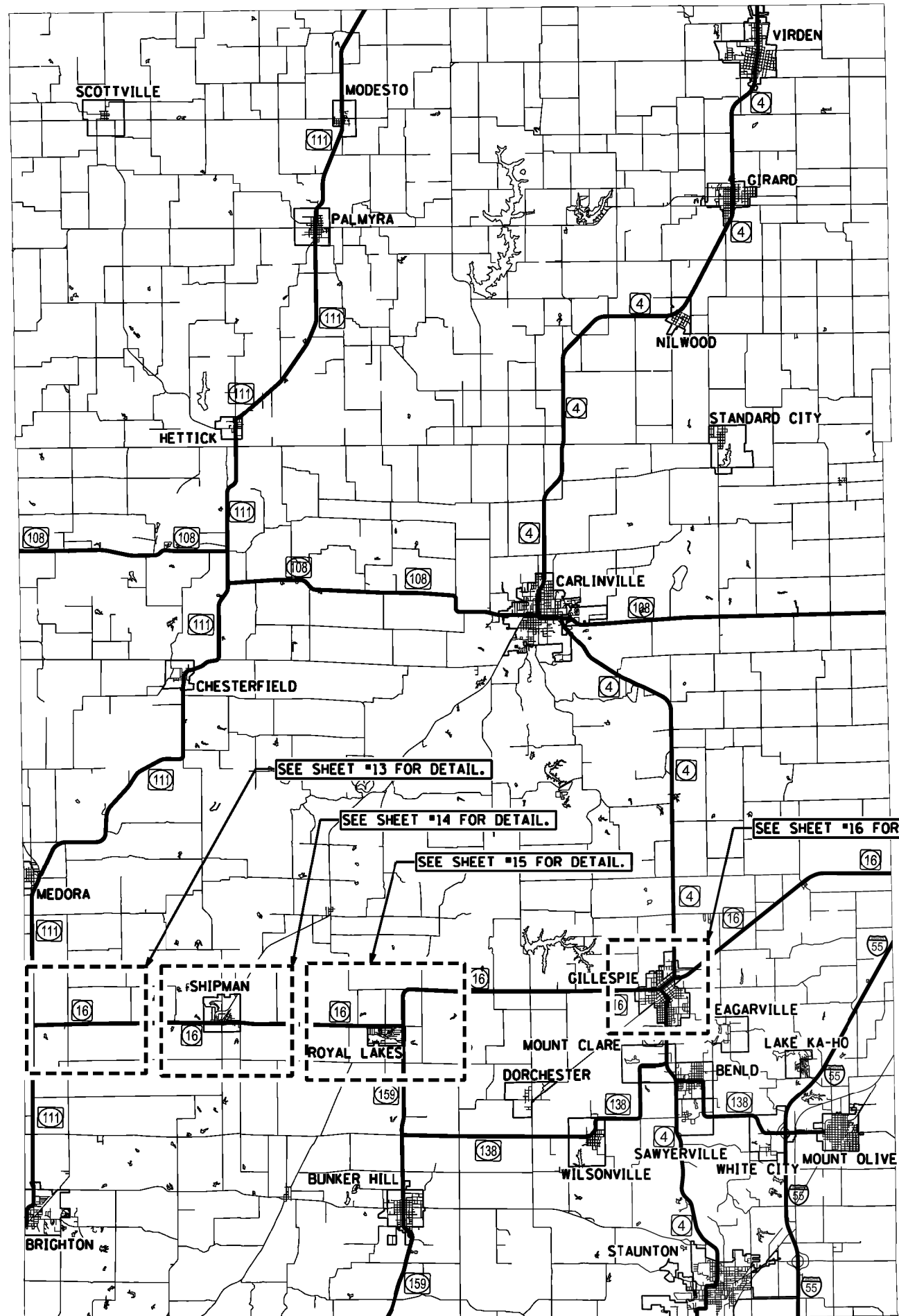

FILE NAME =	USER NAME = jackc	DESIGNED -	REVISED -	<b>STATE OF ILLINOIS</b> <b>DEPARTMENT OF TRANSPORTATION</b>	<b>Macoupin County Location Map</b>		F.A. RTE.	SECTION	COUNTY	TOTAL SHEETS	SHEET NO.	
pw\j\084EBIDINTEG\illinois.gov\PI\DOT\Documents\DOT Offices\District 6\Projects\D672J36\Drawings\6AD\Sheets\D672J36-sht-Macoupin	PLLOT SCALE = 100,000' / 1in.	CHECKED -	REVISED -				VAR	.	VARIOUS	27	12	
Default	PLOT DATE = 10/19/2016	DATE -	REVISED -				SCALE: SHEET 12 OF 27 SHEETS STA. TO STA.		ILLINOIS FED. AID PROJECT		CONTRACT NO. 72J36	
									ILLINOIS FED. AID PROJECT			

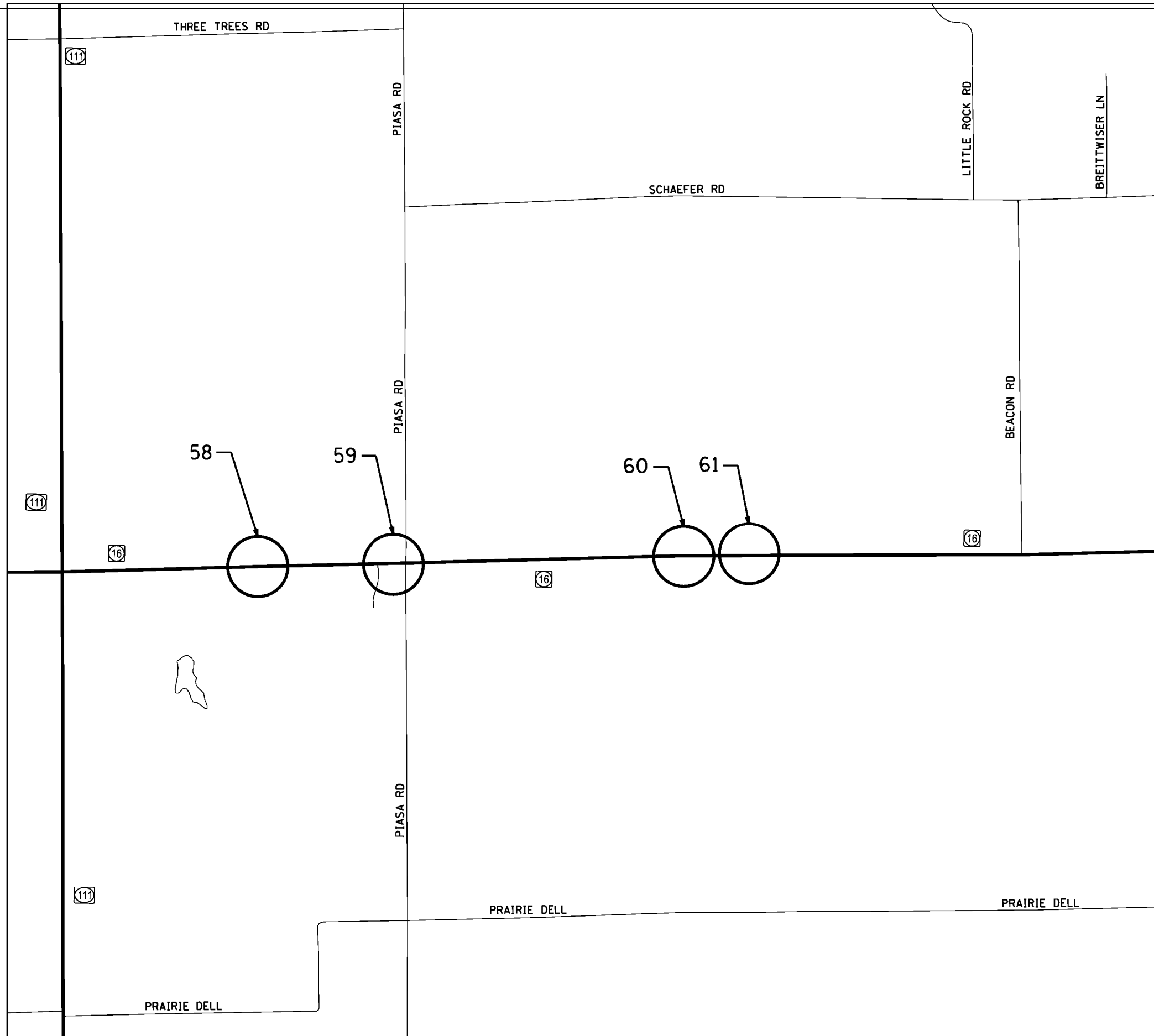

FILE NAME =	USER NAME = jackee	DESIGNED -	REVISED -
pw\jll084EBIDINTEG\illinois.gov\PI\DOT\Documents\DOT Offices\District 6\Projects\D672J36\Drawings\6AD\Sheets\D672J36-ah-Macoupin		DRAWN -	REVISED -
Default	PLOT SCALE = 100.0000' / 1in.	CHECKED -	REVISED -
	PLOT DATE = 10/19/2016	DATE -	REVISED -

**STATE OF ILLINOIS  
DEPARTMENT OF TRANSPORTATION**

**Macoupin County Location Map**

SCALE: SHEET 13 OF 27 SHEETS STA. TO STA.

F.A. RTE.	SECTION	COUNTY	TOTAL SHEETS	SHEET NO.
	•	VARIOUS	27	13
CONTRACT NO. 72J36			ILLINOIS FED. AID PROJECT	

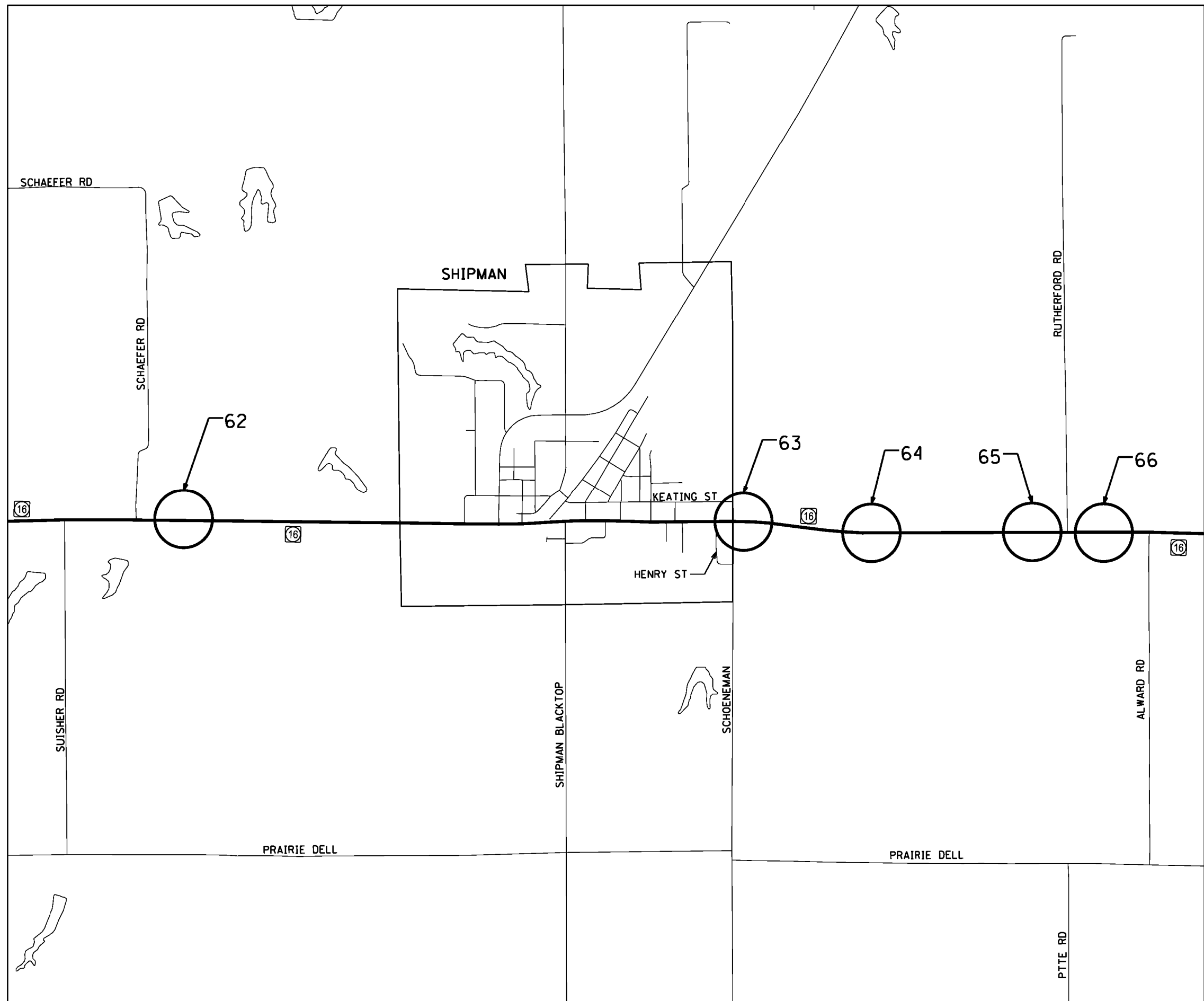

FILE NAME =	USER NAME = jackee	DESIGNED -	REVISED -
pw:\jll\084EBID\INTEG\illinois.gov\PI\DOT\Documents\DOT Offices\District 6\Projects\D672J36\Drawings\6A\Sheets\D672J36-sht-Macoupin		DRAWN -	REVISED -
Default	PLOT SCALE = 100.0000' / in.	CHECKED -	REVISED -
	PLOT DATE = 10/19/2016	DATE -	REVISED -

**STATE OF ILLINOIS  
DEPARTMENT OF TRANSPORTATION**

**Macoupin County Location Map**

SCALE: SHEET 14 OF 27 SHEETS STA. TO STA.

F.A. RTE.	SECTION	COUNTY	TOTAL SHEETS	SHEET NO.
	*	VARIOUS	27	14
CONTRACT NO. 72J36			ILLINOIS FED. AID PROJECT	

\* D6 GUARDRAIL END REPL 2017

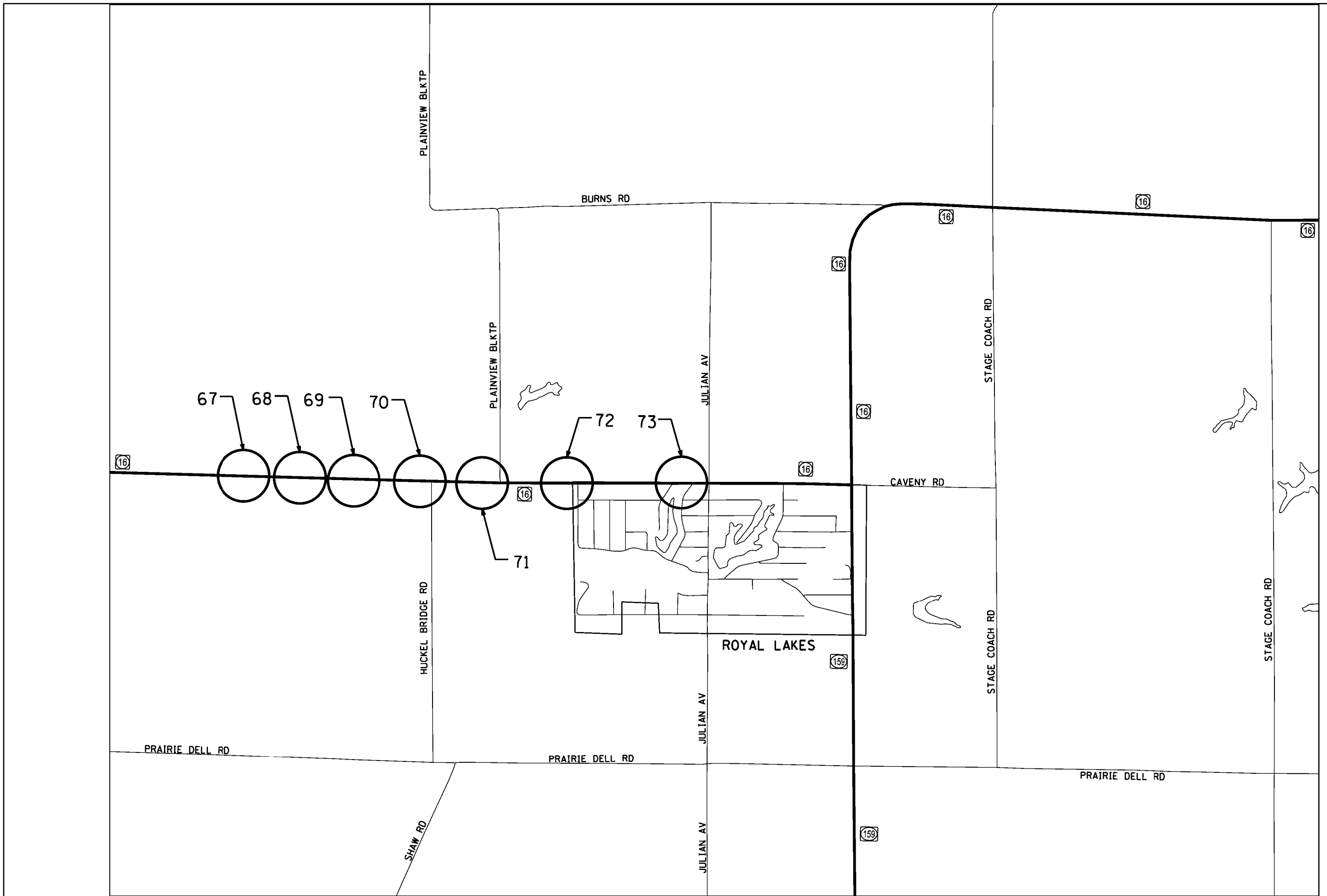

FILE NAME =	USER NAME = jockee	DESIGNED -	REVISED -
p:\11\084EBIDINTEG\illinois.gov\PI\DOT\Documents\IDOT Offices\District 6\Projects\0672\Drawings\6AD\Sheets\0672J36-shr-Mocou\0672J36-shr-Mocou.dwg		DRAWN -	REVISIONS -
Default	PLOT SCALE = 100.0000' / 1in.	CHECKED -	REVISED -
	PLOT DATE = 10/19/2016	DATE -	REVISED -

**STATE OF ILLINOIS  
DEPARTMENT OF TRANSPORTATION**

**Macoupin County Location Map**

SCALE: SHEET 15 OF 27 SHEETS STA. TO STA.

F.A. RTE.	SECTION	COUNTY	TOTAL SHEETS	SHEET NO.
	*	VARIOUS	27	15
ILLINOIS FED. AID PROJECT			CONTRACT NO. 72J36	

\* D6 GUARDRAIL END REPL 2017

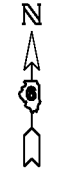
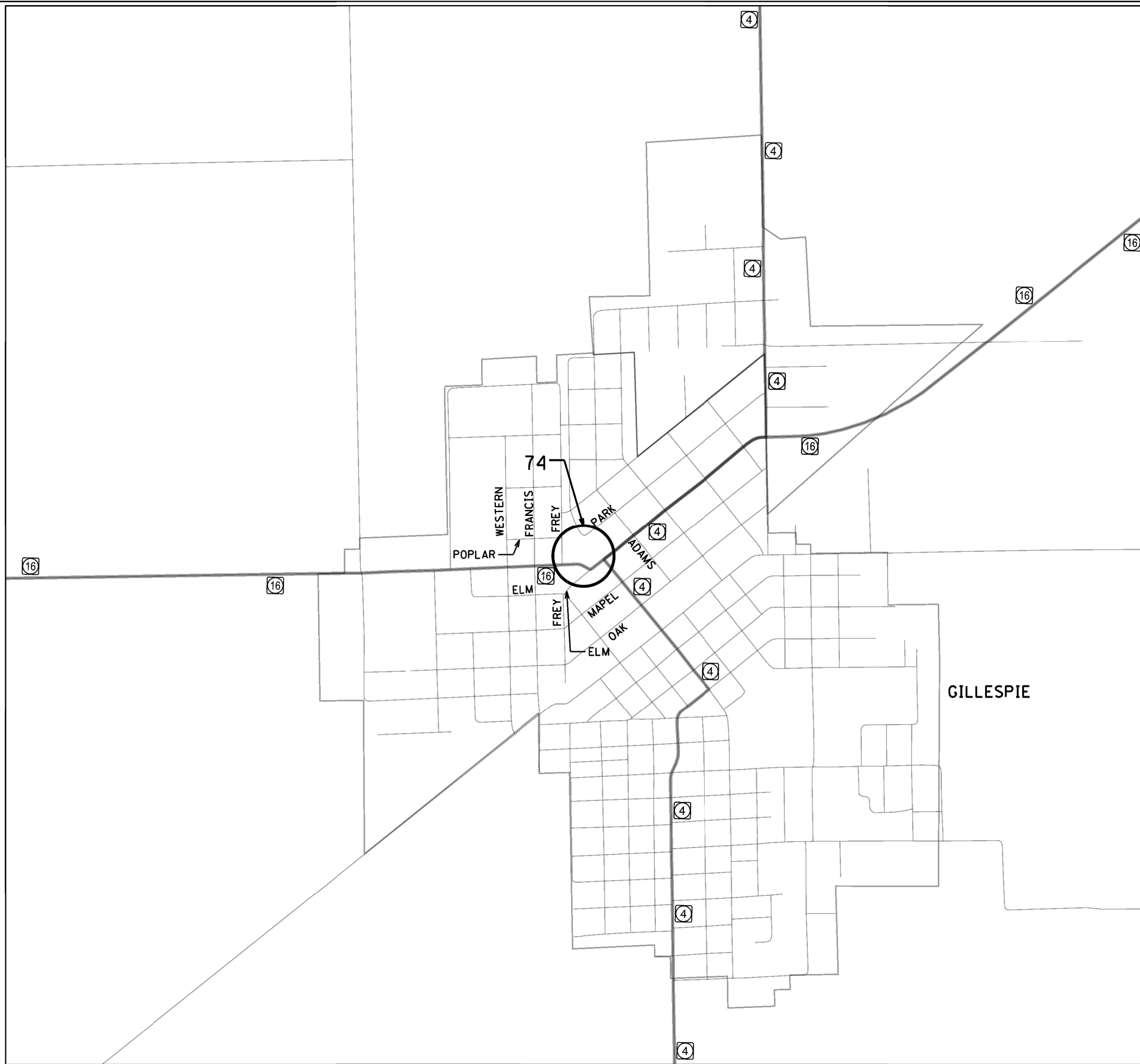

FILE NAME =	USER NAME = jockee	DESIGNED -	REVISED -
pw\jil\084EBID\INTEG\illinois.gov\PI\DOT\Documents\DOT Offices\District 6\Projects\D672J36\Drawings\6AD\Sheets\D672J36-sht-Macoupin		DRAWN -	REVISIONS -
Default	PLOT SCALE = 100.0000' / 1in.	CHECKED -	REVISED -
	PLOT DATE = 10/19/2016	DATE -	REVISED -

**STATE OF ILLINOIS  
DEPARTMENT OF TRANSPORTATION**

**Macoupin County Location Map**

SCALE: SHEET 16 OF 27 SHEETS STA. TO STA.

F.A. RTE.	SECTION	COUNTY	TOTAL SHEETS	SHEET NO.
VAR	*	VARIOUS	27	16
CONTRACT NO. 72J36			ILLINOIS FED. AID PROJECT	



# MACOUPIN COUNTY

MAP LOCATION	ID	ROUTE OR ROAD NAME	TRAVEL DIRECTION	LATITUDE	LONGITUDE	EXISTING TERMINAL TYPE	FURNISHED EXCAVATION	STEEL PLATE BEAM GUARDRAIL, TYPE A, 6 FOOT POSTS	STEEL PLATE BEAM GUARDRAIL, TYPE A, 9 FOOT POSTS	TRAFFIC BARRIER TERMINAL, TYPE 2	TRAFFIC BARRIER TERMINAL, TYPE 1 (SPECIAL) TANGENT	TRAFFIC BARRIER TERMINAL, TYPE 1 (SPECIAL) FLARED	GUARDRAIL REMOVAL	TERMINAL MARKER - DIRECT APPLIED	GUARDRAIL REFLECTORS, TYPE A	VERTICAL ADJUSTMENT OF GUARDRAIL	REMOVE AND REERECT TRAFFIC BARRIER TERMINALS, TYPE 1	WEAK POST GUARDRAIL ATTACHED TO CULVERT	LONG-SPAN GUARDRAIL OVER CULVERT, 25 FT SPAN
							20400800 CU YD	63000001 FOOT	63000003 FOOT	63100045 EACH	63100167 EACH	63100169 EACH	63200310 FOOT	72501000 EACH	78200005 EACH	X6330900 FOOT	63301990 EACH	63000031 FOOT	63000370 FOOT
58	1200	1L-16	EB	39.115987	-90.132203	Breakaway Cable Terminal w/ < 4' Flare					1		50	1	1	25			
	1201	1L-16	WB	39.116106	-90.131824	Breakaway Cable Terminal w/ < 4' Flare		25			1		75	1	1	25			
	1202	1L-16	SB	39.115996	-90.131052	Breakaway Cable Terminal w/ < 4' Flare						1	50	1	1	25			
	1203	1L-16	WB	39.11613	-90.130638	Breakaway Cable Terminal w/ < 4' Flare					1		50	1	1	25			
59	1204	1L-16	EB	39.116163	-90.124423	Blunt End					1		75	1	2				
	1207	1L-16	EB	39.116167	-90.124196	Blunt End					1			1	2				
60	1208	1L-16	EB	39.116459	-90.108434	Blunt End					1		25	1	1			62.5	
	1209	1L-16	WB	39.116579	-90.108443	Blunt End					1		25	1	1				
	1210	1L-16	WB	39.11658	-90.107978	Blunt End					1		25	1	1			62.5	
	1211	1L-16	EB	39.116477	-90.108065	Blunt End					1		25	1	1				
61	1212	1L-16	EB	39.116472	-90.106417	Breakaway Cable Terminal w/ < 4' Flare					1		50	1	1	25			
	1213	1L-16	WB	39.116589	-90.106711	Breakaway Cable Terminal w/ < 4' Flare					1		50	1	1	50			
	1214	1L-16	EB	39.116471	-90.105586	Breakaway Cable Terminal w/ < 4' Flare					1		50	1	1	25			
	1215	1L-16	WB	39.116592	-90.105578	Breakaway Cable Terminal w/ < 4' Flare					1		50	1	1	25			
62	1217	1L-16	WB	39.116923	-90.06592	Blunt End	15				1		75	1	2				
	1218	1L-16	WB	39.116919	-90.065703	Blunt End	15				1			1	2				
63	1220	1L-16	EB	39.116727	-90.034652	Breakaway Cable Terminal w/ < 4' Flare					1		50	1	1	25			
	1222	1L-16	WB	39.116845	-90.034379	Breakaway Cable Terminal w/ < 4' Flare					1		50	1	1	25			
	1223	1L-16	EB	39.116709	-90.034211	Breakaway Cable Terminal w/ < 4' Flare					1		50	1	1	0			
64	1228	1L-16	EB	39.116212	-90.027417	Breakaway Cable Terminal w/ < 4' Flare					1		50	1	1	25			
	1229	1L-16	WB	39.116336	-90.027562	Breakaway Cable Terminal w/ < 4' Flare					1		50	1	1	25			
	1230	1L-16	WB	39.116332	-90.026996	Breakaway Cable Terminal w/ < 4' Flare					1		50	1	1	25			
	1231	1L-16	EB	39.116207	-90.026888	Breakaway Cable Terminal w/ < 4' Flare					1		50	1	1	25			
65	1232	1L-16	EB	39.116222	-90.018752	Breakaway Cable Terminal w/ < 4' Flare					1		50	1	1	25			
	1233	1L-16	WB	39.116349	-90.018514	Breakaway Cable Terminal w/ < 4' Flare		50			1		100	1	1				
	1234	1L-16	EB	39.116224	-90.017822	Breakaway Cable Terminal w/ < 4' Flare					1		50	1	1	25			
	1235	1L-16	WB	39.116346	-90.017492	Breakaway Cable Terminal w/ < 4' Flare					1		50	1	2				
66	1236	1L-16	EB	39.116235	-90.014778	Breakaway Cable Terminal w/ < 4' Flare					1		50	1	1	25			
	1237	1L-16	WB	39.116356	-90.01483	Breakaway Cable Terminal w/ < 4' Flare					1		50	1	1	25			
	1238	1L-16	EB	39.116227	-90.013375	Breakaway Cable Terminal w/ < 4' Flare					1		50	1	1	25			
	1239	1L-16	WB	39.116359	-90.013508	Breakaway Cable Terminal w/ < 4' Flare					1		50	1	1	25			

# MACOUPIN COUNTY CONT.

MAP LOCATION	ID	ROUTE OR ROAD NAME	TRAVEL DIRECTION	LATITUDE	LONGITUDE	EXISTING TERMINAL TYPE	FURNISHED EXCAVATION	STEEL PLATE BEAM GUARDRAIL, TYPE A, 6 FOOT POSTS	STEEL PLATE BEAM GUARDRAIL, TYPE A, 9 FOOT POSTS	TRAFFIC BARRIER TERMINAL, TYPE 2	TRAFFIC BARRIER TERMINAL, TYPE 1 (SPECIAL) TANGENT	TRAFFIC BARRIER TERMINAL, TYPE 1 (SPECIAL) FLARED	GUARDRAIL REMOVAL	TERMINAL MARKER - DIRECT APPLIED	GUARDRAIL REFLECTORS, TYPE A	VERTICAL ADJUSTMENT OF GUARDRAIL	REMOVE AND REERECT TRAFFIC BARRIER TERMINALS, TYPE 1	WEAK POST GUARDRAIL ATTACHED TO CULVERT	LONG-SPAN GUARDRAIL OVER CULVERT, 25 FT SPAN	
							20400800 CU YD	63000001 FOOT	63000003 FOOT	63100045 EACH	63100167 EACH	63100169 EACH	63200310 FOOT	72501000 EACH	78200005 EACH	X6330900 FOOT	63301990 EACH	63000031 FOOT	63000370 FOOT	
67	1240	IL-16	EB	39.115803	-89.992965	Breakaway Cable Terminal w/ < 4' Flare					1		50	1	1					
	1241	IL-16	WB	39.115909	-89.992729	Breakaway Cable Terminal w/ < 4' Flare					1		50	1	1	25				
	1242	IL-16	EB	39.115777	-89.99161	Breakaway Cable Terminal w/ < 4' Flare		75			1		125	1	2					
	1243	IL-16	WB	39.115889	-89.990795	Breakaway Cable Terminal w/ < 4' Flare					1		50	1	1	25				
68	1244	IL-16	EB	39.11572	-89.989069	Breakaway Cable Terminal w/ < 4' Flare		25			1		125	1	2					
	1245	IL-16	WB	39.115838	-89.988941	Breakaway Cable Terminal w/ < 4' Flare					1		50	1	1	25				
	1246	IL-16	EB	39.115705	-89.988636	Breakaway Cable Terminal w/ < 4' Flare					1			1	2					
	1247	IL-16	WB	39.11582	-89.987983	Breakaway Cable Terminal w/ < 4' Flare					1		50	1	1	25				
69	1248	IL-16	EB	39.115605	-89.984121	Breakaway Cable Terminal w/ < 4' Flare		50			1		50	1	1	125				
	1249	IL-16	WB	39.115716	-89.983718	Breakaway Cable Terminal w/ < 4' Flare		50			1		50	1	1	125				
70	1250	IL-16	WB	39.115677	-89.981865	Breakaway Cable Terminal w/ < 4' Flare					1		50	1	1	25				
	1251	IL-16	WB	39.115669	-89.981396	Breakaway Cable Terminal w/ < 4' Flare					1		50	1	1	150				
	1252	IL-16	EB	39.115528	-89.980918	Breakaway Cable Terminal w/ < 4' Flare					1		50	1	1	25				
	1254	IL-16	EB	39.115484	-89.978677	Breakaway Cable Terminal w/ < 4' Flare					1		50	1	1	25				
71	1192	IL-16	WB	39.115526	-89.975429	Breakaway Cable Terminal w/ < 4' Flare		275			1		137.5	1	2					
	1193	IL-16	EB	39.115429	-89.975338	Breakaway Cable Terminal w/ < 4' Flare		375			1		275	1	2					
	1194	IL-16	WB	39.11553	-89.975899	Breakaway Cable Terminal w/ < 4' Flare	TERMINAL IS REMOVED AND GUARDRAIL IS COMBINED WITH ADJACENT TERMINAL													
	1195	IL-16	EB	39.115434	-89.976347	Breakaway Cable Terminal w/ < 4' Flare	TERMINAL IS REMOVED AND GUARDRAIL IS COMBINED WITH ADJACENT TERMINAL													
	1196	IL-16	WB	39.11555	-89.976462	Breakaway Cable Terminal w/ < 4' Flare	TERMINAL IS REMOVED AND GUARDRAIL IS COMBINED WITH ADJACENT TERMINAL													
	1197	IL-16	WB	39.115551	-89.976718	Breakaway Cable Terminal w/ < 4' Flare					1		87.5	1	2					
	1198	IL-16	EB	39.115432	-89.976762	Breakaway Cable Terminal w/ < 4' Flare	TERMINAL IS REMOVED AND GUARDRAIL IS COMBINED WITH ADJACENT TERMINAL													
	1199	IL-16	EB	39.115447	-89.977027	Breakaway Cable Terminal w/ < 4' Flare					1		87.5	1	2					
72	1188	IL-16	WB	39.115504	-89.969813	Breakaway Cable Terminal w/ < 4' Flare	15		175		1		225	1	2					
	1189	IL-16	EB	39.115371	-89.969966	Breakaway Cable Terminal w/ < 4' Flare			200		1		250	1	2					
	1190	IL-16	EB	39.115378	-89.971015	Breakaway Cable Terminal w/ < 4' Flare					1		50	1	2					
	1191	IL-16	WB	39.115494	-89.97077	Breakaway Cable Terminal w/ < 4' Flare	15				1		50	1	2					
73	1184	IL-16	WB	39.115472	-89.962289	Breakaway Cable Terminal w/ < 4' Flare	15		175		1		225	1	2					
	1185	IL-16	EB	39.115349	-89.962198	Breakaway Cable Terminal w/ < 4' Flare					1		50	1	1	50				
	1186	IL-16	WB	39.115477	-89.963253	Breakaway Cable Terminal w/ < 4' Flare	15				1		50	1	2					
	1187	IL-16	EB	39.115354	-89.963277	Breakaway Cable Terminal w/ < 4' Flare					1		50	1	1	50				
74	1306	IL-16	EB	39.129595	-89.820539	Unknown/Other					1		50	1	2					
	1307	IL-16	EB	39.129648	-89.820654	Unknown/Other					1			1	2					
TOTALS							90	937.5	550	-	58	1	3862.5	59	79	1200	-	125	-	-

FILE NAME =	USER NAME = jocke	DESIGNED -	REVISED -	STATE OF ILLINOIS DEPARTMENT OF TRANSPORTATION				Macoupin County Schedule				F.A. RTE.	SECTION	COUNTY	TOTAL SHEETS	SHEET NO.
Default	PLOT DATE = 10/21/2016	CHECKED -	REVISED -									VAR	*	ILLINOIS	27	18
				SCALE:				SHEET 18 OF 27 SHEETS STA. TO STA.				CONTRACT NO. 72J36				







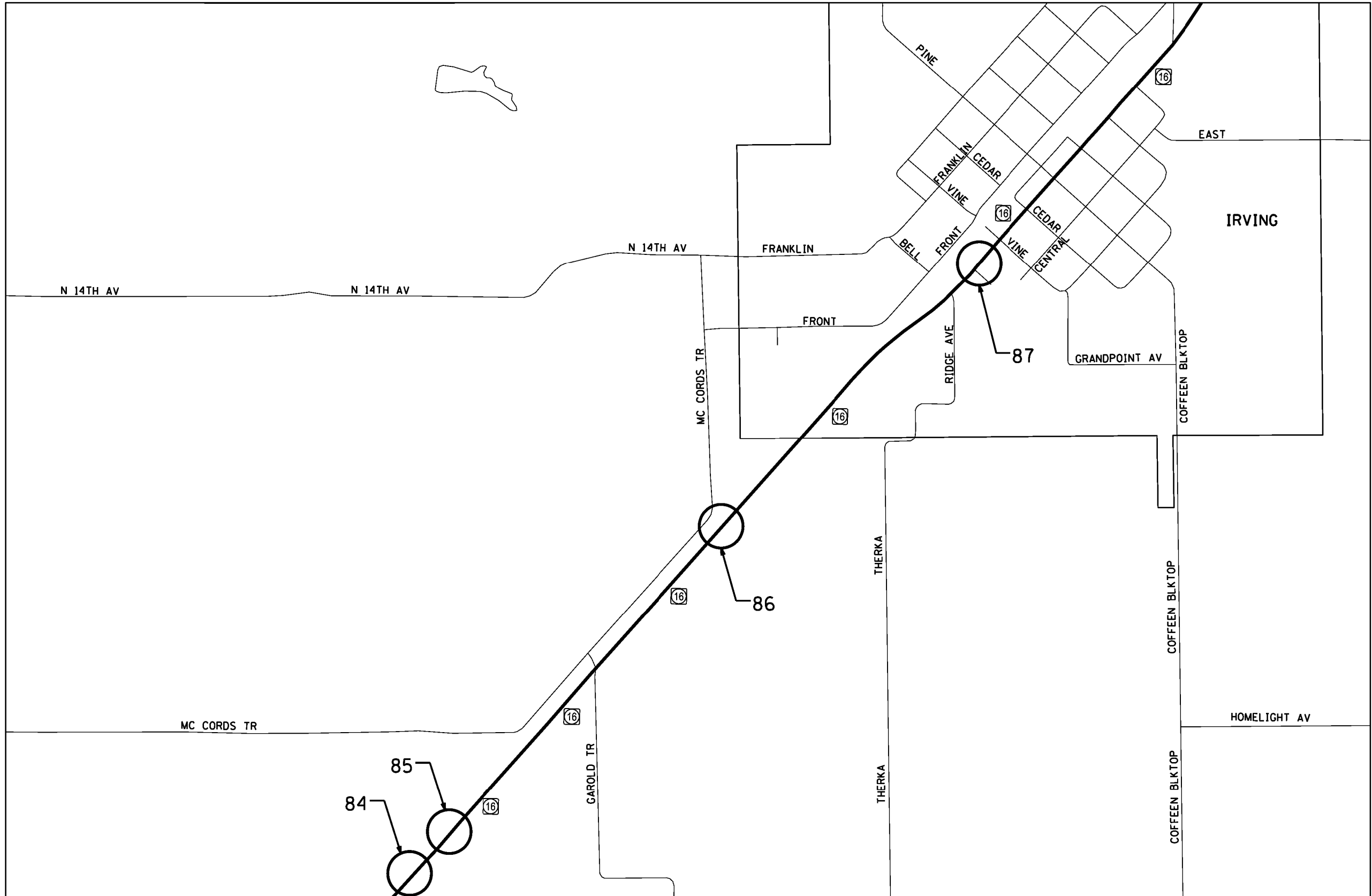

FILE NAME =	USER NAME = jackee	DESIGNED -	REVISED -
pw:\IL\084EBID\INTEG\Illinois.gov\PI\DOT\Documents\DOT Offices\District 6\Projects\D672\Drawings\6A\Sheets\D672J36-aht-Montgomery County Location Map.dwg		DRAWN -	REVISED -
Default	PLOT SCALE = 100.0000' / 1in.	CHECKED -	REVISED -
	PLOT DATE = 10/19/2016	DATE -	REVISED -

**STATE OF ILLINOIS  
DEPARTMENT OF TRANSPORTATION**

**Montgomery County Location Map**

SCALE: SHEET 22 OF 27 SHEETS STA. TO STA.

F.A. RTE.	SECTION	COUNTY	TOTAL SHEETS	SHEET NO.
	*	VARIOUS	27	22
CONTRACT NO. 72J36			ILLINOIS FED. AID PROJECT	

\* D6 GUARDRAIL END REPL 2017

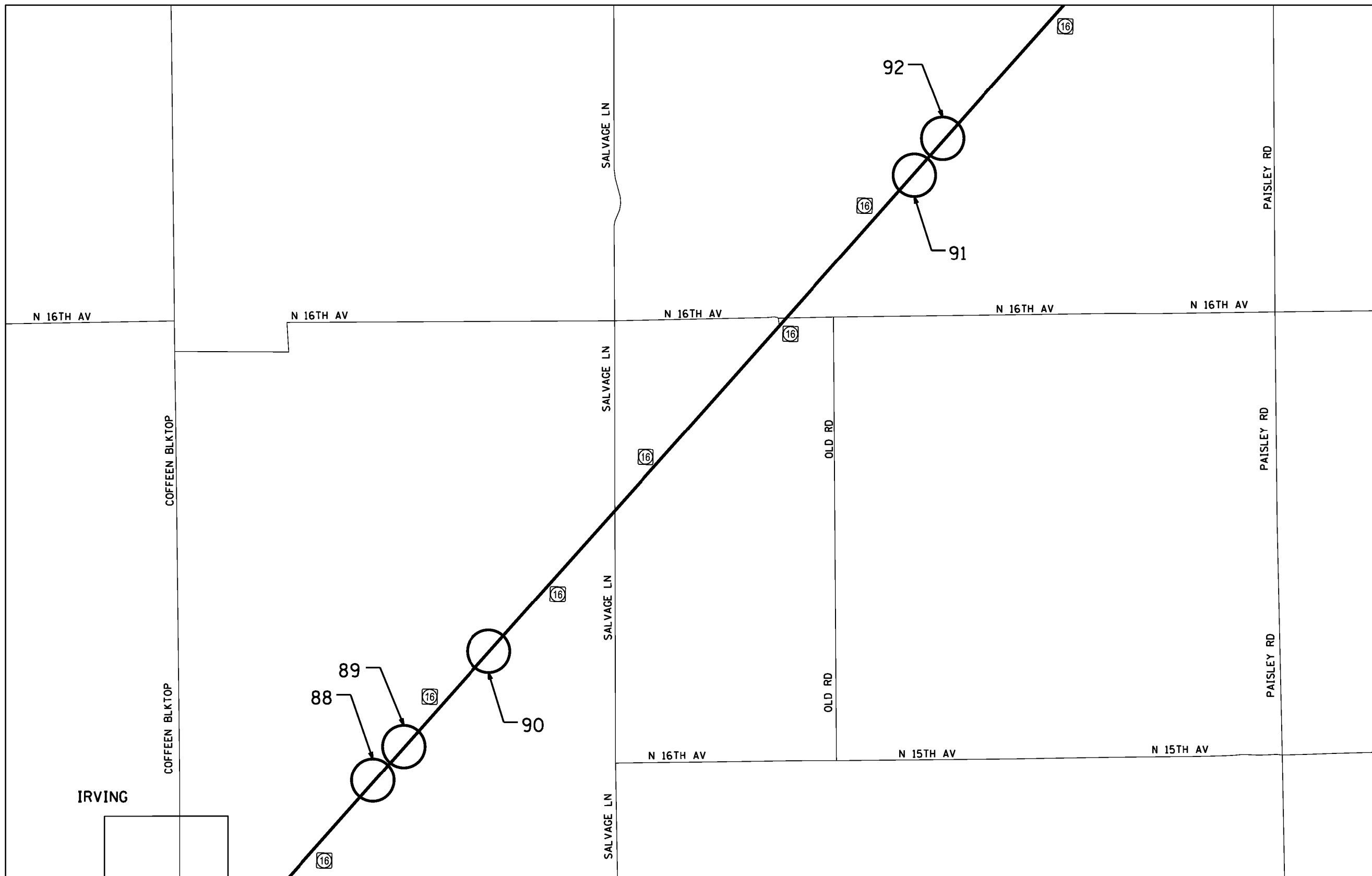

FILE NAME =	USER NAME = jackee	DESIGNED -	REVISED -
pw\j\084EBID\INTEG\illinois.gov\PI\DOT\Documents\DOT Offices\District 6\Projects\D672\Drawings\6AD\Sheets\D672J36-shr-Montgomery County		DRAWN -	REVISED -
Default	PLOT SCALE = 100.0000' / 1in.	CHECKED -	REVISED -
	PLOT DATE = 10/19/2016	DATE -	REVISED -

**STATE OF ILLINOIS  
DEPARTMENT OF TRANSPORTATION**

**Montgomery County Location Map**

SCALE: SHEET 23 OF 27 SHEETS STA. TO STA.

F.A. RTE.	SECTION	COUNTY	TOTAL SHEETS	SHEET NO.
	*	VARIOUS	27	23
CONTRACT NO. 72J36			ILLINOIS FED. AID PROJECT	

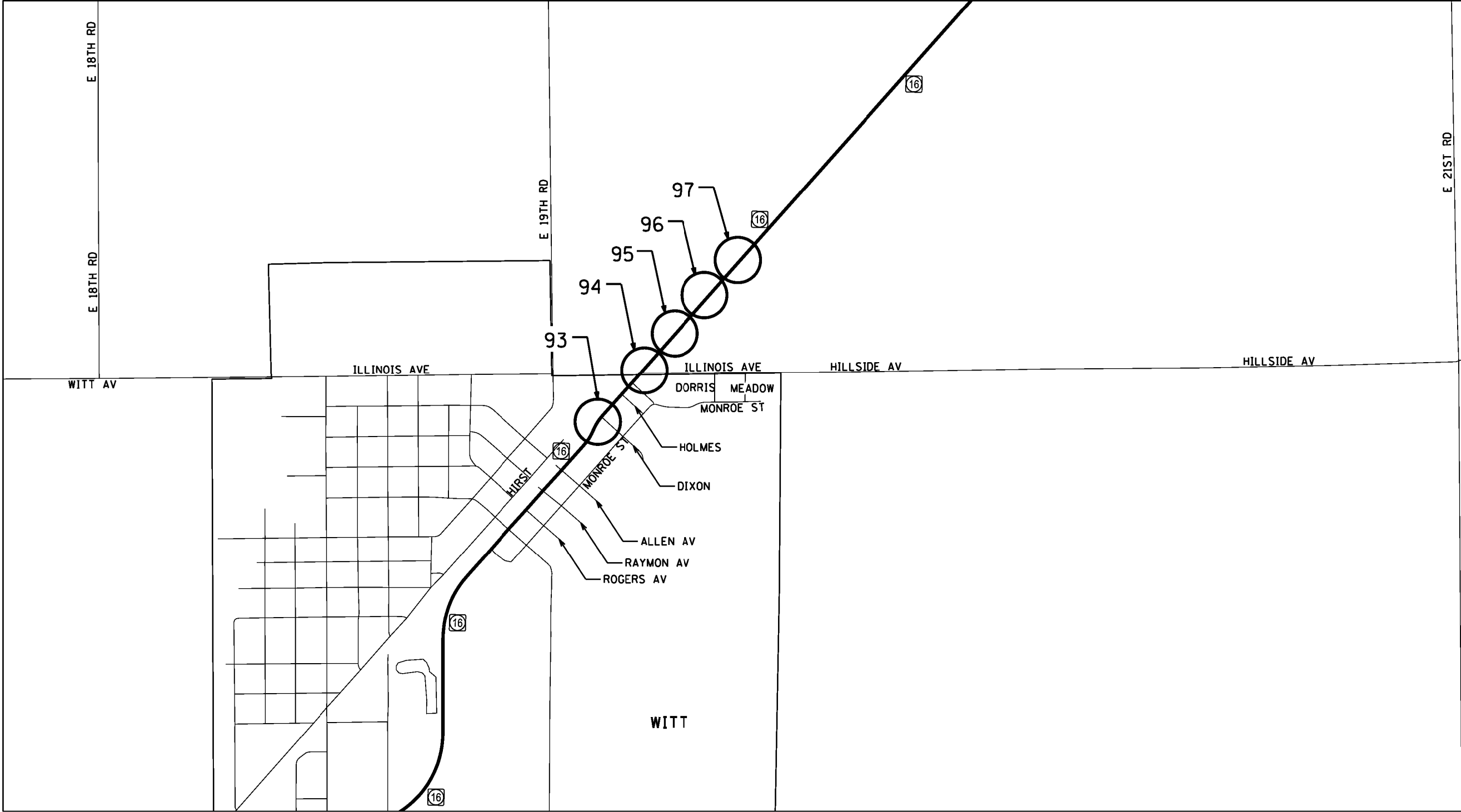

FILE NAME =	USER NAME = jackee	DESIGNED -	REVISED -
pw\j\084EBID\INTEG\illinois.gov\PW\DOT\Documents\DOT Offices\District 6\Projects\D672J36\Drawings\CAD\Sheets\D672J36-sht-Montgomery County		DRAWN -	REVISED -
Default	PLOT SCALE = 100.0000' / 1in.	CHECKED -	REVISED -
	PLOT DATE = 10/19/2016	DATE -	REVISED -

**STATE OF ILLINOIS  
DEPARTMENT OF TRANSPORTATION**

**Montgomery County Location Map**

SCALE: SHEET 24 OF 27 SHEETS STA. TO STA.

F.A. RTE.	SECTION	COUNTY	TOTAL SHEETS	SHEET NO.
	*	VARIOUS	27	24
ILLINOIS FED. AID PROJECT			CONTRACT NO. 72J36	

\* D6 GUARDRAIL END REPL 2017



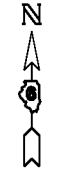
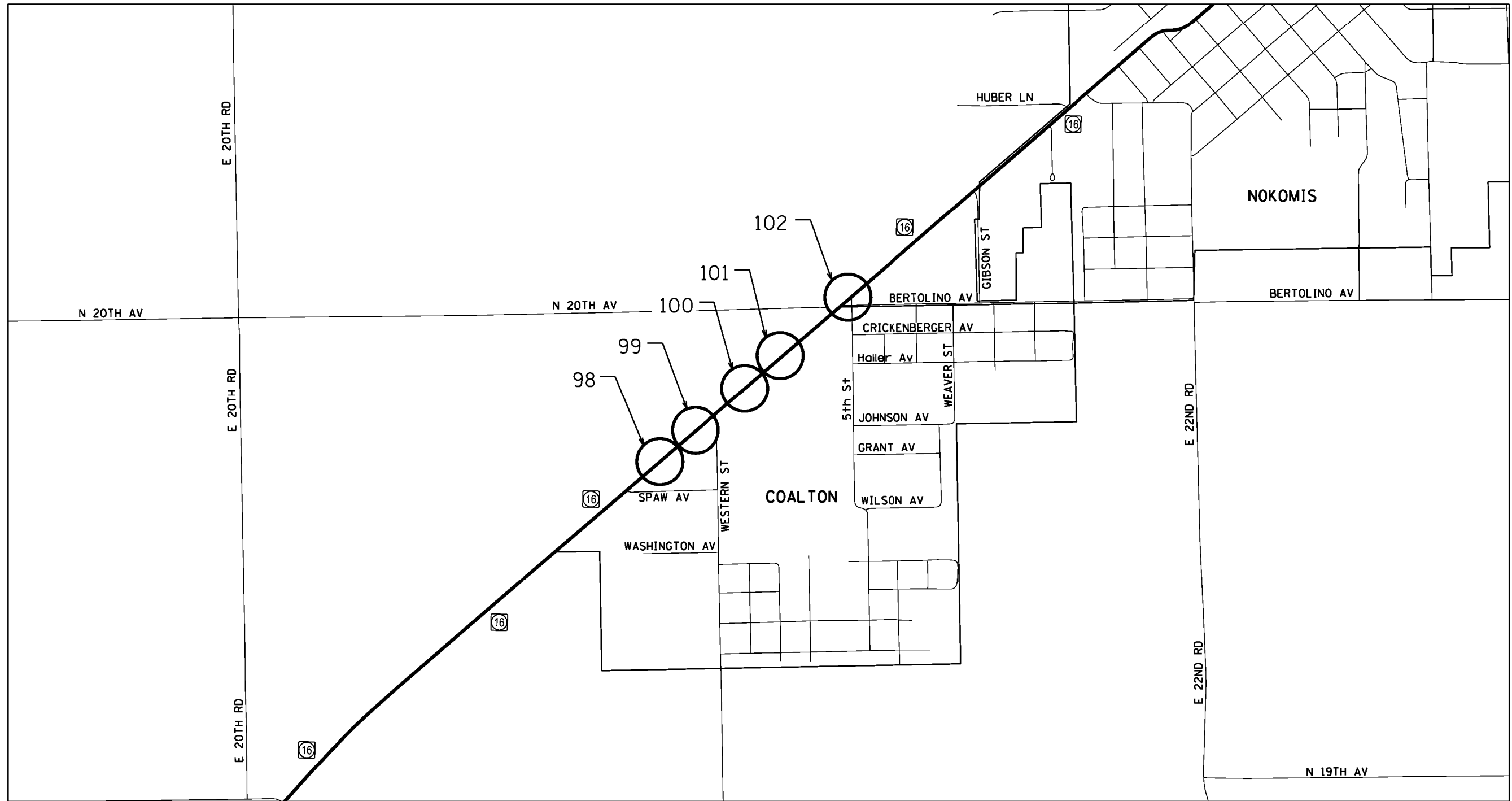

FILE NAME =	USER NAME = jackee	DESIGNED -	REVISED -
p:\11\084EBID\INTEG\illinois.gov\PWIDOT\Documents\IDOT_Offices\District_6\Projects\D672\Drawings\6AD\Sheets\6672J36-shr-MontgomeryCounty\6672J36-shr-MontgomeryCounty.dwg		DRAWN -	REVISED -
Default	PLOT SCALE = 100.0000' / 1in.	CHECKED -	REVISED -
	PLOT DATE = 10/19/2016	DATE -	REVISED -

**STATE OF ILLINOIS  
DEPARTMENT OF TRANSPORTATION**

**Montgomery County Location Map**

SCALE: SHEET 25 OF 27 SHEETS STA. TO STA.

F.A. RTE.	SECTION	COUNTY	TOTAL SHEETS	SHEET NO.
	*	VARIOUS	27	25
CONTRACT NO. 72J36				

\* D6 GUARDRAIL END REPL 2017

# MONTGOMERY COUNTY

MAP LOCATION	ID	ROUTE OR ROAD NAME	TRAVEL DIRECTION	LATITUDE	LONGITUDE	EXISTING TERMINAL TYPE	FURNISHED EXCAVATION	STEEL PLATE BEAM GUARDRAIL, TYPE A, 6 FOOT POSTS	STEEL PLATE BEAM GUARDRAIL, TYPE A, 9 FOOT POSTS	TRAFFIC BARRIER TERMINAL, TYPE 2	TRAFFIC BARRIER TERMINAL, TYPE 1 (SPECIAL) TANGENT	TRAFFIC BARRIER TERMINAL, TYPE 1 (SPECIAL) FLARED	GUARDRAIL REMOVAL	TERMINAL MARKER - DIRECT APPLIED	GUARDRAIL REFLECTORS, TYPE A	VERTICAL ADJUSTMENT OF GUARDRAIL	REMOVE AND REERECT TRAFFIC BARRIER TERMINALS, TYPE 1	WEAK POST GUARDRAIL ATTACHED TO CULVERT	LONG-SPAN GUARDRAIL OVER CULVERT, 25 FT SPAN
							20400800 CU YD	63000001 FOOT	63000003 FOOT	63100045 EACH	63100167 EACH	63100169 EACH	63200310 FOOT	72501000 EACH	78200005 EACH	X6330900 FOOT	63301990 EACH	63000031 FOOT	63000370 FOOT
75	9697	IL 16	NB	39.160232	-89.465465	Breakaway Cable Terminal w/ < 4' Flare					1		50	1	1	25			
	9698	IL 16	NB	39.160675	-89.465396	Breakaway Cable Terminal w/ < 4' Flare	15				1		50	1	1	25			
	9699	IL 16	NB	39.160782	-89.46538	Breakaway Cable Terminal w/ < 4' Flare					1		50	1	1	450			
76	9700	IL 16	NB	39.164039	-89.464374	Breakaway Cable Terminal w/ < 4' Flare					1		50	1	1				
	9701	IL 16	SB	39.164066	-89.464519	Breakaway Cable Terminal w/ < 4' Flare					1		50	1	2	125			
	9702	IL 16	NB	39.164152	-89.464204	Breakaway Cable Terminal w/ < 4' Flare					1		50	1	4				
	9703	IL 16	NB	39.164325	-89.463889	Breakaway Cable Terminal w/ < 4' Flare					1		50	1	4				
77	9704	IL 16	SB	39.164625	-89.463677	Breakaway Cable Terminal w/ < 4' Flare					1		50	1	2	25			
78	9705	IL 16	SB	39.17288	-89.448664	Breakaway Cable Terminal w/ < 4' Flare					1		50	1	1	25			
79	9707	IL 16	NB	39.177315	-89.44298	Breakaway Cable Terminal w/ < 4' Flare					1		50	1	1	25			
	9708	IL 16	SB	39.177439	-89.442982	Breakaway Cable Terminal w/ < 4' Flare					1		50	1	1	25			
	9709	IL 16	SB	39.177743	-89.442491	Breakaway Cable Terminal w/ < 4' Flare					1		50	1	1	25			
	9710	IL 16	NB	39.177695	-89.442359	Breakaway Cable Terminal w/ < 4' Flare					1		50	1	1	25			
80	9711	IL 16	NB	39.182237	-89.434896	Breakaway Cable Terminal w/ < 4' Flare					1		50	1	1	225			
	9712	IL 16	SB	39.18243	-89.434778	Breakaway Cable Terminal w/ < 4' Flare					1		50	1	1	25			
81	9713	IL 16	SB	39.182906	-89.434003	Breakaway Cable Terminal w/ < 4' Flare					1		50	1	2	162.5			
	9714	IL 16	SB	39.183101	-89.433661	Turned Down		12.5			1		62.5	1	2				
82	9715	IL 16	SB	39.183299	-89.433341	Turned Down					1		50	1	2				
	9716	IL 16	NB	39.183209	-89.433306	Breakaway Cable Terminal w/ < 4' Flare					1		50	1	2	25			
83	9717	IL 16	NB	39.183809	-89.432307	Turned Down					1		50	1	1	250			
	9718	IL 16	SB	39.184097	-89.432031	Breakaway Cable Terminal w/ < 4' Flare					1		50	1	2	12.5			
	9720	IL 16	NB	39.184229	-89.431612	Turned Down					1		50	1	1				
	9719	IL 16	SB	39.184314	-89.431679	Breakaway Cable Terminal w/ < 4' Flare					1		50	1	1	12.5			
	9725	IL 16	NB	39.187756	-89.42631	Breakaway Cable Terminal = 4' Flare					1		50	1	2				
84	9726	IL 16	SB	39.187823	-89.426416	Breakaway Cable Terminal w/ < 4' Flare					1		50	1	1	25			
	9727	IL 16	NB	39.187973	-89.426072	Breakaway Cable Terminal w/ < 4' Flare					1		50	1	2				
	9728	IL 16	SB	39.188135	-89.42605	Breakaway Cable Terminal w/ < 4' Flare					1		50	1	1	25			
	9730	IL 16	SB	39.188796	-89.425299	Breakaway Cable Terminal w/ < 4' Flare					1		50	1	1	25			
85	9731	IL 16	SB	39.18926	-89.424757	Breakaway Cable Terminal w/ < 4' Flare					1		50	1	1	25			
	9732	IL 16	NB	39.189205	-89.424632	Breakaway Cable Terminal w/ < 4' Flare					1		50	1	1	50			

# MONTGOMERY COUNTY CONT.

MAP LOCATION	ID	ROUTE OR ROAD NAME	TRAVEL DIRECTION	LATITUDE	LONGITUDE	EXISTING TERMINAL TYPE	FURNISHED EXCAVATION	STEEL PLATE BEAM GUARDRAIL, TYPE A, 6 FOOT POSTS	STEEL PLATE BEAM GUARDRAIL, TYPE A, 9 FOOT POSTS	TRAFFIC BARRIER TERMINAL, TYPE 2	TRAFFIC BARRIER TERMINAL, TYPE 1 (SPECIAL) TANGENT	TRAFFIC BARRIER TERMINAL, TYPE 1 (SPECIAL) FLARED	GUARDRAIL REMOVAL	TERMINAL MARKER - DIRECT APPLIED	GUARDRAIL REFLECTORS, TYPE A	VERTICAL ADJUSTMENT OF GUARDRAIL	REMOVE AND REERECT TRAFFIC BARRIER TERMINALS, TYPE 1	WEAK POST GUARDRAIL ATTACHED TO CULVERT	LONG-SPAN GUARDRAIL OVER CULVERT, 25 FT SPAN
							20400800 CU YD	63000001 FOOT	63000003 FOOT	63100045 EACH	63100167 EACH	63100169 EACH	63200310 FOOT	72501000 EACH	78200005 EACH	X6330900 FOOT	63301990 EACH	63000031 FOOT	63000370 FOOT
86	9734	IL 16	SB	39.196508	-89.416351	Breakaway Cable Terminal w/ < 4' Flare					1		50	1	1	37.5			
	9736	IL 16	NB	39.196694	-89.415967	Breakaway Cable Terminal w/ < 4' Flare					1		50	1	1	25			
87	9737	IL 16	SB	39.203058	-89.408004	Breakaway Cable Terminal = 4' Flare					1		50	1	1	25			
	9738	IL 16	SB	39.20331	-89.407716	Breakaway Cable Terminal = 4' Flare					1		50	1	1	25			
88	9740	IL 16	SB	39.216482	-89.393192	Breakaway Cable Terminal w/ < 4' Flare					1		50	1	1	412.5			
89	9741	IL 16	NB	39.217267	-89.39212	Breakaway Cable Terminal w/ < 4' Flare					1		50	1		462.5			
	9742	IL 16	SB	39.217505	-89.392003	Breakaway Cable Terminal w/ < 4' Flare					1		50	1	1				
90	9744	IL 16	SB	39.220462	-89.388566	Breakaway Cable Terminal w/ < 4' Flare					1		50	1	1	25			
	9745	IL 16	NB	39.221	-89.387778	Breakaway Cable Terminal w/ < 4' Flare					1		50	1	1	25			
91	9747	IL 16	NB	39.236403	-89.36986	Breakaway Cable Terminal w/ < 4' Flare					1		50	1	1	150			
92	9749	IL 16	NB	39.237219	-89.368907	Breakaway Cable Terminal w/ < 4' Flare					1		50	1	1	150			
	9750	IL 16	SB	39.237504	-89.368748	Breakaway Cable Terminal w/ < 4' Flare					1		50	1	1	350			
93	9756	IL 16	SB	39.259329	-89.343201	Breakaway Cable Terminal w/ < 4' Flare					1		50	1	1	75			
	9757	IL 16	SB	39.259828	-89.342796	Breakaway Cable Terminal w/ < 4' Flare					1		50	1	1	37.5			
	9758	IL 16	NB	39.259672	-89.3428	Breakaway Cable Terminal w/ < 4' Flare					1		50	1	1	150			
94	9759	IL 16	NB	39.26125	-89.340976	Breakaway Cable Terminal w/ < 4' Flare					1		100	1	1	175			
	9760	IL 16	SB	39.261495	-89.340865	Breakaway Cable Terminal w/ < 4' Flare		50			1		100	1	1	175			
95	9761	IL 16	SB	39.262518	-89.339673	Breakaway Cable Terminal w/ < 4' Flare					1		50	1	1	200			
	9762	IL 16	NB	39.262275	-89.339788	Breakaway Cable Terminal w/ < 4' Flare					1		50	1	1	200			
96	9763	IL 16	NB	39.263315	-89.33858	Breakaway Cable Terminal w/ < 4' Flare		12.5			1		62.5	1	1	25			
	9764	IL 16	SB	39.263559	-89.338456	Breakaway Cable Terminal w/ < 4' Flare		25			1		75	1	1	187.5			
97	9765	IL 16	SB	39.264608	-89.337239	Breakaway Cable Terminal w/ < 4' Flare					1		50	1	1	187.5			
	9766	IL 16	NB	39.26436	-89.337361	Breakaway Cable Terminal w/ < 4' Flare					1		50	1	1	25			
98	9771	IL 16	NB	39.286006	-89.309221	Breakaway Cable Terminal w/ < 4' Flare					1		50	1	1	262.5			
	9772	IL 16	SB	39.285799	-89.309716	Breakaway Cable Terminal w/ < 4' Flare					1		50	1	1	500			
99	9774	IL 16	NB	39.286621	-89.308278	Breakaway Cable Terminal w/ < 4' Flare					1		50	1	1				
100	9775	IL 16	NB	39.287988	-89.306201	Breakaway Cable Terminal w/ < 4' Flare					1		75	1	1	487.5			25
	9776	IL 16	SB	39.288257	-89.305983	Breakaway Cable Terminal w/ < 4' Flare					1		75	1	1	187.5			25
101	9777	IL 16	SB	39.289073	-89.304735	Breakaway Cable Terminal w/ < 4' Flare					1		50	1	1	187.5			
	9778	IL 16	NB	39.288894	-89.304827	Breakaway Cable Terminal w/ < 4' Flare					1		50	1	1	25			
102	9779	IL 16	SB	39.290829	-89.302066	Breakaway Cable Terminal w/ < 4' Flare					1		50	1	1	25			25
<b>TOTALS</b>							<b>15</b>	<b>100</b>	<b>-</b>	<b>-</b>	<b>61</b>	<b>-</b>	<b>3250</b>	<b>61</b>	<b>75</b>	<b>6438</b>	<b>-</b>	<b>-</b>	<b>75</b>

FILE NAME =	USER NAME = jacks	DESIGNED -	REVISED -	<b>STATE OF ILLINOIS</b>	<b>Montgomery County Schedule</b>	F.A. RTE.	SECTION	COUNTY	TOTAL SHEETS	SHEET NO.
p:\IL\084EBID\INTEG\illinois.gov\PI\DOT\Documents\DOT Offices\District 6\Projects\0672\Drawings\6A\Sheets\0672J36-shr-Montgomery				<b>DEPARTMENT OF TRANSPORTATION</b>						
Default	PLOT SCALE = 100.0000' / 1in.	CHECKED -	REVISED -	SCALE:      SHEET 27 OF 27 SHEETS      STA.      TO STA.						
	PLOT DATE = 10/21/2016	DATE -	REVISED -	ILLINOIS FED. AID PROJECT						