

100% STATE

CONSTR. CODE

CODE NO.	ITEM	UNIT	TOTAL QUANTITY	ROADWAY
				0005 RURAL
40300200	BITUMINOUS MATERIALS (PRIME COAT)	TON	32	32
40300400	BITUMINOUS MATERIALS (COVER AND SEAL COATS)	TON	59	59
40300500	COVER COAT AGGREGATE	TON	201	201
40300600	SEAL COAT AGGREGATE	TON	201	201
40600275	BITUMINOUS MATERIALS (PRIME COAT)	POUND	12896	12896
40603315	HOT-MIX ASPHALT SURFACE COURSE, MIX "C", N70	TON	43	43
44000155	HOT-MIX ASPHALT SURFACE REMOVAL, 1 1/2"	SQ YD	4120	4120
67100100	MOBILIZATION	LSUM	1	1
70100460	TRAFFIC CONTROL AND PROTECTION, STANDARD 701306	LSUM	1	1
70102620	TRAFFIC CONTROL AND PROTECTION, STANDARD 701501	LSUM	1	1
* 78001110	PAINT PAVEMENT MARKING - LINE 4"	FOOT	24548	24548
* 78100100	RAISED REFLECTIVE PAVEMENT MARKER	EACH	20	20
78300200	RAISED REFLECTIVE PAVEMENT MARKER REMOVAL	EACH	20	20
X7810400	TEMPORARY RAISED PAVEMENT MARKER	EACH	583	583

* SPECIALTY ITEM

FILE NAME =	USER NAME =	DESIGNED -	REVISED -	STATE OF ILLINOIS DEPARTMENT OF TRANSPORTATION	SUMMARY OF QUANTITIES				RTE.	SECTION	COUNTY	TOTAL SHEETS	SHEET NO.
path\11084E81DINTEG\illinois.gov\PIDOT\Documents\DOT Office\District 8\Projects\0876-DISTRICT 8\DATA\EAData\0876J75-shr-plan.dwg	PROJECT =	CHECKED -	REVISED -		SCALE:	SHEET 1	OF 1	SHEETS	STA.	TO STA.	WASHINGTON	13	3
	PLOT SCALE = 100.0000 / / in.	DATE -	REVISED -		CONTRACT NO. 76J75								
	PLOT DATE = 11/2/2016				ILLINOIS FED. AID PROJECT								

R 5 W

R 4 W

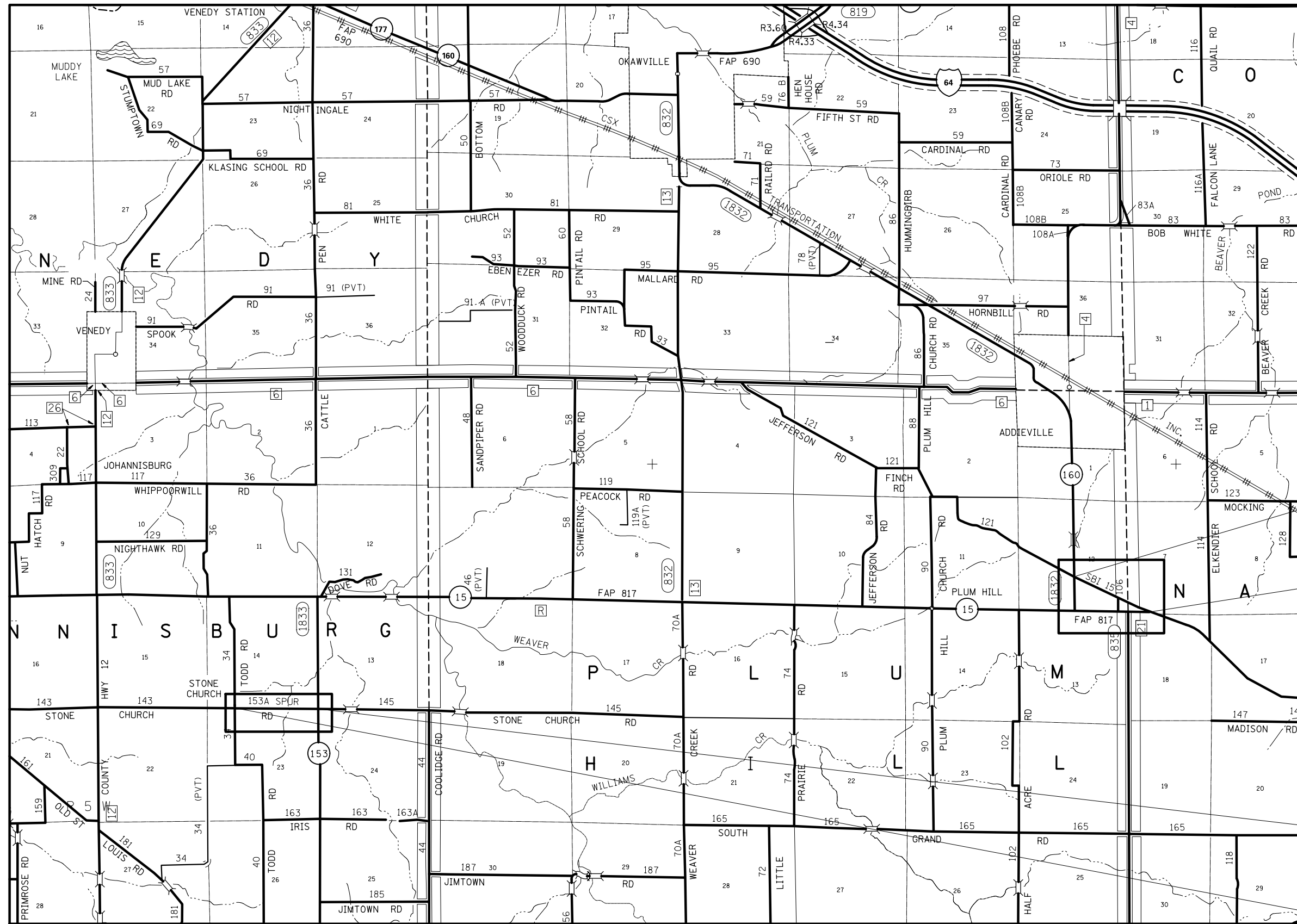

LOCATION 2 BEGIN PROJECT
IL 160
LAT: 38.366894
LONG: -89.486067

LOCATION 2 END PROJECT
IL 15
LAT: 38.361672
LONG: -89.473301

LOCATION 1 END PROJECT
IL 153
LAT: 38.350255
LONG: -89.611563

LOCATION 1 BEGIN PROJECT
TODD ROAD
LAT: 38.350382
LONG: -89.625606

FILE NAME =	USER NAME = manntm	DESIGNED -	REVISED -
pw\11084EBIDINTEG\illinois.gov\PIDOT\Documents\DOT Offices\District 8\Projects\0875\DRAWING\0875\0875-sht-plat.dwg		CHECKED -	REVISED -
#MODELNAME#	PLOT DATE = 10/17/2016	DATE -	REVISED -

**STATE OF ILLINOIS
DEPARTMENT OF TRANSPORTATION**

**LOCATION 1 - STONE CHURCH ROAD
LOCATION 2 - RAVEN ROAD**

SCALE: NONE SHEET 1 OF 3 SHEETS STA. TO STA.

RTE.	SECTION	COUNTY	TOTAL SHEETS	SHEET NO.
VAR	DIST 8 RESURFACING 2017-2	WASHINGTON	13	5
			CONTRACT NO. 76J75	

ILLINOIS FED. AID PROJECT

R 1 W

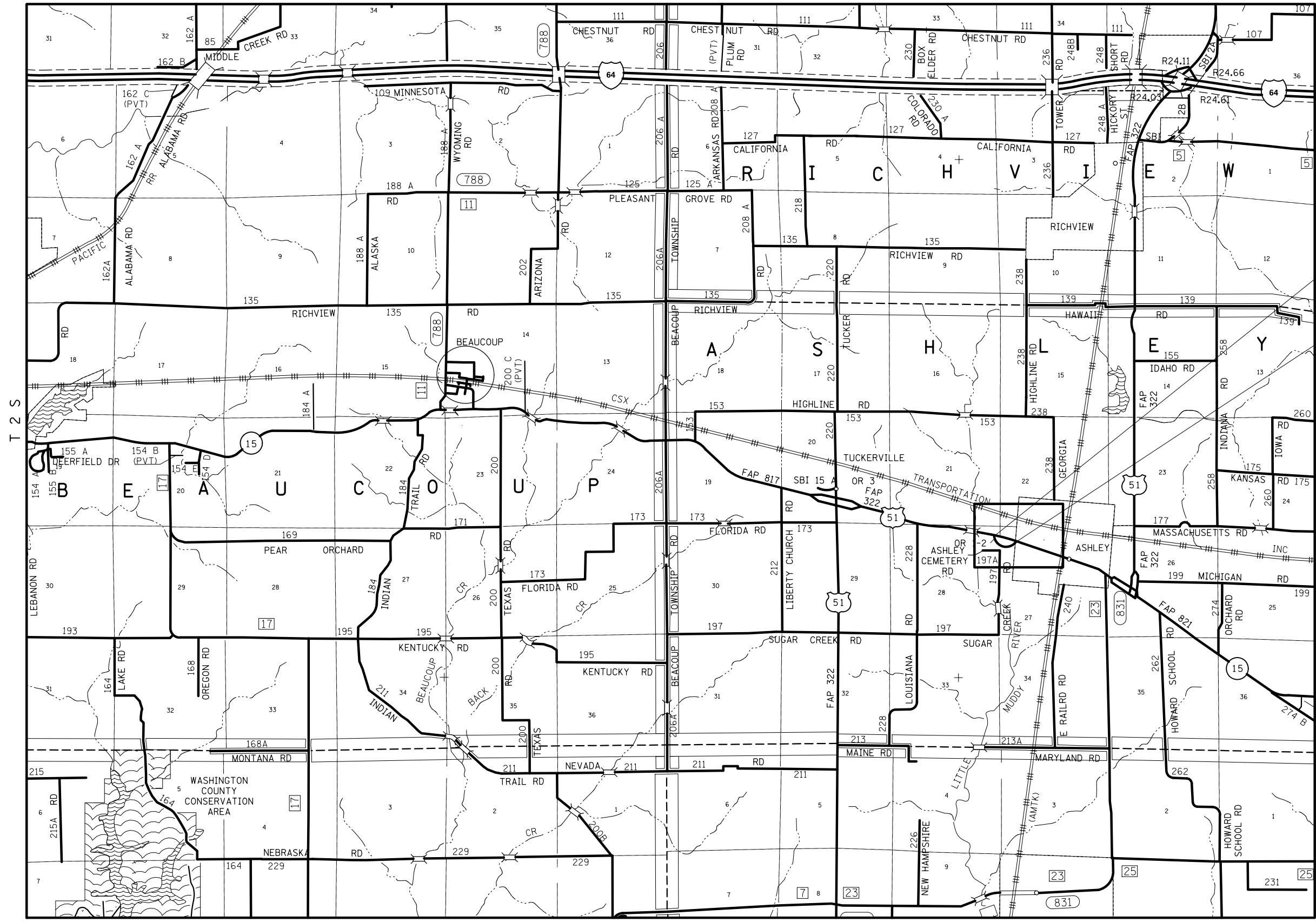

LOCATION 3 BEGIN PROJECT
 IL 15/US 51
 LAT: 38.330214
 LONG: -89.202537

LOCATION 3 END PROJECT
 IL 15/US 51
 LAT: 38.328905
 LONG: -89.197664



R 2 W

FILE NAME =	USER NAME = manntm	DESIGNED -	REVISED -
p:\IL\084EBIDINTEG\illinois.gov\PIWIDOT\Documents\IDOT Offices\District 8\Projects\0875\DRAWING\084EBIDINTEG\0875-sht-plat.dwg		CHECKED -	REVISED -
#MODELNAME#	PLOT DATE = 10/17/2016	DATE -	REVISED -

**STATE OF ILLINOIS
 DEPARTMENT OF TRANSPORTATION**

LOCATION 3 - VERMONT ROAD

SCALE: NONE SHEET 2 OF 3 SHEETS STA. TO STA.

RTE.	SECTION	COUNTY	TOTAL SHEETS	SHEET NO.
VAR	DIST 8 RESURFACING 2017-2	WASHINGTON	13	6
			CONTRACT NO. 76J75	
ILLINOIS FED. AID PROJECT				

R 5 W

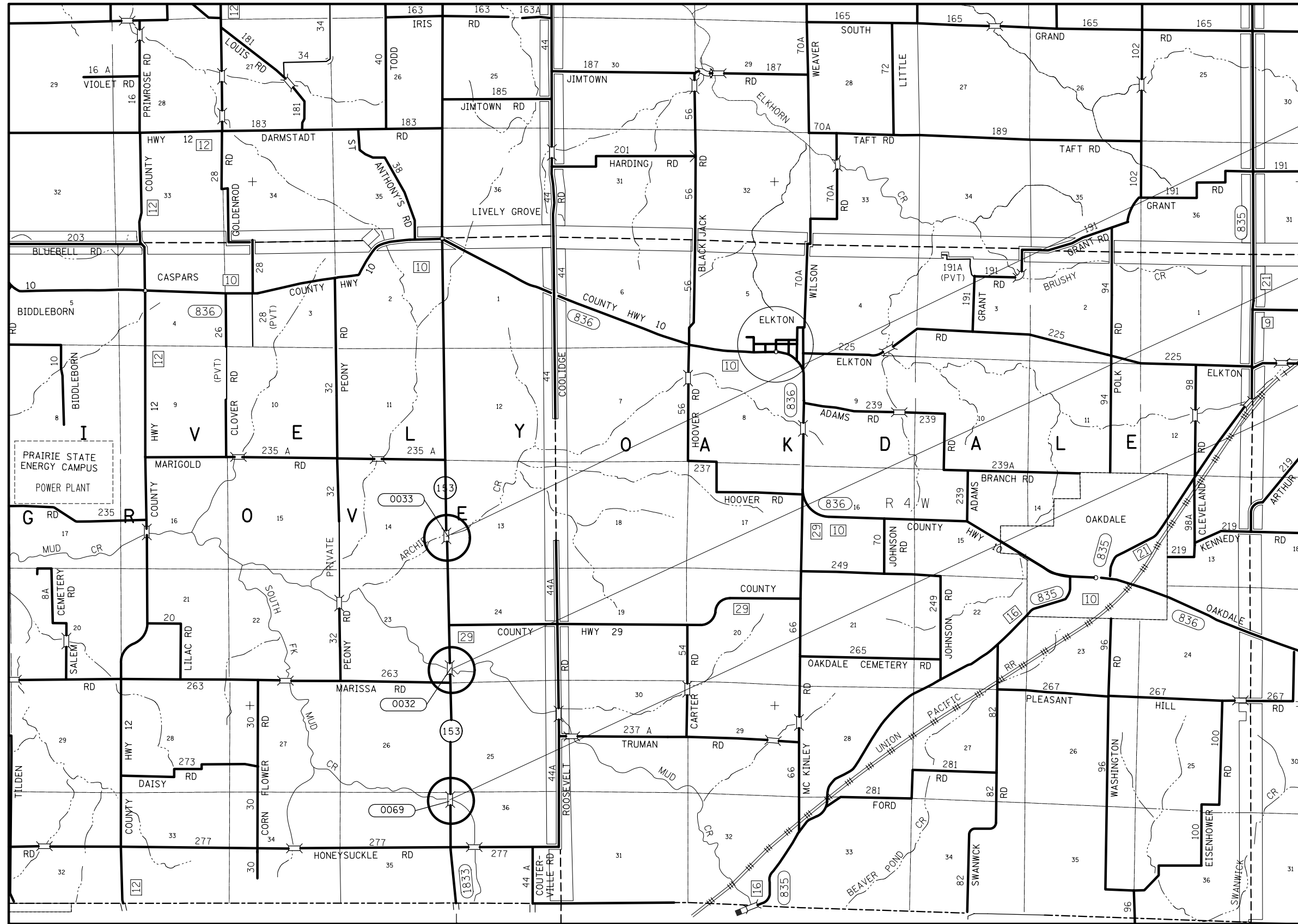

LOCATION 4
 SN 095-0033
 LAT: 38.266568
 LONG: -89.611307

LOCATION 5
 SN 095-0032
 LAT: 38.249573
 LONG: -89.611031

LOCATION 6
 SN 095-0069
 LAT: 38.233178
 LONG: -89.611099



T 3 S

R 4 W

FILE NAME =	USER NAME = manntm	DESIGNED -	REVISED -
p:\1\084EBID\INTEG\illinois.gov\PIWIDOT\Documents\DOT Offices\District 8\Projects\0876\DRAWING\DATA\EA\Sheets\0876J75-sht.pln		CHECKED -	REVISED -
		DATE -	REVISED -
MODELNAME	PLOT DATE = 10/17/2016		

**STATE OF ILLINOIS
 DEPARTMENT OF TRANSPORTATION**

**LOCATION 4 - SN 095-0033. LOCATION 5 - SN 095-0032
 AND LOCATION 6 - SN 095-0069.**

SCALE: NONE SHEET 3 OF 3 SHEETS STA. TO STA.

RTE.	SECTION	COUNTY	TOTAL SHEETS	SHEET NO.
VAR	DIST 8 RESURFACING 2017-2	WASHINGTON	13	7
			CONTRACT NO. 76J75	
ILLINOIS FED. AID PROJECT				

NOT TO SCALE

 BITUMINOUS SURFACE TREATMENT A-2

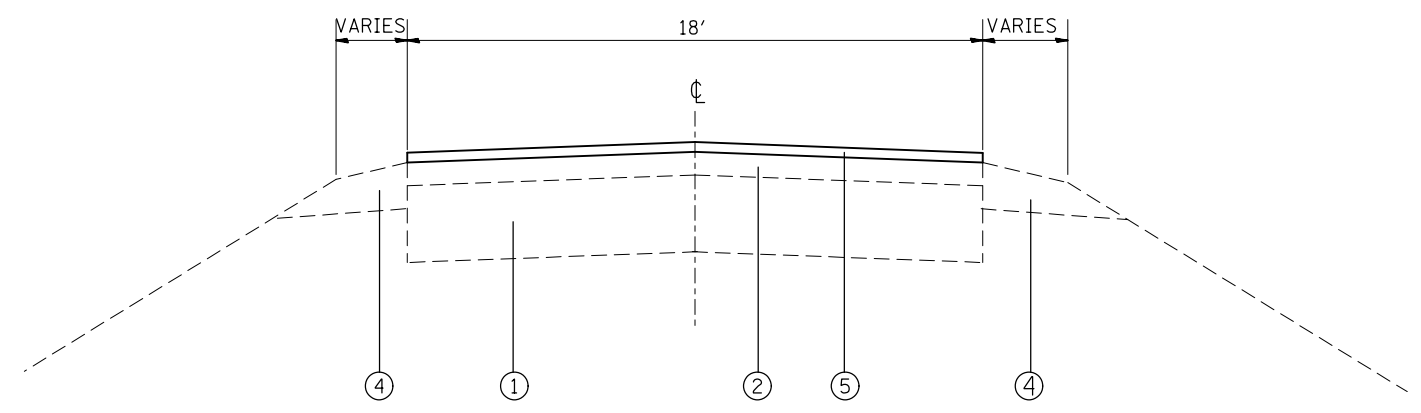
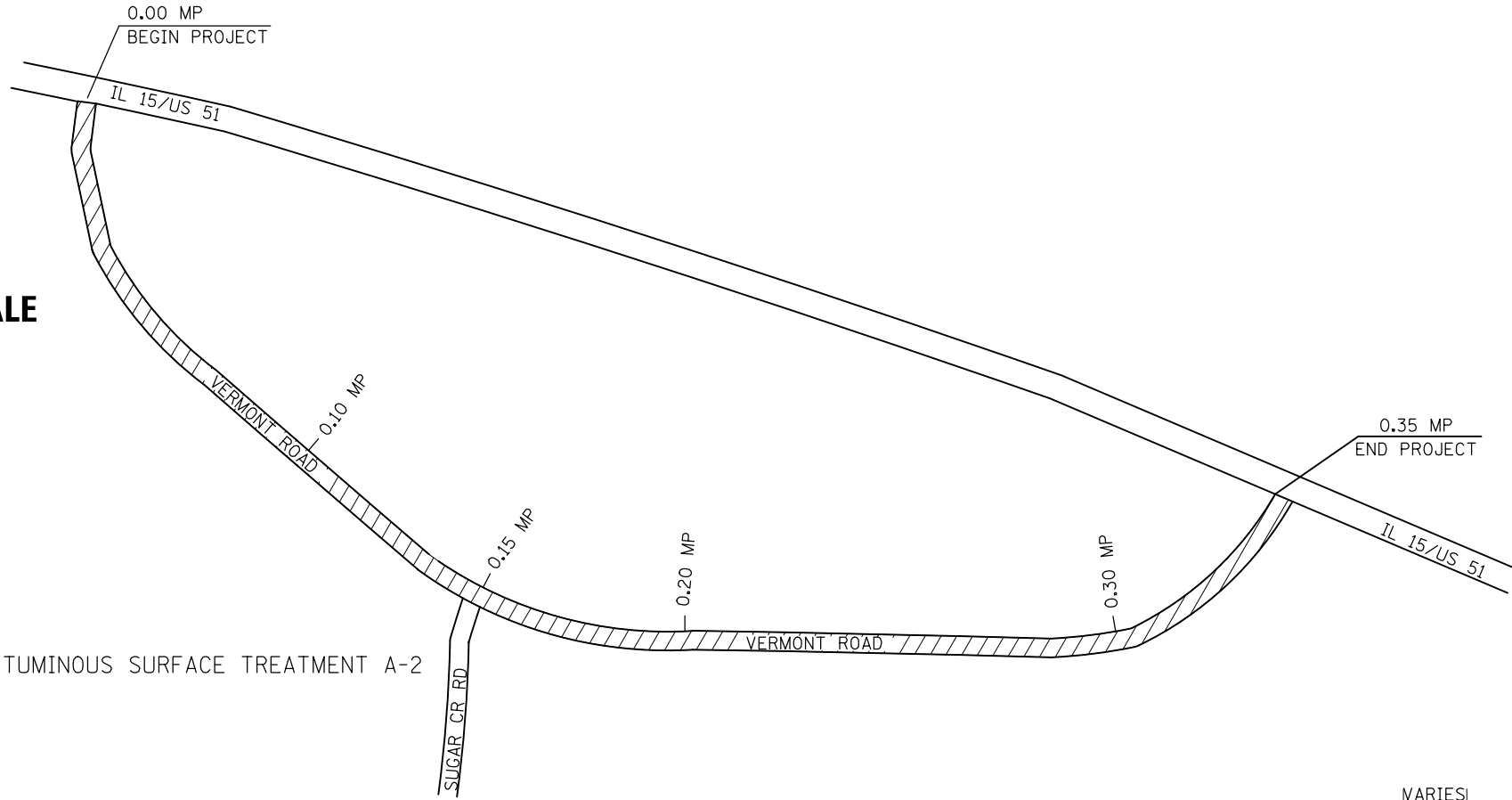

TYPICAL SECTION

LEGEND

- ① EXISTING PAVEMENT
- ② EXISTING RESURFACING
- ③ EXISTING HMA SHOULDER
- ④ EXISTING AGGREGATE SHOULDER
- ⑤ PROPOSED BITUMINOUS SURFACE TREATMENT, CLASS A-2

FILE NAME =	USER NAME = manntm	DESIGNED -	REVISED -
pw:\IL084EBIDINTEG\illinois.gov\PWIDOT\Documents\IDOT Offices\District 8\Projects\0875-DRAWING\DATA\EA0sheets\0875-sht-plan.dwg		CHECKED -	REVISED -
MODELNAME	PLOT DATE = 10/17/2016	DATE -	REVISED -

STATE OF ILLINOIS
DEPARTMENT OF TRANSPORTATION

TYPICAL SECTION AND PLAN
VERMONT ROAD - LOCATION 3

SCALE: NONE SHEET 3 OF 6 SHEETS STA. TO STA.

RTE.	SECTION	COUNTY	TOTAL SHEETS	SHEET NO.
VAR	DIST8 RESURFACING 2017-2	WASHINGTON	13	10
			CONTRACT NO. 76J75	

ILLINOIS FED. AID PROJECT

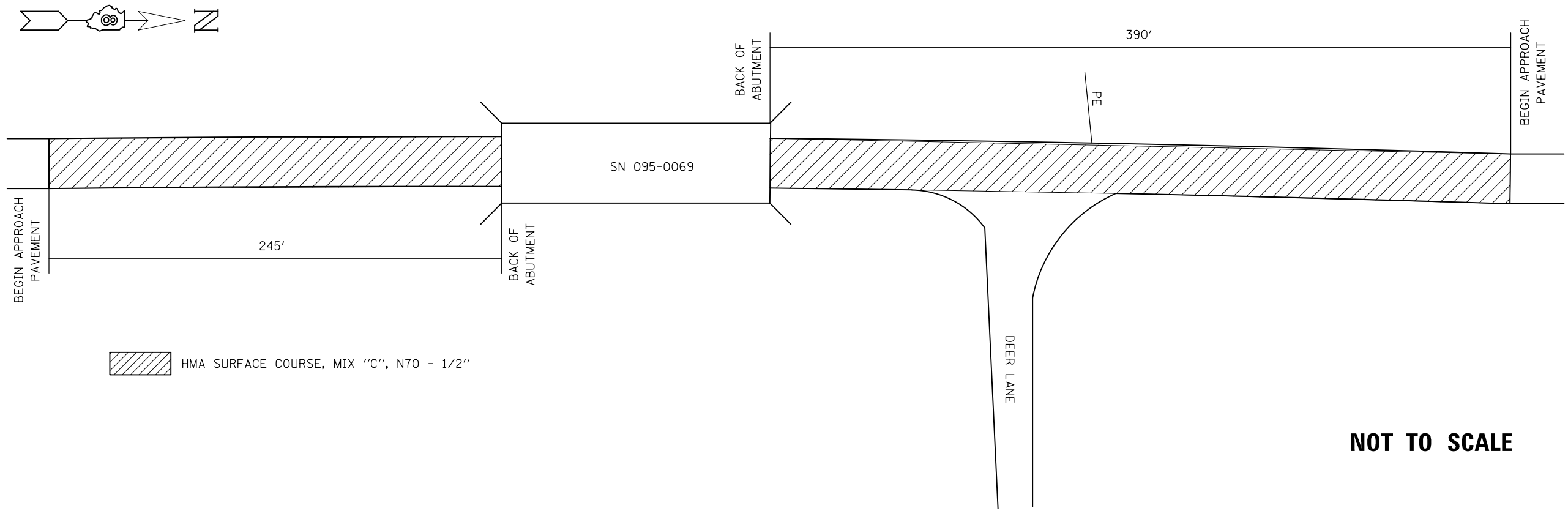

 HMA SURFACE COURSE, MIX "C", N70 - 1/2"

NOT TO SCALE

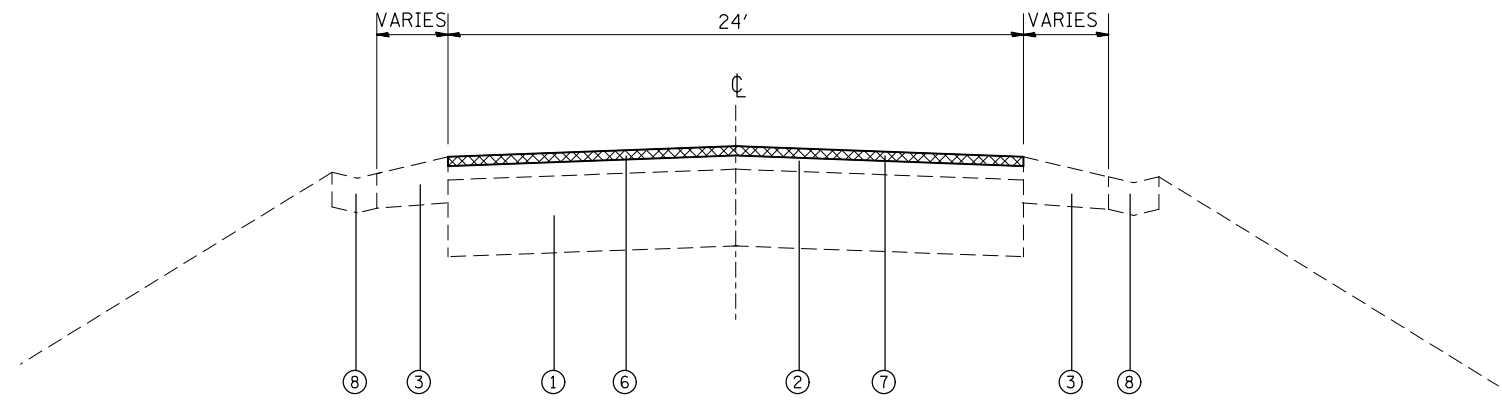

TYPICAL SECTION

LEGEND

- ① EXISTING PAVEMENT
- ② EXISTING RESURFACING
- ③ EXISTING HMA SHOULDER
- ④ EXISTING AGGREGATE SHOULDER
- ⑤ PROPOSED BITUMINOUS SURFACE TREATMENT, CLASS A-2
- ⑥ HMA SURFACE REMOVAL - 1 1/2 "
- ⑦ HMA SURFACE COURSE, MIX "C", N70 - 1 1/2 "
- ⑧ EXISTING CONCRETE GUTTER

FILE NAME =	USER NAME = manntm	DESIGNED -	REVISED -	STATE OF ILLINOIS DEPARTMENT OF TRANSPORTATION	TYPICAL SECTION AND PLAN SN 095-0069 - LOCATION 6		RTE.	SECTION	COUNTY	TOTAL SHEETS	SHEET NO.
pw:\IL\084EBIDINTEG.illinois.gov\PWIDOT\Documents\DOT Offices\District 8\Projects\0875-DRAWING\DATA\6A\Sheets\0875-sht-plan.dwg		DRAWN -	REVISED -		VAR	DIST8 RESURFACING 2017-2	WASHINGTON	13	13		
#MODELNAME#	PLOT SCALE = 100.0000' / 1in.	CHECKED -	REVISED -		SCALE: NONE SHEET 6 OF 6 SHEETS STA. TO STA.			CONTRACT NO. 76J75			
	PLOT DATE = 10/17/2016	DATE -	REVISED -		ILLINOIS FED. AID PROJECT						