

STATE OF ILLINOIS  
DEPARTMENT OF TRANSPORTATION  
DIVISION OF HIGHWAYS

**PROPOSED  
HIGHWAY PLANS**

FAU ROUTE 9105 (SALISBURY ST.)  
SECTION 119B-1DS-2  
MCKINLEY BRIDGE  
DECK SEALING  
MADISON COUNTY, IL  
CITY OF ST. LOUIS, MO

C-98-007-15

F.A.U. RTE.	SECTION	COUNTY	TOTAL SHEETS	SHEET NO.
9105	119B-1DS-2	MADISON	15	1
		ILLINOIS	CONTRACT NO. 76H54	

FOR INDEX OF SHEETS, SEE SHEET NO. 2

**TRAFFIC DATA**

2014 ADT = 15,800 (ACTUAL)  
2016 ADT = 16,100 (ESTIMATED)  
SU = 2.8%  
MU = 7.0%

**DESIGN DESIGNATION**

NA

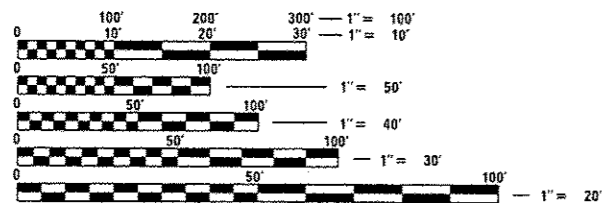

FULL SIZE PLANS HAVE BEEN PREPARED USING STANDARD ENGINEERING SCALES. REDUCED SIZED PLANS WILL NOT CONFORM TO STANDARD SCALES. IN MAKING MEASUREMENTS ON REDUCED PLANS, THE ABOVE SCALES MAY BE USED.

J.U.L.I.E.  
JOINT UTILITY LOCATION INFORMATION FOR EXCAVATION  
1-800-892-0123  
OR 811

PROJECT LOCATION  
McKINLEY BRIDGE  
SN 060-6002  
STA. 100+00  
LATITUDE: 38.66511  
LONGITUDE: -90.18257

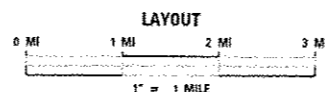
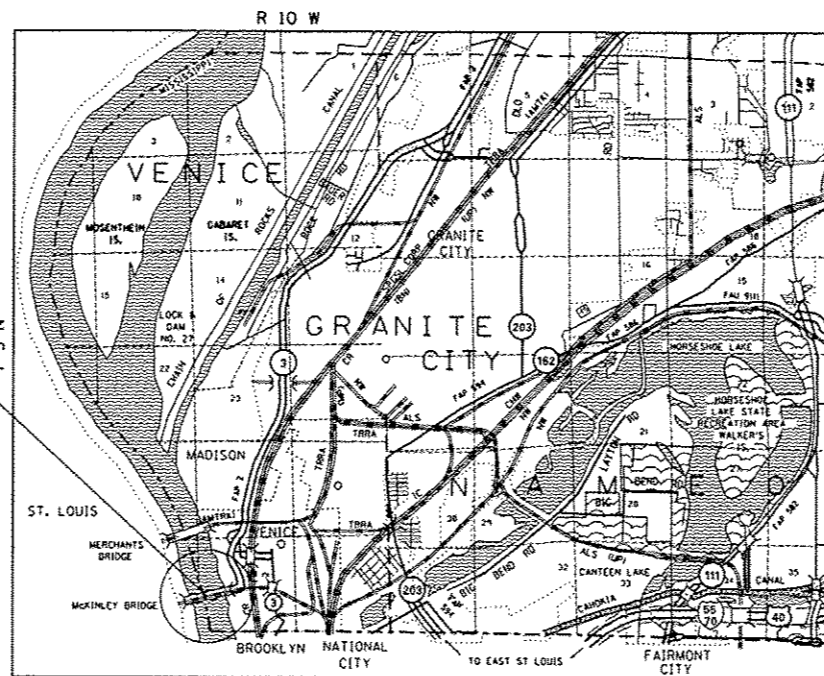

GROSS LENGTH = 5,734.25 FT. = 1.086 MILE  
NET LENGTH = 5,734.25 FT. = 1.086 MILE

PROJECT ENGINEER: HERVE GELIN (618) 346-3179  
SQUAD LEADER: BILLIE OWEN (618) 346-3209

CONTRACT NO. 76H54

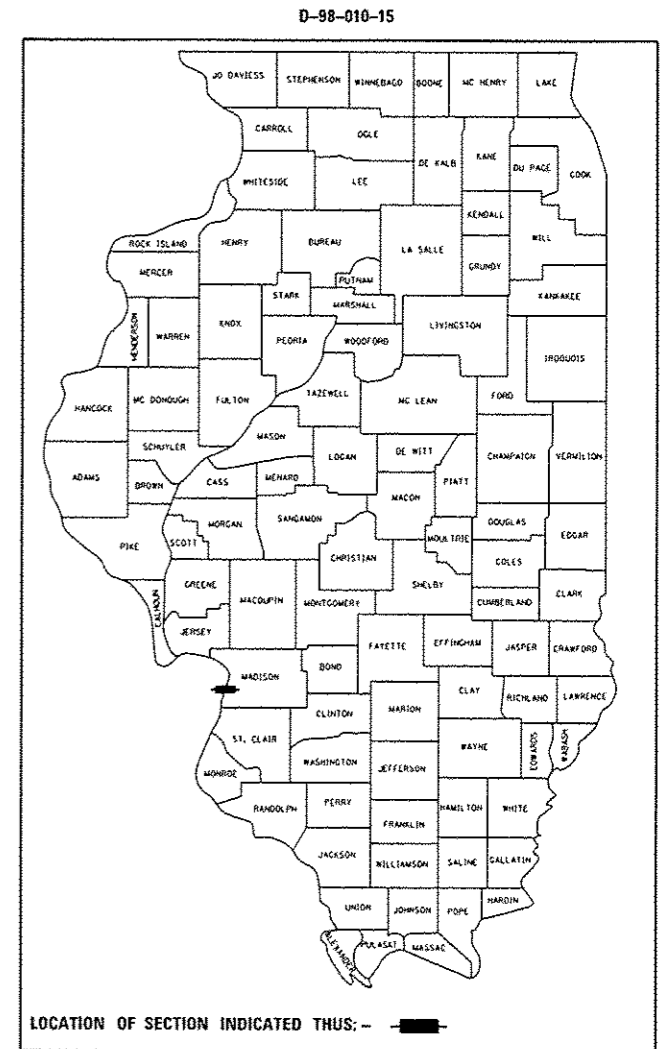

LOCATION OF SECTION INDICATED THUS: - [thick black line] -

STATE OF ILLINOIS  
DEPARTMENT OF TRANSPORTATION

SUBMITTED Oct 14 2016  
Jeffrey Z. Kamars  
REGIONAL ENGINEER

Dec 9 2016  
Maureen M. Addis P.E.  
ENGINEER OF DESIGN AND ENVIRONMENT

Dec 9 2016  
Amelia [Signature]  
DIRECTOR OF PROGRAM DEVELOPMENT

PRINTED BY THE AUTHORITY  
OF THE STATE OF ILLINOIS

INDEX OF SHEETS

- 1 COVER SHEET
- 2 INDEX OF SHEETS, HIGHWAY STANDARDS,  
GENERAL NOTES & COMMITMENTS
- 3 SUMMARY OF QUANTITIES
- 4-9 TYPICAL SECTIONS
- 10 SCHEDULE OF QUANTITIES
- 11 EXISTING PLAN AND ELEVATION
- 12-15 TRAFFIC CONTROL DETAILS

STANDARDS

- 000001-06 STANDARD SYMBOLS, ABBREVIATIONS AND PATTERNS
- 001006 DECIMAL OF AN INCH AND OF A FOOT
- 701901-06 TRAFFIC CONTROL DEVICES
- BLR 21-9 TYPICAL APPLICATION OF TRAFFIC CONTROL DEVICES  
FOR CONSTRUCTION ON RURAL LOCAL HIGHWAYS

COMMITMENTS

NO COMMITMENTS

GENERAL NOTES

1. ILLINOIS STATE LAW REQUIRES A 48-HOUR NOTICE TO BE GIVEN TO UTILITIES BEFORE DIGGING. FIELD MARKING OF FACILITIES MAY BE OBTAINED BY CONTACTING J.U.L.I.E. (1-800-892-0123 OR 811) OR FOR NON-MEMBERS THE UTILITY COMPANY DIRECTLY.
2. PLAN DIMENSIONS AND DETAILS RELATIVE TO THE EXISTING STRUCTURE AND ROADWAY HAVE BEEN TAKEN FROM EXISTING PLANS AND ARE SUBJECT TO CONSTRUCTION VARIATIONS. IT SHALL BE THE RESPONSIBILITY OF THE CONTRACTOR TO VERIFY SUCH DIMENSIONS AND DETAILS IN THE FIELD AND MAKE NECESSARY APPROVED ADJUSTMENTS PRIOR TO CONSTRUCTION OR ORDERING OF MATERIALS. SUCH VARIATIONS SHALL NOT BE CAUSE FOR ADDITIONAL COMPENSATION FOR A CHANGE IN THE SCOPE OF WORK.
3. EXISTING PAVEMENT MARKING SHALL BE TEMPORARILY COVERED PRIOR TO APPLICATION OF THE DECK SURFACE TREATMENT, ACCORDING TO THE ENGINEER SPECIFICATION, TO PREVENT THE CONCRETE SEALER FROM BEING APPLIED TO THE MARKINGS AND TO PROTECT THE REFLECTIVE PROPERTIES OF THE MARKINGS. THE TEMPORARY COVERING MATERIAL USED SHALL BE SUCH THAT IT WILL NOT AFFECT THE MARKINGS REFLECTIVITY WHEN REMOVED AFTER APPLICATION OF THE DECK SURFACE TREATMENT AND PRIOR TO OPENING TO TRAFFIC. THE COST IS INCLUDED IN THE BRIDGE DECK CONCRETE SEALER AND NO ADDITIONAL COMPENSATION WILL BE ALLOWED.
4. THE DEPARTMENT STRONGLY ENCOURAGES THE PRIME CONTRACTOR AND THEIR APPROVED SUB-CONTRACTORS TO HIRE MINORITY, WOMEN AND DISADVANTAGED INDIVIDUALS FROM ITS FEDERALLY FUNDED HIGHWAY CONSTRUCTION CAREERS TRAINING PROGRAM (HCCTP) TO HELP MEET WORKFORCE AND TRAINEE GOALS. THIS PROGRAM IS TRAINING MINORITIES, WOMEN AND DISADVANTAGED INDIVIDUALS IN HIGHWAY CONSTRUCTION-RELATED SKILLS, E.G., MATH FOR THE TRADES, JOB READINESS, TECHNICAL SKILLS COURSEWORK (CARPENTRY, CONCRETE FLATWORK, BLUEPRINT READING, SITE PLANS, SITE WORK, TOOLS USE, ETC.) AND OSHA 10 HOUR CERTIFICATION, TO PREPARE THEM FOR A CAREER IN THE HIGHWAY CONSTRUCTION TRADES. GRADUATES ARE WELL-TRAINED AND READY TO BECOME PRODUCTIVE ENTRY-LEVEL CONSTRUCTION WORKERS. CONTACT THE DISTRICT B EEO OFFICE AT 618-346-3360 AND/OR THE HCCTP COORDINATOR AT 618-874-6528 TO LEARN MORE ABOUT THE PROGRAM AND FOR ASSISTANCE IN MEETING WORKFORCE AND TRAINEE GOALS.
5. SIX CHANGEABLE MESSAGE BOARDS SHALL BE REQUIRED FOR THIS PROJECT. THEY SHALL BE PLACED TWO WEEKS PRIOR TO ANY LANE CLOSURE AND SHALL REMAIN UP FOR THE DURATION OF THE PROJECT. THE CHANGEABLE MESSAGE BOARDS SHALL BE PLACED AT THE DIRECTION OF THE ENGINEER. THE COST IS INCLUDED IN TRAFFIC CONTROL AND PROTECTION SPECIAL AND NO ADDITIONAL COMPENSATION WILL BE ALLOWED.
6. THE BIKE TRAIL SHALL NOT BE SEALED.
7. THE CANTILEVERED LANES ON THE MAIN SPAN, STA. 92+17.5 TO STA. 107+82.5, SHALL NOT BE SEALED.
8. THE GAP BETWEEN THE IMPACT ATTENUATORS FROM STA. 89+94 TO STA. 90+57 AND FROM STA. 109+47.5 TO STA. 110+12.5 SHALL BE SEALED.

FILE NAME *	USER NAME * ogbooleto	DESIGNED -	REVISED -	<b>STATE OF ILLINOIS DEPARTMENT OF TRANSPORTATION</b>	<b>INDEX OF SHEETS, HIGHWAY STANDARDS, GENERAL NOTES &amp; COMMITMENTS</b>	F.A.U. RTE.	SECTION	COUNTY	TOTAL SHEETS	SHEET NO.	
PROJECT * 11084EBIDINTEG.illinois.gov#P100T100	PROJECT * 11084EBIDINTEG.illinois.gov#P100T100	CHECKED -	REVISED -			9105	1198-IDS-2	MADISON	15	2	
PLOT SCALE * 1/8" = 1'-0"	PLOT SCALE * 1/8" = 1'-0"	DATE -	REVISED -			CONTRACT NO. 76H54		[ILLINOIS] FED. AID PROJECT			
PLOT DATE * 10/7/2016	PLOT DATE * 10/7/2016	SCALE: NA	SHEET 1 OF 1 SHEETS			STA.	TO STA.				



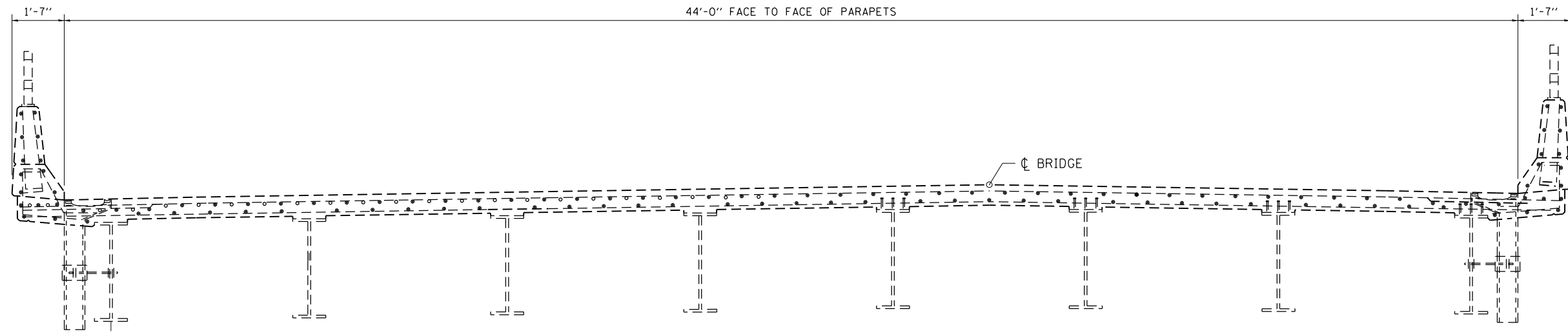

**TYPICAL SECTION**

STA. 61+02 TO STA. 62+47.5

(NOT TO SCALE)

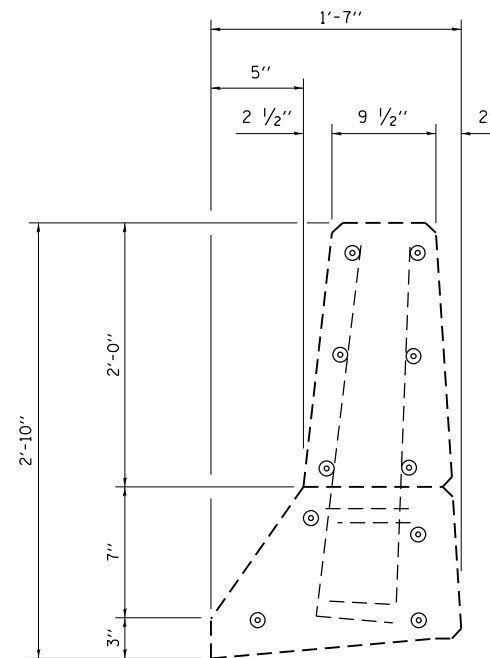

**TYPICAL PARAPET SECTION**

FILE NAME =	USER NAME = ogboolato	DESIGNED -	REVISED -	<b>STATE OF ILLINOIS DEPARTMENT OF TRANSPORTATION</b>	<b>TYPICAL SECTION</b>		F.A.U. RTE.	SECTION	COUNTY	TOTAL SHEETS	SHEET NO.	
p:\11\084EBIDINTEG.illinois.gov\PWIDOT\Documents\DOT Offices\District 8\Projects\0875\DRAWING\DATA\EA0\Sheets\08754-sht-typoc		CHECKED -	REVISED -		SCALE: NA	SHEET NO. 1 OF 6 SHEETS	STA. 61+02 TO STA. 62+47.5	9105	119B-IDS-2	MADISON	15	4
		DATE -	REVISED -					<b>CONTRACT NO. 76H54</b>				
								FED. ROAD DIST. NO. ILLINOIS FED. AID PROJECT				



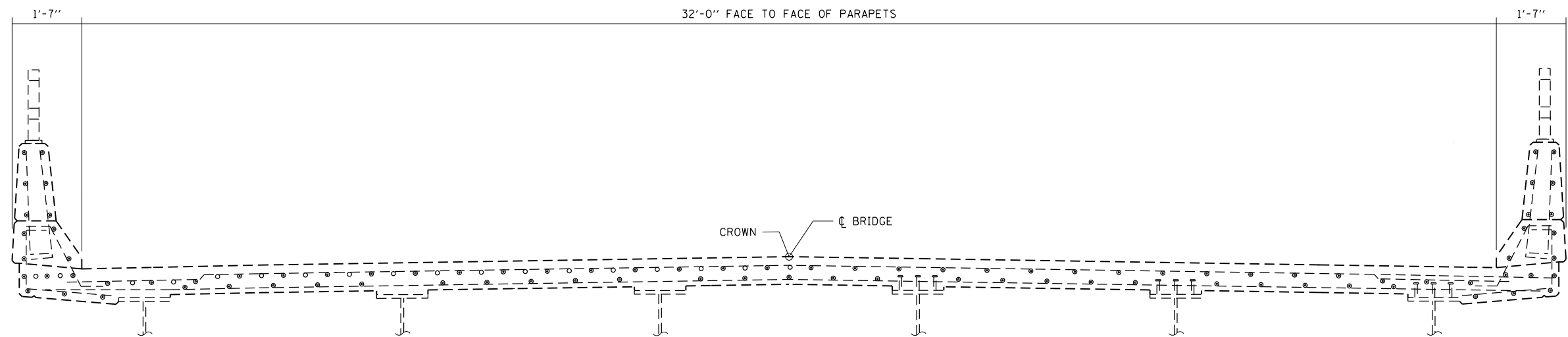

TYPICAL SECTION

STA. 63+54.5 TO 89+67.5

(NOT TO SCALE)

FILE NAME =	USER NAME = ogboolato	DESIGNED -	REVISED -	<b>STATE OF ILLINOIS DEPARTMENT OF TRANSPORTATION</b>	<b>TYPICAL SECTION</b>		F.A.U. RTE.	SECTION	COUNTY	TOTAL SHEETS	SHEET NO.	
p:\11\084EBIDINTEG.illinois.gov\PWIDOT\Documents\DOT Offices\District 8\Projects\0875\DRAWING\DATA\EA0sheets\D876H54-sht-typoc	DRAWING DATA =	CHECKED -	REVISED -				9105	119B-1DS-2	MADISON	15	6	
	PLOT SCALE = 100.0000' / 1in.	DATE -	REVISED -		SCALE: NA		SHEET NO. 3 OF 6 SHEETS		STA. 63+54.5 TO STA. 89+67.5	CONTRACT NO. 76H54		
	PLOT DATE = 9/28/2016	DATE -	REVISED -		FED. ROAD DIST. NO. ILLINOIS FED. AID PROJECT							

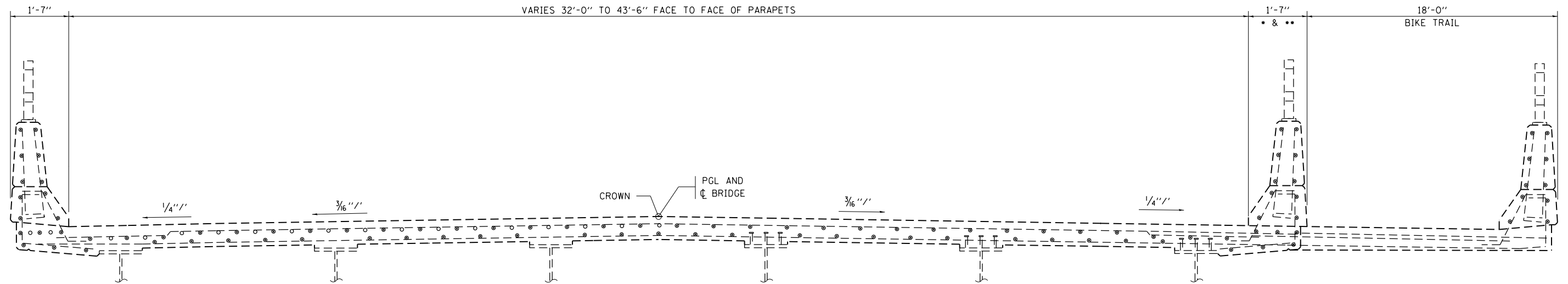

TYPICAL SECTION

STA. 89+67.5 TO STA. 92+17.5•

STA. 107+82.5 TO STA. 110+32.5••

•IMPACT ATTENUATOR FROM STA. 89+77.5 TO STA. 89+94 AND FROM STA. 90+57 TO STA. 90+73.5 AND GAP FROM STA. 89+94 TO STA. 90+57

••IMPACT ATTENUATOR FROM STA. 109+31 TO STA. 109+47.5 AND FROM STA. 110+12.5 TO STA. 110+29 AND GAP FROM STA. 109+47.5 TO STA. 110+12.5

FILE NAME =	USER NAME = ogboolato	DESIGNED -	REVISED -	<b>STATE OF ILLINOIS DEPARTMENT OF TRANSPORTATION</b>	<b>TYPICAL SECTION</b>		F.A.U. RTE.	SECTION	COUNTY	TOTAL SHEETS	SHEET NO.
p:\11\084EBIDINTEG.illinois.gov\PI\DOT\Documents\DOT Offices\District 8\Projects\0875\DRAWING\084EBID\084EBID-1198-1DS-2.dwg	DESIGNED BY = ogboolato	CHECKED -	REVISED -				9105	1198-1DS-2	MADISON	15	7
	PLOT SCALE = 100.0000' / 1"	DATE -	REVISED -		CONTRACT NO. 76H54						
	PLOT DATE = 9/28/2016				FED. ROAD DIST. NO. ILLINOIS FED. AID PROJECT						
				SCALE: NA		SHEET NO. 4 OF 6 SHEETS		STA. 89+67.5 TO STA. 110+32.5			

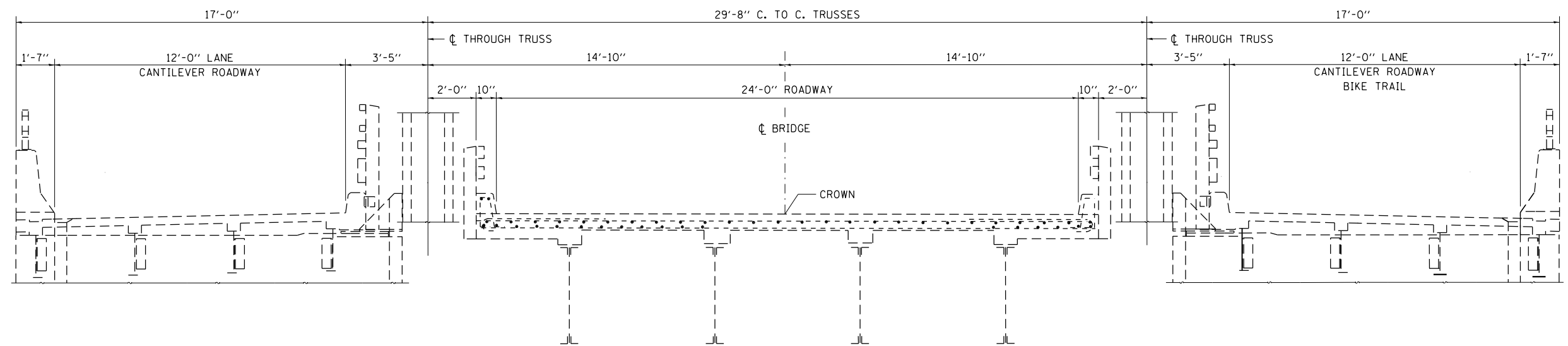

**TYPICAL SECTION**

STA. 92+17.5 TO STA. 107+82.5

(NOT TO SCALE)

NOTE: APPLY SEALER TO CURBS

FILE NAME =	USER NAME = ogboolato	DESIGNED -	REVISED -	<b>STATE OF ILLINOIS DEPARTMENT OF TRANSPORTATION</b>	<b>TYPICAL SECTION</b>	F.A.U. RTE.	SECTION	COUNTY	TOTAL SHEETS	SHEET NO.
p:\11\084EBIDINTEG.illinois.gov\PIWIDOT\Documents\DOT Offices\District 8\Projects\0875\DRAWING\DATA\EA0\Sheets\08754-sht-typic	DRAWN -	REVISED -	9105			119B-1DS-2	MADISON	15	8	
PLOT SCALE = 100.0000' / 1in.	CHECKED -	REVISED -	CONTRACT NO. 76H54							
PLOT DATE = 9/28/2016	DATE -	REVISED -	FED. ROAD DIST. NO. ILLINOIS FED. AID PROJECT							
				SCALE: NA	SHEET NO. 5 OF 6 SHEETS	STA. 92+17.5 TO STA. 107+82.5				



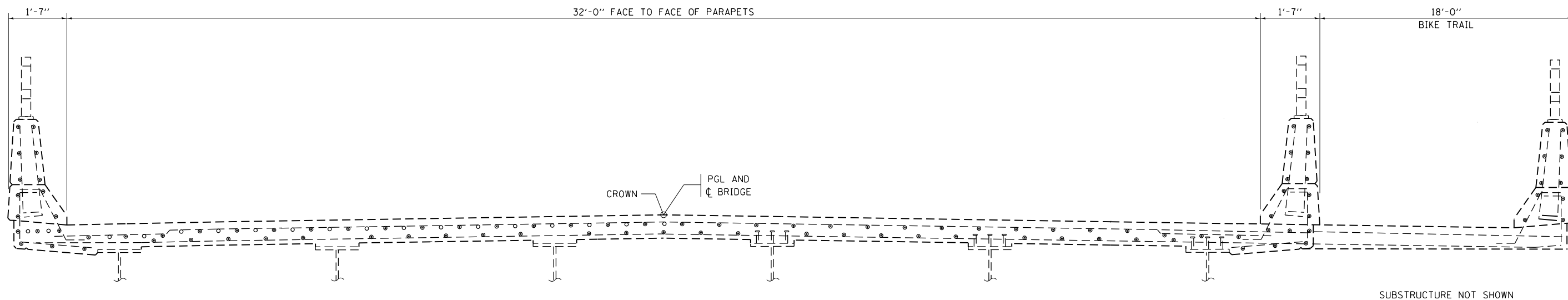

**TYPICAL SECTION**

STA. 110+32.5 TO STA. 118+36.25

(NOT TO SCALE)

FILE NAME =	USER NAME = ogboolato	DESIGNED -	REVISED -
p:\11084EBIDINTEG.illinois.gov\PI\DOT\Documents\DOT Offices\District 8\Projects\0875\DRAWING\DATA\EAD\Sheets\08754-sht-typoc		DRAWN -	REVISED -
	PLOT SCALE = 100.0000' / 1in.	CHECKED -	REVISED -
	PLOT DATE = 9/28/2016	DATE -	REVISED -

**STATE OF ILLINOIS  
DEPARTMENT OF TRANSPORTATION**

**TYPICAL SECTION**

SCALE: NA SHEET NO. 6 OF 6 SHEETS STA. 110+32.5 TO STA. 118+36.25

F.A.U. RTE.	SECTION	COUNTY	TOTAL SHEETS	SHEET NO.
9105	119B-1DS-2	MADISON	15	9
CONTRACT NO. 76H54				
FED. ROAD DIST. NO. ILLINOIS FED. AID PROJECT				

STA		STA	LENGTH ( FT )	AVG WIDTH ( FT )	DECK AREA TO BE SEALED ( SQ. FT )	PARAPET TO BE SEALED ( FT )	TOTAL PARAPET AREA TO BE SEALED ( SQ. FT )	GAP TO BE SEALED ( SQ. FT )
61+02	TO	62+47.5	145.5	44	6402	3.77	1096	
62+47.5	TO	63+54.5	107	38	4066	3.77	806	
63+54.5	TO	89+67.5	2613	32	83616	3.77	19685	
89+67.5	TO	92+17.5	250	37.75	9437.5	3.77	580	378
92+17.5	TO	107+82.5	1565	24	37560	1.67	5217	
107+82.5	TO	110+32.5	250	37.75	9437.5	3.77	559	390
110+32.5	TO	118+36.25	803.75	32	25720	3.77	6055	
SUBTOTAL ( SQ. FT. ) =					176239		33998	768
BRIDGE DECK CONCRETE SEALER ( SQ. FT. ) =					211,005			

FILE NAME =	USER NAME = ogbooloto	DESIGNED -	REVISED -	<b>STATE OF ILLINOIS DEPARTMENT OF TRANSPORTATION</b>	<b>SCHEDULE OF QUANTITIES</b>			F.A.U. RTE.	SECTION	COUNTY	TOTAL SHEETS	SHEET NO.	
p:\11\084EBIDINTEG.illinois.gov\PIWIDOT\Documents\IDOT Offices\District 8\Projects\0875\Drawings\CADsheets\08754-sht-sched	DRAWN	CHECKED	REVISED					9105	119B-IDS-2	MADISON	15	10	
Default	PLOT SCALE = 100.0050' / in.	DATE -	REVISED -		SCALE: NA			SHEET 1	OF 1	SHEETS	STA.	TO STA.	CONTRACT NO. 76H54
	PLOT DATE = 9/28/2016	DATE -	REVISED -		ILLINOIS FED. AID PROJECT								

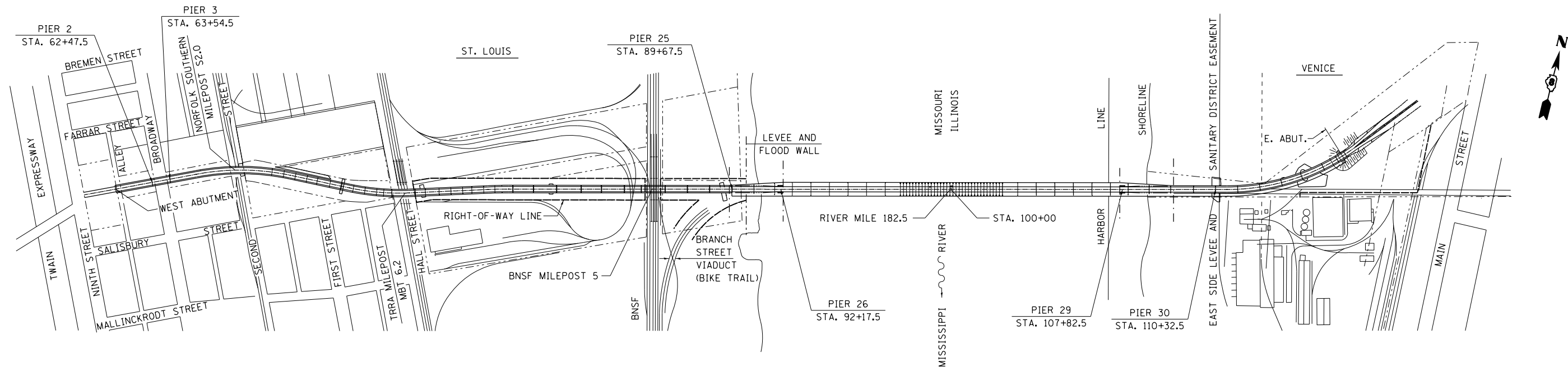

**EXISTING PLAN**

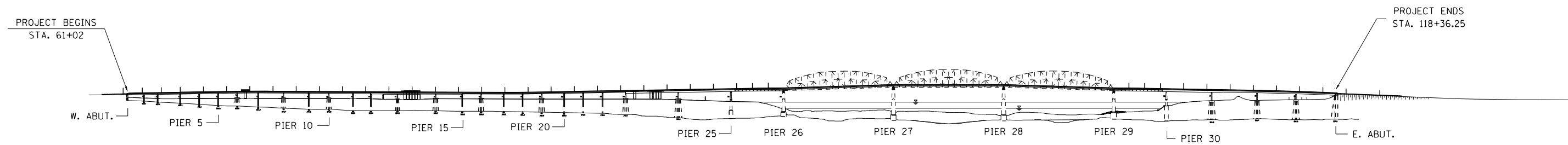

**EXISTING ELEVATION**

FILE NAME =		USER NAME = ogboolo		DESIGNED -		REVISED -		<b>STATE OF ILLINOIS</b> <b>DEPARTMENT OF TRANSPORTATION</b>		<b>EXISTING PLAN AND ELEVATION</b>				F.A.U. RTE.	SECTION	COUNTY	TOTAL SHEETS	SHEET NO.
p:\11\084EBIDINTEG.illinois.gov\PWIDOT\Documents\DOT Offices\District 8\Projects\0875\DRAWING\DATA\EA0\Sheets\0875H54-sht-typos		DRAWING DATA		REVISED -		REVISED -								9105	119B-1DS-2	MADISON	15	11
PLOT SCALE = 100.0000' / in.		CHECKED -		REVISED -		REVISED -				CONTRACT NO. 76H54				FED. ROAD DIST. NO.	ILLINOIS FED. AID PROJECT			
PLOT DATE = 9/28/2016		DATE -		REVISED -		REVISED -		SCALE: NA		SHEET NO. 1 OF 1 SHEETS		STA. TO STA.						

PROPOSED CHANGEABLE MESSAGE SIGN TO BE LOCATED ON EB I-70 1/2 MILE BEFORE EXIT 248A



CITY OF ST. LOUIS

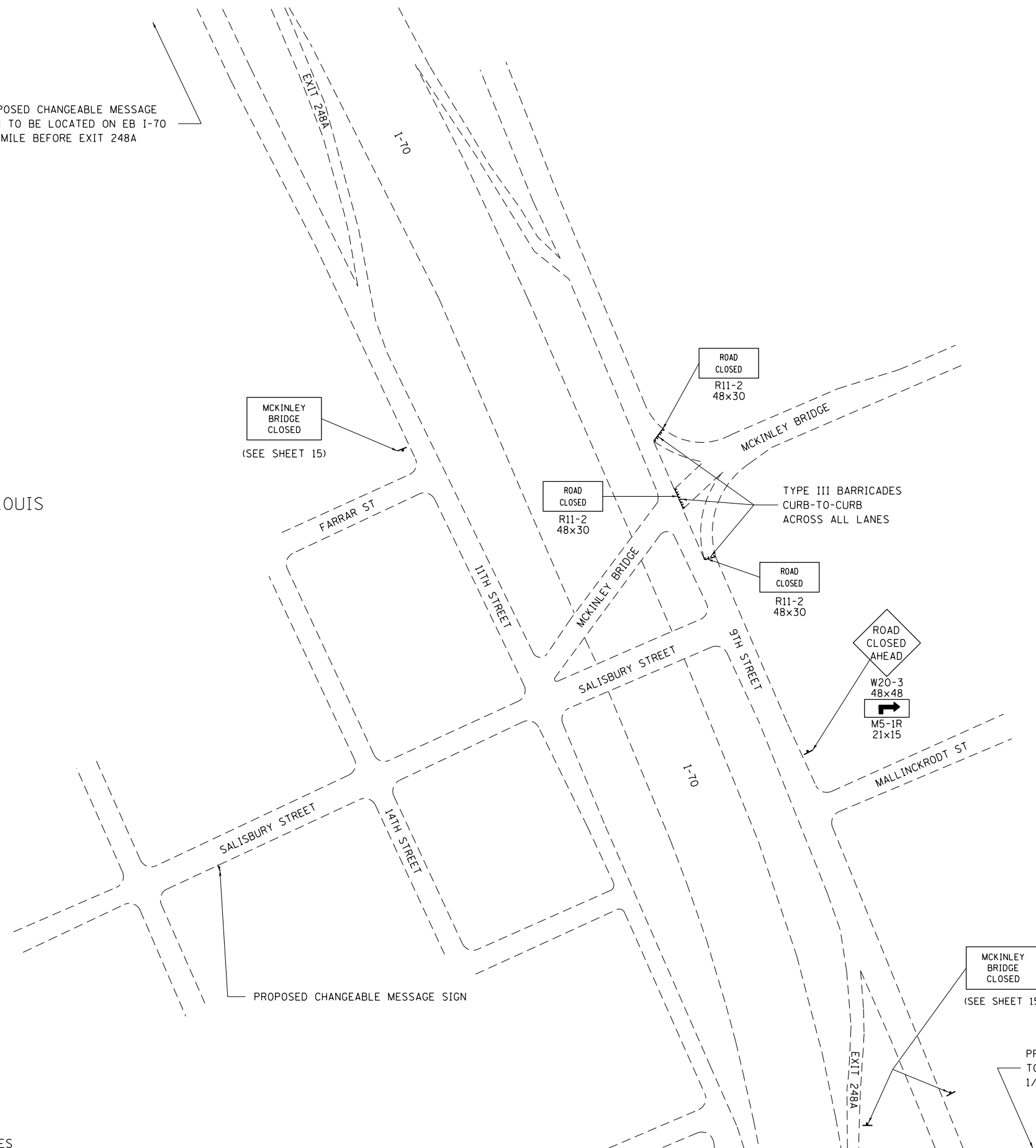

NOTE: ALL SIGN DIMENSIONS IN INCHES

FILE NAME =	USER NAME = ogbooloto	DESIGNED -	REVISED -
p:\11\084EBIDINTEG.illinois.gov\PIDOT\Documents\DOT Offices\District 8\Projects\0875\DRAWING\DATA\CADsheets\0875\54-sht-plan.dwg		DRAWN -	REVISED -
Default	PLOT SCALE = 100.0050' / in.	CHECKED -	REVISED -
	PLOT DATE = 9/28/2016	DATE -	REVISED -

**STATE OF ILLINOIS  
DEPARTMENT OF TRANSPORTATION**

**TRAFFIC CONTROL & PROTECTION  
(MISSOURI)**

SCALE: NA SHEET 1 OF 4 SHEETS STA. TO STA.

F.A.U. RTE.	SECTION	COUNTY	TOTAL SHEETS	SHEET NO.
9105	119B-IDS-2	MADISON	15	12
ILLINOIS FED. AID PROJECT			CONTRACT NO. 76H54	

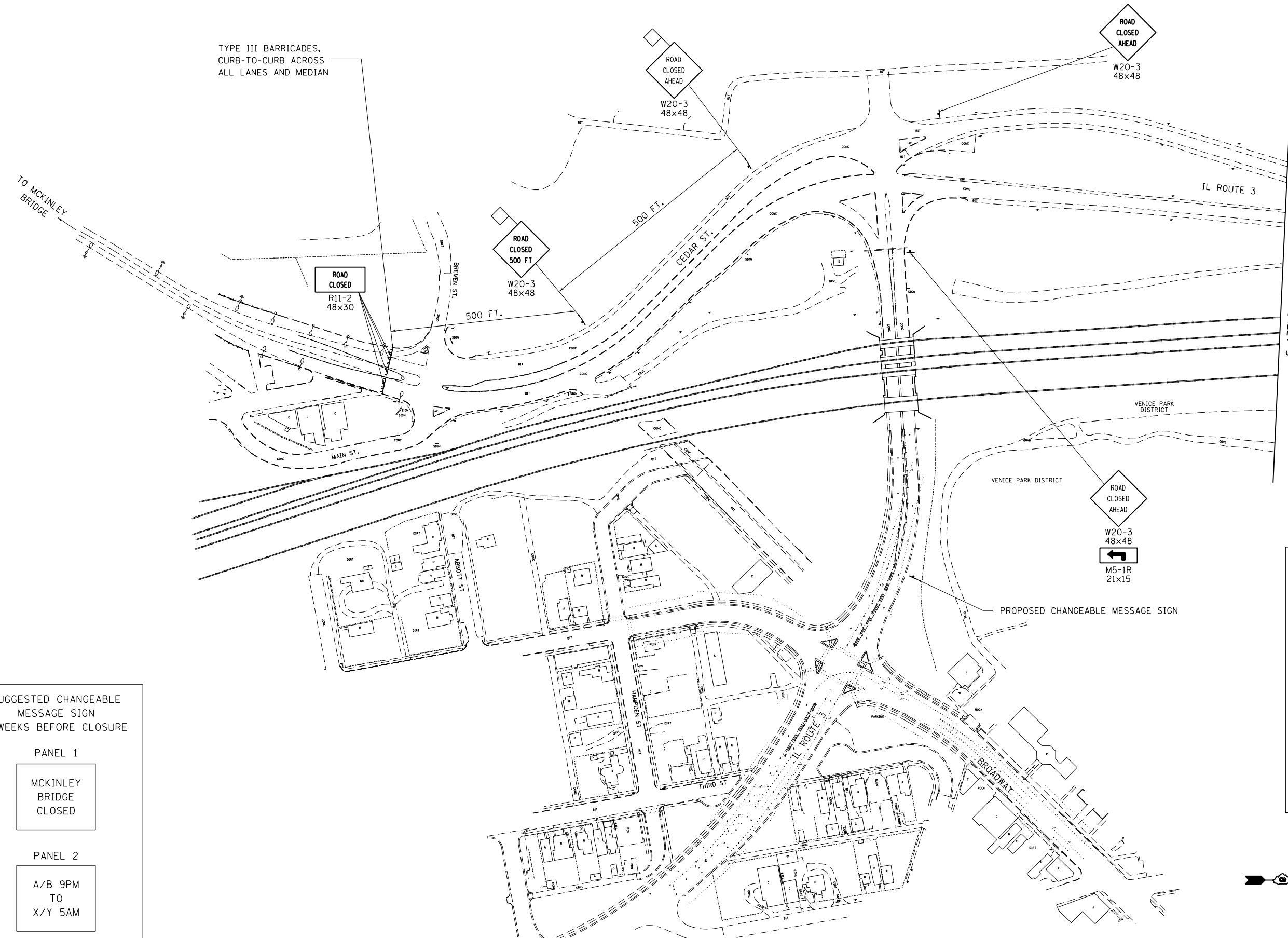

SUGGESTED CHANGEABLE MESSAGE SIGN  
2 WEEKS BEFORE CLOSURE

PANEL 1

MCKINLEY BRIDGE CLOSED

PANEL 2

A/B 9PM TO X/Y 5AM

SUGGESTED CHANGEABLE MESSAGE SIGN DURING CLOSURE

PANEL 1

MCKINLEY BRIDGE CLOSED

PANEL 2

USE ALT ROUTE

NOTE: ALL SIGN DIMENSIONS IN INCHES

FILE NAME =	USER NAME = ogbooloto	DESIGNED -	REVISED -	<b>STATE OF ILLINOIS DEPARTMENT OF TRANSPORTATION</b>	<b>TRAFFIC CONTROL &amp; PROTECTION (ILLINOIS)</b>		F.A.U. RTÉ.	SECTION	COUNTY	TOTAL SHEETS	SHEET NO.	
p:\11084EBIDINTEG.illinois.gov\PIWIDOT\Documents\DOT Offices\District 8\Projects\0875\DRAWING\DATA\EAD\Sheets\0875-54-sht-plan.dwg		DRAWN -	REVISED -		SCALE: NA	SHEET NO. 2 OF 4 SHEETS	STA.	9105	119B-IDS-2	MADISON	15	13
		CHECKED -	REVISED -				TO STA.	CONTRACT NO. 76H54				
		DATE -	REVISED -					FED. ROAD DIST. NO. ILLINOIS FED. AID PROJECT				

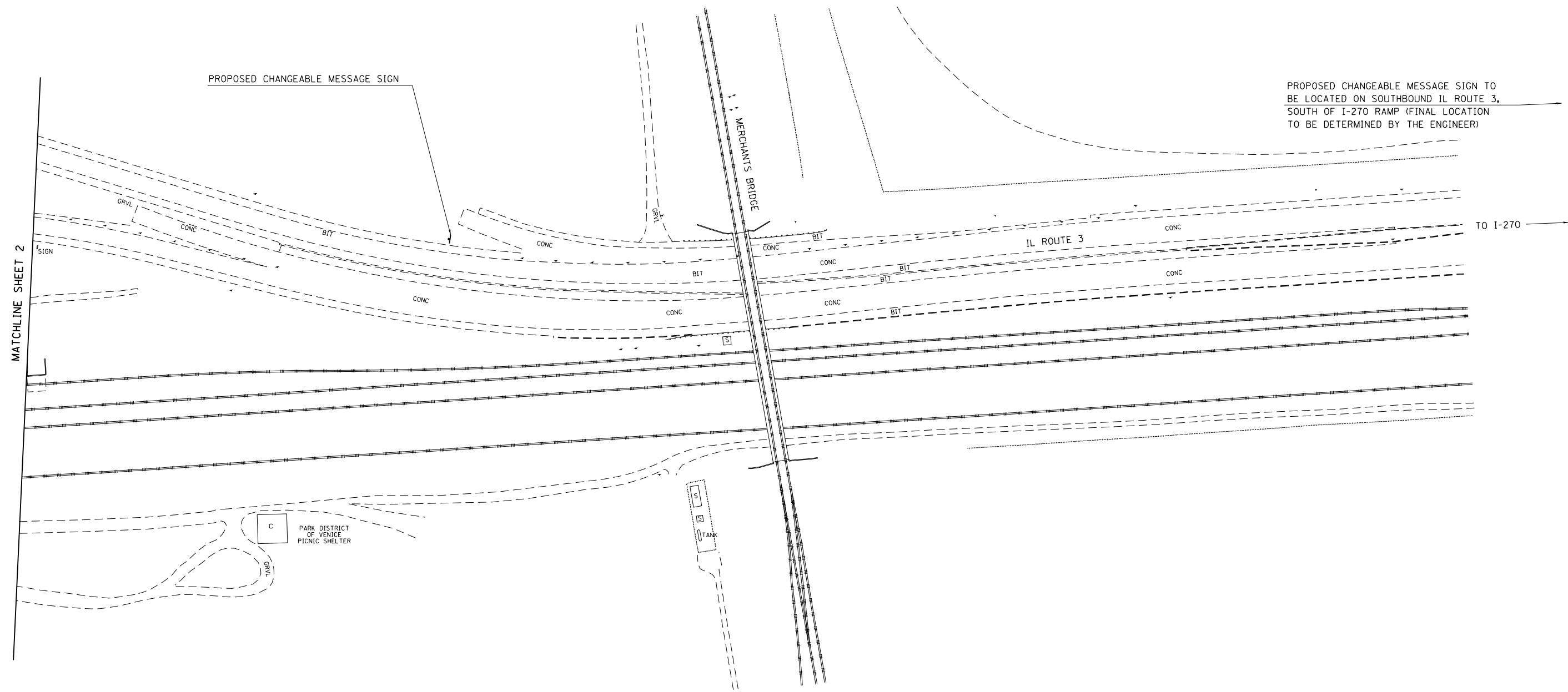

PROPOSED CHANGEABLE MESSAGE SIGN TO BE LOCATED ON SOUTHBOUND IL ROUTE 3, SOUTH OF I-270 RAMP (FINAL LOCATION TO BE DETERMINED BY THE ENGINEER)

FILE NAME =	USER NAME = ogboolato	DESIGNED -	REVISED -
p:\11\084EBIDINTEG.illinois.gov\PIWIDOT\Documents\DOT Offices\District 8\Projects\0875\DRAWING\DATA\EA0\Sheets\0875-54-sht-plan.dwg		CHECKED -	REVISED -
		DATE -	REVISED -

**STATE OF ILLINOIS  
DEPARTMENT OF TRANSPORTATION**

**TRAFFIC CONTROL & PROTECTION  
(ILLINOIS)**

F.A.U. RTE.	SECTION	COUNTY	TOTAL SHEETS	SHEET NO.
9105	119B-1DS-2	MADISON	15	14
CONTRACT NO. 76H54				
FED. ROAD DIST. NO. ILLINOIS FED. AID PROJECT				

SCALE: NA SHEET NO. 3 OF 4 SHEETS STA. TO STA.

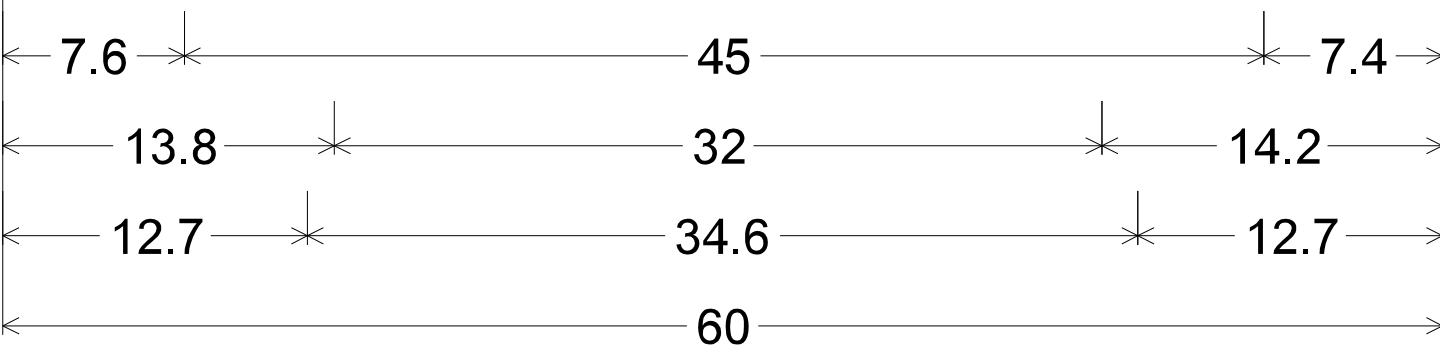
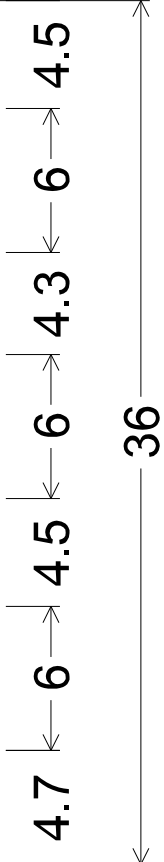

2.3" Radius, 0.9" Border, 0.6" Indent, Black on Orange;  
 [MCKINLEY] E; [BRIDGE] E; [CLOSED] E;

FILE NAME =	USER NAME = ogboolato	DESIGNED -	REVISED -	<b>STATE OF ILLINOIS DEPARTMENT OF TRANSPORTATION</b>	<b>TRAFFIC CONTROL &amp; PROTECTION (McKINLEY BRIDGE CLOSED SIGN DETAIL)</b>		F.A.U. RTE.	SECTION	COUNTY	TOTAL SHEETS	SHEET NO.
p:\11\084EBIDINTEG.illinois.gov\PIWIDOT\Documents\DOT Offices\District 8\Projects\0875\DRAWING\DATA\EA0\Sheets\0875-54-sht-plan.dwg	PLOT SCALE = 100.0000' / in.	CHECKED -	REVISED -				9105	119B-1DS-2	MADISON	15	15
PLOT DATE = 9/28/2016	DATE -	REVISED -	REVISED -		CONTRACT NO. 76H54			FED. ROAD DIST. NO.	ILLINOIS FED. AID PROJECT		
					SCALE: NA	SHEET NO. 4 OF 4 SHEETS	STA.	TO STA.			