

STATE OF ILLINOIS
DEPARTMENT OF TRANSPORTATION

F.A.S. RITE	SECTION	COUNTY	TOTAL SHEETS	SHEET NO.
899	J8X,103)TS-2, SW 1	SALINE	17	1
ILLINOIS CONTRACT NO. 78909				

FOR INDEX OF SHEETS, SEE SHEET NO. 3

FOR SUMMARY OF QUANTITIES, SEE SHEET NO. 5-7

PROPOSED HIGHWAY PLANS

FAS 899 / FAU 9559 (OLD IL 13 / MAIN STREET
SECTION (8X,103)TS-2,SW-1
PROJECT STP-U2KP(076)
SIGNAL AND ADA IMPROVEMENTS
SALINE COUNTY

TRAFFIC DATA

(2021)	POPLAR ST	MAIN ST
ADT =	3900	4850

PROPOSED IMPROVEMENT AT THE INTERSECTION
OF POPLAR ST AND MAIN ST

C-99-001-22

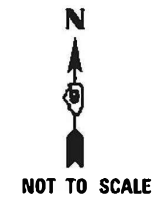

TOWNSHIPS
HARRISBURG

DESIGN DESIGNATION : N/A

COORDINATE SYSTEM : United States /State Plane 1983
Zone: Illinois East 1201 Feet

POSTED SPEED : 20 - 30 MPH

J.U.L.I.E.
JOINT UTILITY LOCATION INFORMATION FOR EXCAVATION
1-800-892-0123
OR 811

PROJECT ENGINEER: SUSAN POE

CONTRACT NO. 78909

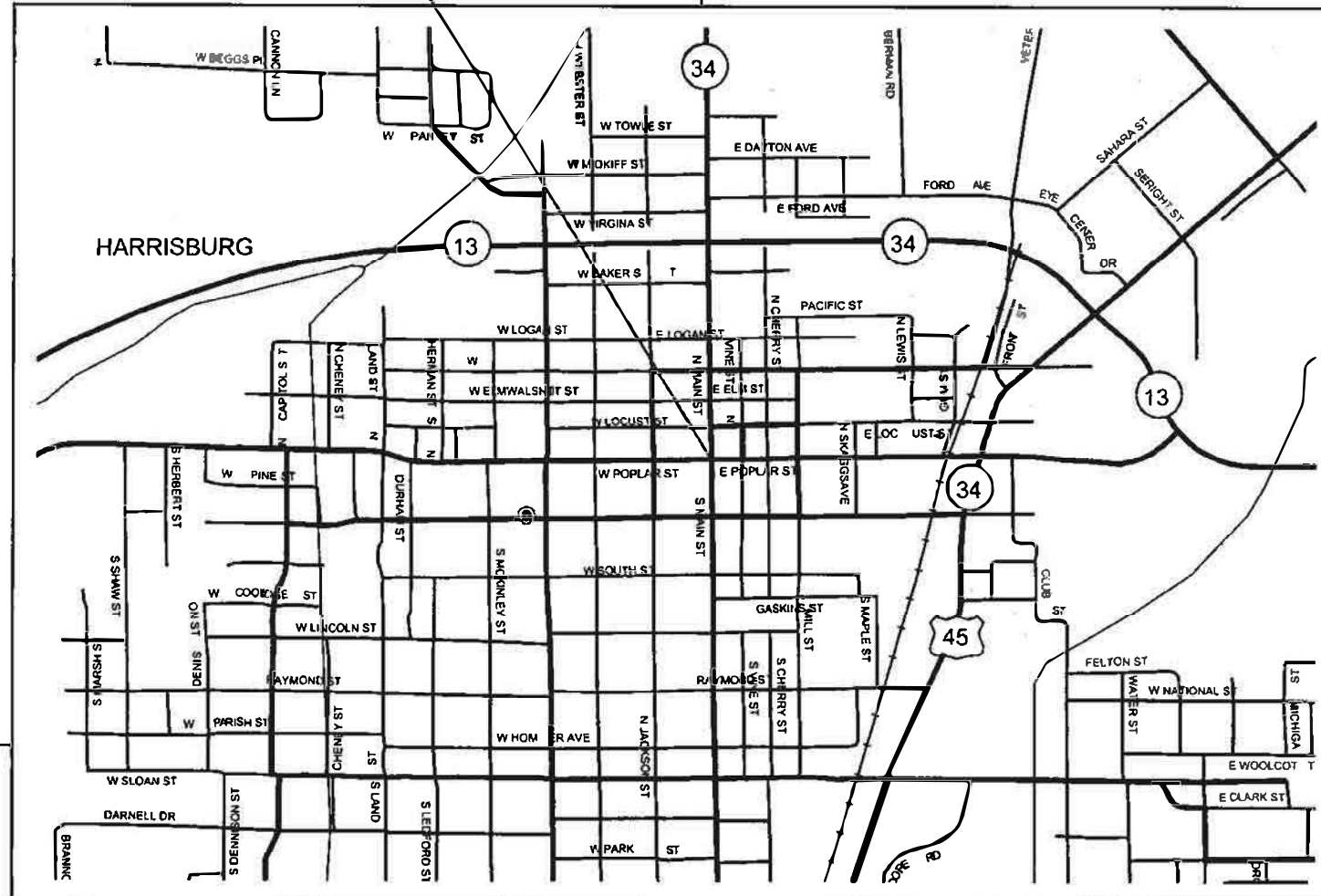

GROSS LENGTH = N/A
NET LENGTH = N/A

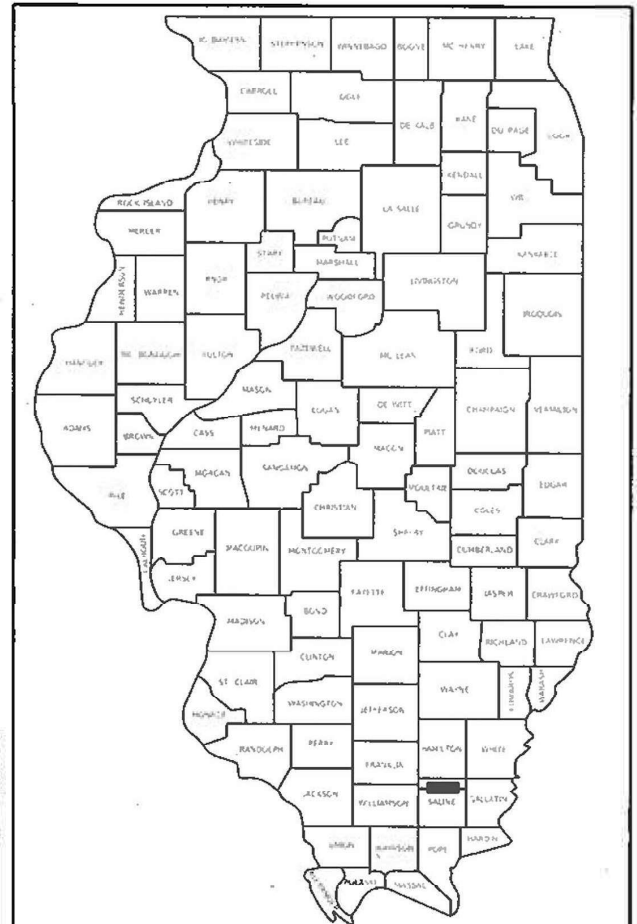

LOCATION OF SECTION INDICATED THUS: - [Symbol]

	ABNA CORP.
	DATE: 10-12-2022
	ABDELHAMID HADJRI
	EXPIRES: 11-30-2023
SHEETS NO. ALL SHEETS	

STATE OF ILLINOIS
DEPARTMENT OF TRANSPORTATION

SUBMITTED Oct 13 20 22
Kirk H. Broom
REGIONAL ENGINEER

December 9, 2022
Steph M. A...
ENGINEER OF DESIGN AND ENVIRONMENT

December 9, 2022
Steph M. A...
DIRECTOR OF HIGHWAYS PROJECT IMPLEMENTATION

PRINTED BY THE AUTHORITY
OF THE STATE OF ILLINOIS

Prepared By: Charles Stein
DISTRICT STUDIES & PLANS ENGINEER

Examined By: Naughton
DISTRICT LAND ACQUISITION ENGINEER

Examined By: Cassie Puler
DISTRICT PROGRAM DEVELOPMENT ENGINEER

Examined By: [Signature]
DISTRICT OPERATIONS ENGINEER

Examined By: David Mehlid
DISTRICT PROJECT IMPLEMENTATION ENGINEER

Examined By: David Mehlid
DISTRICT CONSTRUCTION ENGINEER

Examined By: [Signature]
DISTRICT MATERIALS ENGINEER

NOTE: SHORT NAMES
FILE NAME: P1E1E1



USER NAME = SUSERS	DESIGNED -	REVISED -
	DRAWN -	REVISED -
PLOT SCALE = S5EALES	CHECKED -	REVISED -
PLOT DATE = SDATES	DATE = 3/9/22	REVISED -

STATE OF ILLINOIS
DEPARTMENT OF TRANSPORTATION

SIGNATURE SHEET

SCALE: SHEET OF SHEETS STA. TO STA.

F.A.P. RTE.	SECTION	COUNTY	TOTAL SHEETS	SHEET NO.
VAR	D9 RAILROAD SIGNAL FY22-1	VARIOUS	17	2
CONTRACT NO. 78947			ILLINOIS FED. AID PROJECT	

INDEX OF SHEETS

<u>SHEET NO</u>	<u>DESCRIPTION</u>
1	COVER SHEET
2	SIGNATURE SHEET
3	INDEX OF SHEETS AND HIGHWAY STANDARDS
4	GENERAL NOTES
5-7	SUMMARY OF QUANTITIES
8	SCHEDULE OF QUANTITIES
9-10	TRAFFIC SIGNAL PLAN
11	ROADWAY LIGHTING PLAN
12	REMOVAL PLAN
13	SIDEWALK RAMP DETAIL PLAN
14	MAST ARM MOUNTED STREET NAME SIGNS
15-17	DISTRICT DETAILS

HIGHWAY STANDARDS

000001-08	STANDARD SYMBOLS, ABBREVIATIONS AND PATTERNS
001001-02	AREAS OF REINFORCEMENT BARS
001006	DECIMAL OF AN INCH AND OF A FOOT
280001-07	TEMPORARY EROSION CONTROL SYSTEMS
424021-06	DEPRESSED CORNER FOR SIDEWALKS
606001-08	CONCRETE CURB TYPE B AND COMBINATION CONCRETE CURB AND GUTTER
701001-02	OFF-ROAD OPERATIONS, 2L, 2W, MORE THAN 15' (4.5 M) AWAY
701006-05	OFF-ROAD OPERATIONS, 2L, 2W, 15' (4.5 M) TO 24" (600 MM) FROM PAVEMENT EDGE
701311-03	LANE CLOSURE, 2L, 2W, MOVING OPERATIONS - DAY ONLY
701501-06	URBAN LANE CLOSURE, 2L, 2W, UNDIVIDED
701502-09	URBAN LANE CLOSURE, 2L, 2W, WITH BIDIRECTIONAL LEFT TURN LANE
701701-10	URBAN LANE CLOSURE, MULTI LANE INTERSECTION
701801-06	SIDEWALK, CORNER OR CROSSWALK CLOSURE
701901-08	TRAFFIC CONTROL DEVICES
720001-01	SIGN PANEL MOUNTING DETAILS
720006-04	SIGN PANEL ERECTION DETAILS
720016-04	MAST ARM MOUNTED STREET NAME SIGNS
780001-05	TYPICAL PAVEMENT MARKINGS
805001-01	ELECTRICAL SERVICE INSTALLATION DETAILS
814001-03	HANDHOLES
814006-03	DOUBLE HANDHOLES
821101-02	LUMINAIRE WIRING IN POLE
857001-01	STANDARD PHASE DESIGNATION DIAGRAMS AND PHASE SEQUENCES
873001-02	TRAFFIC SIGNAL GROUNDING & BONDING
877011-10	STEEL COMBINATION MAST ARM ASSEMBLY AND POLE 16' THROUGH 55'
878001-11	CONCRETE FOUNDATION DETAILS
880006-01	TRAFFIC SIGNAL MOUNTING DETAILS
886001-01	DETECTOR LOOP INSTALLATIONS
886006-01	TYPICAL LAYOUT FOR DETECTION LOOPS

REV. - MS

MODEL: I:\EGG
FILE NAME: I:\2021\8095\Cost\Design\Print\CP96051-5R1-Index.dwg

USER NAME = igimire PLOT SCALE = 1.0000' / in. PLOT DATE = 10/12/2022	DESIGNED - DRAWN - CHECKED - DATE -	REVISED - REVISED - REVISED - REVISED -	STATE OF ILLINOIS DEPARTMENT OF TRANSPORTATION	INDEX SHEETS & HIGHWAY STANDARDS OLD IL 13 & MAIN ST (FAS 899FAU 9559)	F.A.S. RTE. 899	SECTION (8X,103)T5-2,5W-1	COUNTY SALINE	TOTAL SHEETS 17	SHEET NO. 3	CONTRACT NO. 78909 ILLINOIS FED. AID PROJECT
SCALE: SHEET OF SHEETS STA. TO STA.										

GENERAL NOTES

1. ALL DETECTOR LOOP CORNERS SHALL BE CORE DRILLED 2 IN. MINIMUM DIAMETER EXCEPT THOSE PLACED UNDER RESURFACING. THE DETECTOR LOOP CORNERS PLACED UNDER RESURFACING SHALL BE DIAGONALLY SAW CUT.
2. THE CONTRACTOR SHALL NOTIFY THE ENGINEER OF TRAFFIC OPERATIONS 72 HOURS PRIOR TO THE SHUT- DOWN OR CUTTING OF EXISTING DETECTOR LOOPS.
3. THE FURNISHING AND INSTALLATION OF THE 1 IN. CONDUIT FROM THE LOOP SAW CUT TO THE SPLICE POINT SHALL BE INCLUDED IN THE LOOP INSTALLATION UNLESS OTHERWISE NOTED ON THE PLANS.
4. SAWED SLOTS FOR TWISTED PAIR ELECTRIC CABLES SHALL BE LARGER THAN SINGLE CONDUCTOR LOOP SLOTS.
5. THE FINAL LOCATION OF THE DETECTOR LOOPS AND TRAFFIC SIGNAL FOUNDATIONS SHALL BE APPROVED BY THE BUREAU OF OPERATIONS BEFORE INSTALLATION.

MODEL: Index
 FILE NAME: J:\2021\6085\Cadd\Design\Plan\096085-shr.dgn

USER NAME = ighimire	DESIGNED -	REVISED -	STATE OF ILLINOIS DEPARTMENT OF TRANSPORTATION	GENERAL NOTES OLD IL 13 & MAIN ST (FAS 899/FAU 9559)	F.A.S. RTE.	SECTION	COUNTY	TOTAL SHEETS	SHEET NO.
	DRAWN -	REVISED -			899	(8X,103)TS-2,SW-1	SALINE	17	4
PLOT SCALE = 1.0000' / in	CHECKED -	REVISED -			CONTRACT NO. 78909				
PLOT DATE = 10/12/2022	DATE -	REVISED -			SCALE:		SHEET	OF	SHEETS
					ILLINOIS		FED. AID PROJECT		

COUNTY: SALINE
 ROUTE: (FAS 899/FAU 9559)
 FUNDING: 80% FED / 20% STATE
 LOCATION: URBAN

CODE NO.	ITEM DESCRIPTION	UNIT	TOTAL QUANTITY	ROADWAY	SIGNAL & LIGHTING
				0021	0021
42400100	PORTLAND CEMENT CONCRETE SIDEWALK 4 INCH	SQ FT	1566	1566	
42400800	DETECTABLE WARNINGS	SQ FT	110	110	
44000500	COMBINATION CURB AND GUTTER REMOVAL	FOOT	87	87	
44000600	SIDEWALK REMOVAL	SQ FT	1566	1566	
44213204	TIE BARS 3/4"	EACH	29	29	
60603800	COMBINATION CONCRETE CURB AND GUTTER, TYPE B-6.12	FOOT	87	87	
67000400	ENGINEER'S FIELD OFFICE, TYPE A	CAL MO	3	3	
67100100	MOBILIZATION	L SUM	1	0.5	0.5
70102620	TRAFFIC CONTROL AND PROTECTION, STANDARD 701501	L SUM	1	0.5	0.5
70102622	TRAFFIC CONTROL AND PROTECTION, STANDARD 701502	L SUM	1	0.5	0.5
70102635	TRAFFIC CONTROL AND PROTECTION, STANDARD 701701	L SUM	1	0.5	0.5
70102640	TRAFFIC CONTROL AND PROTECTION, STANDARD 701801	L SUM	1	0.5	0.5
70107025	CHANGEABLE MESSAGE SIGN	CAL DA	56	56	
72000100	SIGN PANEL - TYPE 1	SQ FT	25.5		25.5
72400310	REMOVE SIGN PANEL - TYPE 1	SQ FT	48		48
78000400	THERMOPLASTIC PAVEMENT MARKING - LINE 6"	FOOT	425	425	
78000650	THERMOPLASTIC PAVEMENT MARKING - LINE 24"	FOOT	120	120	
78300201	PAVEMENT MARKING REMOVAL - GRINDING	SQ FT	56	56	
80300100	LOCATING UNDERGROUND CABLE	FOOT	150		150
80500010	SERVICE INSTALLATION - GROUND MOUNTED	EACH	1		1

REV. - MS

MODEL: Q:\dms\it
 FILE NAME: P:\2021\6085\Cost\Design\print\PP6085-5R-500.dgn

USER NAME = ighimire	DESIGNED -	REVISED -
PLOT SCALE = 10.0000 sf / in	DRAWN -	REVISED -
PLOT DATE = 10/12/2022	CHECKED -	REVISED -
	DATE -	REVISED -

STATE OF ILLINOIS
 DEPARTMENT OF TRANSPORTATION

SUMMARY OF QUANTITIES
 OLD IL 13 & MAIN ST (FAS 899/FAU 9559)

SCALE: SHEET OF SHEETS STA. TO STA.

F.A.S. RTE.	SECTION	COUNTY	TOTAL SHEETS	SHEET NO.
899	(8X.103)T5-2.SW-1	SALINE	17	5
			CONTRACT NO. 78909	
ILLINOIS FED. AID PROJECT				

COUNTY:	SALINE	SALINE
ROUTE:	(FAS 899/FAU 9559)	(FAS 899/FAU 9559)
FUNDING:	80% FED / 20% STATE	80% FED / 15% STATE /5% LOCAL
LOCATION:	URBAN	URBAN

CODE NO.	ITEM DESCRIPTION	UNIT	TOTAL QUANTITY	ROADWAY	SIGNAL & LIGHTING
				0021	0021
81028390	UNDERGROUND CONDUIT, PVC, 4" DIA.	FOOT	922		922
81400100	HANDHOLE	EACH	7		7
81400300	DOUBLE HANDHOLE	EACH	1		1
81702450	ELECTRIC CABLE IN CONDUIT, 600V (XLP-TYPE USE 3-1/C NO. 10)	FOOT	760		760
82110003	LUMINAIRE, LED, ROADWAY, OUTPUT DESIGNATION C	EACH	4		4
87301215	ELECTRIC CABLE IN CONDUIT, SIGNAL NO. 14 2C	FOOT	2990		2990
87301225	ELECTRIC CABLE IN CONDUIT, SIGNAL NO. 14 3C	FOOT	1130		1130
87301245	ELECTRIC CABLE IN CONDUIT, SIGNAL NO. 14 5C	FOOT	1080		1080
87301255	ELECTRIC CABLE IN CONDUIT, SIGNAL NO. 14 7C	FOOT	1070		1070
87301305	ELECTRIC CABLE IN CONDUIT, LEAD-IN, NO. 14 1 PAIR	FOOT	750		750
87301815	ELECTRIC CABLE IN CONDUIT, SERVICE, NO. 6 3C	FOOT	24		24
87301900	ELECTRIC CABLE IN CONDUIT, EQUIPMENT GROUNDING CONDUCTOR NO. 6 1C	FOOT	710		710
87502700	TRAFFIC SIGNAL POST, ALUMINUM 16 FT.	EACH	1		1
87702890	STEEL COMBINATION MAST ARM ASSEMBLY AND POLE 32 FT.	EACH	1		1
87702910	STEEL COMBINATION MAST ARM ASSEMBLY AND POLE 36 FT.	EACH	1		1
87702940	STEEL COMBINATION MAST ARM ASSEMBLY AND POLE 42 FT.	EACH	2		2
87800100	CONCRETE FOUNDATION, TYPE A	FOOT	24		24
87800150	CONCRETE FOUNDATION, TYPE C	FOOT	4		4

MODEL: D:\m\h\l... FILE NAME: J:\2021\6085\Cadd\Design\Plan\096085-shr-500.dgn

USER NAME = ighimire	DESIGNED -	REVISED -
PLOT SCALE = 10.0000 sf / in.	DRAWN -	REVISED -
PLOT DATE = 10/12/2022	CHECKED -	REVISED -
	DATE -	REVISED -

**STATE OF ILLINOIS
DEPARTMENT OF TRANSPORTATION**

**SUMMARY OF QUANTITIES
OLD IL 13 & MAIN ST (FAS 899/FAU 9559)**

SCALE: SHEET OF SHEETS STA. TO STA.

F.A.S. RTE.	SECTION	COUNTY	TOTAL SHEETS	SHEET NO.
899	(8X,103)TS-2,SW-1	SALINE	17	6
CONTRACT NO. 78909			ILLINOIS FED. AID PROJECT	

COUNTY: SALINE
 ROUTE: (FAS 899/FAU 9559)
 FUNDING: 80% FED / 20% STATE
 LOCATION: URBAN

CODE NO.	ITEM DESCRIPTION	UNIT	TOTAL QUANTITY	SALINE (FAS 899/FAU 9559)	
				ROADWAY 0021	SIGNAL & LIGHTING 0021
87800415	CONCRETE FOUNDATION, TYPE E 36-INCH DIAMETER	FOOT	48		48
88040090	SIGNAL HEAD, POLYCARBONATE, LED, 1-FACE, 3-SECTION, MAST ARM MOUNTED	EACH	5		5
88030100	SIGNAL HEAD, POLYCARBONATE, LED, 1-FACE, 5-SECTION, BRACKET MOUNTED	EACH	3		3
88030110	SIGNAL HEAD, POLYCARBONATE, LED, 1-FACE, 5-SECTION, MAST ARM MOUNTED	EACH	4		4
88102747	PEDESTRIAN SIGNAL HEAD, LED, 2-FACE, BRACKET MOUNTED, WITH COUNTDOWN TIMER	EACH	4		4
88200510	TRAFFIC SIGNAL BACKPLATE, RETROREFLECTIVE **	EACH	9		9
88500100	INDUCTIVE LOOP DETECTOR	EACH	9		9
88600100	DETECTOR LOOP, TYPE I	FOOT	1020		1020
89502375	REMOVE EXISTING TRAFFIC SIGNAL EQUIPMENT	EACH	1		1
89502380	REMOVE EXISTING HANDHOLE	EACH	4		4
89502385	REMOVE EXISTING CONCRETE FOUNDATION	EACH	7		7
X7340100	CONCRETE FOUNDATION, GROUND MOUNT	CU YD	0.1		0.1
X8760055	PEDESTRIAN PUSH-BUTTON POST, TYPE A	EACH	4		4
X8760200	ACCESSIBLE PEDESTRIAN SIGNALS	EACH	8		8
X8950075	REMOVE EXISTING LIGHTING CONTROLLER AND SALVAGE	EACH	1		1

**
 NOTES:
 TRAFFIC SIGNAL BACKPLATE, RETROREFLECTIVE QUANTITY
 CONSISTS OF FIVE 3 - SECTION BACKPLATES AND FOUR 5 - SECTION
 BACKPLATES.

REV. - MS

MODEL: Q:\d\h\h
 FILE NAME: I:\2021\6085\6085.dwg

USER NAME = ighimire	DESIGNED -	REVISED -
	DRAWN -	REVISED -
PLOT SCALE = 10.0000 sf / in	CHECKED -	REVISED -
PLOT DATE = 10/12/2022	DATE -	REVISED -

STATE OF ILLINOIS
 DEPARTMENT OF TRANSPORTATION

SUMMARY OF QUANTITIES
 OLD IL 13 & MAIN ST (FAS 899/FAU 9559)

SCALE: SHEET OF SHEETS STA. TO STA.

F.A.S. RTE.	SECTION	COUNTY	TOTAL SHEETS	SHEET NO.
899	(8X,103)TS-2,SW-1	SALINE	17	7
			CONTRACT NO. 78909	
ILLINOIS FED. AID PROJECT				

SIGNAL AND LIGHTING SCHEDULE											
LOCATION	UNDERGROUND CONDUIT PVC, 4" DIA.	ELEC. CABLE IN CONDUIT SIGNAL NO. 14 2C	ELEC. CABLE IN CONDUIT SIGNAL NO. 14 3C	ELEC. CABLE IN CONDUIT SIGNAL NO. 14 5C	ELEC. CABLE IN CONDUIT SIGNAL NO. 14 7C	ELEC. CABLE IN CONDUIT LEAD-IN, NO. 14 1 PAIR	ELEC. CABLE IN CONDUIT SERVICE, NO. 6 3C	ELEC. CABLE IN CONDUIT EQUIPMENT GROUNDING CONDUCTOR NO. 6 1C	HANDHOLE	DOUBLE HANDHOLE	LOCATING UNDERGROUND CABLE
	FOOT	FOOT	FOOT	FOOT	FOOT	FOOT	FOOT	FOOT	EACH	EACH	FOOT
HARRISBURG, IL (OLD IL-13 & MAIN STREET)											
NW QUADRANT	129	523	240	160	315	193		170	2		18
NE QUADRANT	266	1265	484	650	246	185		220	2		6
SE QUADRANT	101	795	314	187	365	198		160	2		38
SW QUADRANT	426	407	92	83	144	174	24	160	1	1	88
PROJECT TOTALS	922	2990	1130	1080	1070	750	24	710	7	1	150

SIGNAL AND LIGHTING SCHEDULE										
LOCATION	TRAFFIC SIGNAL POST ALUMINIUM 16FT	STEEL COMB. MAST ARM ASS. & POLE 32FT	STEEL COMB. MAST ARM ASS. & POLE 36FT	STEEL COMB. MAST ARM ASS. & POLE 42FT	CONC. FOUNDATION TYPE A	CONC. FOUNDATION TYPE C	CONC. FOUNDATION TYPE E, 36" DIA	SIGNAL HEAD POLY. LED 1-FACE, 3-SECTION MA	SIGNAL HEAD POLY. LED 1-FACE, 5-SECTION BA	SIGNAL HEAD POLY. LED 1-FACE, 5-SECTION MA
	EACH	EACH	EACH	EACH	FOOT	FOOT	FOOT	EACH	EACH	EACH
HARRISBURG, IL (OLD IL-13 & MAIN STREET)										
NW QUADRANT				1			13	1		2
NE QUADRANT	1			1	4		13	2	1	
SE QUADRANT		1			8		11	1	1	1
SW QUADRANT			1		12	4	11	1	1	1
PROJECT TOTALS	1	1	1	2	24	4	48	5	3	4

SIGNAL AND LIGHTING SCHEDULE															
LOCATION	PED. SIGNAL HEAD LED, 2-FACE, BA WITH COUNTDOWN TIMER	TRAFFIC SIGNAL BACKPLATE RETRO REFLECTIVE	INDUCTIVE LOOP DETECTOR	DETECTOR LOOP TYPE 1	PEDSTRIAN PUSH BUTTON	REMOVE EXIST. HANDHOLE	REMOVE EXIST. CONCRETE FOUNDATION	PEDSTRIAN PUSH BUTTON POST, TYPE A	ACCESSIBLE PEDESTRIAN SIGNALS	LUMINAIRE, LED ROADWAY OUTPUT DESIG. C	ELEC. CABLE IN CONDUIT, 600V (XLP-TYPE USE 3-1/C NO. 10)	REMOVE EXISTING LIGHTING CONTROLLER AND SALVAGE	REMOVE EXISTING TRAFFIC SIGNAL EQUIPMENT	CONCRETE FOUNDATIONS, GROUND MOUNT	SERVICE INSTALLATION, GROUND MOUNT
	EACH	EACH	EACH	FOOT	EACH	EACH	EACH	EACH	EACH	EACH	FOOT	EACH	EACH	CU YD	EACH
HARRISBURG, IL (OLD IL-13 & MAIN STREET)															
NW QUADRANT	1	3	2	288	2	1	2		2	1	162				
NE QUADRANT	1	2	2	69	2	1	2		2	1	318				
SE QUADRANT	1	2	3	468	2	1	1	2	2	1	168				
SW QUADRANT	1	2	2	195	2	1	2	2	2	1	112				1
PROJECT TOTALS	4	9	9	1020	8	4	7	4	8	4	760	1	1	0.1	1

SIDEWALK SCHEDULE						
LOCATION	COMB CC&G, REMOVAL	SIDEWALK REMOVAL	COMB CC&G, TYB-6.12	TIE BARS 3/4"	PC CONCRETE SIDEWALK	DETECTABLE WARNING
	FOOT	SQ FT	FOOT	EACH	SQ FT	SQ FT
HARRISBURG, IL (OLD IL-13 & MAIN STREET)						
SE QUADRANT	45	737	45	15	737	63
SW QUADRANT	42	696	42	14	696	47
SE ADVANCED LOOP		60			60	
SW ADVANCED LOOP		73			73	
PROJECT TOTALS	87	1566	87	29	1566	110

PAVEMENT MARKING SCHEDULE					
LOCATION	PAVEMENT MARKING REMOVAL GRINDING	THERMOP. PAVEMENT MARKING LINE 6"	THERMOP. PAVEMENT MARKING LINE 24"	SIGN PANEL TYPE 1	REMOVE SIGN PANEL TYPE 1
	SQ FT	FOOT	FOOT	SQ FT	SQ FT
HARRISBURG, IL (OLD IL-13 & MAIN STREET)					
NW QUADRANT	31	124	32	6.3	12
NE QUADRANT		139	37	6.4	12
SE QUADRANT		80	25	6.4	12
SW QUADRANT	25	82	26	6.4	12
PROJECT TOTALS	56	425	120	25.5	48

MODEL: Schedule
FILE NAME: I:\2021\6085\Cadd\Design\Plan\096085-shr-schedule.dgn

USER NAME = ighimire	DESIGNED -	REVISED -
	DRAWN -	REVISED -
PLOT SCALE = 1,0000' / in.	CHECKED -	REVISED -
PLOT DATE = 10/12/2022	DATE -	REVISED -

**STATE OF ILLINOIS
DEPARTMENT OF TRANSPORTATION**

**SCHEDULE OF QUANTITIES
OLD IL 13 & MAIN ST (FAS 899/FAU 9559)**

SCALE: SHEET OF SHEETS STA. TO STA.

F.A.S. RTE.	SECTION	COUNTY	TOTAL SHEETS	SHEET NO.
899	(8X,103)TS-2,SW-1	SALINE	17	8
CONTRACT NO. 78909			ILLINOIS FED. AID PROJECT	

NOTES:

- REFER TO THE ROADWAY LIGHTING PLANS FOR MAST ARM MOUNTED LUMINAIRE'S.
- ALL MAST ARM MOUNTED SIGNAL HEADS ARE TO BE ATTACHED 2'-0" FROM THE END OF MAST ARM UNLESS OTHERWISE NOTED.
- ALL SIGNAL POSTS SHALL BE SET BACK 4 FEET MINIMUM AND ALL MAST ARM POLES SHALL BE SET BACK 6 FEET MINIMUM FROM THEIR CENTER TO THE BACK OF CURB UNLESS OTHERWISE NOTED. IN NON-CURBED AREAS THE MAST ARM POLE AND THE SIGNAL POST SHALL BE LOCATED A MINIMUM OF 10 FEET BEHIND THE EDGE OF PAVEMENT OR 2 FEET BEHIND THE EDGE OF THE SHOULDER, WHICHEVER DISTANCE IS GREATER.
- INTERCEPT EXISTING SERVICE CONDUIT, COUPLE EXISTING CONDUIT WITH PROPOSED CONDUIT TO NEW GROUND MOUNT SERVICE CABINET, LAND EXISTING SERVICE CABLE TO NEW SERVICE.

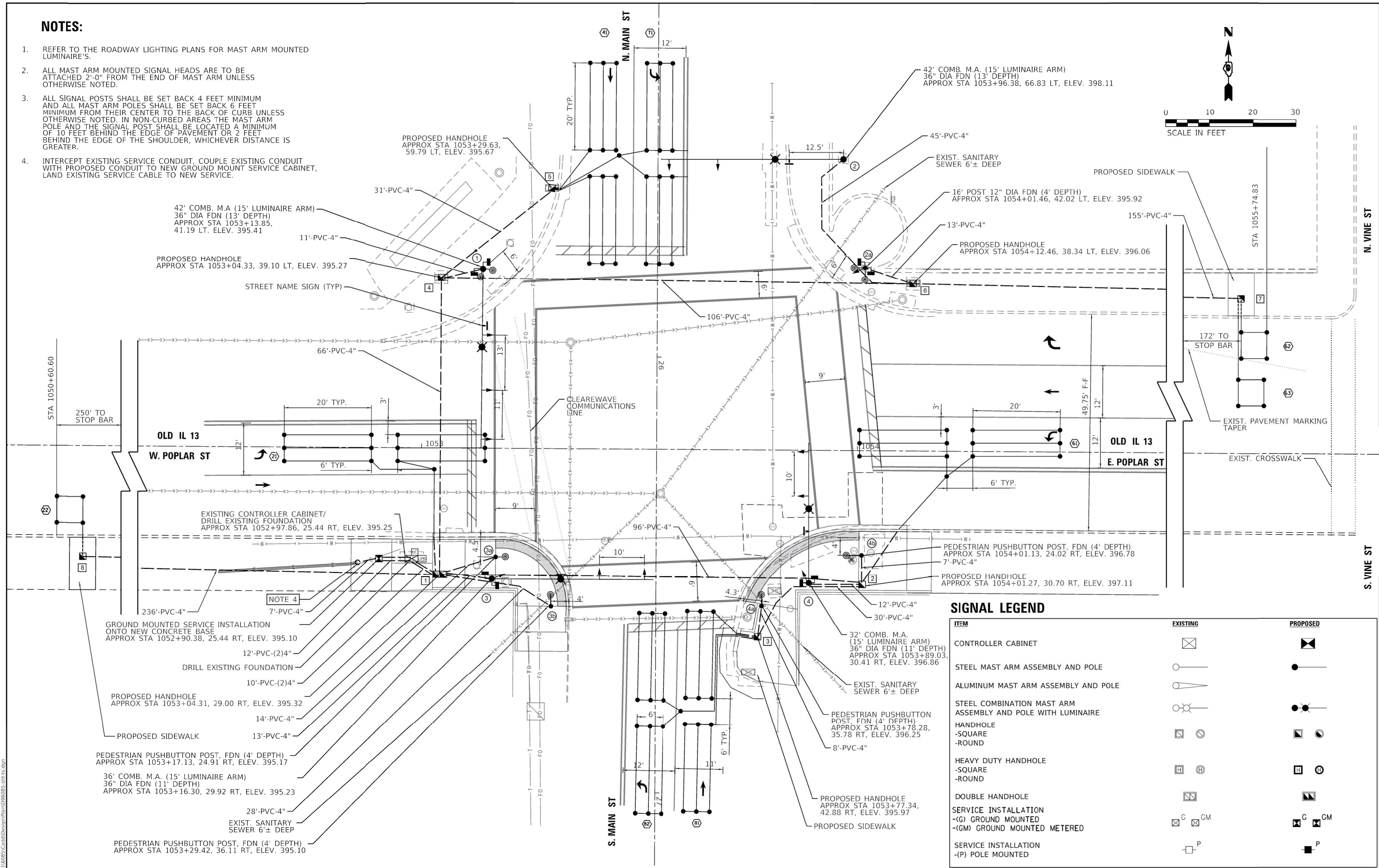
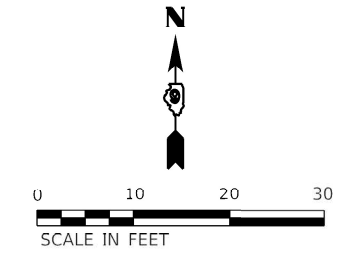

SIGNAL LEGEND

ITEM	EXISTING	PROPOSED
CONTROLLER CABINET		
STEEL MAST ARM ASSEMBLY AND POLE		
ALUMINUM MAST ARM ASSEMBLY AND POLE		
STEEL COMBINATION MAST ARM ASSEMBLY AND POLE WITH LUMINAIRE		
HANDHOLE		
HEAVY DUTY HANDHOLE		
DOUBLE HANDHOLE		
SERVICE INSTALLATION		

MODEL: Definitive
 FILE NAME: J:\2021\6085\Cadd\Design\Plan\096085-sht-1.dgn
 PLOT DATE = 10/12/2022

USER NAME = ighimire	DESIGNED -	REVISED -
	DRAWN -	REVISED -
PLOT SCALE = 10.0000" / ft.	CHECKED -	REVISED -
PLOT DATE = 10/12/2022	DATE -	REVISED -

**STATE OF ILLINOIS
DEPARTMENT OF TRANSPORTATION**

**TRAFFIC SIGNAL PLAN SHEET
OLD IL 13 & MAIN ST (FAS 899/FAU 9559)**

SCALE: SHEET OF SHEETS STA. TO STA.

F.A.S. RTE. 899	SECTION (8X,103)TS-2,SW-1	COUNTY SALINE	TOTAL SHEETS 17	SHEET NO. 9
ILLINOIS FED. AID PROJECT CONTRACT NO. 78909				

PROPOSED CONTROLLER SEQUENCE

LEGEND

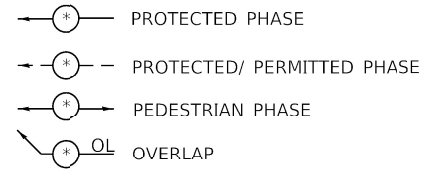

RIGHT TURN OVERLAP/ PHASE DESIGNATION

OVERLAP LETTER = PERMISSIVE PHASE + PROTECTED PHASE
 A = 6 + 7

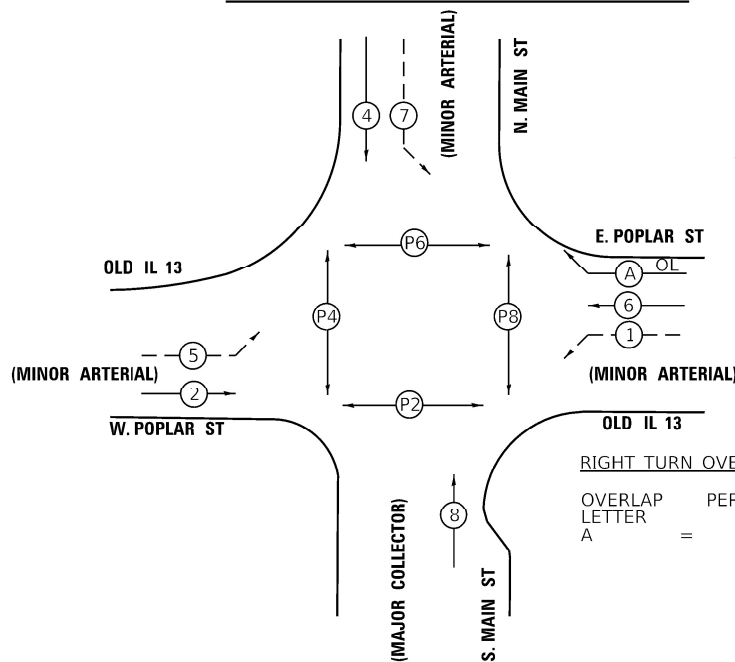

TRAFFIC SIGNAL ELECTRICAL SERVICE REQUIREMENTS				
TYPE	NO. OF LAMPS	LED WATTAGE	% OPERATION	TOTAL WATTAGE
SIGNAL (RED)	12	17	0.50	102.00
(YELLOW)	12	25	0.05	15.00
(GREEN)	12	15	0.45	81.00
(ARROW)	14	12	0.10	17.00
PEDESTRIAN SIGNAL)	8	25	1.00	200.00
(VEHICLE DET.)	30	5	1.00	150.00
(CONTROLLER)	1	100	1.00	100.00
(UPS)	1	25	1.00	25.00
(HEATER)	1	200	0.30	60.00
(LUMINAIRE)	4	190	0.50	380.00
TOTAL				1130.00

ENERGY COST TO:
 ILLINOIS DEPARTMENT OF TRANSPORTATION
 2801 W Murphysboro Rd, Carbondale, IL 62901

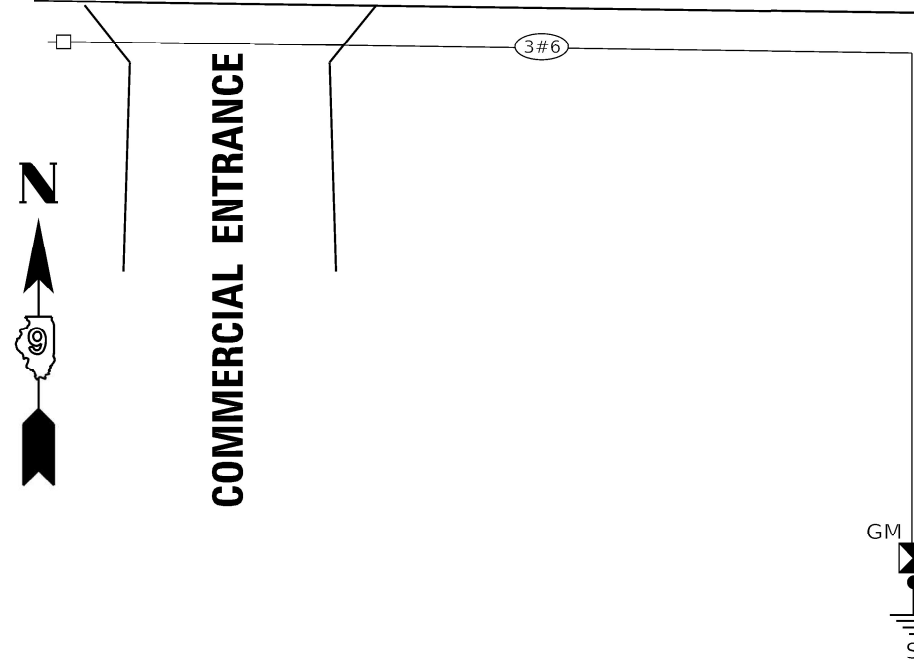
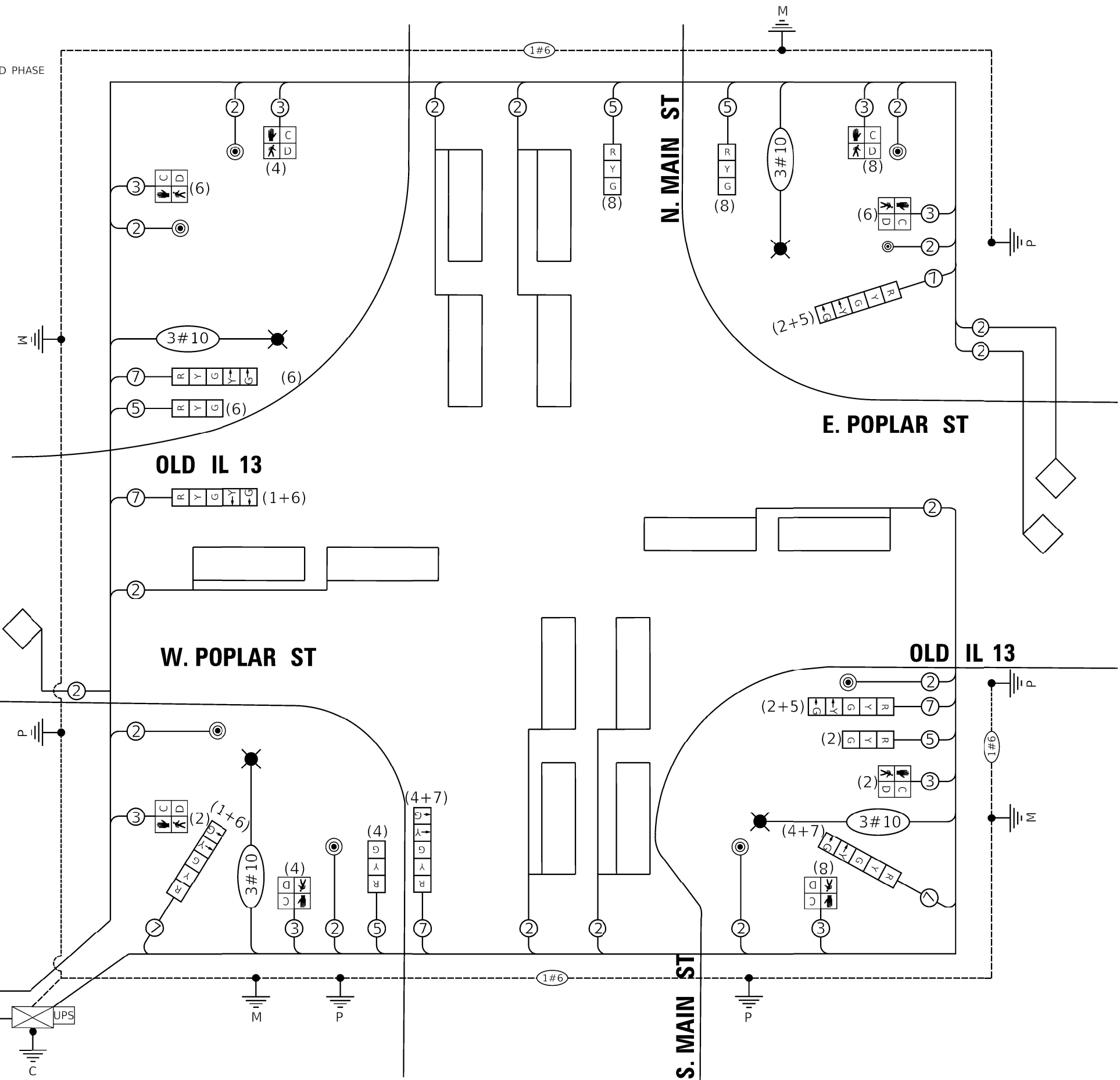

MODEL: Default
 FILE NAME: J:\2021\6085\Cadd\Design\plan\96085-sh1-12.dgn

USER NAME = ighimire	DESIGNED -	REVISED -
PLOT SCALE = 10.0000 sf / in.	DRAWN -	REVISED -
PLOT DATE = 10/12/2022	CHECKED -	REVISED -
	DATE -	REVISED -

STATE OF ILLINOIS
 DEPARTMENT OF TRANSPORTATION

TRAFFIC SIGNAL CABLE DIAGRAM
 OLD IL 13 & MAIN ST (FAS 899FAU 9559)

SCALE: SHEET OF SHEETS STA. TO STA.

F.A.S. RTE. 899	SECTION (8X,103)TS-2,SW-1	COUNTY SALINE	TOTAL SHEETS 17	SHEET NO. 10
CONTRACT NO. 78909				
ILLINOIS FED. AID PROJECT				

LEGEND

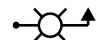
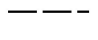
-  PROP LED COBRAHEAD COMBINATION LUMINAIRE ON 15' ARM MOUNTED AT 45'
-  PROPOSED COMBINATION LIGHTING CABLES IN TRAFFIC CONDUIT SIGNAL

LIGHTING QUANTITY OLD IL 13 & MAIN ST (FAS 899/FAU 9559)			
ITEM NO.	ITEM	UNIT	QUANTITY
82110003	LUMINAIRE, LED, ROADWAY, OUTPUT DESIGNATION C	EACH	4
81702450	ELECTRIC CABLE IN CONDUIT, 600V (XLP-TYPE USE) 3-1/C NO. 10	FOOT	760

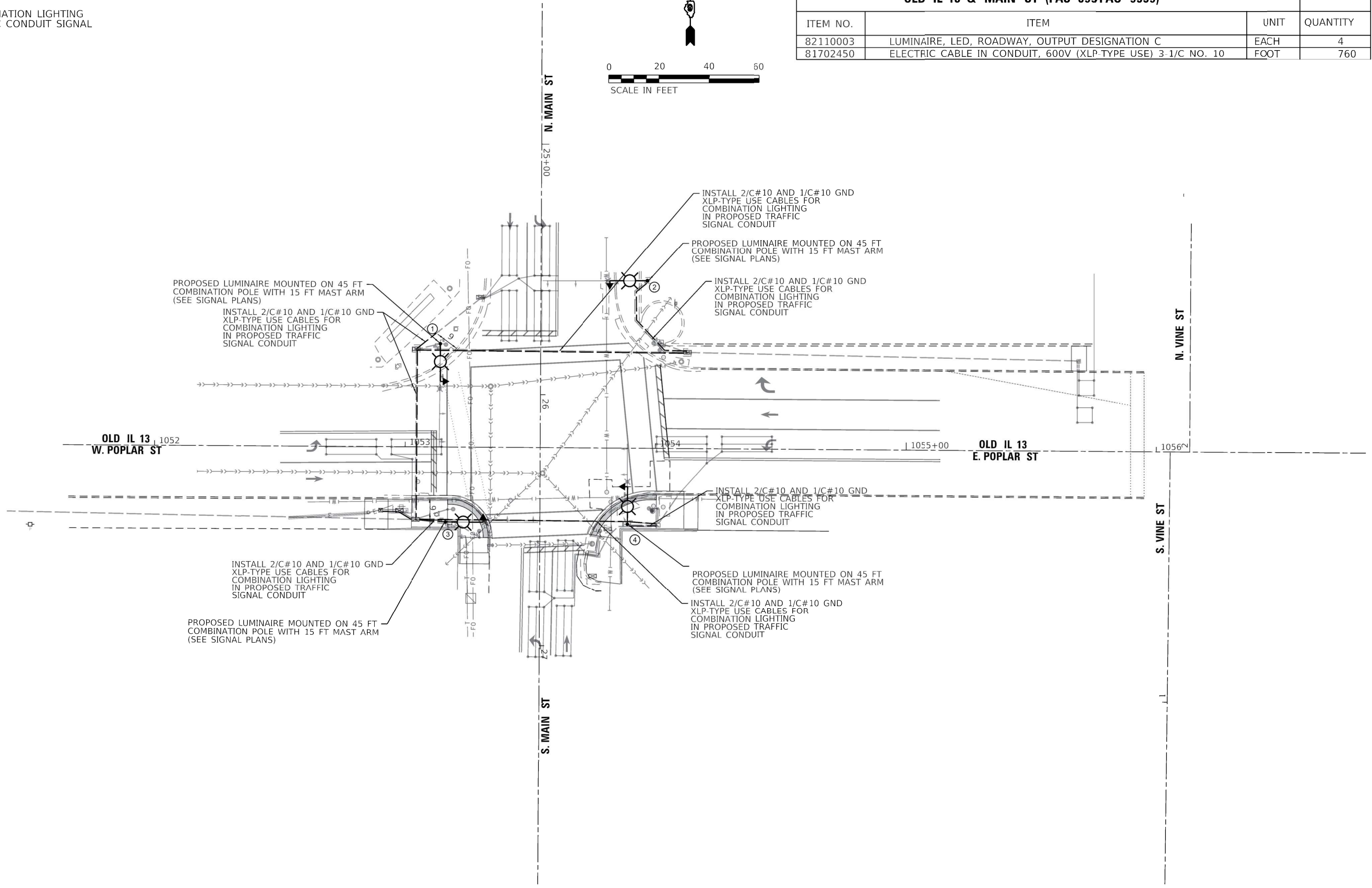
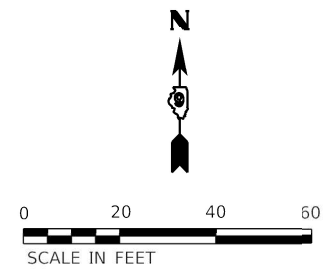

MODEL: D:\p1\h1
 FILE NAME: J:\2021\6085\Cadd\Design\plan\96085-sh-light1.dgn

USER NAME = ighimire	DESIGNED -	REVISED -
PLOT SCALE = 20.0000' / in.	DRAWN -	REVISED -
PLOT DATE = 10/12/2022	CHECKED -	REVISED -
	DATE -	REVISED -

**STATE OF ILLINOIS
DEPARTMENT OF TRANSPORTATION**

PROPOSED LIGHTING PLAN SHEET			
OLD IL 13 & MAIN ST (FAS 899/FAU 9559)			
SCALE:	SHEET	OF SHEETS	STA. TO STA.

F.A.S. RTE.	SECTION	COUNTY	TOTAL SHEETS	SHEET NO.
899	(8X,103)TS-2,SW-1	SALINE	17	11
CONTRACT NO. 78909				
ILLINOIS FED. AID PROJECT				

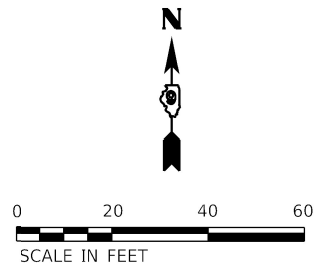

REMOVAL QUANTITY OLD IL 13 & MAIN ST (FAS 899/FAU 9559)			
ITEM NO.	ITEM	UNIT	QUANTITY
44000500	COMBINATION CURB AND GUTTER REMOVAL	FOOT	87
44000600	SIDEWALK REMOVAL	SQ FT	1566
72400310	REMOVE SIGN PANEL - TYPE 1	SQ FT	48
78300201	PAVEMENT MARKING REMOVAL - GRINDING	SQ FT	56
89502375	REMOVE EXISTING TRAFFIC SIGNAL EQUIPMENT	EACH	1
89502380	REMOVE EXISTING HANDHOLE	EACH	4
89502385	REMOVE EXISTING CONCRETE FOUNDATION	EACH	7
X8950075	REMOVE EXISTING LIGHTING CONTROLLER AND SALVAGE	EACH	1

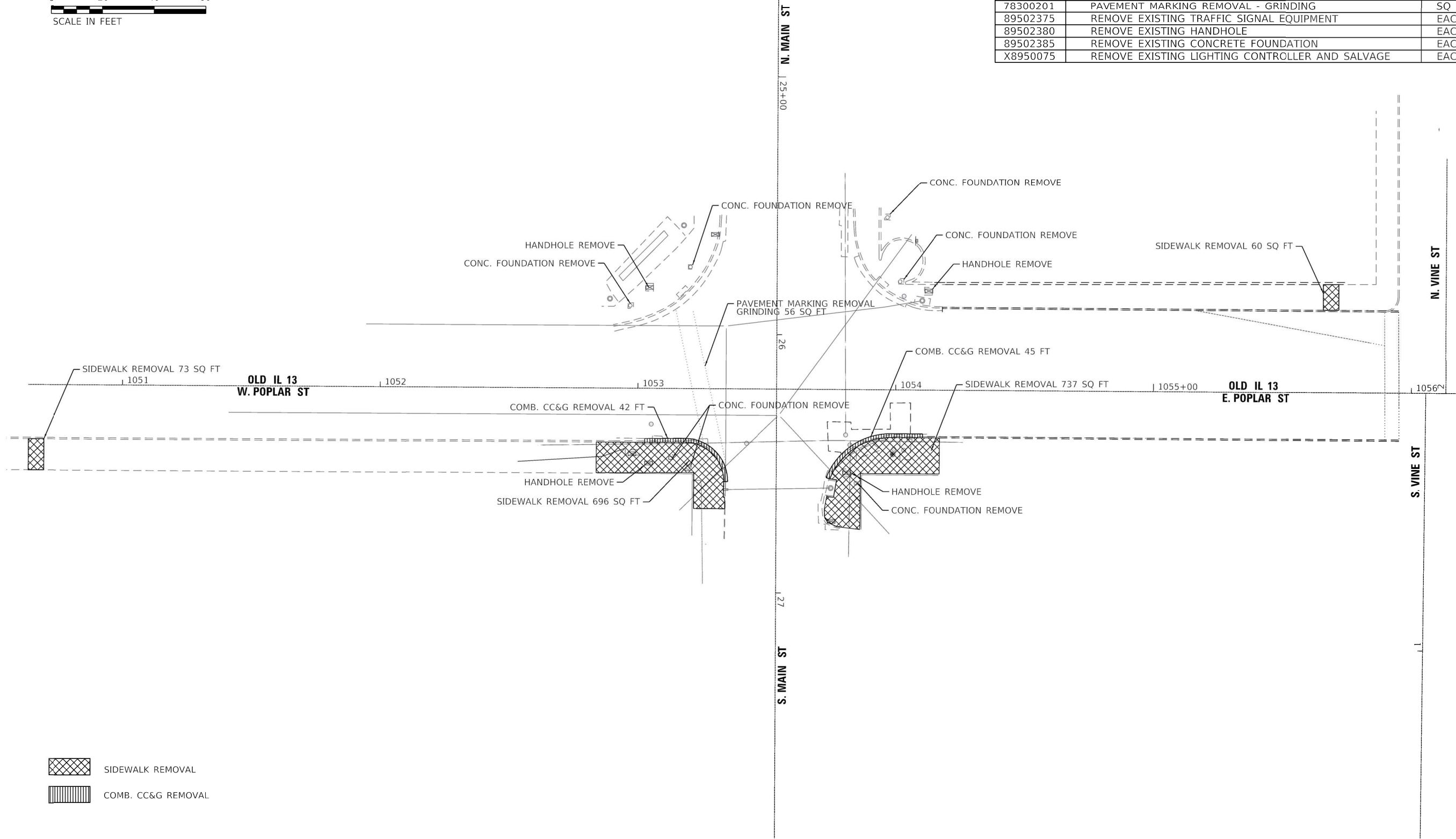

- SIDEWALK REMOVAL
- COMB. CC&G REMOVAL

MODEL: D:\m\h\l
FILE NAME: J:\2021\6085\Cadd\DesignPlan\966085-sht-removal.dgn

USER NAME = ighimire	DESIGNED -	REVISED -
	DRAWN -	REVISED -
PLOT SCALE = 20.0000' / in.	CHECKED -	REVISED -
PLOT DATE = 10/12/2022	DATE -	REVISED -

**STATE OF ILLINOIS
DEPARTMENT OF TRANSPORTATION**

REMOVAL SHEET			
OLD IL 13 & MAIN ST (FAS 899/FAU 9559)			
SCALE:	SHEET	OF SHEETS	STA. TO STA.

F.A.S. RTE.	SECTION	COUNTY	TOTAL SHEETS	SHEET NO.
899	(8X,103)TS-2,SW-1	SALINE	17	12
CONTRACT NO. 78909				
ILLINOIS FED. AID PROJECT				

NOTE:

1. STATIONS AND OFFSETS ARE REFERENCED TO OLD 13/ POPLAR ST.
2. ANY EXCAVATION, AGGREGATE BASE OR SIDE CURB NECESSARY FOR THE PROPOSED SIDEWALK IS INCLUDED IN THE COST OF PCC SIDEWALK, 4".

BENCHMARK

P.N. 2435 ELEVATION 398.765'
 BENCHMARK IS AN "X" CUT IN THE MOST WESTERLY TOP FLANGE BOLT ON FIRE HYDRANT IN THE SE QUADRANT OF THE INTERSECTION OF MAIN ST. AND POPLAR ST.



SCALE IN FEET

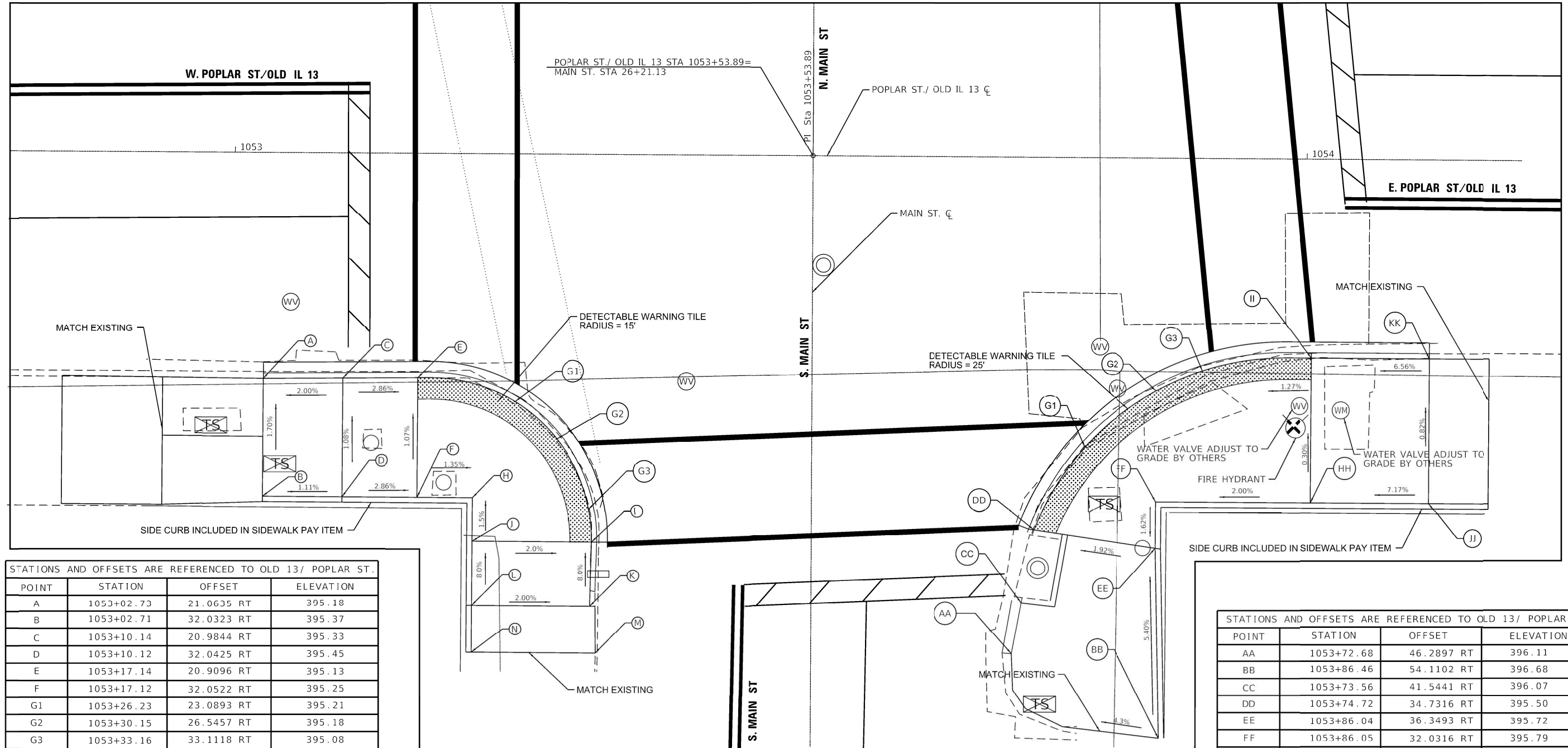

STATIONS AND OFFSETS ARE REFERENCED TO OLD 13/ POPLAR ST.

POINT	STATION	OFFSET	ELEVATION
A	1053+02.73	21.0635 RT	395.18
B	1053+02.71	32.0323 RT	395.37
C	1053+10.14	20.9844 RT	395.33
D	1053+10.12	32.0425 RT	395.45
E	1053+17.14	20.9096 RT	395.13
F	1053+17.12	32.0522 RT	395.25
G1	1053+26.23	23.0893 RT	395.21
G2	1053+30.15	26.5457 RT	395.18
G3	1053+33.16	33.1118 RT	395.08
H	1053+22.28	32.0594 RT	395.18
I	1053+33.30	36.1150 RT	395.02
J	1053+22.27	36.0994 RT	395.24
K	1053+33.29	42.1148 RT	395.50
L	1053+22.27	42.0994 RT	395.72
M	1053+33.84	46.4899 RT	395.47
N	1053+22.27	46.4737 RT	395.92

STATIONS AND OFFSETS ARE REFERENCED TO OLD 13/ POPLAR ST.

POINT	STATION	OFFSET	ELEVATION
AA	1053+72.68	46.2897 RT	396.11
BB	1053+86.46	54.1102 RT	396.68
CC	1053+73.56	41.5441 RT	396.07
DD	1053+74.72	34.7316 RT	395.50
EE	1053+86.04	36.3493 RT	395.72
FF	1053+86.05	32.0316 RT	395.79
GG1	1053+79.39	27.0339 RT	395.68
GG2	1053+86.02	21.7082 RT	395.85
GG3	1053+90.33	19.8178 RT	395.91
HH	1054+00.50	32.0187 RT	396.08
II	1054+00.51	18.5387 RT	396.04
JJ	1054+11.51	32.0088 RT	396.87
KK	1054+11.49	18.5411 RT	396.76

SIDEWALK AND CURB/GUTTER QUANTITY OLD IL 13 & MAIN ST (FAS 899/FAU 9559)			
ITEM NO.	ITEM	UNIT	QUANTITY
42400100	PORTLAND CEMENT CONCRETE SIDEWALK 4 INCH	SQ FT	1566
42400800	DETECTABLE WARNINGS	SQ FT	110
60603800	COMBINATION CONCRETE CURB AND GUTTER, TYPE B-6.12	FOOT	87

STATE OF ILLINOIS
 DEPARTMENT OF TRANSPORTATION

SIDEWALK RAMP DETAIL PLAN
 OLD IL 13 & MAIN ST (FAS 899/FAU 9559)

SCALE: SHEET OF SHEETS STA. TO STA.

F.A.S. RTE.	SECTION	COUNTY	TOTAL SHEETS	SHEET NO.
899	(8X,103)TS-2,SW-1	SALINE	17	13

CONTRACT NO. 78909
 ILLINOIS FED. AID PROJECT

MODEL: SHEET 1
 FILE NAME: J:\2021\60603800\Design\Plan\096085-SW-ADA.dgn

USER NAME = ighimire	DESIGNED -	REVISED -
PLOT SCALE = 5.0000' / in	DRAWN -	REVISED -
PLOT DATE = 10/12/2022	CHECKED -	REVISED -
	DATE -	REVISED -

SIGN PANEL – TYPE 1 OR TYPE 2

ALL DIMENSIONS ARE IN INCHES UNLESS NOTED OTHERWISE

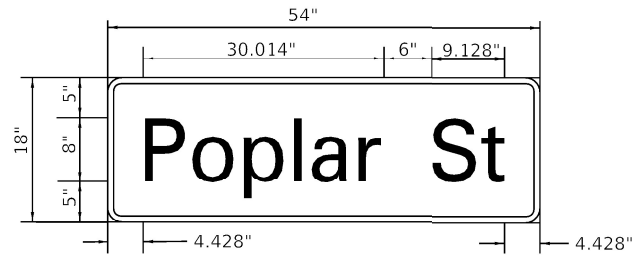

DESIGN SERIES	AREA (SQ FT)	SIGN PANEL TYPE	SHEETING TYPE	QTY. REQUIRED
D	6.75	1	ZZ	2

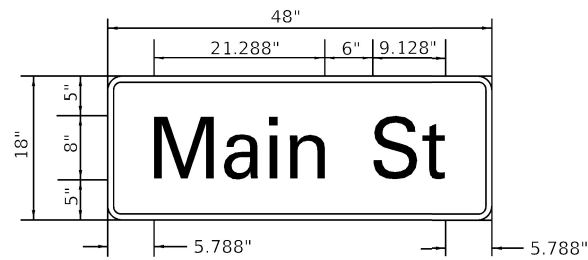

DESIGN SERIES	AREA (SQ FT)	SIGN PANEL TYPE	SHEETING TYPE	QTY. REQUIRED
D	6	1	ZZ	2

SIGNAGE QUANTITY OLD IL 13 & MAIN ST (FAS 899/FAU 9559)			
ITEM NO.	ITEM	UNIT	QUANTITY
72000100	SIGN PANEL - TYPE 1	SQFT	25.5

SIGNING NOTES:

1. WHITE LETTERING AND BORDER ON GREEN BACKGROUND. SIGN LETTERING SHALL BE SERIES D, 8" UPPERCASE AND 6" LOWERCASE. SIGN BORDER SHALL BE 1" WIDE.

MODEL - Sheet 1
FILE NAME - \\bah\ah\bb\file\2021\6085\Cadd\Design\Plan\096085-sht-signage.dgn

USER NAME = ighimire	DESIGNED -	REVISED -
PLOT SCALE = 40.0000' / in.	DRAWN -	REVISED -
PLOT DATE = 10/12/2022	CHECKED -	REVISED -
	DATE -	REVISED -

**STATE OF ILLINOIS
DEPARTMENT OF TRANSPORTATION**

**MAST ARM MOUNTED STREET NAME SIGN
OLD IL 13 & MAIN ST (FAS 899/FAU 9559)**

SCALE: SHEET OF SHEETS STA. TO STA.

F.A.S. RTE.	SECTION	COUNTY	TOTAL SHEETS	SHEET NO.
899	(8X,103)TS-2,SW-1	SALINE	17	14
			CONTRACT NO. 78909	
		ILLINOIS	FED. AID PROJECT	

WIRING DIAGRAM FOR LIGHTING

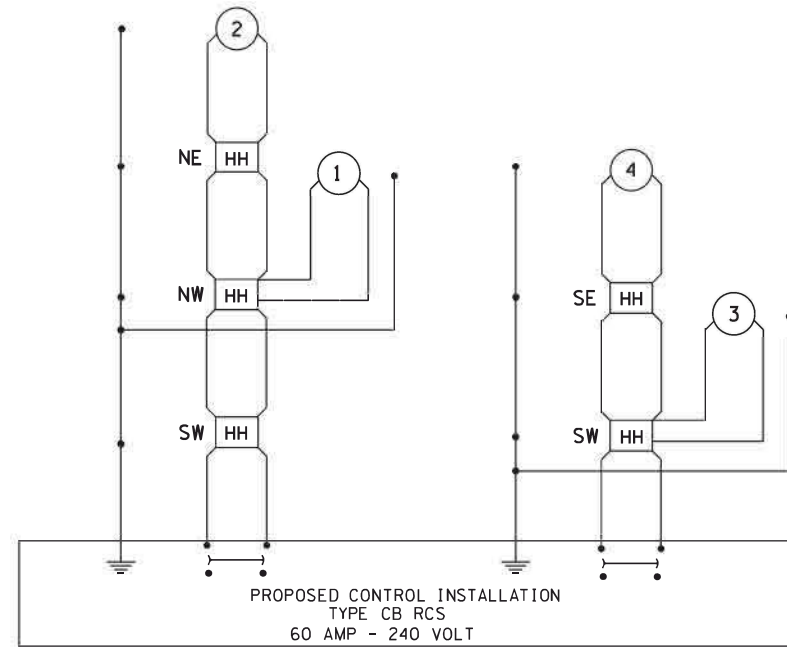

NOTES:

- FOR SIZE AND TYPE OF CABLE USED FOR LIGHTING INSTALLATION SEE CABLE DIAGRAM SHEET NO. 11.
- POWER TO CONTROL INSTALLATION SHALL REMAIN AS IS.
- PROPOSED LIGHTING CONTROLLER IS HOUSED INSIDE THE GROUND MOUNT SERVICE INSTALLATION CABINET AND INCLUDED IN THE COST OF SERVICE INSTALLATION -GROUND MOUNT.

LEGEND FOR WIRING DIAGRAM

- HH** INDICATES PROPOSED TRAFFIC SIGNAL HANDHOLE.
NOTE: THE SIGNAL CONDUIT SYSTEM SHALL BE UTILIZED TO INSTALL WIRING FOR ALL THE PROPOSED LIGHTING SYSTEM, EXCEPT FOR LIGHT POLES NO.
- 1** NUMBER INDICATES POSITION OF POLE IN WIRING DIAGRAM.
- INDICATES PROPOSED GROUND AT LIGHT POLE AND CONTROL INSTALLATION.
- ⊕ INDICATES CONTINUOUS GROUND FROM CONTROL INSTALLATION.

REVISIONS	
DRAWN	7-27-93
REVISED	5-14-02
RESIZED	5-8-08
REVIEWED	5-17-13

STD. 9-59

DETAIL OF DETECTOR LOOPS

NOTES

- THE DETECTOR LOOPS SHALL BE TYPE I. EACH DETECTOR LOOP SHALL HAVE 3 TURNS OF LOOP WIRE AND BE INSTALLED IN ACCORDANCE WITH THE APPLICABLE PORTIONS OF SECTION 886 OF THE STANDARD SPECIFICATIONS FOR TRAFFIC CONTROL ITEMS.
- BEGINNING LEAD WIRES SHALL BE CONNECTED TO THE BLACK LEAD AND THE ENDING LEAD WIRES SHALL BE CONNECTED TO THE WHITE LEAD OF THE TWIN TWISTED FEED CABLES AT THE SPLICE POINT.
- WHERE THE LOOPS ARE INSTALLED PRIOR TO RESURFACING, THE LOOP CORNERS SHALL BE DIAGONALLY CUT.

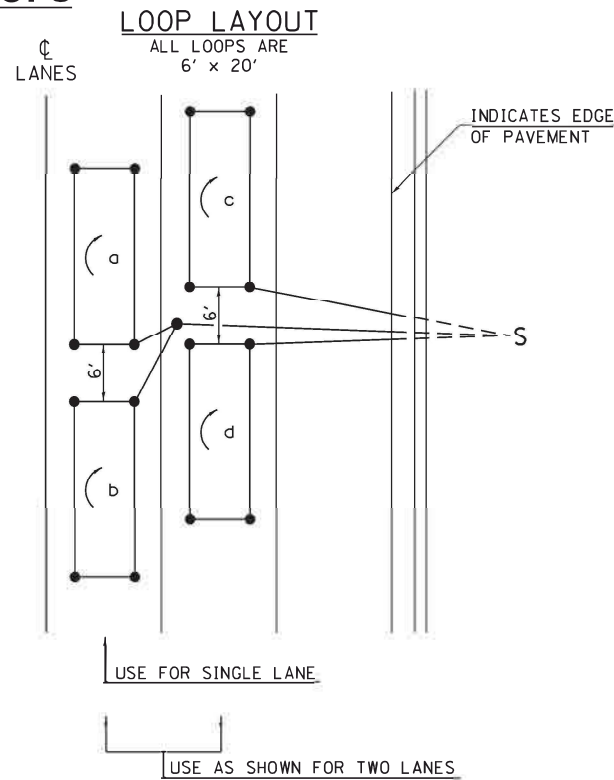

LOOP LEGEND

- () CLOCKWISE ROTATION FOR LOOP WIRES
- S INDICATES SPLICE POINT FOR DETECTOR LOOP LEAD
- INDICATES 2" CORE-DRILL

DETAIL 6' x 20' DETECTOR LOOPS

REVISIONS	
REDRAWN	5-13-02
REVISED	10-27-05
REVISED	3-26-08
REDRAWN	3-16-11
REVISED	4-12-13

STD. 9-92

USER NAME = ighimire	DESIGNED -	REVISED -
PLOT SCALE = 10.0000 sf / in	DRAWN -	REVISED -
PLOT DATE = 10/12/2022	CHECKED -	REVISED -
	DATE -	REVISED -

STATE OF ILLINOIS
DEPARTMENT OF TRANSPORTATION

CABINET FOR SERVICE INSTALLATION GROUND MOUNT AND CONCRETE FOUNDATIONS GROUND MOUNT

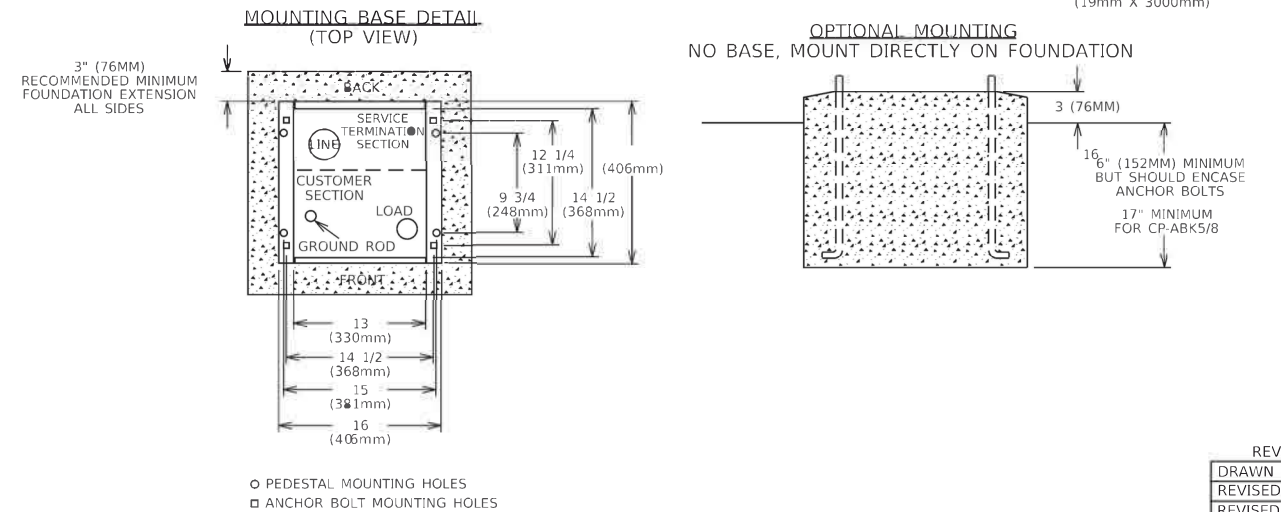
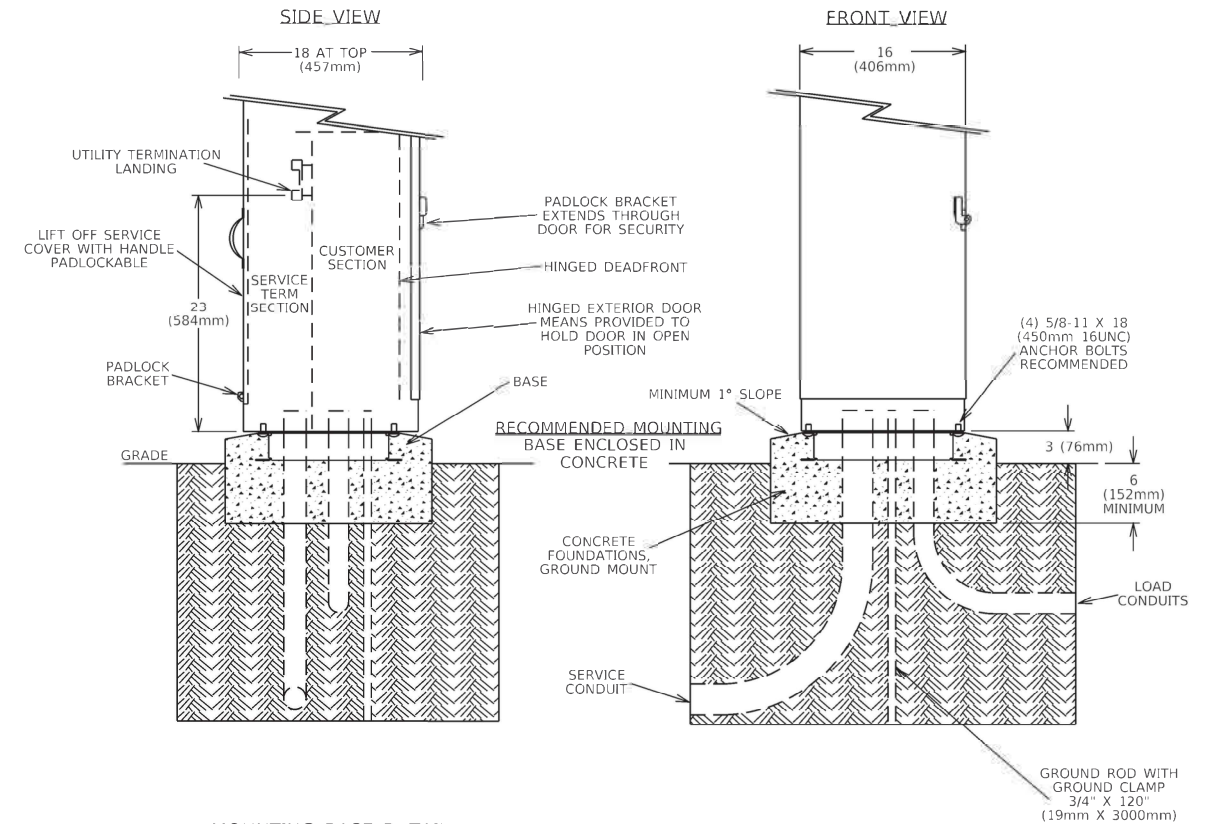

REVISIONS	
DRAWN	03-02-22
REVISED	
REVISED	
REVISED	

STD. 9-51

R10-3e PEDESTRIAN SIGNAL INFORMATION (COUNTDOWN)

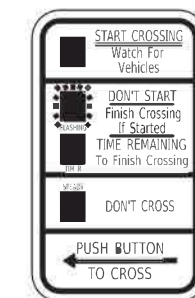

NOTE:

THE SIGNS ARE INCLUDED IN THE COST OF THE ACCESSIBLE PEDESTRIAN SIGNALS

REV. - MS

REVISIONS	
DRAWN	03-03-22
REVISED	
REVISED	
REVISED	

STD. 9-112

ACCESSIBLE PEDESTRIAN PUSH-BUTTON SIGNS SHALL BE MOUNTED ABOVE THE ACCESSIBLE PEDESTRIAN PUSH-BUTTON. THE SIGN SHALL BE BOLTED TO THE POSTS.

DETAILS		F.A.S. RTE.		SECTION		COUNTY		TOTAL SHEETS		SHEET NO.	
OLD IL 13 & MAIN ST (FAS 899/FAU 9559)		899		(8X,103)TS-2,5W-1		SALINE		17		15	
SCALE:		SHEET OF SHEETS		STA. TO STA.		ILLINOIS		FED. AID PROJECT		CONTRACT NO. 78909	

POLE STANDARDS

"INSTALL AND ORIENT ARM BRACKET OVER POLE TENON AND FIRMLY HAND TIGHTEN THE TWO SET SCREWS. USE THIRD HOLE IN ARM BRACKET AS A GUIDE TO DRILL A 3/16" DIAMETER HOLE THROUGH TENON. INSTALL AND TIGHTEN SELF-TAPPING SCREW. TIGHTEN SET SCREWS AN ADDITIONAL 1/4 TO 3/8 TURN WITH HEX KEY (NOT PROVIDED). INSTALL LOCKNUTS ON SET SCREWS IF THREADED PROJECTION ALLOWS."

POLE SHALL MEET AASHTO STANDARD SPECIFICATIONS FOR 80 MPH WIND LOADING AND 90 LB. 4.0 SQ. FT E.P.A. LUMINAIRE.

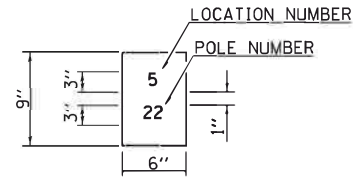

THE CONTRACTOR SHALL FURNISH AND INSTALL A LIGHT POLE IDENTIFICATION OF EACH NEW LIGHT POLE, AS SHOWN ABOVE, INCIDENTAL TO THE RESPECTIVE LIGHT POLE PAY ITEM. THE NUMERALS SHALL BE 3", SERIES "D", BLACK, SCREENED ON SILVER-WHITE TYPE B PRESSURE SENSITIVE REFLECTIVE SHEETING CONFORMING TO THE REQUIREMENTS OF SECTION T602.01 OF THE STANDARD SPECIFICATIONS FOR TRAFFIC CONTROL ITEMS. THE NUMERALS SHALL CONFORM TO THE FHWA "STANDARD ALPHABETS FOR HIGHWAY SIGNS".

THE LIGHT POLE IDENTIFICATION SHALL BE APPLIED TO SIGN BASE MATERIAL AS SPECIFIED IN SECTION 719.11 OF THE STANDARD SPECIFICATIONS, APPROXIMATELY 7" ABOVE THE ADJACENT PAVEMENT GRADE VISIBLE TO APPROACHING TRAFFIC IN ACCORDANCE WITH HIGHWAY STANDARD 720001.

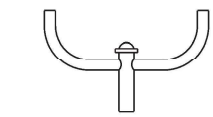

TWIN TENON

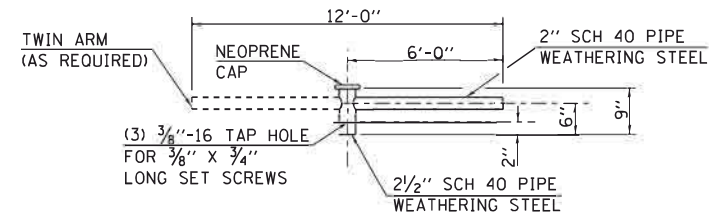

TENON MOUNT BRACKET ARM

NOTE: SINGLE OR TWIN ARM ASSEMBLY SHALL BE TILTED 3° ABOVE HORIZONTAL.

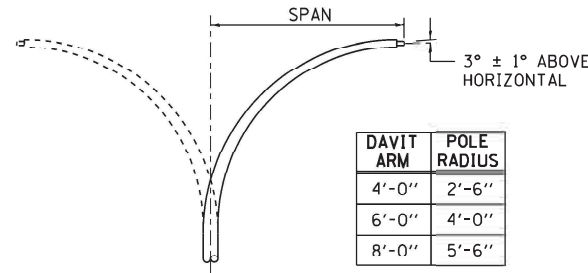

DAVIT ARM (AND OR)

DAVIT ARM-TWIN

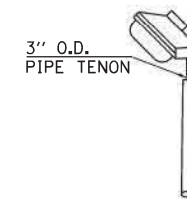

TENON

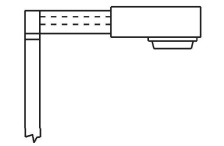

SHORT BRACKET

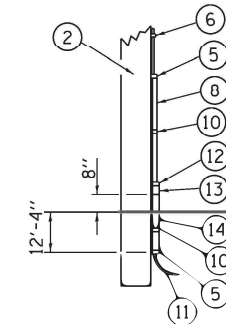

DETAILS FOR UNDERGROUND DISTRIBUTION IF REQUIRED

POLE, WOOD

POLE LENGTH	DEPTH IN GROUND
65'-0"	12'-0"
60'-0"	10'-0"
55'-0"	9'-0"
50'-0"	8'-0"
45'-0"	7'-0"
40'-0"	6'-6"
35'-0"	6'-0"
30'-0"	5'-6"

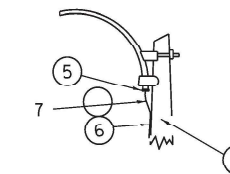

MAST ARM

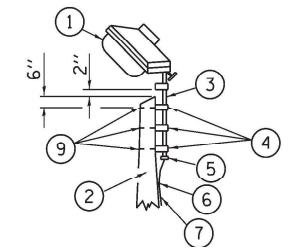

TENON

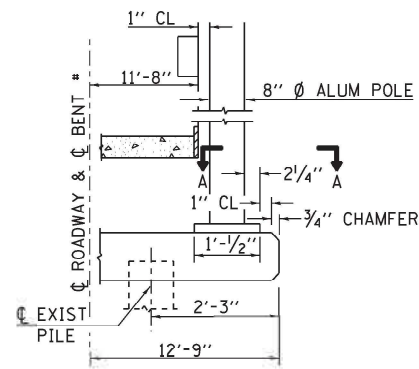

BENT #
(LOOKING)

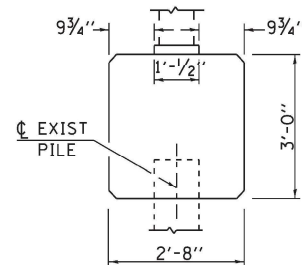

BRIDGE PIER MOUNT

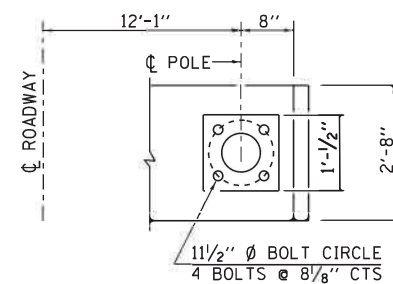

SECTION A-A

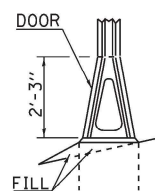

STAINLESS STEEL FLAIR BASE

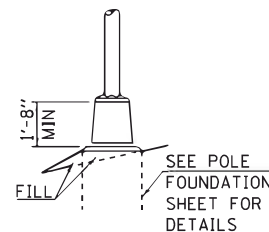

TRANSFORMER BASE
 FRANGIBLE

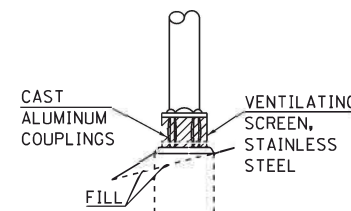

BREAKAWAY COUPLING

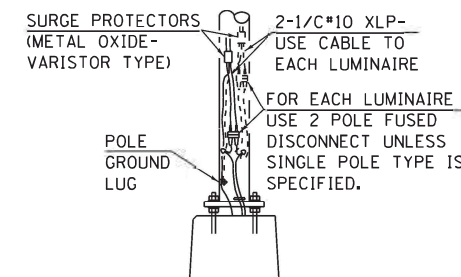

ANCHOR

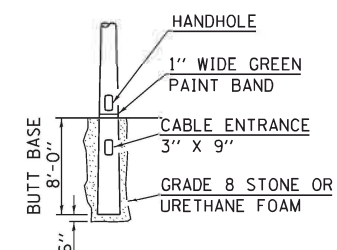

BUTT BASE

- ① LUMINAIRE
- ② WOOD POLE, CLASS 3 OR BETTER
- ③ 2 1/2" GALV. STEEL CONDUIT
- ④ SINGLE OFFSET POLE BAND
- ⑤ CONDUIT BUSHING
- ⑥ CABLE CLAMPS ON 2" CENTERS
- ⑦ 2/C #12 TYPE USE CABLE
- ⑧ 1" GALV. STEEL CONDUIT 10' IN LENGTH
- ⑨ 5/8" Ø HOT DIPPED GALVANIZED BOLT WITH FLAT WASHER & LOCKNUT (3 REQ'D)
- ⑩ CONDUIT CLAMPS ON 3' CENTERS
- ⑪ UNIT DUCT
- ⑫ THREADED REDUCER
- ⑬ "C" CONDULET, THREADED
- ⑭ 1 1/2" GALV. STEEL CONDUIT FOR 1 UNIT DUCT OR 3" GALV. STEEL CONDUIT FOR 2 OR 3 UNIT DUCTS.

REV. - MS

REVISIONS	
DRAWN	2-9-01
REVISED	4-14-02
RESIZED	5-6-08
REVIEWED	5-17-13

STD. 9-115

MODEL: 04/03/11
FILE NAME: I:\2021\6085\6085.dwg
DRAWN: JPH
CHECKED: JPH
DATE: 10/12/2022

USER NAME = ighimire	DESIGNED -	REVISED -
	DRAWN -	REVISED -
PLOT SCALE = 10.0000 sf / in	CHECKED -	REVISED -
PLOT DATE = 10/12/2022	DATE -	REVISED -

STATE OF ILLINOIS
DEPARTMENT OF TRANSPORTATION

POLE STANDARDS DETAILS
OLD IL 13 & MAIN ST (FAS 899FAU 9559)

SCALE: SHEET OF 16 SHEETS STA. TO STA.

F.A.S. RTE.	SECTION	COUNTY	TOTAL SHEETS	SHEET NO.
899	(8X,103)T5-2.5W-1	SALINE	17	16
				CONTRACT NO. 78909
ILLINOIS FED. AID PROJECT				

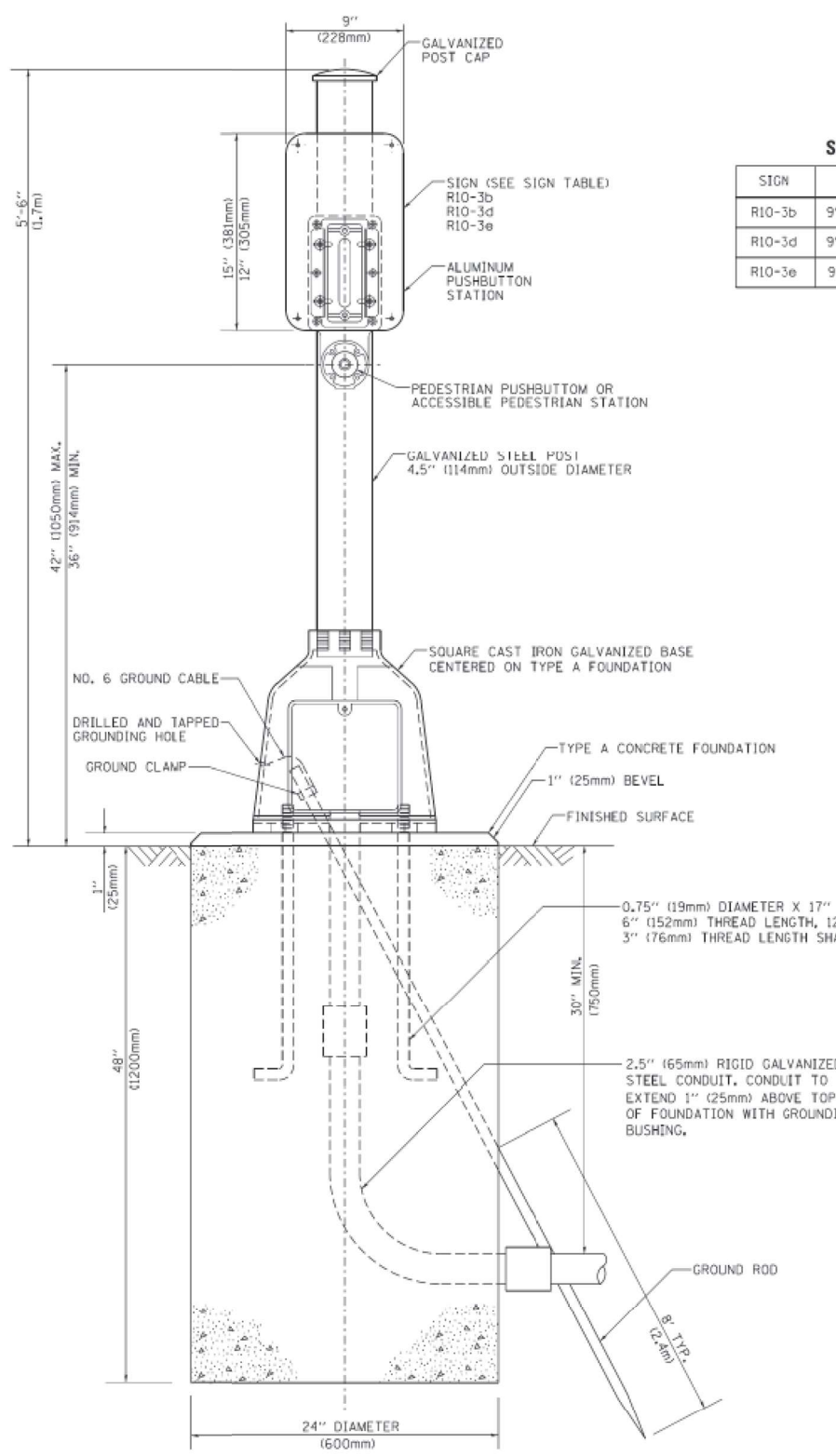

SIGN TABLE

SIGN	DIMENSIONS
R10-3b	9" (228mm) X 12" (305mm)
R10-3d	9" (228mm) X 12" (305mm)
R10-3e	9" (228mm) X 15" (381mm)

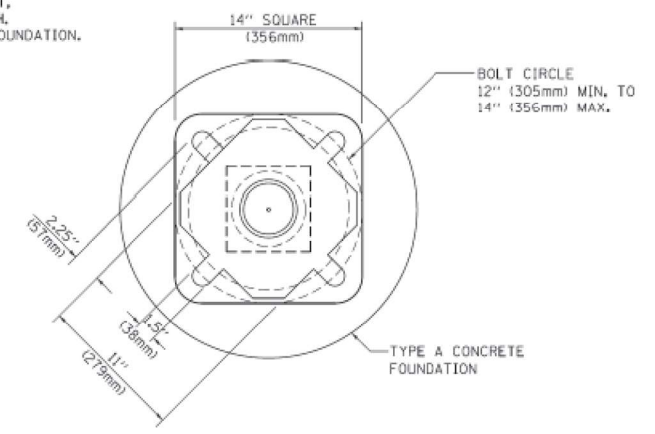

BOLT PATTERN
PEDESTRIAN PUSH BUTTON POST, TYPE A

MODEL: Default
FILE NAME: I:\2021\6085\Cadd\Design\Plan\206685-shc-cta.tbl.dgn

USER NAME = ighimire	DESIGNED -	REVISED -
PLOT SCALE = 10,0000 sf / in.	DRAWN -	REVISED -
PLOT DATE = 10/12/2022	CHECKED -	REVISED -
	DATE -	REVISED -

STATE OF ILLINOIS
DEPARTMENT OF TRANSPORTATION

PEDESTRIAN PUSH BUTTON POST DETAIL
OLD IL 13 & MAIN ST (FAS 899FAU 9559)

SCALE: SHEET OF SHEETS STA. TO STA.

F.A.S. RTE.	SECTION	COUNTY	TOTAL SHEETS	SHEET NO.
899	(8X,103)TS-2,SW-1	SALINE	17	17
CONTRACT NO. 78909				
ILLINOIS FED. AID PROJECT				