

SECTION 3, TOWNSHIP 33, RANGE 1E
 SECTION 4, TOWNSHIP 33, RANGE 1E
 SECTION 9, TOWNSHIP 33, RANGE 1E
 SECTION 10, TOWNSHIP 33, RANGE 1E

01-20-2023 LETTING ITEM 071

STATE OF ILLINOIS
 DEPARTMENT OF TRANSPORTATION

| F.A.U. RTE. | SECTION | COUNTY | TOTAL SHEETS | SHEET NO. |
|-------------|----------------|-----------------------|--------------|-----------|
| 6104 | 22-00084-00-RS | LASALLE | 10 | 1 |
| | | ILLINOIS CONTRACT NO. | 87807 | |

INDEX OF SHEETS

1. COVER SHEET
2. GENERAL NOTES & SUMMARY OF QUANTITIES
3. TYPICAL SECTIONS
4. - 10. PLAN SHEETS

HIGHWAY STANDARDS

- | | |
|-----------|---|
| 000001-08 | STANDARD SYMBOLS, ABBREVIATIONS AND PATTERNS |
| 280001-07 | TEMPORARY EROSION CONTROL SYSTEMS |
| 606001-08 | CONCRETE CURB TYPE B AND COMBINATION CONCRETE CURB AND GUTTER |
| 701001-02 | OFF-ROAD OPERATIONS, 2L, 2W, MORE THAN 15' AWAY |
| 701006-05 | OFF-ROAD OPERATIONS, 2L, 2W, 15' TO 24" FROM PAVEMENT EDGE |
| 701301-04 | LANE CLOSURE, 2L, 2W, SHORT TIME OPERATIONS |
| 701311-03 | LANE CLOSURE 2L, 2W MOVING OPERATIONS - DAY ONLY |
| 701501-06 | URBAN LANE CLOSURE, 2L, 2W, UNDIVIDED |
| 701901-08 | TRAFFIC CONTROL DEVICES |
| 780001-05 | TYPICAL PAVEMENT MARKINGS |

PROPOSED PLANS FOR
 FEDERAL AID HIGHWAY

CITY OF LA SALLE
 FAU 6104 (CHARTRES STREET)
 SECTION 22-00084-00-RS
 PROJECT A583(027)
 LASALLE COUNTY
 C-93-019-23

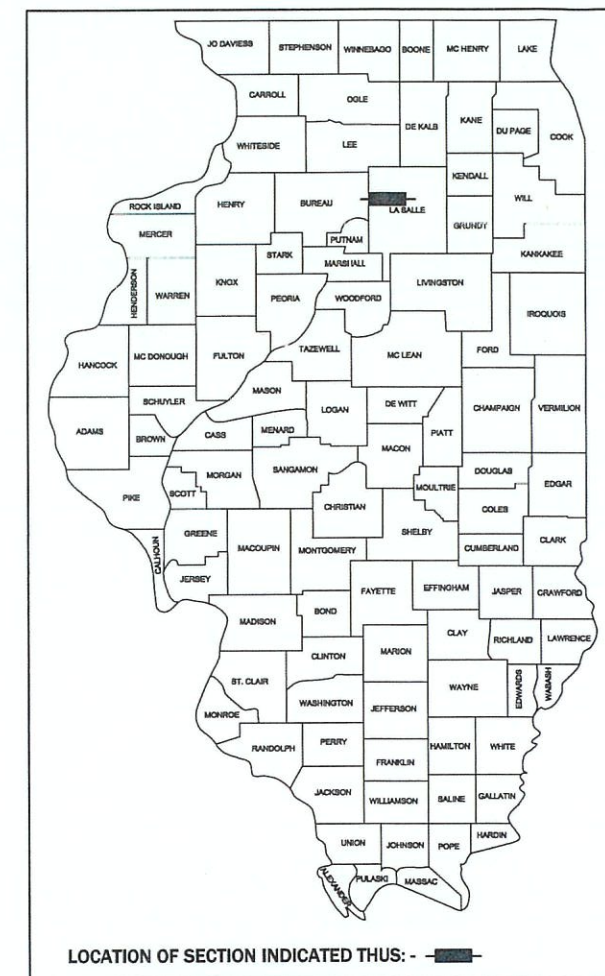

LOCATION OF SECTION INDICATED THIS: - [Symbol] -
 FAU 6104 (CHARTRES STREET)
 FUNCTIONAL CLASSIFICATION: MINOR ARTERIAL
 ADT = 2850 (2020)
 POSTED SPEED = 30 MPH

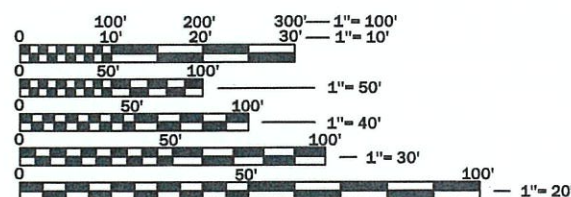

FULL SIZE PLANS HAVE BEEN PREPARED USING STANDARD ENGINEERING SCALES. REDUCED SIZED PLANS WILL NOT CONFORM TO STANDARD SCALES. IN MAKING MEASUREMENTS ON REDUCED PLANS, THE ABOVE SCALES MAY BE USED.

J.U.L.I.E.
 JOINT UTILITY LOCATION INFORMATION FOR EXCAVATION
 1-800-892-0123
 OR 811

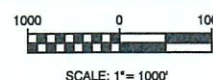
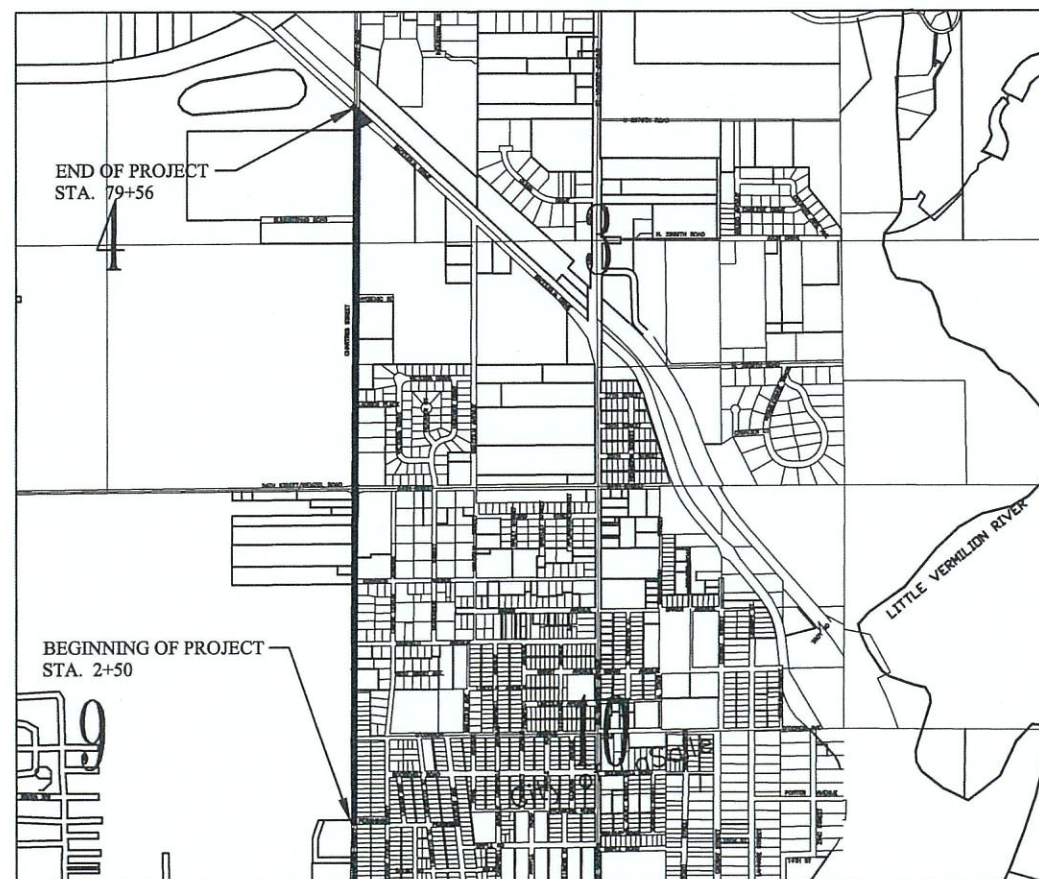

GROSS LENGTH = 7,706 FT. = 1.46 MILES
 NET LENGTH = 7,706 FT. = 1.46 MILES

PREPARED BY OR UNDER THE DIRECT SUPERVISION OF:

[Signature]

DATED THIS 20TH DAY OF OCTOBER, 2022



LICENSE EXPIRES 11/30/23

STATE OF ILLINOIS
 DEPARTMENT OF TRANSPORTATION

SUBMITTED OCTOBER 10, 2022
Jeff Grove
 JEFF GROVE, MAYOR - CITY OF LA SALLE
 PASSED NOVEMBER 9, 2022
[Signature]
 DISTRICT 3 LOCAL ROADS AND STREET ENGINEER
 RELEASED FOR NOVEMBER 9, 2022
[Signature]
 LIMITED REVIEW REGION 2 ENGINEER

PRINTED BY THE AUTHORITY
 OF THE STATE OF ILLINOIS

DISTRICT 3 NO. (815) 434-6131
 CONTRACT NO. 87807

GENERAL NOTES

THE THICKNESS OF THE HOT-MIX ASPHALT SHOWN ON THE PLANS IS A NOMINAL THICKNESS. DEVIATIONS FROM NOMINAL THICKNESS WILL BE PERMITTED WHEN SUCH DEVIATIONS OCCUR DUE TO REGULARITIES IN THE EXISTING SURFACE OR BASE ON WHICH THE HOT-MIX ASPHALT IS PLACED.

THE ENGINEER WILL BE THE SOLE JUDGE CONCERNING CURING TIME FOR VARIOUS HOT-MIX ASPHALT LIFTS.

FOR STABILIZATION, ALL TYPE III BARRICADES WILL REQUIRE A MINIMUM OF FOUR (4) SAND BAGS PER BARRICADE.

CONTRACTOR SHALL NOTIFY J.U.L.I.E. AT LEAST 48 HOURS PRIOR TO EXCAVATION.

CONTRACTOR SHALL INSTALL "ROAD CONSTRUCTION AHEAD" SIGNS ON ALL CROSS ROADWAYS, PLACED EAST AND WEST OF CHARTRES STREET. SIGNS TO BE 48" X 48" WITH A BLACK DIRECTIONAL ARROW ON FLUORESCENT ORANGE BACKGROUND.

THE FOLLOWING RATES OF APPLICATION HAVE BEEN USED IN CALCULATING PLAN QUANTITIES:

| BITUMINOUS MATERIAL (PRIME COAT) | | |
|--|----------------------------------|-----------------|
| SURFACE TYPE | ESTIMATED TRUCK APPLICATION RATE | RESIDUAL RATE |
| AGGREGATE BASES | 0.375 GAL/SQ YD | N/A |
| MILLED HMA OR PCC PAVEMENT | 0.08 GAL/SQ YD | 0.04 GAL/SQ YD |
| EXISTING PAVEMENT | 0.05 GAL/SQ YD | 0.025 GAL/SQ YD |
| FOG COAT (BETWEEN ADDITIONAL HMA LIFTS) | 0.05 GAL/SQ YD | 0.025 GAL/SQ YD |

ESTIMATED TRUCK APPLICATION RATE USED FOR CALCULATING PLAN QUANTITIES

**CONSTRUCTION TYPE CODE 005
SUMMARY OF QUANTITIES**

| ITEM CODE | ITEM DESCRIPTION | QUANTITY | UNIT |
|---------------------|--|----------|------|
| 40600290 | BITUMINOUS MATERIALS (TACK COAT) | 17861 | LBS |
| 40602965 | HOT-MIX ASPHALT BINDER COURSE, IL 9.5FG, N50 | 1852 | TON |
| 40604000 | HOT-MIX ASPHALT SURFACE COURSE, IL 9.5FG, MIX "C", N50 | 1852 | TON |
| Δ 44000158 | HOT-MIX ASPHALT SURFACE REMOVAL, 2-1/4" | 28090 | SY |
| Δ 44000500 | COMBINATION CURB AND GUTTER REMOVAL | 841 | FT |
| 44201747 | CLASS D PATCHES, TYPE IV, 8" | 45 | SY |
| 48101200 | AGGREGATE SHOULDERS, TYPE B | 209 | TON |
| Δ 60255500 | MANHOLES TO BE ADJUSTED | 7 | EACH |
| Δ 60260100 | INLETS TO BE ADJUSTED | 20 | EACH |
| Δ 60266600 | VALVE BOXES TO BE ADJUSTED | 10 | EACH |
| 60605000 | COMBINATION CONCRETE CURB AND GUTTER, TY B-6.24 | 951 | FT |
| 67100100 | MOBILIZATION | 1 | L.S. |
| 70102620 | TRAFFIC CONTROL AND PROTECTION 701501 | 1 | L.S. |
| * 78000100 | THERMOPLASTIC PAVEMENT MARKING - LETTERS AND SYMBOLS | 142 | SF |
| * 78000200 | THERMOPLASTIC PAVEMENT MARKING - LINE 4" | 9429 | FT |
| * 78000500 | THERMOPLASTIC PAVEMENT MARKING - LINE 8" | 645 | FT |
| * 78000600 | THERMOPLASTIC PAVEMENT MARKING - LINE 12" | 422 | FT |
| * 78000650 | THERMOPLASTIC PAVEMENT MARKING - LINE 24" | 322 | FT |
| * 78005180 | EPOXY PAVEMENT MARKING - LINE 24" | 54 | FT |
| * SPECIALTY ITEM | | | |
| Δ SPECIAL PROVISION | | | |

| | | | | |
|---------------------|----------------|---------|--------------------|-----------|
| FAU. RTE. | SECTION | COUNTY | TOTAL SHEETS | SHEET NO. |
| 6104 | 22-00084-00-RS | LASALLE | 10 | 3 |
| FED. ROAD DIST. NO. | ILLINOIS | | CONTRACT NO. 87807 | |

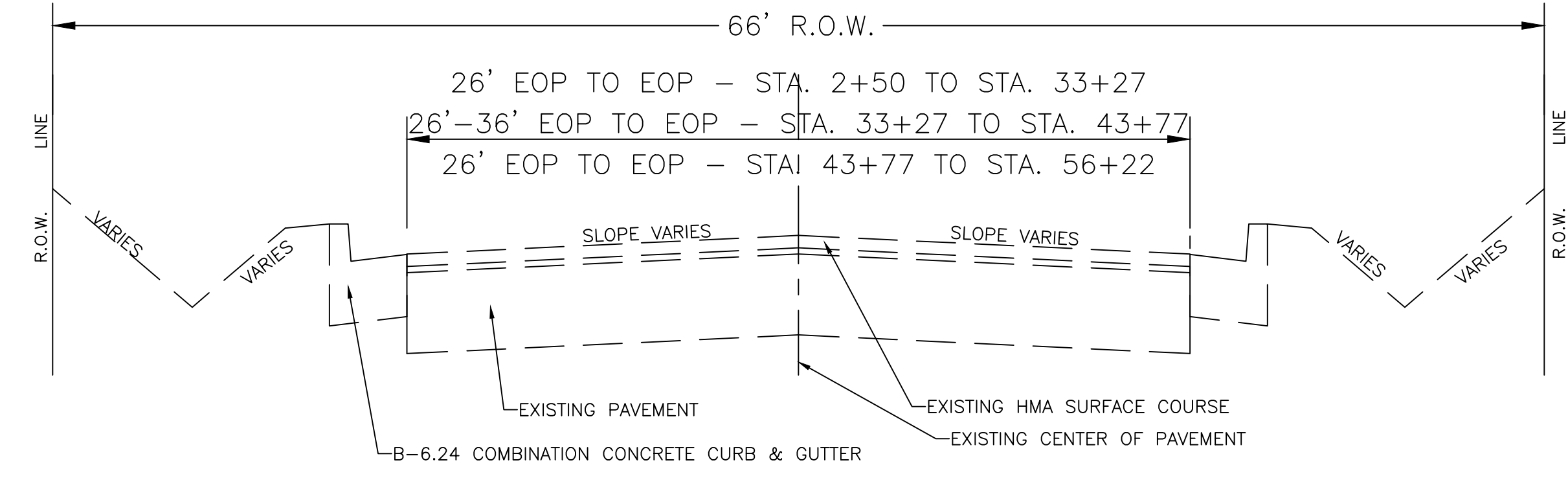

EXISTING TYPICAL SECTION
2+50 to 56+22
CHARTRES STREET
 N.T.S.

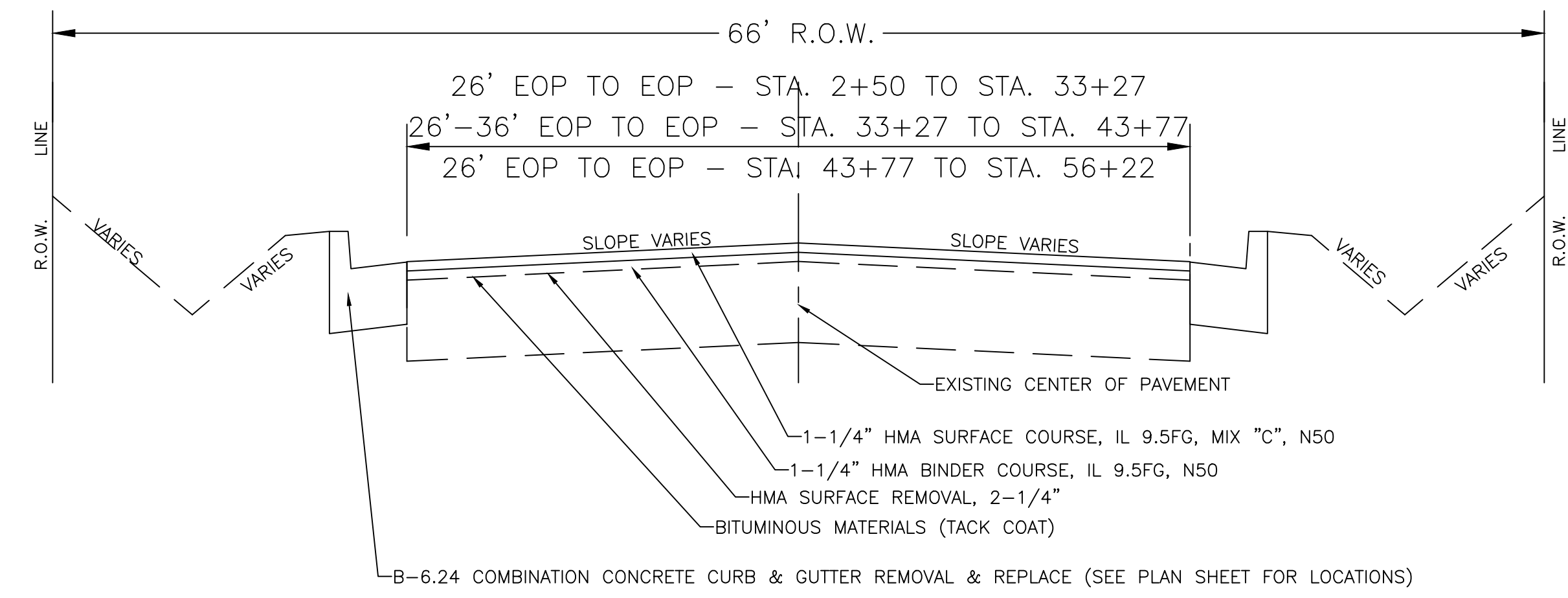

PROPOSED TYPICAL SECTION
2+50 to 56+22
CHARTRES STREET
 N.T.S.

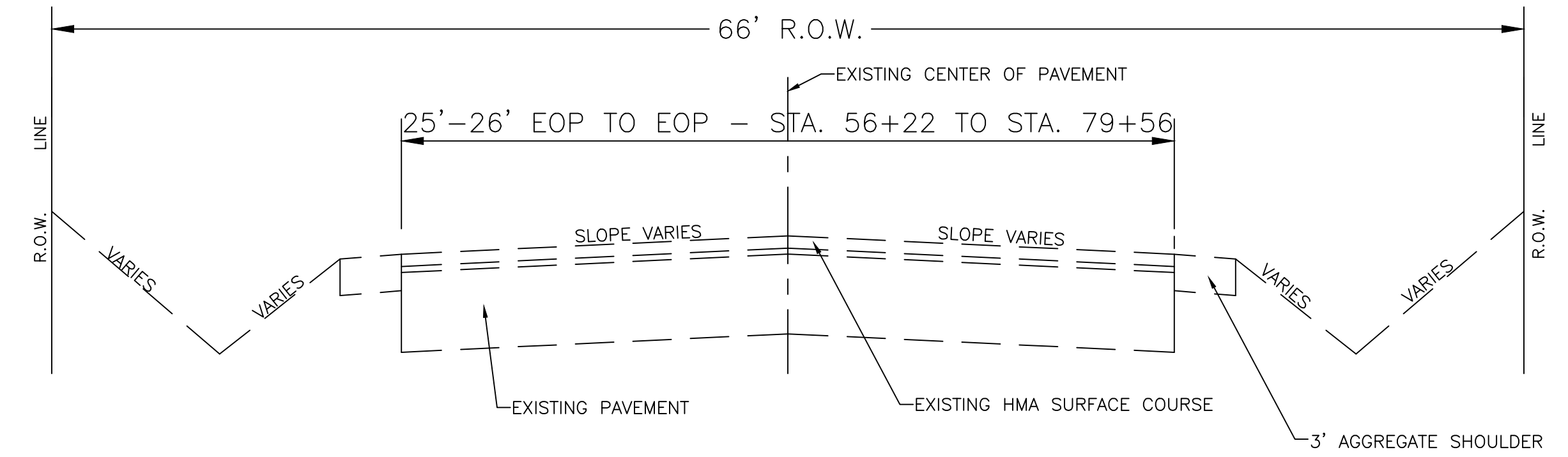

EXISTING TYPICAL SECTION
56+22 to 79+56
CHARTRES STREET
 N.T.S.

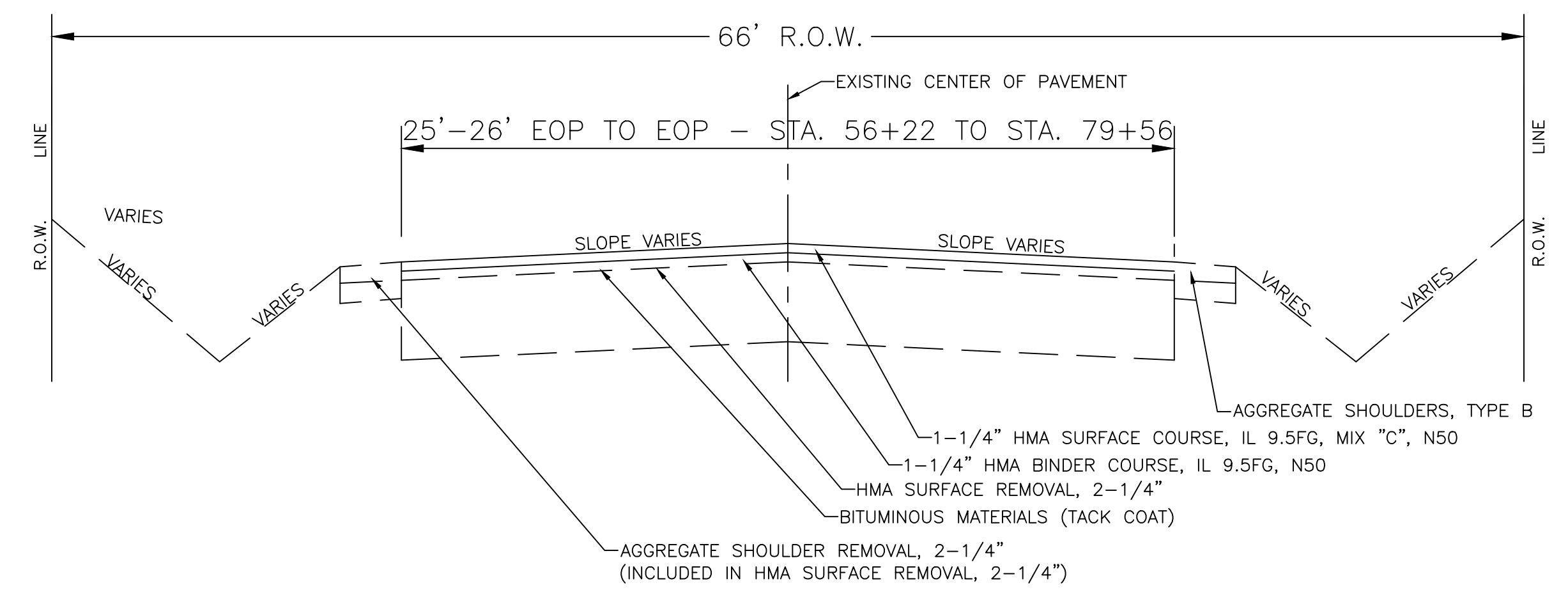

PROPOSED TYPICAL SECTION
56+22 to 79+56
CHARTRES STREET
 N.T.S.

| HMA MIXTURE REQUIREMENT TABLE | | | |
|--|----------------|----------------|--------------------------|
| LOCATIONS: | ENTIRE PROJECT | ENTIRE PROJECT | ENTIRE PROJECT |
| MIXTURE USE(S): | HMA BINDER | HMA SURFACE | CLASS D PATCHING |
| BINDER GRADE (PG): | PG 64-22 | PG 64-22 | PG 64-22 |
| DESIGN AIR VOIDS: | 4.0% @ N50 | 4.0% @ N50 | 4.0% @ N50 |
| MIXTURE COMPOSITION: (MIXTURE GRADATION) | IL 9.5FG | IL 9.5FG | IL 19.0 |
| FRICTION AGGREGATE: | | MIXTURE C | |
| MIXTURE WEIGHT: | 112.0 LB/SY/IN | 112.0 LB/SY/IN | 112.0 LB/SY/IN |
| QUALITY MANAGEMENT PROGRAM: | QCQA | QCQA | QCQA |
| SUBLOT SIZE: | N/A | N/A | N/A |
| DENSITY TEST METHOD: | NUCLEAR/CORES | NUCLEAR/CORES | SATISFACTION OF ENGINEER |
| MATERIAL TRANSFER DEVICE (REQUIRED) | NO | NO | NO |

87807 - CHARTRES ST. IN LASALLE

| | | | | |
|---------------------|----------------|--------------------|--------------|-----------|
| FAU. RTE. | SECTION | COUNTY | TOTAL SHEETS | SHEET NO. |
| 6104 | 22-00084-00-RS | LASALLE | 10 | 4 |
| FED. ROAD DIST. NO. | ILLINOIS | CONTRACT NO. 87807 | | |

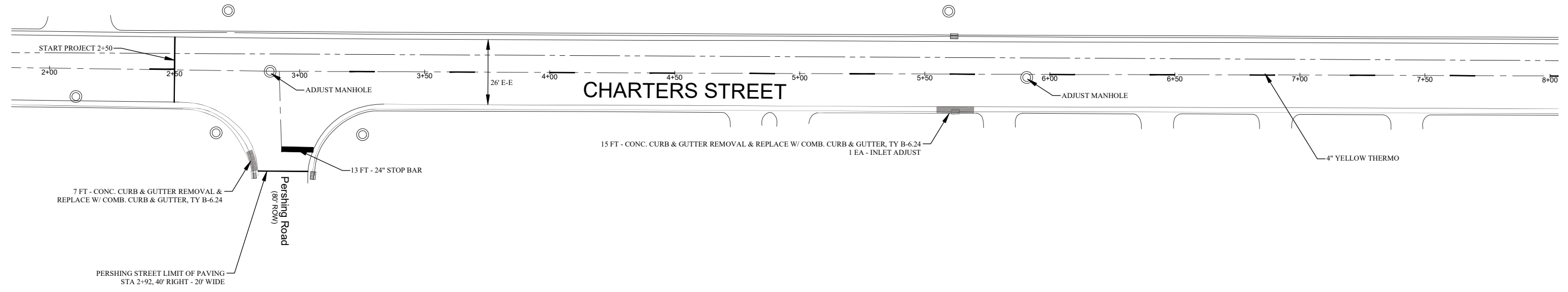
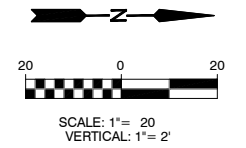

**DOUBLE PLAN SHEETS
CHARTRES STREET
STA. 2+00 TO STA. 8+00**

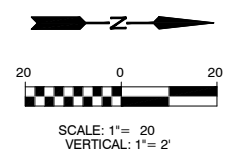
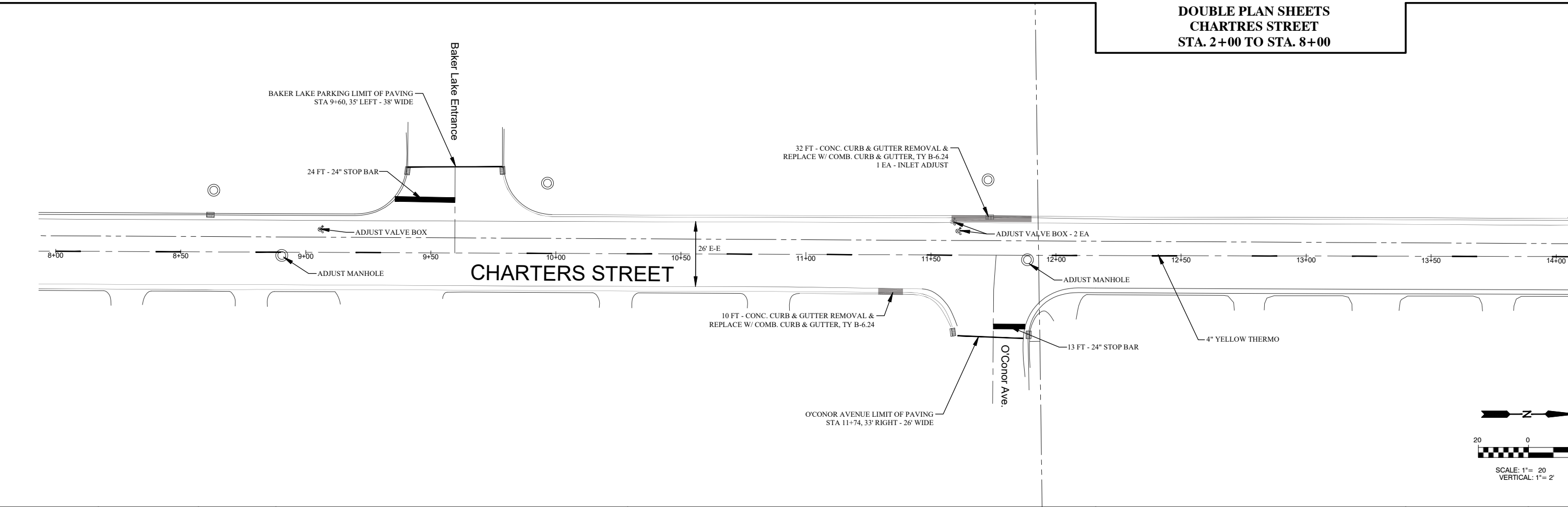

| | |
|---------------|-------|
| DRAWN BY: CJG | CAD: |
| CHECKED BY: | DATE: |

| REVISIONS | |
|-----------|----|
| DATE | BY |
| | |
| | |



**FAU 6104 (CHARTRES STREET)
SECTION 22-00084-00-RS
CITY OF LA SALLE, LA SALLE COUNTY**

**DOUBLE PLAN SHEETS
CHARTRES STREET
STA. 8+00 TO STA. 14+00**

| | |
|-------------------------|----------------|
| SCALE: 1" = 20' (Horz.) | SHEET 4 |
| FILE NO.: | OF 10 |

| | | | | |
|---------------------|----------------|----------|--------------------|-----------|
| FAU RTE. | SECTION | COUNTY | TOTAL SHEETS | SHEET NO. |
| 6104 | 22-00084-00-RS | LASALLE | 10 | 5 |
| FED. ROAD DIST. NO. | | ILLINOIS | CONTRACT NO. 87807 | |

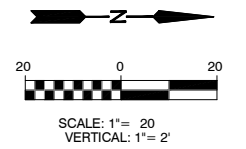
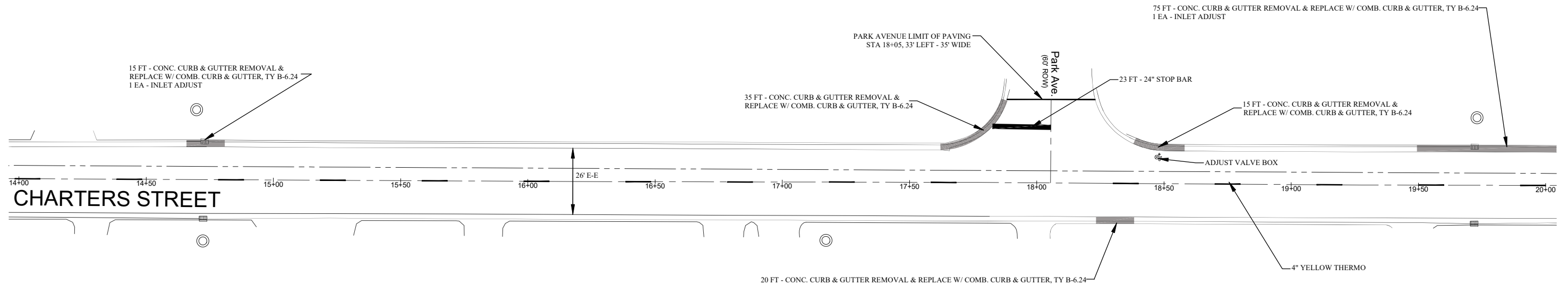

**DOUBLE PLAN SHEETS
CHARTRES STREET
STA. 14+00 TO STA. 20+00**

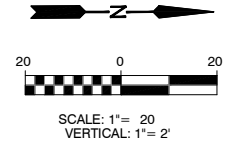
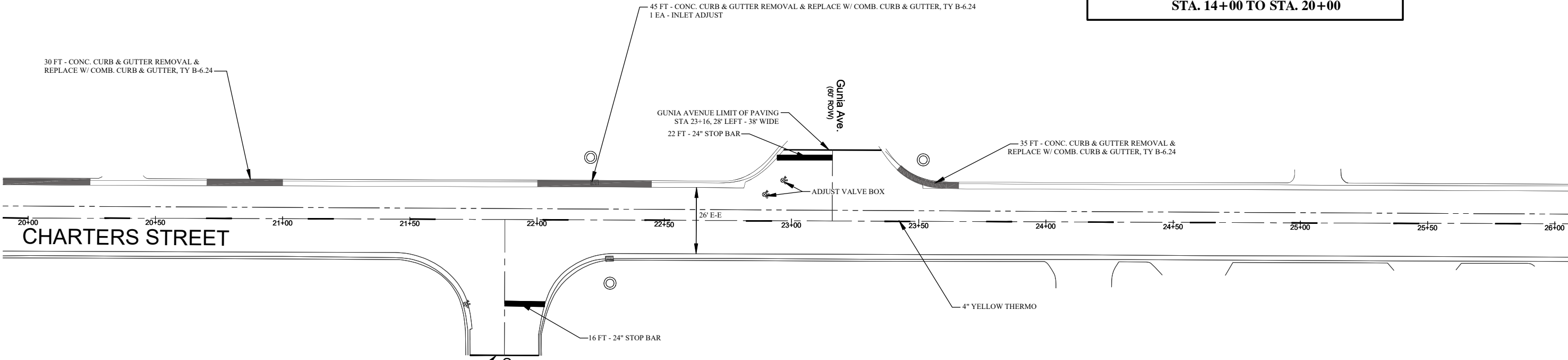

| | |
|---------------|-------|
| DRAWN BY: CJG | CAD: |
| CHECKED BY: | DATE: |

| REVISIONS | |
|-----------|----|
| DATE | BY |
| | |
| | |



THE CITY OF
LaSalle
ILLINOIS

**FAU 6104 (CHARTRES STREET)
SECTION 22-00084-00-RS
CITY OF LA SALLE, LA SALLE COUNTY**

**DOUBLE PLAN SHEETS
CHARTRES STREET
STA. 20+00 TO STA. 26+00**

| | |
|-------------------------|----------------|
| SCALE: 1" = 20' (Horz.) | SHEET 5 |
| FILE NO.: | OF 10 |

| | | | | |
|---------------------|----------------|----------|--------------------|-----------|
| FAU RTE. | SECTION | COUNTY | TOTAL SHEETS | SHEET NO. |
| 6104 | 22-00084-00-RS | LASALLE | 10 | 6 |
| FED. ROAD DIST. NO. | | ILLINOIS | CONTRACT NO. 87807 | |

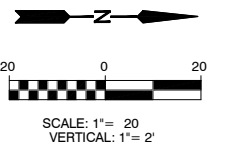
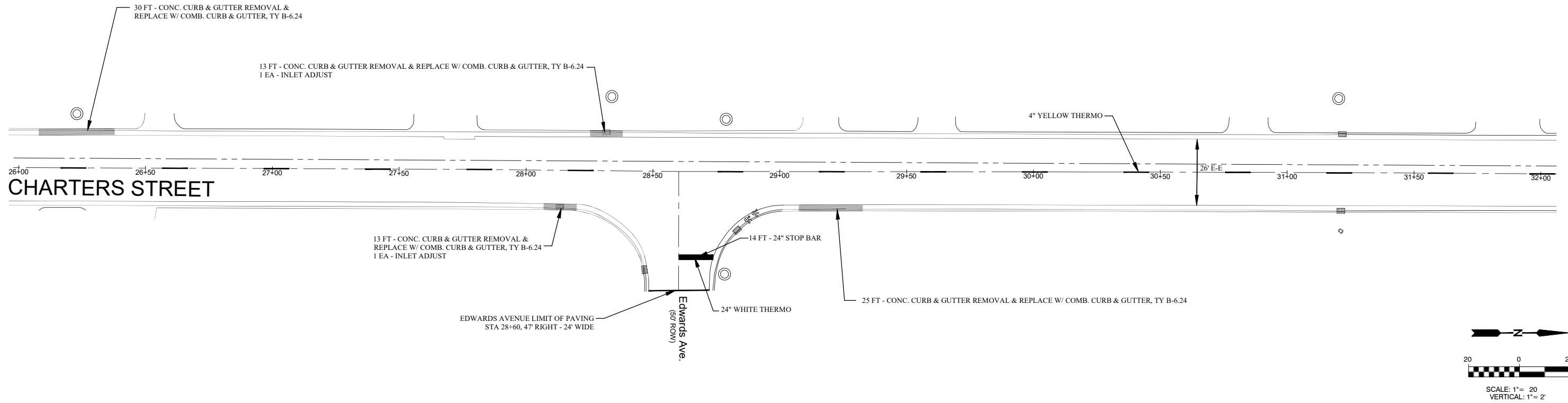

**DOUBLE PLAN SHEETS
CHARTRES STREET
STA. 26+00 TO STA. 32+00**

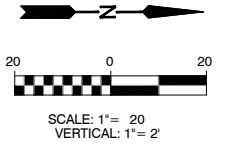
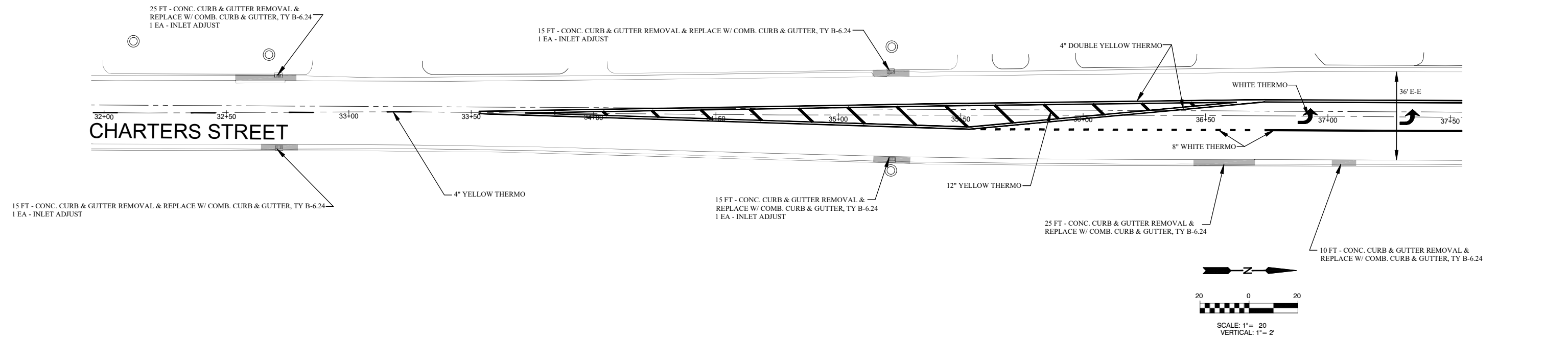

| | |
|---------------|-------|
| DRAWN BY: CJG | CAD: |
| CHECKED BY: | DATE: |

| REVISIONS | |
|-----------|----|
| DATE | BY |
| | |
| | |



**FAU 6104 (CHARTRES STREET)
SECTION 22-00084-00-RS
CITY OF LA SALLE, LA SALLE COUNTY**

**DOUBLE PLAN SHEETS
CHARTRES STREET
STA. 32+00 TO STA. 37+50**

| | |
|-------------------------|----------------|
| SCALE: 1" = 20' (Horz.) | SHEET 6 |
| FILE NO.: | OF 10 |

| | | | | |
|---------------------|----------------|----------|--------------------|-----------|
| FAU. RTE. | SECTION | COUNTY | TOTAL SHEETS | SHEET NO. |
| 6104 | 22-00084-00-RS | LASALLE | 10 | 7 |
| FED. ROAD DIST. NO. | | ILLINOIS | CONTRACT NO. 87807 | |

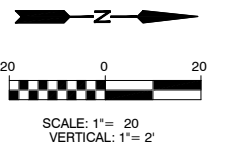
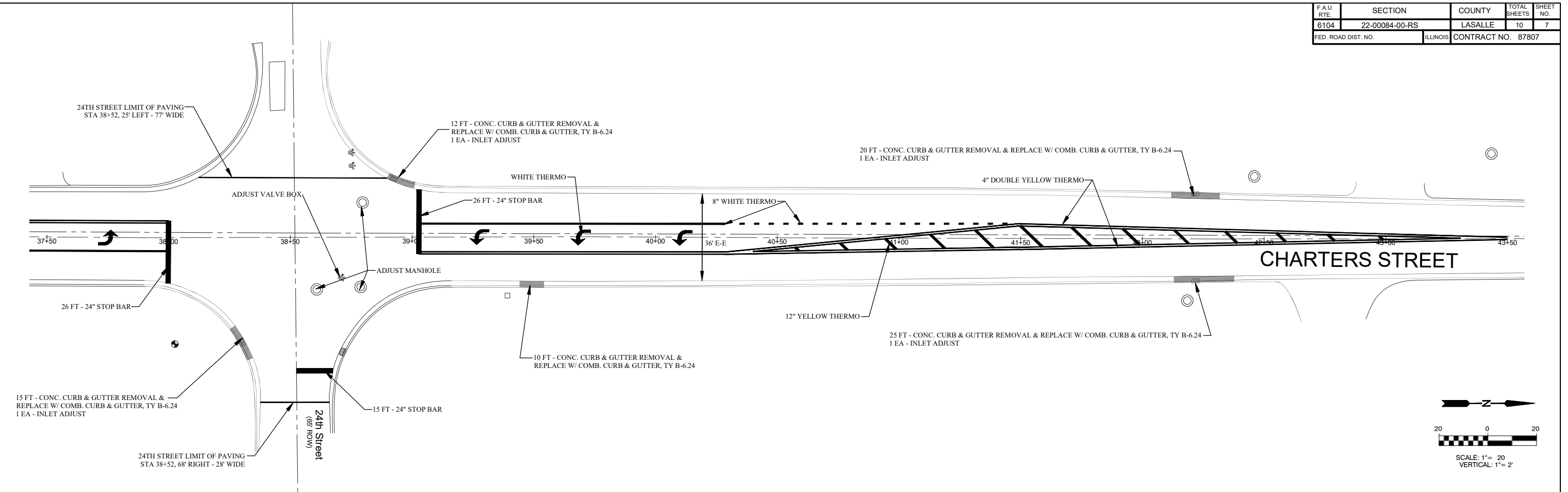

**DOUBLE PLAN SHEETS
CHARTRES STREET
STA. 37+50 TO STA. 43+50**

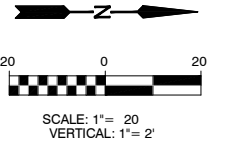
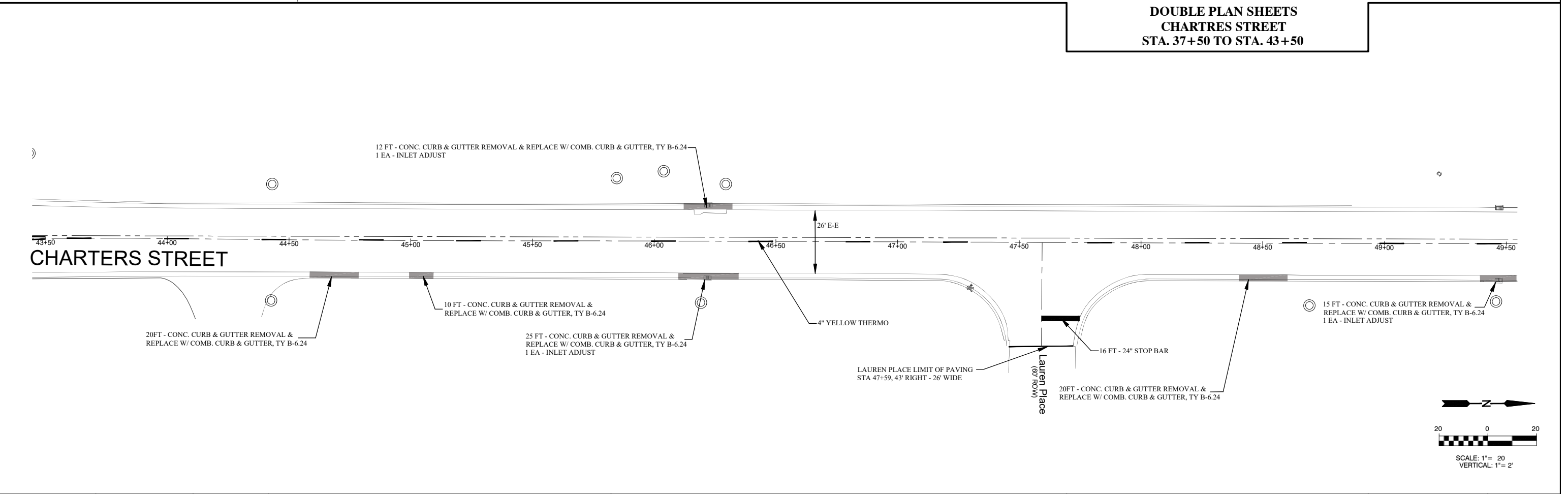

| | |
|---------------|-------|
| DRAWN BY: CJG | CAD: |
| CHECKED BY: | DATE: |

| REVISIONS | |
|-----------|----|
| DATE | BY |
| | |
| | |



**FAU 6104 (CHARTRES STREET)
SECTION 22-00084-00-RS
CITY OF LA SALLE, LA SALLE COUNTY**

**DOUBLE PLAN SHEETS
CHARTRES STREET
STA. 43+50 TO STA. 49+50**

| | |
|-------------------------|---------|
| SCALE: 1" = 20' (Horz.) | SHEET 7 |
| FILE NO.: | OF 10 |

| | | | | |
|---------------------|----------------|----------|--------------------|-----------|
| FAU. RTE. | SECTION | COUNTY | TOTAL SHEETS | SHEET NO. |
| 6104 | 22-00084-00-RS | LASALLE | 10 | 8 |
| FED. ROAD DIST. NO. | | ILLINOIS | CONTRACT NO. 87807 | |

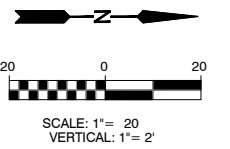
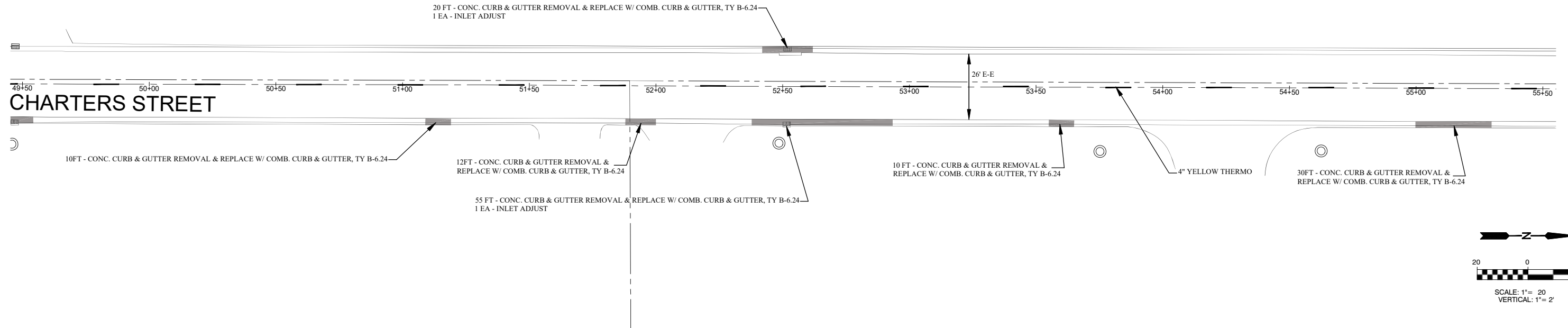

**DOUBLE PLAN SHEETS
CHARTRES STREET
STA. 49+50 TO STA. 55+50**

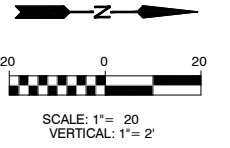
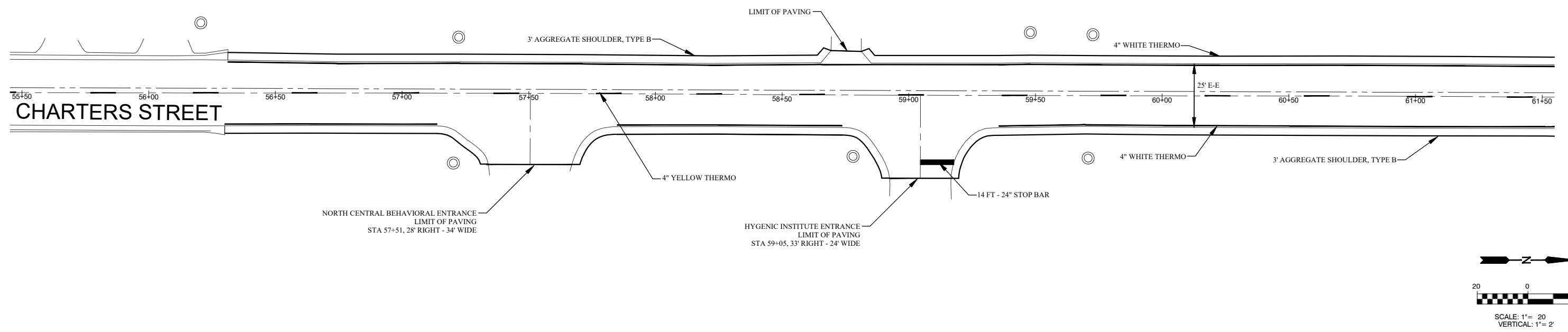

| | |
|---------------|-------|
| DRAWN BY: CJG | CAD: |
| CHECKED BY: | DATE: |

| REVISIONS | |
|-----------|----|
| DATE | BY |
| | |
| | |



THE CITY OF
LaSalle
ILLINOIS

**FAU 6104 (CHARTRES STREET)
SECTION 22-00084-00-RS
CITY OF LA SALLE, LA SALLE COUNTY**

**DOUBLE PLAN SHEETS
CHARTRES STREET
STA. 55+50 TO STA. 61+50**

| | |
|-------------------------|----------------|
| SCALE: 1" = 20' (Horz.) | SHEET 8 |
| FILE NO.: | OF 10 |

| | | | | |
|---------------------|----------------|----------|--------------------|-----------|
| FAU RTE. | SECTION | COUNTY | TOTAL SHEETS | SHEET NO. |
| 6104 | 22-00084-00-RS | LASALLE | 10 | 9 |
| FED. ROAD DIST. NO. | | ILLINOIS | CONTRACT NO. 87807 | |

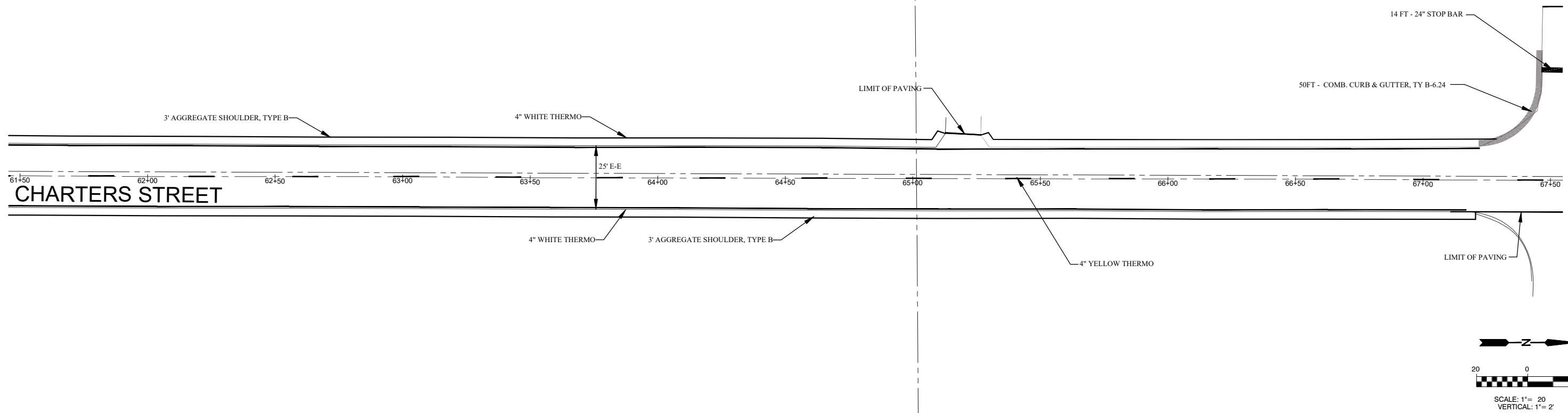

**DOUBLE PLAN SHEETS
CHARTRES STREET
STA. 61+50 TO STA. 67+50**

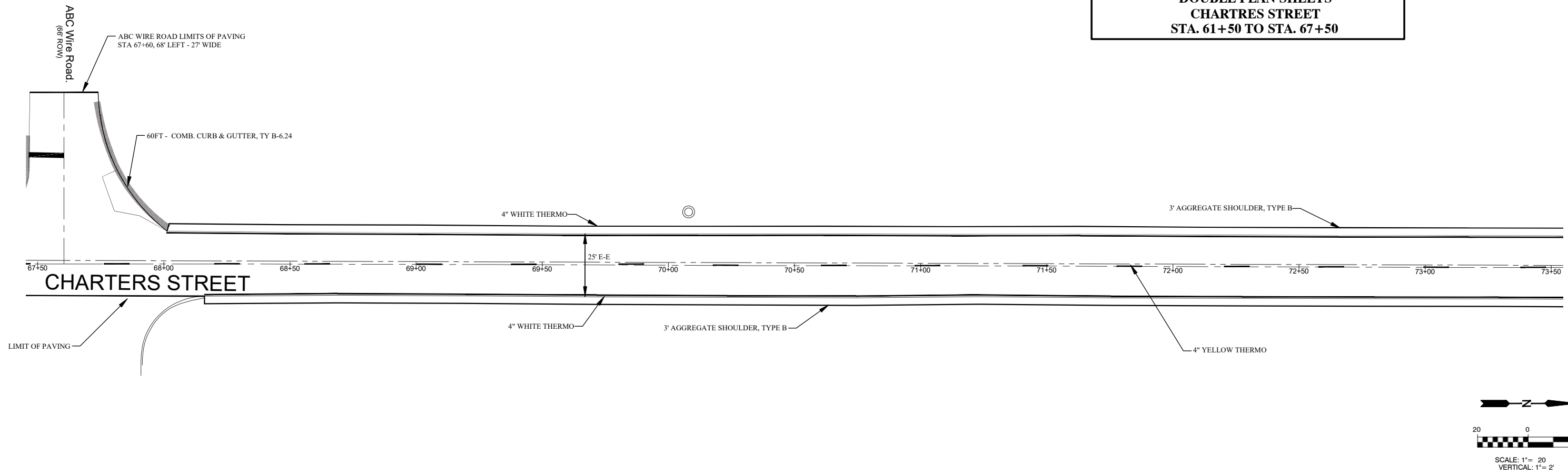

| | |
|---------------|-------|
| DRAWN BY: CJG | CAD: |
| CHECKED BY: | DATE: |

| REVISIONS | |
|-----------|----|
| DATE | BY |
| | |
| | |



**FAU 6104 (CHARTRES STREET)
SECTION 22-00084-00-RS
CITY OF LA SALLE, LA SALLE COUNTY**

**DOUBLE PLAN SHEETS
CHARTRES STREET
STA. 67+50 TO STA. 73+50**

| | |
|-------------------------|----------------|
| SCALE: 1" = 20' (Horz.) | SHEET 9 |
| FILE NO.: | OF 10 |

| | | | | |
|---------------------|----------------|----------|--------------------|-----------|
| FAU. RTE. | SECTION | COUNTY | TOTAL SHEETS | SHEET NO. |
| 6104 | 22-00084-00-RS | LASALLE | 10 | 10 |
| FED. ROAD DIST. NO. | | ILLINOIS | CONTRACT NO. 87807 | |

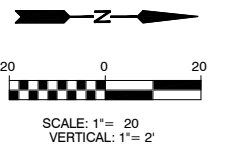
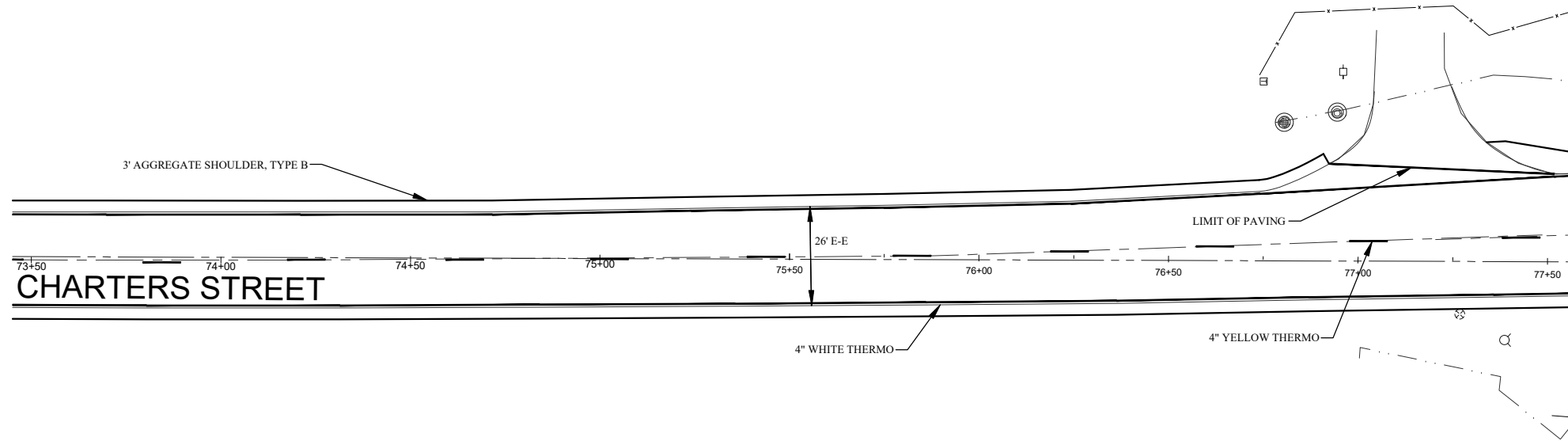

**DOUBLE PLAN SHEETS
CHARTRES STREET
STA. 73+50 TO 77+50**

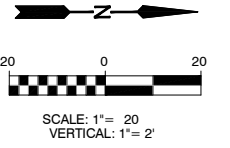
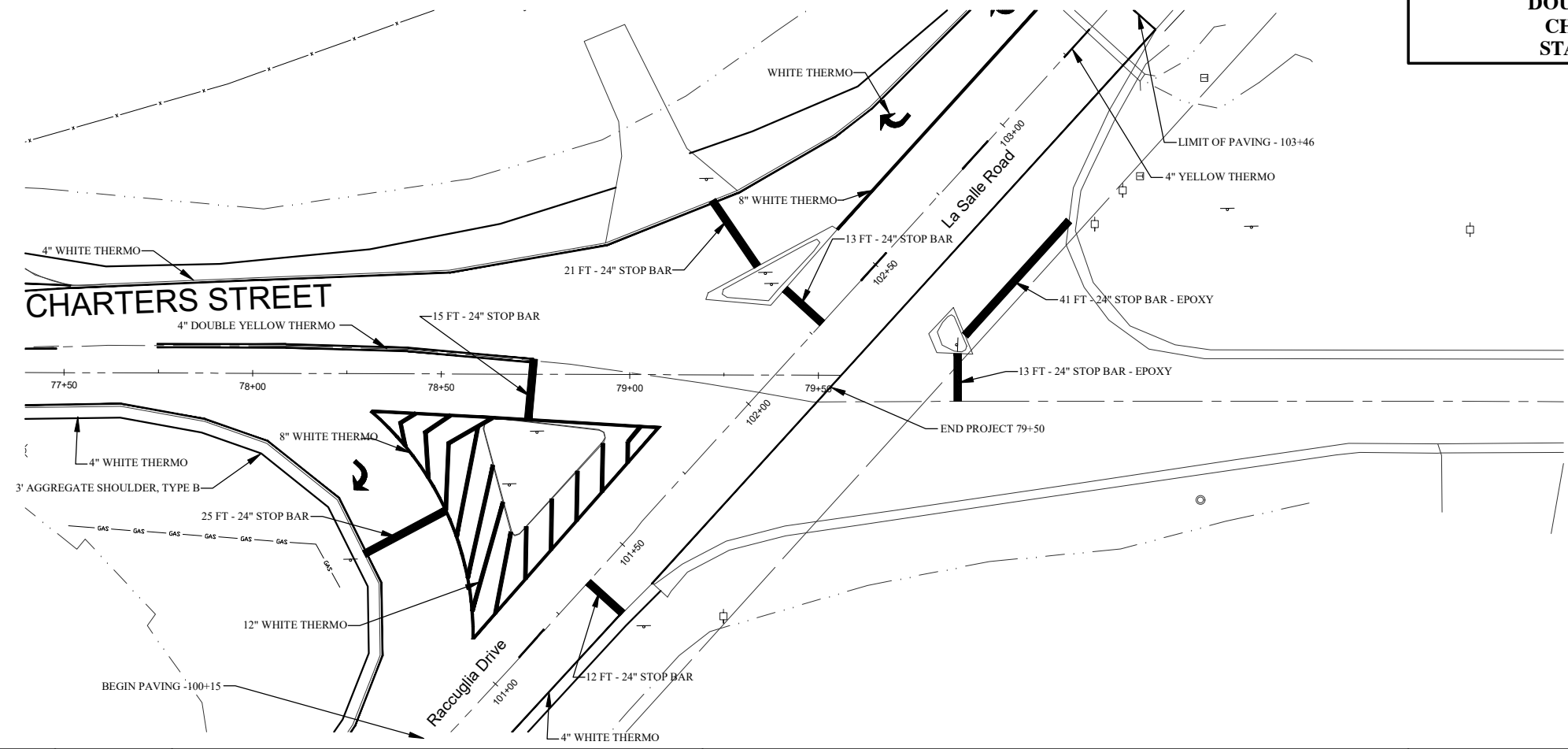

| | |
|------------------|-------|
| DRAWN BY: C.J.G. | CAD: |
| CHECKED BY: | DATE: |

| REVISIONS | |
|-----------|----|
| DATE | BY |
| | |
| | |



**FAU 6104 (CHARTRES STREET)
SECTION 22-00084-00-RS
CITY OF LA SALLE, LA SALLE COUNTY**

**DOUBLE PLAN SHEETS
CHARTRES STREET
STA. 77+50 TO END STA.**

| | |
|-------------------------|-----------------|
| SCALE: 1" = 20' (Horz.) | SHEET 10 |
| FILE NO.: | OF 10 |