

P.A.U. RTE.	SECTION	COUNTY	TOTAL SHEETS	SHEET NO.
1349	3197(A&B)RS	COOK	35	18
FED. ROAD DIST. NO. 1		ILLINOIS		HIGHWAY PROJECT

60721

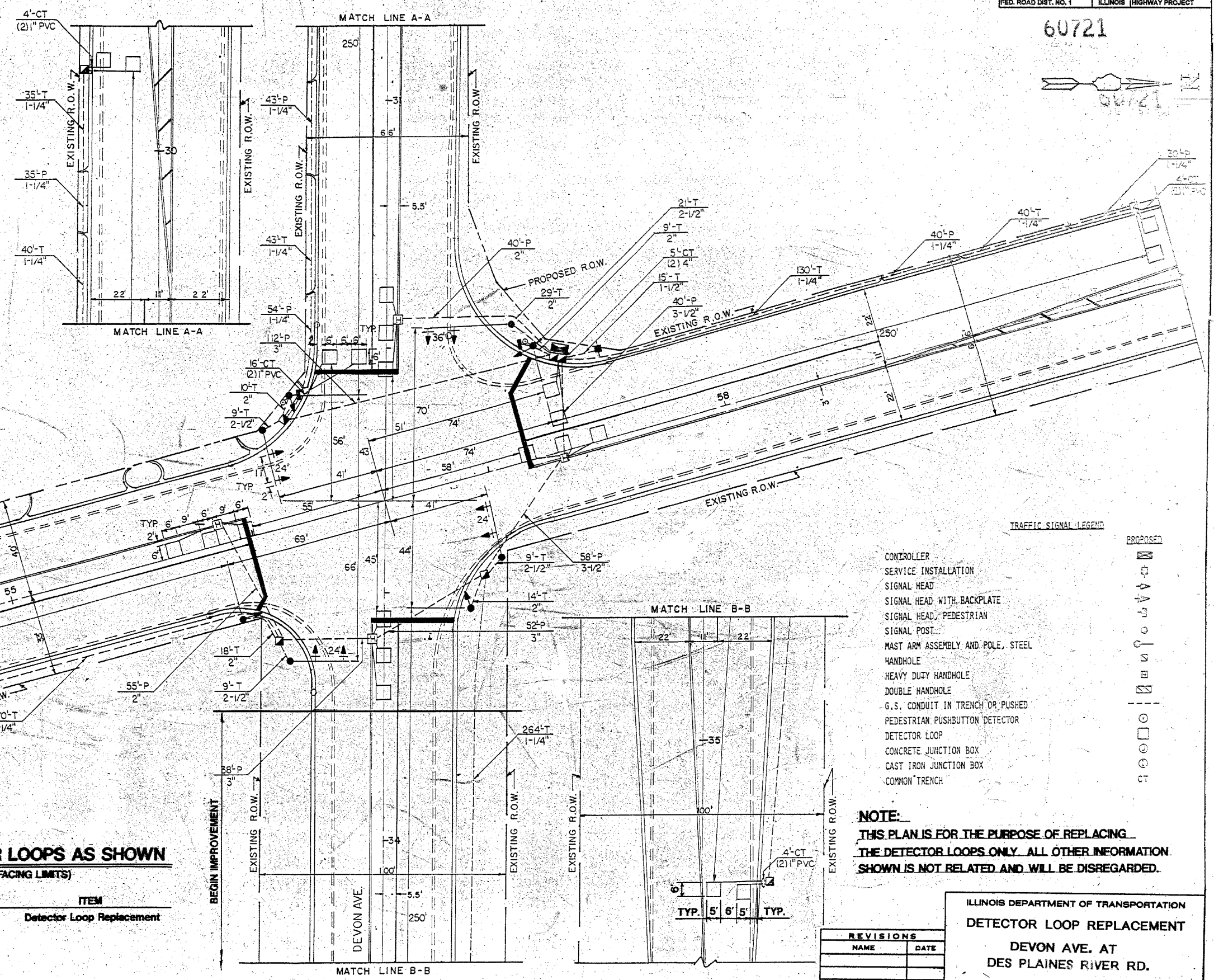

- GENERAL NOTES**
- ALL DETECTOR LOOPS SHALL CONSIST OF THE NUMBER OF TURNS REQUIRED AND SHALL BE INSTALLED IN STRICT CONFORMITY WITH THE LOOP DETECTOR AMPLIFIER MANUFACTURERS RECOMMENDATIONS. THE DETECTOR LOOP SHALL BE MEASURED FOR THAT PORTION OF SAW CUT BEYOND THE SPLICE AS SPECIFIED IN SECTION T 418.04 OF THE SPECIFICATIONS FOR TRAFFIC CONTROL ITEMS.
 - LEAD-IN WIRING SHALL BE INSTALLED IN STRICT CONFORMITY WITH THE MANUFACTURERS RECOMMENDATIONS. THE 2/C SHIELDED CABLE TO BE USED FOR THE DETECTOR LOOP LEAD-IN SHALL BE MEASURED FROM THE SPLICE TO THE CONTROLLER AS SPECIFIED IN SECTION T 421.04 OF THE STANDARD SPECIFICATIONS FOR TRAFFIC CONTROL ITEMS. FLAT CABLE WILL NOT BE PERMITTED.
 - ALL SIGNAL AND DETECTOR ELECTRIC CABLE THAT IS FURNISHED BY THE CONTRACTOR SHALL BE PROTECTED BY POLETHYLENE INSULATION WITH A POLYVINYLCHLORIDE JACKET. SERVICE CABLE MAY HAVE AN XLP JACKET.
 - THE REMOVAL AND REPLACEMENT OF SIDEWALK, DRIVEWAY, MEDIAN AND ISLAND SURFACE PAVING AT HANDHOLES, JACKING PITS, INSPECTION OPENINGS AND CONCRETE JUNCTION BOXES SHALL BE SAW CUT AROUND THE AREA TO BE REMOVED. THE REMOVAL AND REPLACEMENT OF SIDEWALK, DRIVEWAY, MEDIAN AND ISLAND SURFACE PAVING WILL BE PAID FOR SEPARATELY.
 - THE EXACT LOCATION OF ALL UTILITIES SHALL BE FIELD VERIFIED BY THE CONTRACTOR BEFORE THE INSTALLATION OF ANY COMPONENTS OF THE TRAFFIC SIGNAL SYSTEM. FOR LOCATION OF UTILITIES CALL J.U.L.I.E. TOLL FREE NUMBER 800-892-0123 AND STATE MAINTAINED TRAFFIC SIGNAL 312-379-2800.
 - ALL SIGNAL POST AND MAST ARM POLES SHALL BE LOCATED WITH THEIR CENTERLINES A MINIMUM OF FOUR (4) AND SIX (6) FEET RESPECTIVELY FROM THE BACK OF CURB UNLESS NOTED OR DIMENSIONS TO THE CONTRARY ON THE DRAWINGS. IN NON-CURBED AREAS THE MAST ARM POLE SHALL BE LOCATED A MINIMUM OF TEN (10) FEET BEHIND THE EDGE OF PAVEMENT OR TWO (2) FEET BEHIND THE EDGE OF SHOULDER, WHICHEVER DISTANCE IS GREATER. SIGNAL POSTS SHOULD BE PLACED AT A MINIMUM OF TWO (2) FEET BEHIND THE EDGE OF THE SHOULDER.
 - FOR THE LOCATION OF ALL LOOPS AT THIS INTERSECTION, CONTACT THE I.D.O.T. AREA TRAFFIC SIGNAL ENGINEER AT 334-4139 WHO WILL MARK THE PAVEMENT FOR THE CUTTING OF THE LOOPS.



REPLACE ALL DETECTOR LOOPS AS SHOWN
(WITHIN THE RESURFACING LIMITS)

CODE NO.	QUANTITY	UNIT	ITEM
88600600	66	Foot	Detector Loop Replacement

TRAFFIC SIGNAL LEGEND

PROPOSED	[Symbol]
CONTROLLER	[Symbol]
SERVICE INSTALLATION	[Symbol]
SIGNAL HEAD	[Symbol]
SIGNAL HEAD WITH BACKPLATE	[Symbol]
SIGNAL HEAD, PEDESTRIAN	[Symbol]
SIGNAL POST	[Symbol]
MAST ARM ASSEMBLY AND POLE, STEEL	[Symbol]
HANDHOLE	[Symbol]
HEAVY DUTY HANDHOLE	[Symbol]
DOUBLE HANDHOLE	[Symbol]
G.S. CONDUIT IN TRENCH OR PUSHED	[Symbol]
PEDESTRIAN PUSHBUTTON DETECTOR	[Symbol]
DETECTOR LOOP	[Symbol]
CONCRETE JUNCTION BOX	[Symbol]
CAST IRON JUNCTION BOX	[Symbol]
COMMON TRENCH	[Symbol]

NOTE:
THIS PLAN IS FOR THE PURPOSE OF REPLACING THE DETECTOR LOOPS ONLY. ALL OTHER INFORMATION SHOWN IS NOT RELATED AND WILL BE DISREGARDED.

REVISIONS

NAME	DATE

ILLINOIS DEPARTMENT OF TRANSPORTATION
DETECTOR LOOP REPLACEMENT
DEVON AVE. AT
DES PLAINES RIVER RD.

SCALE: VERT. 1:20
HORIZ. 1:20

DRAWN BY
CHECKED BY