

F.A.I. RTE.	SECTION	COUNTY	TOTAL SHEETS	SHEET NO.
90/94	2021-922PT.1-AC	COOK	460	44
STA. 128+00	TO STA. 133+00			
FED. ROAD DIST. NO. 1	ILLINOIS	FED. AID PROJECT		

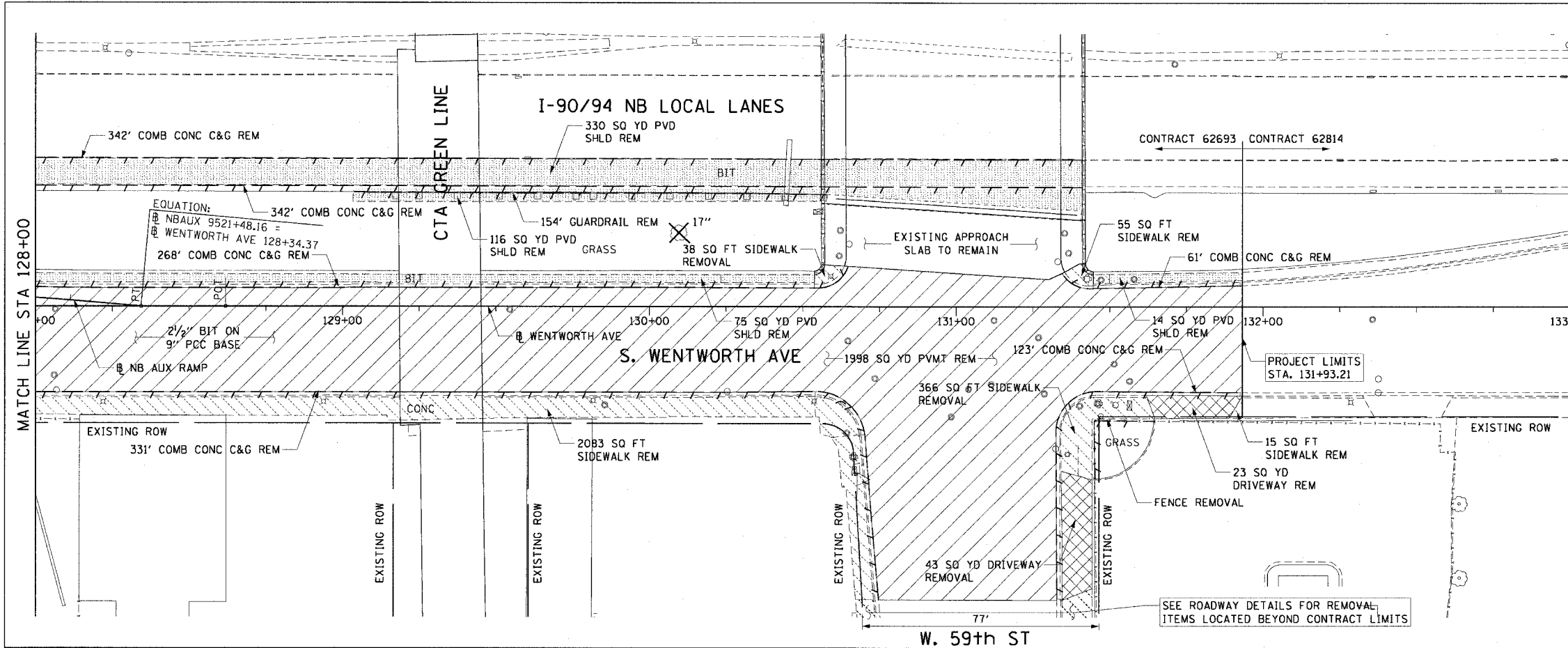

LEGEND:

- PAVEMENT REMOVAL
- MEDIAN REMOVAL
- LINEAR REMOVALS
- SIDEWALK REMOVAL
- APPROACH SLAB REMOVAL
- DRIVEWAY PAVEMENT REMOVAL
- PAVED SHOULDER REMOVAL
- TREE REMOVAL (BY OTHERS)

NOTES:

1. SEE CONTRACT 62583 FOR REMOVAL OF EXISTING ROADWAY LIGHTING AND ITS EQUIPMENT.
2. SEE STRUCTURAL SHEETS FOR RETAINING WALL REMOVALS AND IMPROVEMENTS.
3. SEE DRAINAGE AND UTILITY SHEETS FOR REMOVALS AND IMPROVEMENTS.
4. FOUNDATIONS FOR ROADWAY LIGHTING AND ITS EQUIPMENT ARE REMOVED IN CONTRACT 62693. SEE ELECTRICAL EXISTING CONDITIONS AND DEMOLITION PLANS.
5. SEE SIGNING SHEETS FOR MAINLINE REMOVAL AND IMPROVEMENTS.
6. ALL EXISTING DRIVEWAYS SHOWN ARE CONCRETE UNLESS NOTED OTHERWISE.
7. SEE ROADWAY DETAILS FOR QUANTITIES OF REMOVAL AND PATCHING ITEMS OUTSIDE OF CONTRACT LIMITS. COORDINATE WITH CONTRACT NO. 62839 FOR SEQUENCE OF REMOVAL AND PATCHING WORK.

EXISTING CONDITIONS AND REMOVAL

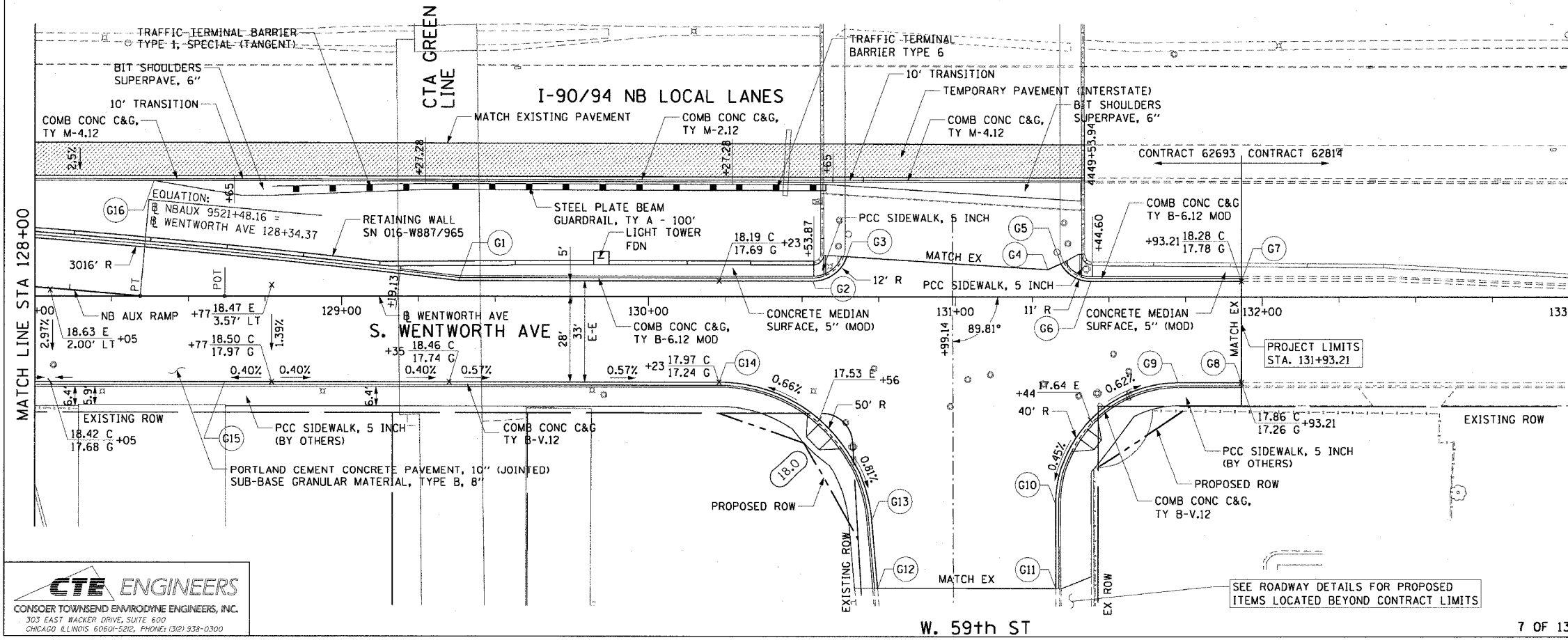

LEGEND:

- TEMPORARY PAVEMENT (INTERSTATE)

NOTES:

1. SEE INTERSECTION DETAIL SHEETS FOR INTERSECTION GRADING DETAILS.
2. SEE ALIGNMENT PLANS FOR CURVE DATA.
3. SEE GORE DETAILS FOR GORE GRADING.
4. SEE ELECTRICAL INFRASTRUCTURE SHEETS FOR IMPROVEMENTS.
5. SEE ROADWAY DETAIL SHEETS FOR CURB AND GUTTER TRANSITIONS AT THE BRIDGE APPROACH PAVEMENT.
6. SEE PLAT OF HIGHWAYS SHEETS FOR PROPOSED ROW LOCATIONS.

PT.	STATION	OFFSET	LOC	PT.	STATION	OFFSET	LOC
G1	129+38.13	5.00' LT	EOP	G9	131+72.58	28.00' RT	EOP
G2	130+53.53	5.00' LT	EOP	G10	131+32.72	68.14' RT	EOP
G3	130+64.54	13.05' LT	EOP	G11	131+32.81	95.54' RT	EOP
G4	131+30.11	8.90' LT	EOP	G12	130+74.73	95.46' RT	EOP
G5	131+34.35	10.88' LT	EOP	G13	130+72.81	73.61' RT	EOP
G6	131+44.09	5.00' LT	EOP	G14	130+23.00	28.00' RT	EOP
G7	131+93.21	5.00' LT	EOP	G15	128+61.88	28.00' RT	EOP
G8	131+93.21	28.00' RT	EOP	G16	128+38.81	37.44' LT	BOC

REVISIONS	
NAME	DATE

ILLINOIS DEPARTMENT OF TRANSPORTATION
 F.A.I. 90/94 (DAN RYAN EXPRESSWAY)
 63rd ST TO 59th ST (FRONTAGE ROAD & RAMPS)
**EXISTING AND PROPOSED ROADWAY PLANS
 WENTWORTH AVENUE**
 SCALE: 1"=20'
 DATE: October 29, 2004
 DRAWN BY: NJH
 CHECKED BY: RMG

CTE ENGINEERS
 CONSCOR TOWNSEND ENVIRONMENTAL ENGINEERS, INC.
 303 EAST WACKER DRIVE, SUITE 600
 CHICAGO, ILLINOIS 60601-5212, PHONE: (312) 338-0300

W. 59th ST

7 OF 13

11/23/2004 03:03:04 PM