

F.A.I. RTE.	SECTION	COUNTY	TOTAL SHEETS	SHEET NO.
90/94	2021-922PT.1-AC	COOK	460	65
STA.	TO STA.			
FED. ROAD DIST. NO. 1	ILLINOIS	FED. AID PROJECT		

62693



**NOTE:**

- PRESTAGE WORK SHALL INCLUDE RELOCATION OF COMBINED SEWER ON WENTWORTH AVENUE BETWEEN STA. 112+85 TO STA. 126+58 (APPROXIMATE LIMITS). THIS WORK MUST BE PERFORMED BEFORE STAGE 1 AS THE LOCATION OF EXISTING COMBINED SEWER CONFLICTS WITH THE LOCATION OF PROPOSED TEMPORARY SHEETING NECESSARY FOR RETAINING WALL CONSTRUCTION ALONG THE WENTWORTH AVENUE FRONTAGE ROAD.
- ADVANCE SIGNING FOR LANE CLOSURE ON WENTWORTH AVENUE SHALL APPLY IDOT HIGHWAY STANDARD 701601.
- ONE LANE OF NORTHBOUND TRAFFIC MUST BE MAINTAINED ON WENTWORTH AVE DURING CONSTRUCTION. 63RD STREET ENTRANCE RAMP FROM WENTWORTH AVE TO DAN RYAN EXPRESSWAY MUST REMAIN OPEN DURING CONSTRUCTION.

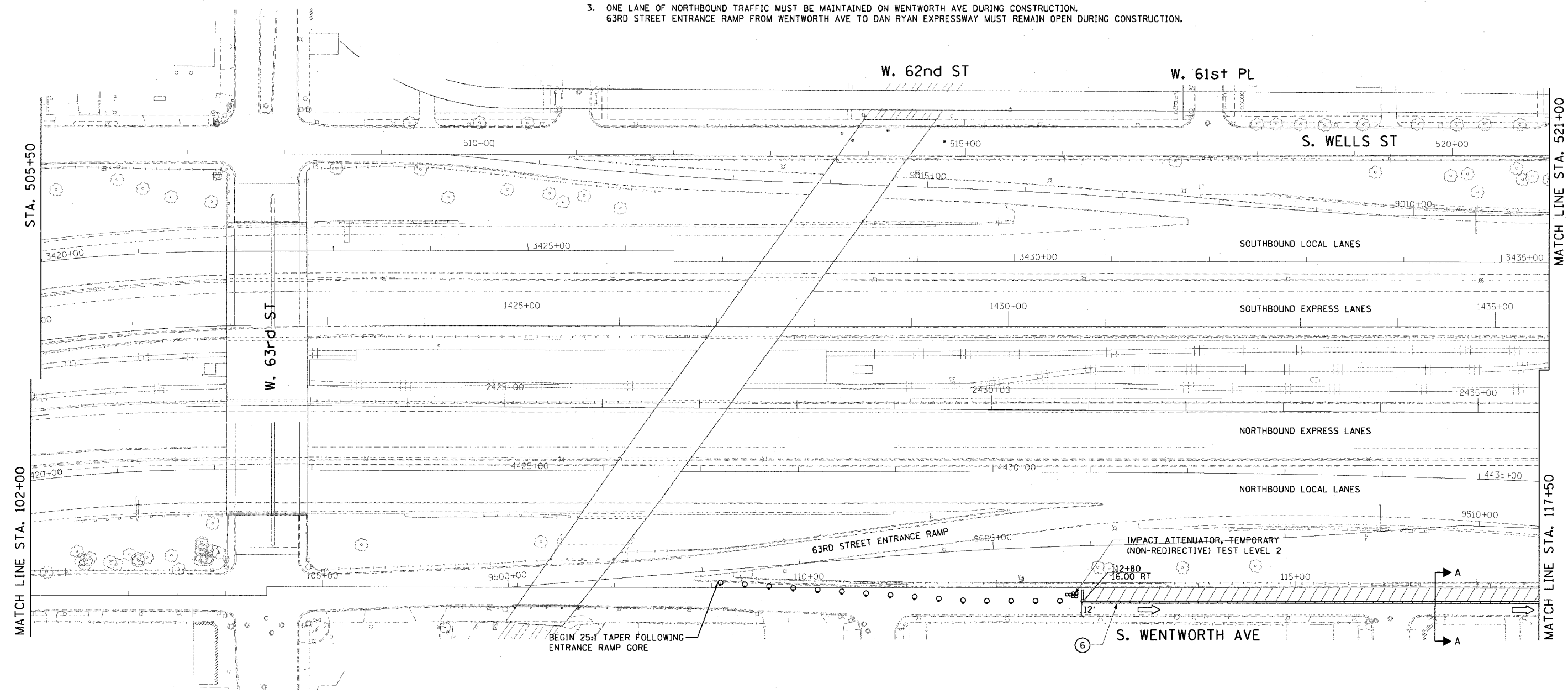

**LEGEND**

- |   |   |
|---|---|
| ① TEMPORARY PAVEMENT MARKING 4"                                 | ⑨ EXISTING CURB AND GUTTER                            |
| ② TEMPORARY PAVEMENT MARKING 5"                                 | ⑩ EXISTING RETAINING WALL                             |
| ③ TEMPORARY PAVEMENT MARKING 6"                                 | 1EX → EXPRESS LANE DIRECTION OF TRAFFIC               |
| ④ TEMPORARY PAVEMENT MARKING 8"                                 | 1LL → LOCAL LANE DIRECTION OF TRAFFIC                 |
| ⑤ EXISTING CONCRETE BARRIER                                     | ▨ WORK AREA   |
| ⑥ TEMPORARY CONCRETE BARRIER (CONTRACTOR FURNISHED)             | ⊘ IMPACT ATTENUATOR                                   |
| ⑦ MONODIRECTIONAL PRISMATIC BARRIER REFLECTOR @ 50' C-C SPACING | ○ DRUM OR TYPE II BARRICADE WITH STEADY BURNING LIGHT |
| ⑧ BITUMINOUS OVERLAYED CURB AND GUTTER                          | ⊏ TYPE III BARRICADE                                  |
|   | → ARROW BOARD   |

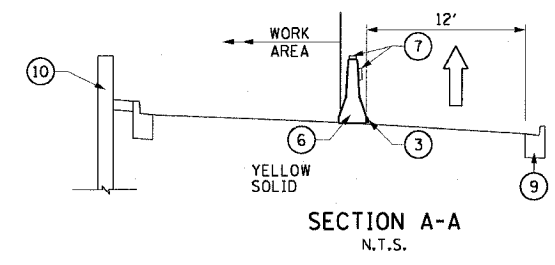

REVISIONS	
NAME	DATE

ILLINOIS DEPARTMENT OF TRANSPORTATION  
 F.A.I. 90/94 (DAN RYAN EXPRESSWAY)  
 63rd ST TO 59th ST (FRONTAGE ROAD & RAMPS)

**SUGGESTED STAGES OF CONSTRUCTION AND TRAFFIC CONTROL PRESTAGE WORK**

SCALE: 1"=50'  
 DATE: October 29, 2004  
 DRAWN BY: SWANG  
 CHECKED BY: RMG



11/15/2004 02:36:24 PM