

F.A.I. RTE.	SECTION	COUNTY	TOTAL SHEETS	SHEET NO.
90/94	2021-922PT.1-AC	COOK	460	70
STA.	TO STA.			
FED. ROAD DIST. NO. 1	ILLINOIS	FED. AID PROJECT		

62693

**LEGEND**

- (A) TEMPORARY PAVEMENT MARKING 4", WHITE, SOLID
- (B) TEMPORARY PAVEMENT MARKING 4", YELLOW, SOLID
- (C) TEMPORARY PAVEMENT MARKING 4", WHITE, 2' DASH/6' SKIP
- (D) TEMPORARY PAVEMENT MARKING 4", YELLOW, 2' DASH/6' SKIP
- (E) TEMPORARY PAVEMENT MARKING 4", WHITE, 6' DASH/18' SKIP
- (F) TEMPORARY PAVEMENT MARKING 12", YELLOW, SOLID
- (G) TEMPORARY PAVEMENT MARKING 24", WHITE, SOLID
- (H) TEMPORARY PAVEMENT MARKING SYMBOLS
- (I) TEMPORARY CONCRETE BARRIER (CONTRACTOR FURNISHED)
- DRUM WITH STEADY BURNING LIGHT (25' SPACING, TYPICAL)
- TT TYPE III BARRICADE
- ARROW BOARD
- ▨ WORK AREA

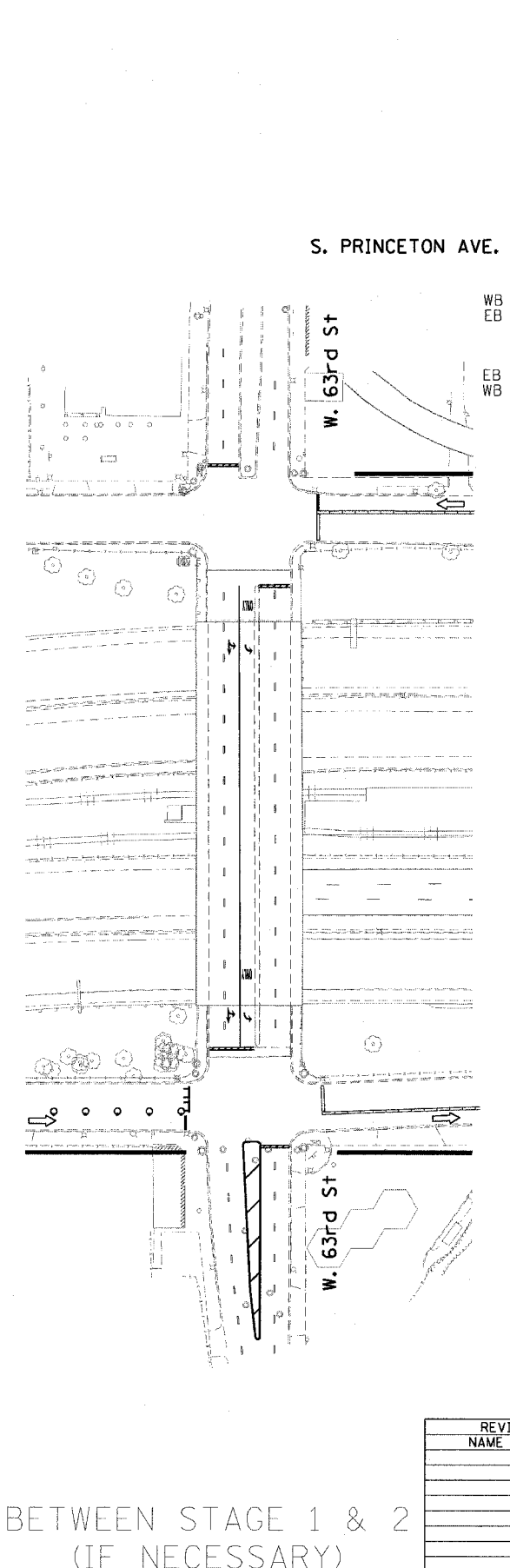
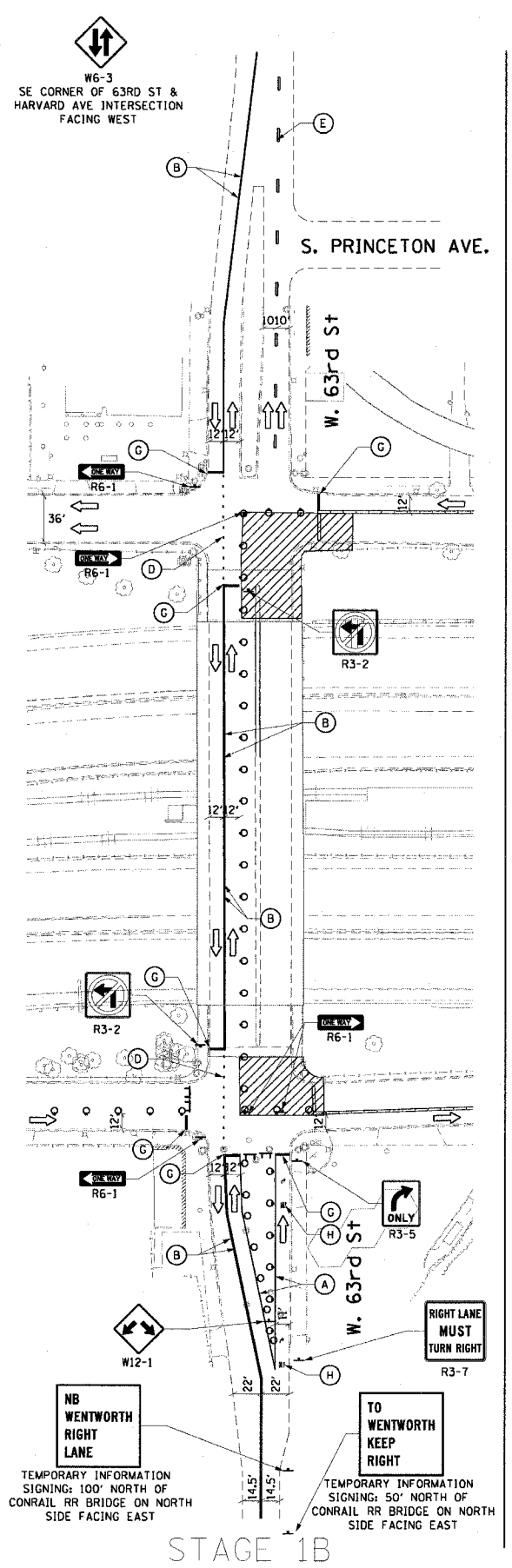
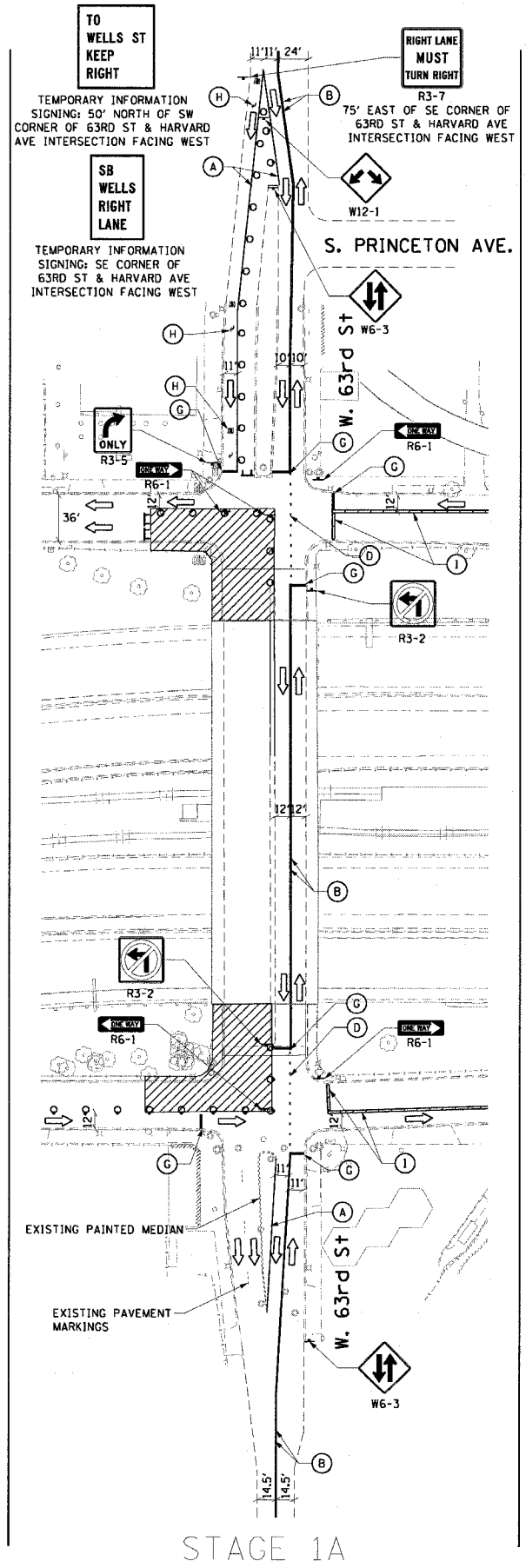

**TYPICAL SIGN PLACEMENT**

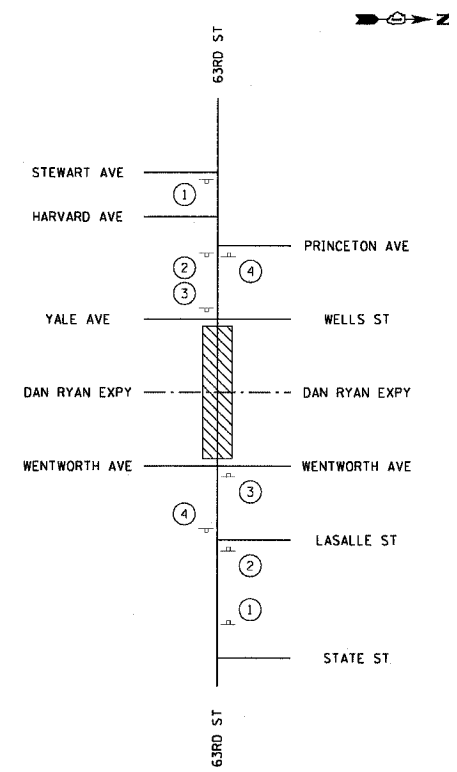
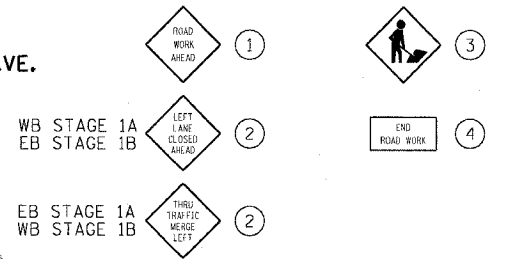

- NOTES:
1. MINIMUM SIGN SPACING OF 200'. PRECISE SIGN PLACEMENT NOT REPRESENTED. REFERENCE IDOT STANDARD 701601-03 FOR SPACING.
  2. COMPLETION OF STAGE 1B SHOULD BE IMMEDIATELY FOLLOWED BY THE START OF STAGE 2A. IF STAGES 1A AND 1B ARE COMPLETE, AND THE SWITCH TO STAGE 2 IS NOT POSSIBLE FOR 7 OR MORE DAYS, ALL LANES ON THE BRIDGE ARE TO BE RESTORED AS SHOWN OR AS DIRECTED BY THE ENGINEER.
  3. ALL PAVEMENT MARKINGS SHOWN ARE PAVEMENT MARKING TAPE TYPE III.

REVISIONS	
NAME	DATE

ILLINOIS DEPARTMENT OF TRANSPORTATION  
 F.A.I. 90/94 (DAN RYAN EXPRESSWAY)  
 63rd ST TO 59th ST (FRONTAGE ROAD & RAMPS)

**SUGGESTED STAGES OF CONSTRUCTION AND TRAFFIC CONTROL STAGE 1**

SCALE: 1"=60'  
 DATE: October 29, 2004  
 DRAWN BY: SWANG  
 CHECKED BY: RMG

11/23/2004 09:43:12 PM