

F.A.I. RTE.	SECTION	COUNTY	TOTAL SHEETS	SHEET NO.
90/94	2021-922PT.1-AC	COOK	460	108
STA.	TO STA.			
FED. ROAD DIST. NO. 1	ILLINOIS	FED. AID PROJECT		

62693

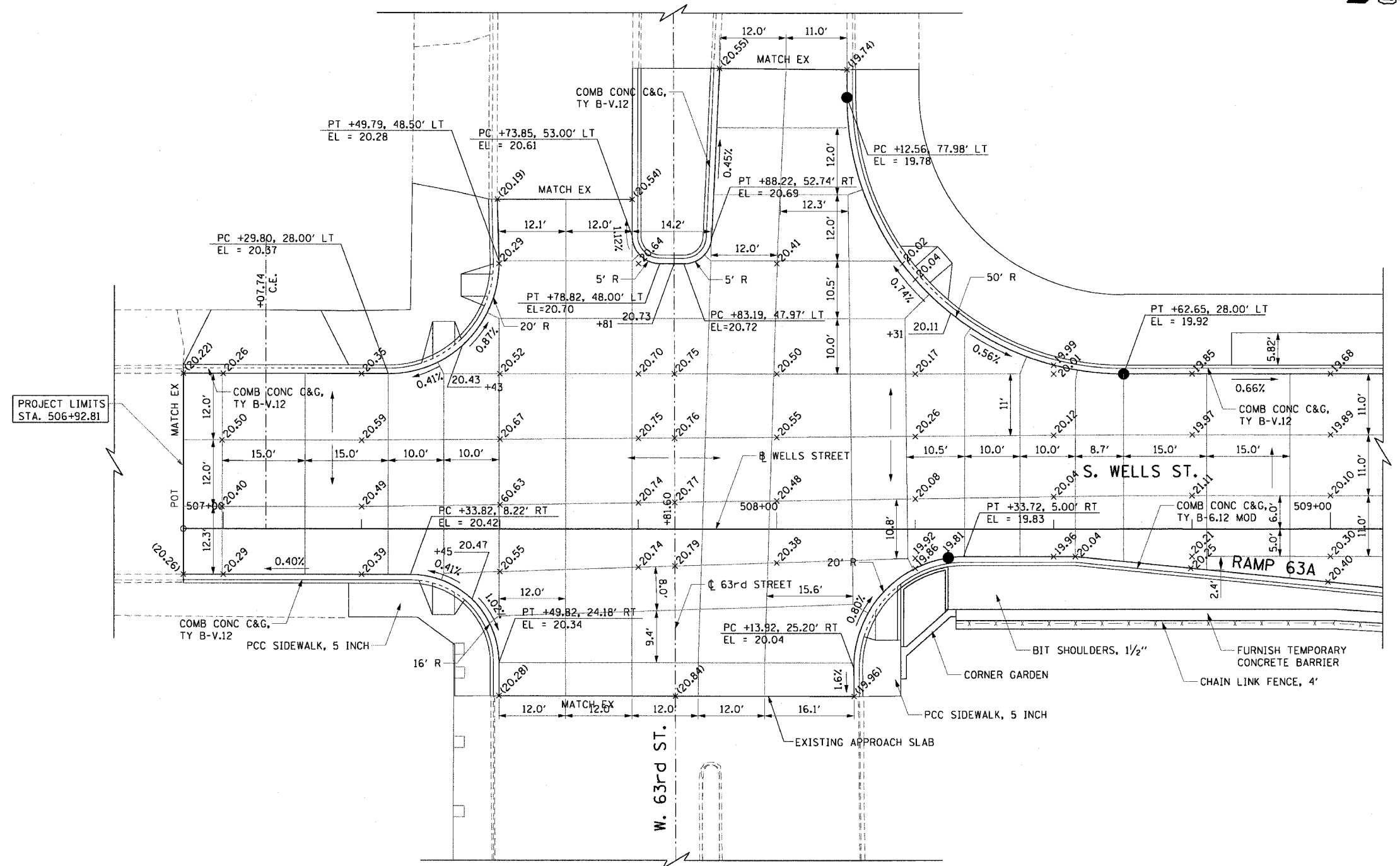

- LEGEND:**
- EXISTING ELEVATION (XX.XX)
 - PROPOSED ELEVATION XX.XX
 - DIRECTION OF PAVEMENT SLOPE
- NOTES:**
1. SEE GORE DETAIL SHEETS FOR GRADING OF RAMP 63A.
 2. SEE STRUCTURAL SHEETS FOR CORNER GARDEN DETAILS.
 3. SEE ROADWAY DETAIL FOR CURB AND GUTTER TRANSITIONS AT THE BRIDGE APPROACH PAVEMENT.
 4. USE DOWEL BARS INSTEAD OF TIE BARS FOR FIRST PANEL NEXT TO WELLS STREET PAVEMENT.
 5. ELEVATIONS ALONG BASELINE ARE LOCATED AT EVEN 25' INCREMENTS UNLESS NOTED.



REVISIONS	
NAME	DATE

ILLINOIS DEPARTMENT OF TRANSPORTATION
 F.A.I. 90/94 (DAN RYAN EXPRESSWAY)
 63rd ST TO 59th ST (FRONTAGE ROAD & RAMPS)
PROPOSED IMPROVEMENT
WELLS STREET
W. 63rd STREET INTERSECTION

SCALE: 1"=10'
 DATE: October 29, 2004

DRAWN BY: NJH
 CHECKED BY: RMG

m:\y:\0465\0465.dwg - c:\p1\cadd\cadd\m\section.dwg 10/25/2004 9:46:56 AM