

Benchmark:
No. 3533;
Brass Disk (CTA Monument) at the
Southwest Corner of 63rd Street
and Harvard Street
E1 19.71

STATE OF ILLINOIS
DEPARTMENT OF TRANSPORTATION

F.A.I. RTE.	SECTION	COUNTY	TOTAL SHEETS	SHEET NO.
90/94	2021-922PT.1-AC	COOK	460	210
STA.	TO STA.			
FED. ROAD DIST. NO. 1	ILLINOIS	FED. AID PROJECT	62693	

TOTAL BILL OF MATERIAL

Item	Unit	Quantity
Sub-base Granular	Sq Yd	28
Material Type, B 8"		
Structure Excavation	Cu Yd	13
Concrete Superstructure	Cu Yd	21
Protective Coat	Sq Yd	62
Reinforcement Bars, Epoxy Coated	Pound	3,310
Chain Link Fence, 42" Attached to Structure (Special)	Foot	86
Rustication Finish	Sq Ft	158
Concrete Removal	Cu Yd	3

INDEX OF SHEETS

- WRR1 General Plan
- WRR2 Sections
- WRR3 Detailed Elevation, Section & Misc. Details
- WRR4 Reinforcement Details

LEGEND:

- (C) - Construction Jt.
- (E) - Expansion Jt.
- [Hatched Box] - Chain Link Fence, Special
- [Solid Line] - New Construction
- [Dashed Line] - Existing Construction

GENERAL NOTES:

- Stations and offsets are measured from @ S. Wentworth Ave.
- Existing utilities in conflict with Slab and Parapet shall be abandoned or relocated according to directions given in the Roadway Plans.
- All construction joints shall be bonded.
- All exposed concrete edges shall have a 3/4" by 45° chamfer except where shown otherwise.
- A protective coat shall be applied according to Section 503 of the Standard Specifications to all concrete surfaces not in contact with soil.
- Reinforcement bars shall conform to the requirements of AASHTO M31 or M322 Grade 60.
- Reinforcement bars designated "(E)" shall be epoxy coated.
- Plan dimensions and details relative to existing structure have been taken from existing plans and are subject to nominal construction variations. It shall be the Contractor's responsibility to verify such dimensions and details in the field and make necessary approved adjustments prior to construction or ordering of materials. Such variations shall not be cause for additional compensation for a change in the scope of work. However the Contractor will be paid for the quantity actually furnished at the unit price for the work.

DESIGN SPECIFICATIONS

2002 AASHTO, Standard Specifications
for Highway Bridges

DESIGN STRESSES

FIELD UNITS

f'c = 3,500 psi
fy = 60,000 psi (Reinf.)

ABBREVIATIONS

- B Bottom
- BF Back Face
- CG Curb & Gutter
- CJ Construction Joint
- EF Each Face
- EJ Expansion Joint
- FF Front Face
- Lt Left
- Shld Shoulder
- Sta Station
- T Top

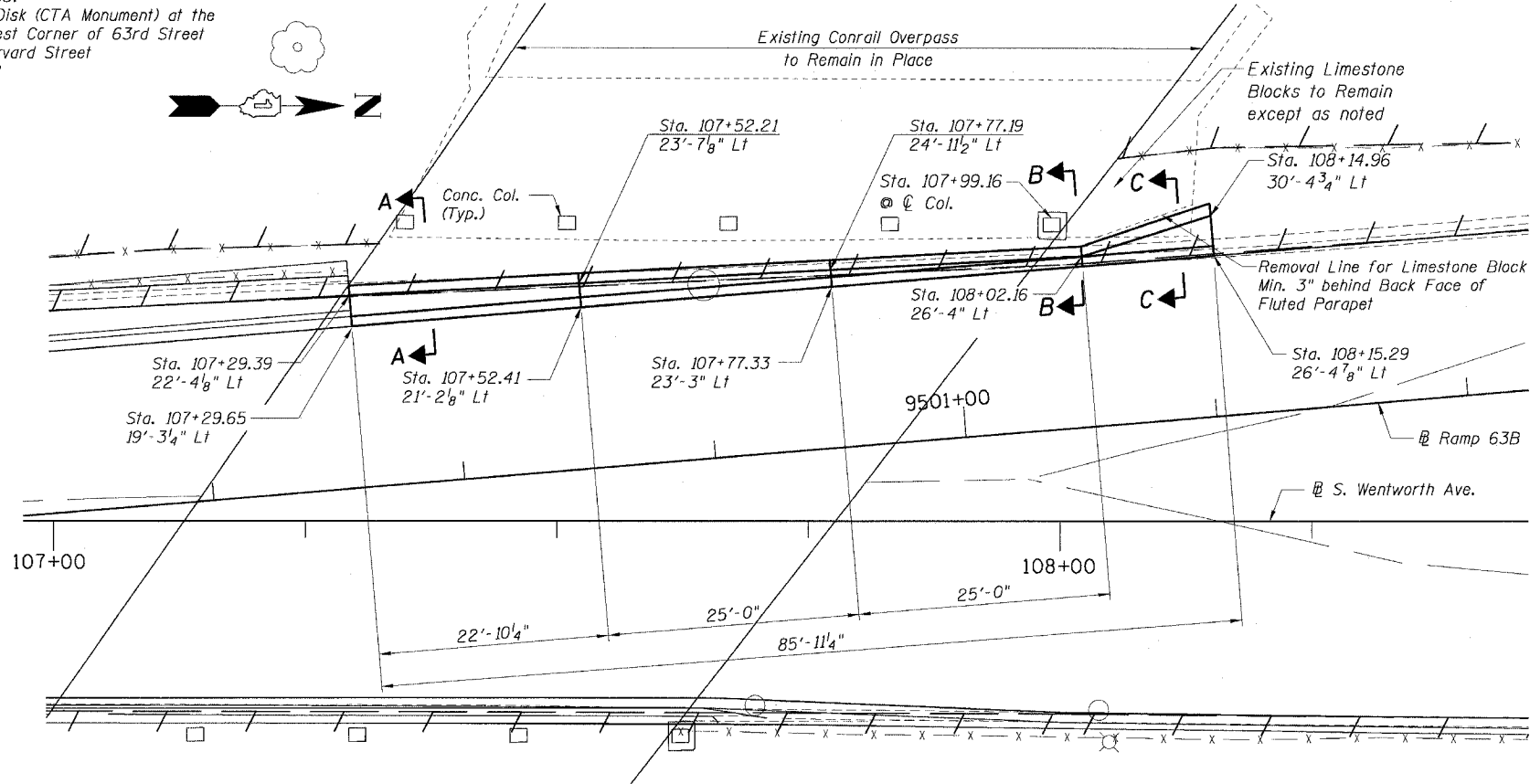

GENERAL PLAN

Note:
For Sections A-A, B-B and C-C
see Sheet WRR2

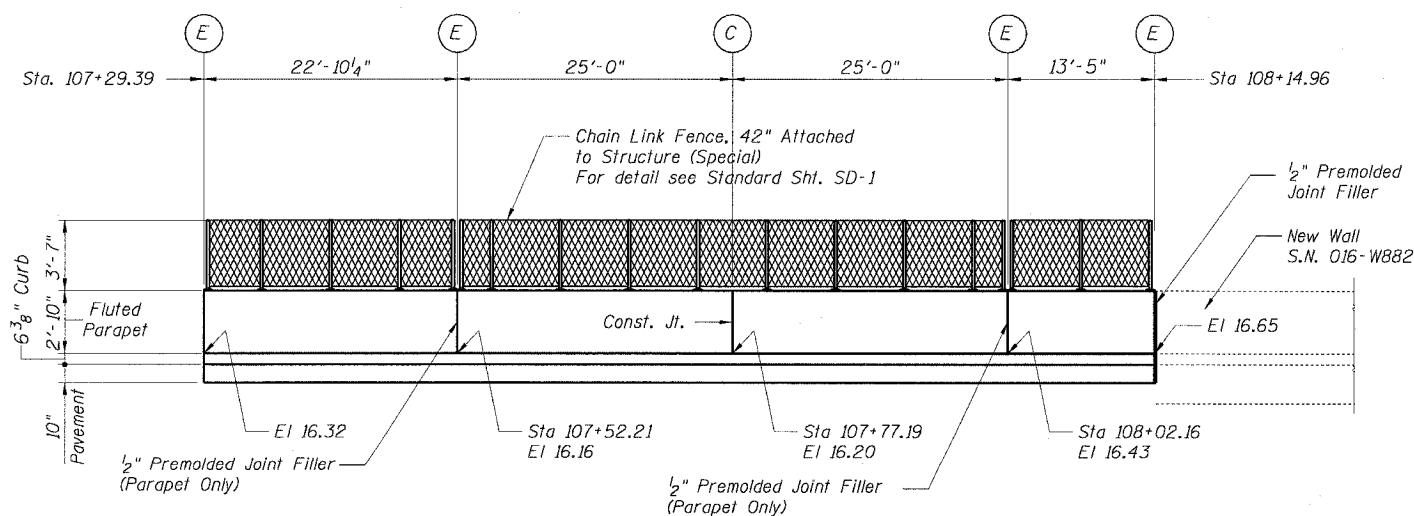

FRONT FACE ELEVATION

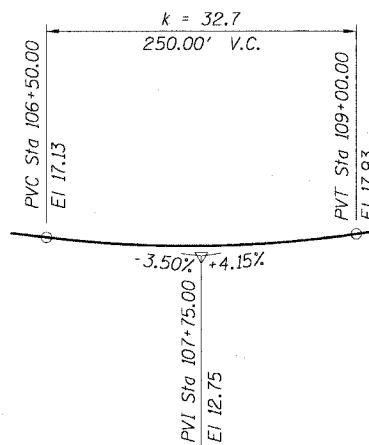

PGL - S. WENTWORTH AVE.

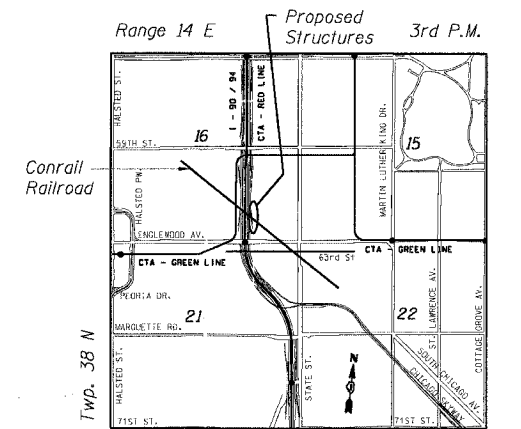

LOCATION SKETCH

Sheet WRR1 of 4

REVISIONS	
NAME	DATE

ILLINOIS DEPARTMENT OF TRANSPORTATION
F.A.I. 90/94 (DAN RYAN EXPRESSWAY)
GENERAL PLAN
SOUTH WENTWORTH AVENUE RETAINING WALLS
CONRAIL BRIDGE
SECTION (2021-922PT.1-AC)
STATION 107+29.39 TO 108+14.96
COOK COUNTY S.N. 016-WRR
SCALE: None
DATE: October 29, 2004
DRAWN BY: RSB/CHD
CHECKED BY: MM



M-JP - 10-29-04
EXPIRATION DATE: 11-30-2004

163-P-0466B STRUCTURE 44-0179C ST WRR1 OF 4 GENERAL PLAN