

STATE OF ILLINOIS  
DEPARTMENT OF TRANSPORTATION

F.A.I. RTE.	SECTION	COUNTY	TOTAL SHEETS	SHEET NO.
90/94	2021-922PT.1-AC	COOK	460	215
STA.	TO STA.			
FED. ROAD DIST. NO. 1	ILLINOIS	FED. AID PROJECT		

62693

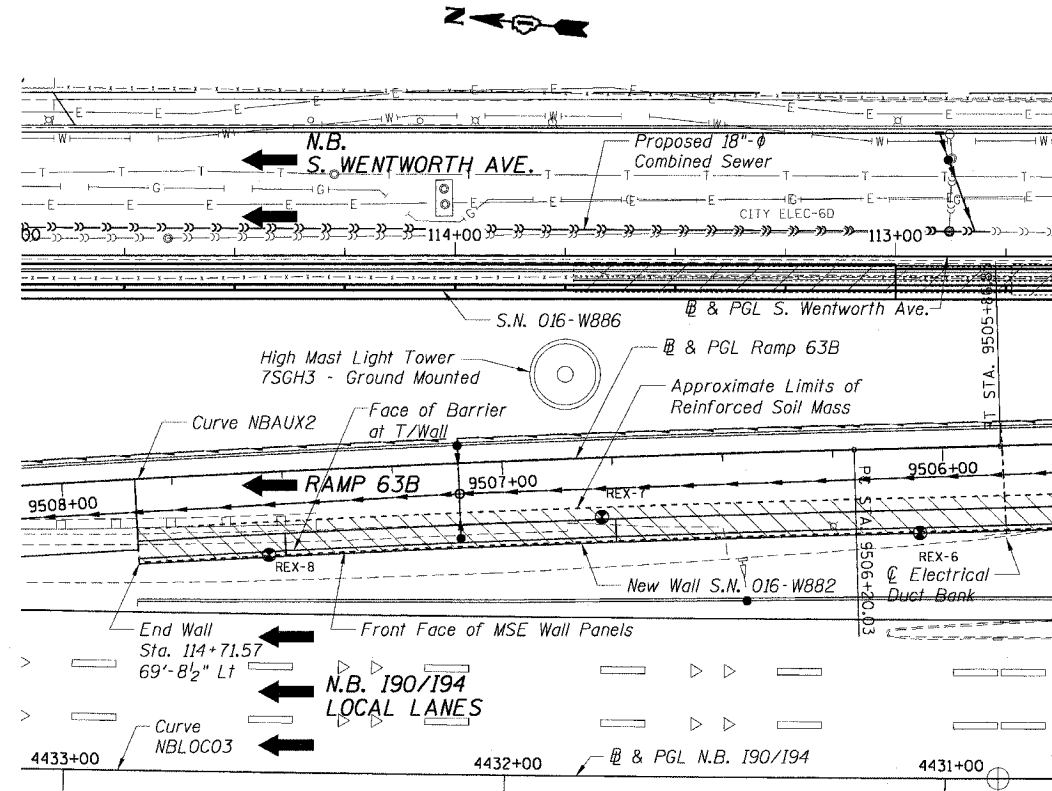

PLAN

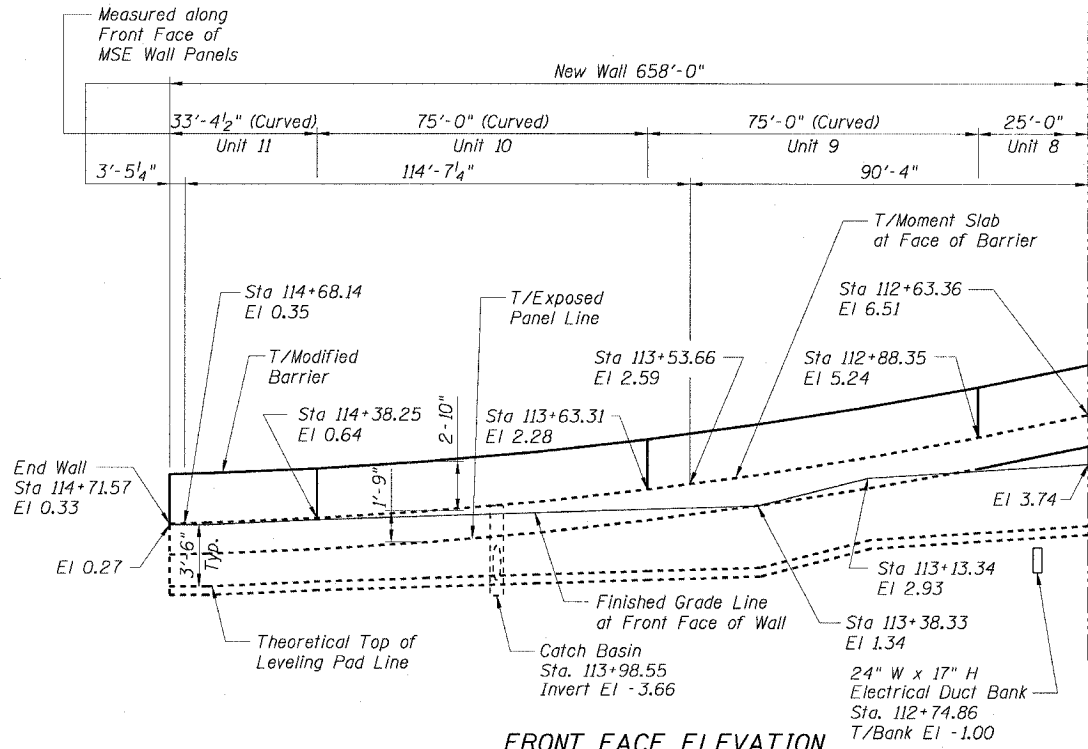

FRONT FACE ELEVATION  
(Looking East)

MATCH LINE STA. 112+63.36 SEE SHEET X1

INDEX OF SHEETS

- X1 General Plan I
- X2 General Plan II
- X3 Offset Sketch, Profiles and Curve Data
- X4 Typical Sections
- X5 Typical Sections
- X6 Moment Slab Details - Unit 1
- X7 Moment Slab Details - Unit 2
- X8 Moment Slab Details - Unit 3
- X9 Moment Slab Details - Units 4 thru 10
- X10 Moment Slab Details - Units 7, 10 and 11
- X11 Miscellaneous Details
- X12 Reinforcement Details
- X13 Soil Boring Logs
- X14 Soil Boring Logs

GENERAL NOTES:

1. Stations and offsets are measured from @ & PGL S. Wentworth Ave. to the front face of the MSE Wall Panels.
2. The M.S.E. Wall Supplier's internal stability design shall account for the moment slab's bearing pressure surcharge and a horizontal sliding force of 0.5 kips/ft. of wall.
3. Existing utilities in conflict with Retaining Wall shall be abandoned or relocated according to directions given in the Roadway Plans.
4. All construction joints shall be bonded.
5. All exposed concrete edges shall have a 3/4" by 45° chamfer except where shown otherwise. Chamfer on vertical edges shall be continued a minimum of 1 foot below the finished ground line.
6. A protective coat shall be applied to the top and inside surfaces of the Modified Barrier or Fluted Parapet and the top of the Moment Slab in accordance with Section 503.19 of the Standard Specifications.
7. Reinforcement bars shall conform to the requirements of AASHTO M31 or M322, Grade 60.
8. Reinforcement bars designated "E" shall be epoxy coated.
9. Coarse aggregate for concrete in Fluted Parapet and Modified Barrier shall meet the requirements of Section 1004.01(b) of the Standard Specifications.
10. Plan Dimensions and Details relating to Existing Structures have been taken from Existing Plans and are subject to Nominal Construction Variations. It shall be The Contractor's responsibility to verify such Dimensions and Details in the Field and make necessary approved adjustments prior to Construction or ordering of Materials. Such variations shall not be cause for additional compensation or a change in the Scope of Work. However The Contractor will be paid for the Quantity actually furnished at the Unit Price for the Work.
11. Light Tower Foundation and Pad Construction: The Contractor shall protect the earth in front of existing and proposed retaining walls during construction of light tower foundations and service pads. For light tower foundations in front of the new retaining walls, the Contractor shall coordinate the construction of the retaining walls, light tower foundations, and service pads to occur concurrently. If the Contractor does not perform the work concurrently he shall provide a temporary soil retention system to protect the retaining wall from being undermined during light tower construction work which shall be included in the Cost of the Light Tower Foundation work.

LEGEND:

- Soil Boring Location
- Reinforced Soil Mass
- Chain Link Fence, Special
- Removal of Existing Structure
- Direction of Traffic
- New Structure
- Existing Structure

ABBREVIATIONS

- B Bottom
- BF Back Face
- @ Baseline
- CJ Construction Joint
- EF Each Face
- EJ Expansion Joint
- EW Each Way
- FF Front Face
- Lt Left
- PGL Profile Grade Line
- Rt Right
- Shld Shoulder
- Sta Station
- T Top

NOTES:

1. For Typical Sections, see Sheets X4 and X5.
2. For Moment Slab Details, see Sheets X6 thru X10.
3. For Modified Barrier and Fluted Parapet Details see Sheet X11.
4. For Soil Boring Logs see Sheet X13 and X14.

Sheet X2 of 14

REVISIONS	
NAME	DATE

ILLINOIS DEPARTMENT OF TRANSPORTATION  
F.A.I. 90/94 (DAN RYAN EXPRESSWAY)  
GENERAL PLAN II  
SOUTH WENTWORTH AVENUE RETAINING WALL  
WEST 63RD STREET TO WEST 59TH STREET  
SECTION 2021-922 PT.1- AC  
STATION 108+14.88 TO 114+71.57  
COOK COUNTY S.N. 016-W882

SCALE: None DRAWN BY: CHD  
DATE: October 29, 2004 CHECKED BY: MJP

11/23/2004 07:02:49 AM