

STATE OF ILLINOIS
DEPARTMENT OF TRANSPORTATION

F.A.I. RTE.	SECTION	COUNTY	TOTAL SHEETS	SHEET NO.
90/94	2021-922PT.1-AC	COOK	460	216
STA.	TO STA.			
FED. ROAD DIST. NO. 1	ILLINOIS	FED. AID PROJECT		

62693

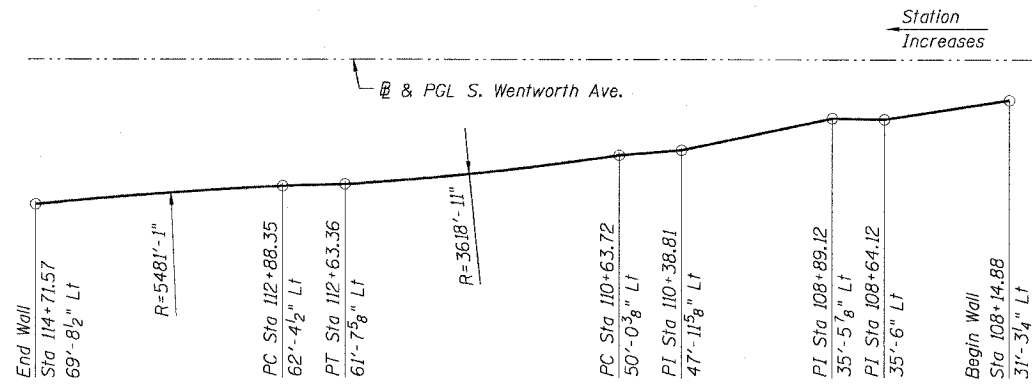

OFFSET SKETCH
(Along Front Face of MSE Wall Panels)

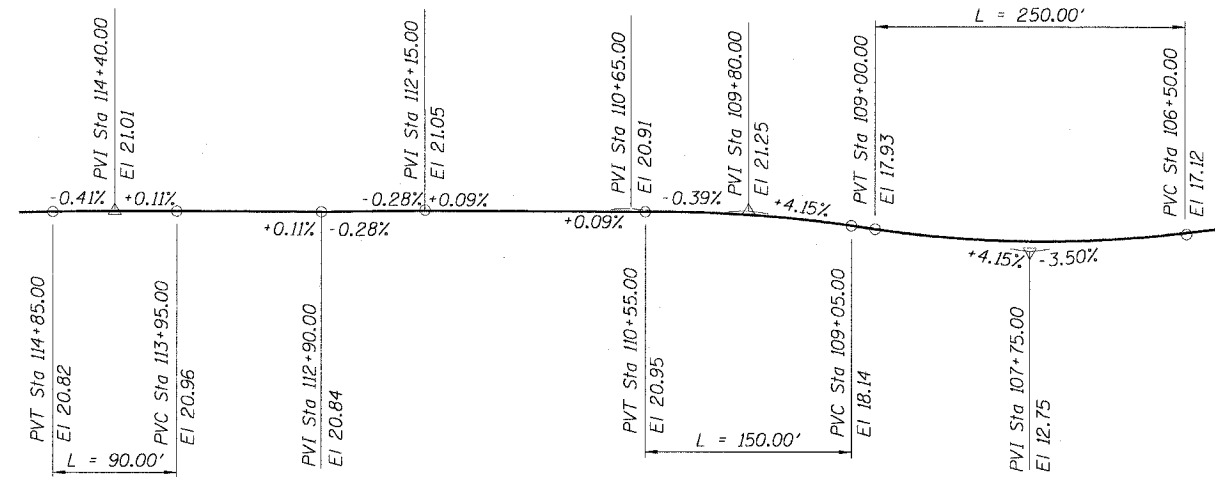

PGL - S. WENTWORTH AVE.

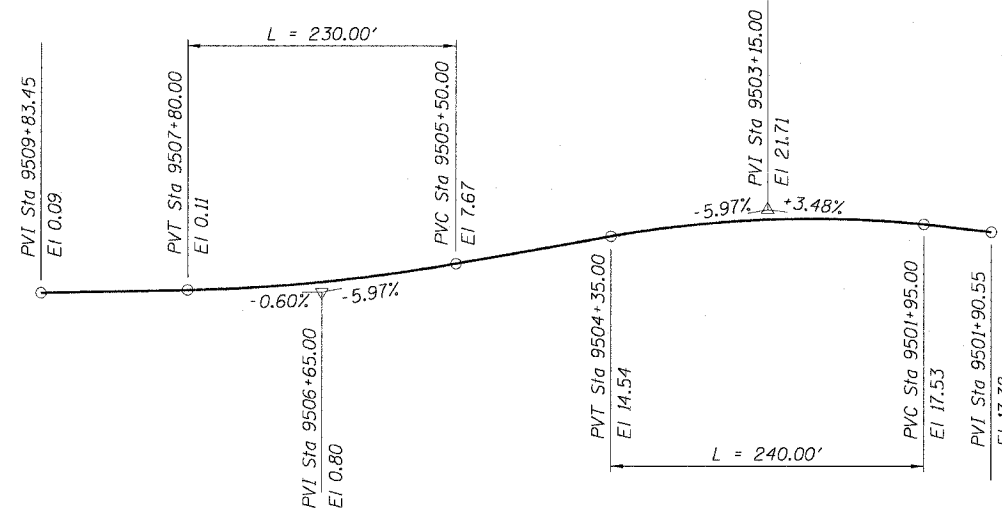

PGL - RAMP 63B

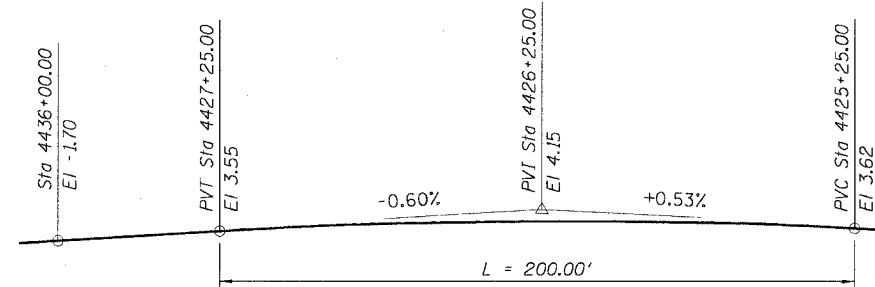

PGL - 190/194 NB LOCAL LANES

CURVE NBAUX1
P.I. STA = 9504+85.87
N = 1,863,921.64
E = 1,175,976.69
Δ = 3° 12' 54"
D = 1° 35' 30"
R = 3600.00'
T = 101.03'
L = 202.00'
E = 1.42'
e = N/A
T.R. = N/A
S.E. RUN = N/A
P.C. STA = 9503+84.85
N = 1,863,821.23
E = 1,175,987.89
P.T. STA = 9505+86.85
N = 1,864,022.51
E = 1,175,971.13

CURVE NBLOC03
P.I. STA = 4433+74.36
N = 1,864,307.20
E = 1,175,888.18
Δ = 2° 20' 39"
D = 0° 24' 33"
R = 14000.00'
T = 286.43'
L = 572.79'
E = 2.93'
e = NC
T.R. = N/A
S.E. RUN = N/A
P.C. STA = 4430+87.93
N = 1,864,020.87
E = 1,175,895.72
P.T. STA = 4436+60.71
N = 1,864,593.61
E = 1,175,892.37

CURVE NBAUX2
P.I. STA = 9507+37.23
N = 1,864,172.66
E = 1,175,962.85
Δ = 2° 26' 29"
D = 1° 02' 30"
R = 5500.00'
T = 117.20'
L = 234.36'
E = 1.25'
e = N/A
T.R. = N/A
S.E. RUN = N/A
P.C. STA = 9506+20.03
N = 1,864,055.64
E = 1,175,969.30
P.T. STA = 9508+54.39
N = 1,864,289.30
E = 1,175,951.42

Sheet X3 of 14

REVISIONS	
NAME	DATE

ILLINOIS DEPARTMENT OF TRANSPORTATION
F.A.I. 90/94 (DAN RYAN EXPRESSWAY)
OFFSET SKETCH, PROFILES AND CURVE DATA
SOUTH WENTWORTH AVENUE RETAINING WALL
WEST 63RD STREET TO WEST 59TH STREET
SECTION 2021-922 PT.1-AC
STATION 108+14.88 TO 114+71.57
COOK COUNTY S.N. 016-W882

SCALE: None DRAWN BY: CHD
DATE: October 29, 2004 CHECKED BY: MJP

11/23/2004 08:01:42 AM