

STATE OF ILLINOIS  
DEPARTMENT OF TRANSPORTATION

**Bench Mark:**  
No. 3535. Found cross cut on Southerly  
flange bolt of fire hydrant at the Northeast  
corner of 59th St. and Wentworth Ave.  
EI 19.31

- Existing Structure:**
1. Cast-in-place cantilever retaining wall E-2 on spread footing with variable height and 450'-0" long.
  2. Cast-in-place cantilever retaining wall E-3 on spread footing with variable height and 884'-0" long.
  3. Cast-in-place cantilever retaining wall E-4 on spread footing with variable height and 875'-5 3/4" long.

F.A.I. RTE.	SECTION	COUNTY	TOTAL SHEETS	SHEET NO.
90/94	2021-922PT.1-AC	COOK	460	228
STA.	TO STA.			
FED. ROAD DIST. NO. 1	ILLINOIS	FED. AID PROJECT		
62693				

**INDEX OF SHEETS**

- R1 General Plan I
- R2 General Plan II
- R3 General Plan III
- R4 Profile Grades
- R5 Typical Sections
- R6 Typical Sections
- R7 Detailed Plan and Elevation
- R8 Detailed Plan and Elevation
- R9 Detailed Plan and Elevation
- R10 Detailed Plan and Elevation
- R11 Detailed Plan and Elevation
- R12 Detailed Plan and Elevation
- R13 Detailed Plan and Elevation
- R14 Step Details and Misc. Details
- R15 Wall Sections
- R16 Wall Sections
- R17 Wall Sections
- R18 Temporary Soil Retention System/  
Temporary Sheet Piling
- R19 Typical Fluted Parapet and Misc. Details
- R20 Reinforcement Details
- R21 Soil Boring Logs
- R22 Soil Boring Logs
- R23 Soil Boring Logs
- R24 Soil Boring Logs
- R25 Soil Boring Logs
- R26 Soil Boring Logs
- R27 Soil Boring Logs
- R28 Soil Boring Logs

TOTAL BILL OF MATERIAL		
Item	Unit	Quantity
Rustication Finish	Sq Ft	16697
Porous Granular Embankment	Cu Yd	6142
Temporary Soil Retention System	Sq Ft	22660
Removal of Existing Structures No. 4	Each	1
Removal of Existing Structures No. 5	Each	1
Structure Excavation	Cu Yd	6162
Concrete Superstructure	Cu Yd	204
Concrete Structures	Cu Yd	2547
Protective Coat	Sq Yd	2967
Reinforcement Bars, Epoxy Coated	Pound	301590
Furnishing Metal Pile Shells 12"	Foot	22342
Driving and Filling Shells	Foot	22342
Test Pile Metal Shells	Each	13
Pipe Underdrains for Structures, 6"	Foot	1565
Chain Link Fence, 42" Attached to Structure (Special)	Foot	1535
Chain Link Fence, 42" Gate (Special)	Each	2
Temporary Sheet Piling	Sq Ft	6720
Porous Granular Embankment, Special	Cu Yd	176

**DESIGN STRESSES**      **DESIGN SPECIFICATIONS**  
FIELD UNITS  
f'c = 3,500 psi      2002 AASHTO, Standard Specifications  
fy = 60,000 psi (Reinf.)      for Highway Bridges

**NOTES:**

1. For General Notes see Sheet R4.
2. For Typical Sections see Sheets R5 and R6.
3. For limits of Temporary Sheet Piling and/or Soil Retention System see Sheet R18.
4. For Detailed Plan & Elevation, see Sheets R7 to R13.
5. For Wall Sections, see Sheets R15 to R17.
6. For Boring Logs, see Sheets R21 to R28.
7. For High Mast Light Tower Details, see LTF Sheets.
8. For Chain Link Fence, 42" Attached to Structure (Special) Details, see Sheet SD1.
9. For Chain Link Fence, 42" Gate (Special) Details see Sheets SD2-SD5.
10. For Retaining Wall Rustication Details, see Sheet SD6.

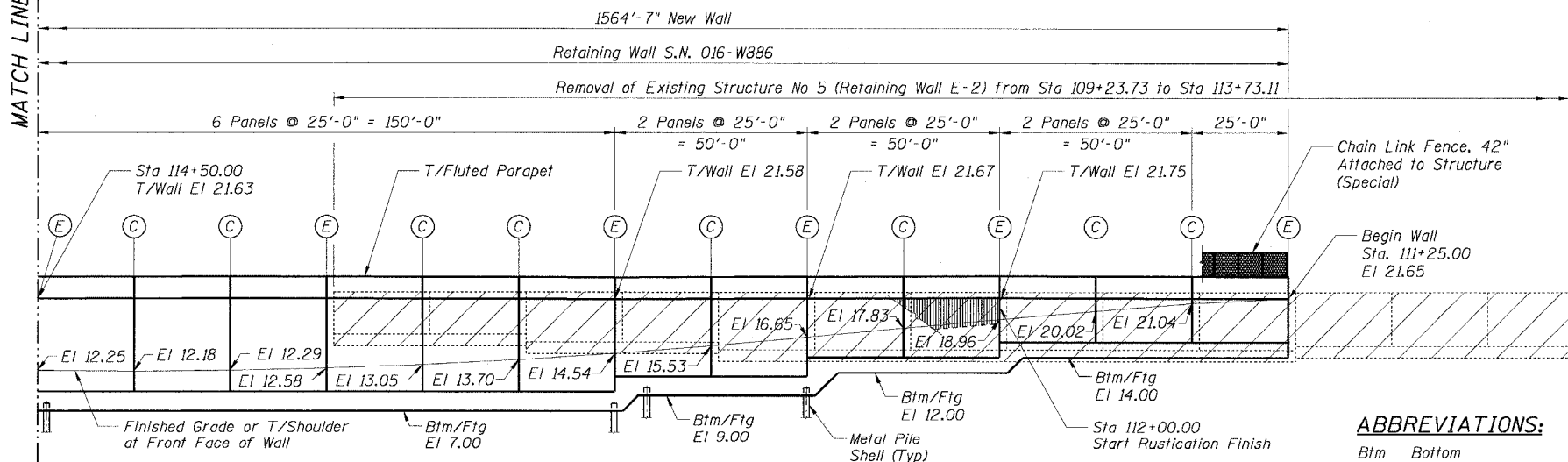
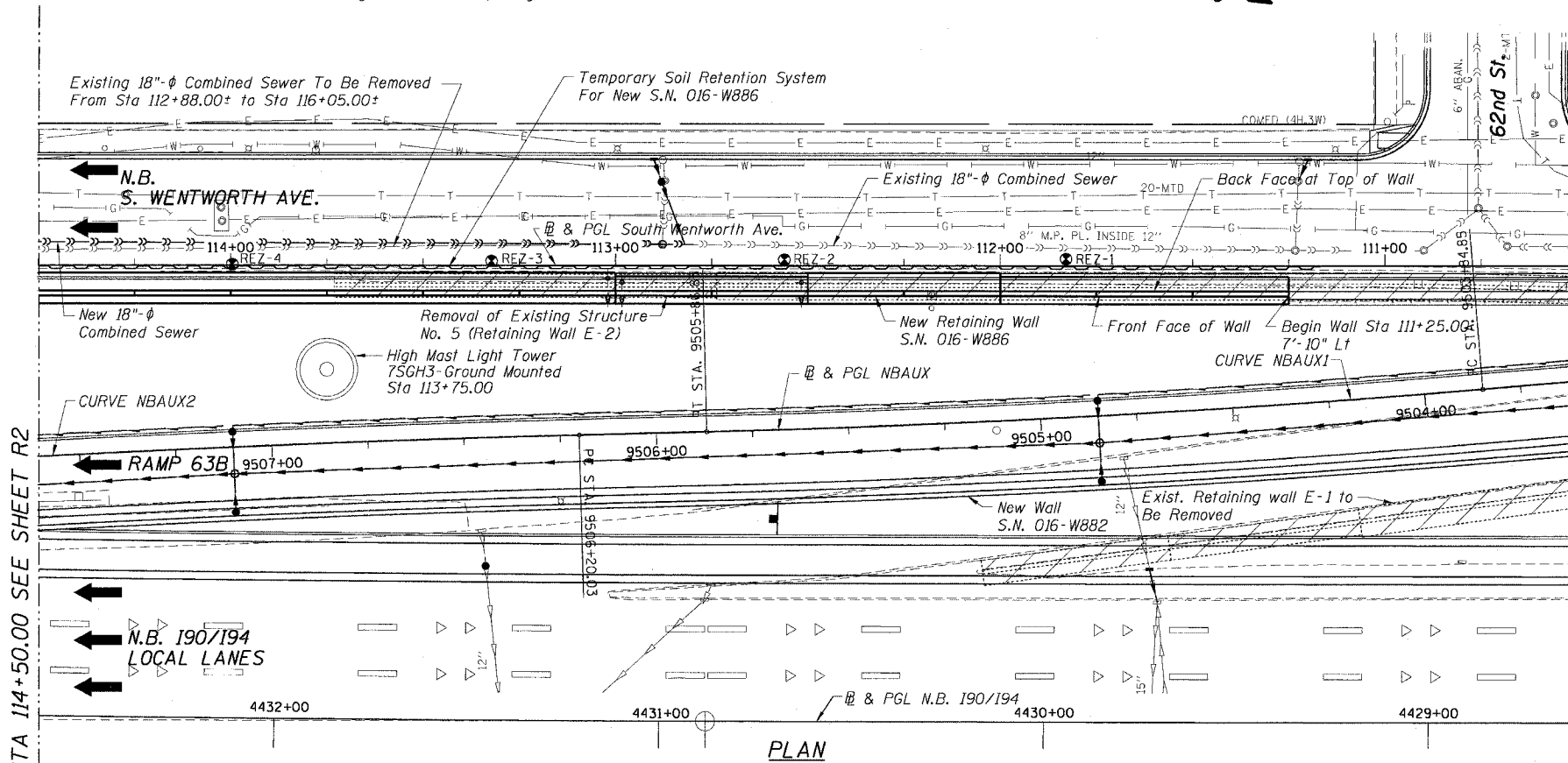

**ABBREVIATIONS:**

- Btm Bottom
- BF Back Face
- EF Each Face
- EW Each Way
- FF Front Face
- Ftg Footing
- Lt Left
- Sta Station
- T Top

**LEGEND**

- (C) - Construction Joint
- (E) - Expansion Joint
- (S) - Soil Boring Location
- (X) - Removal of Existing Structures
- (Hatched) - Chain Link Fence, Special
- (Arrow) - Direction of Traffic
- (Circle) - Vertical Pile
- (Diamond) - Battered Pile
- (Solid Line) - New Structure
- (Dashed Line) - Existing Structure
- (Hatched) - Rustication Finish

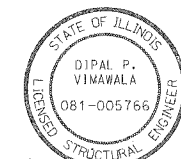

del *[Signature]*  
11-24-04  
EXPIRATION DATE: 11-30-2004

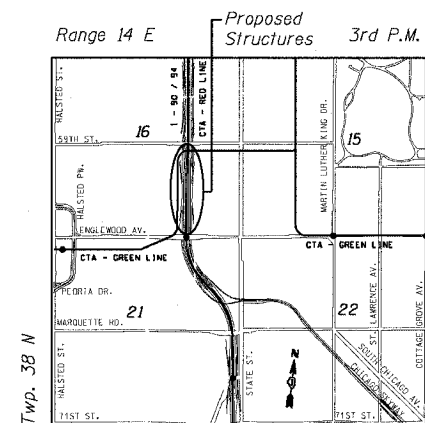

**LOCATION SKETCH**

Sheet R1 of 28

REVISIONS	
NAME	DATE

ILLINOIS DEPARTMENT OF TRANSPORTATION  
F.A.I. 90/94 (DAN RYAN EXPRESSWAY)  
**GENERAL PLAN I**  
SOUTH WENTWORTH AVENUE RETAINING WALL  
WEST 59TH STREET TO WEST 63RD STREET  
SECTION 2021-922 PT.1-AC  
STATION 111+25.00 TO 126+89.58  
COOK COUNTY S.N. 016-W886  
SCALE: None      DRAWN BY: ET  
DATE: October 29, 2004      CHECKED BY: JSS/MM

