

F.A.P. RTE.	SECTION	COUNTY	TOTAL SHEETS	SHEET NO.
2689	(3185&3186) RS-2	COOK	19	1

D-91-078-04

62698

STATE OF ILLINOIS
DEPARTMENT OF TRANSPORTATION
DIVISION OF HIGHWAYS

**PROPOSED
HIGHWAY PLANS**

F.A.U. 2689 : (WOLF ROAD)
IL. 38 (Roosevelt Rd.) to 22nd Street (Cermak Rd.)
SECTION: (3185 & 3186) RS-2
RESURFACING (MAINTENANCE)
COOK COUNTY
C-91-078-04

FINAL PLANS



LOCATION OF SECTION INDICATED THUS: - [black rectangle] -

FOR INDEX OF SHEETS, SEE SHEET NO. 2

IMPROVEMENT LOCATED IN THE
VILLAGES OF HILLSIDE, WESTCHESTER,
AND YORKFIELD

DISTRICT ONE - DESIGN / PLAN PREPARATION ENGINEERS: KEN ENG / ISSAM RAYYAN (847) 705-4242

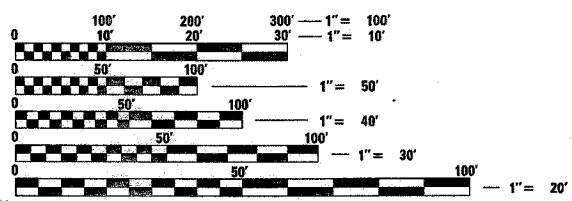

FULL SIZE PLANS HAVE BEEN PREPARED USING STANDARD ENGINEERING SCALES. REDUCED SIZED PLANS WILL NOT CONFORM TO STANDARD SCALES. IN MAKING MEASUREMENTS ON REDUCED PLANS, THE ABOVE SCALES MAY BE USED.

J.U.L.I.E.
JOINT UTILITY LOCATION INFORMATION FOR EXCAVATION
1-800-892-0123

CONTRACT NO. 62698

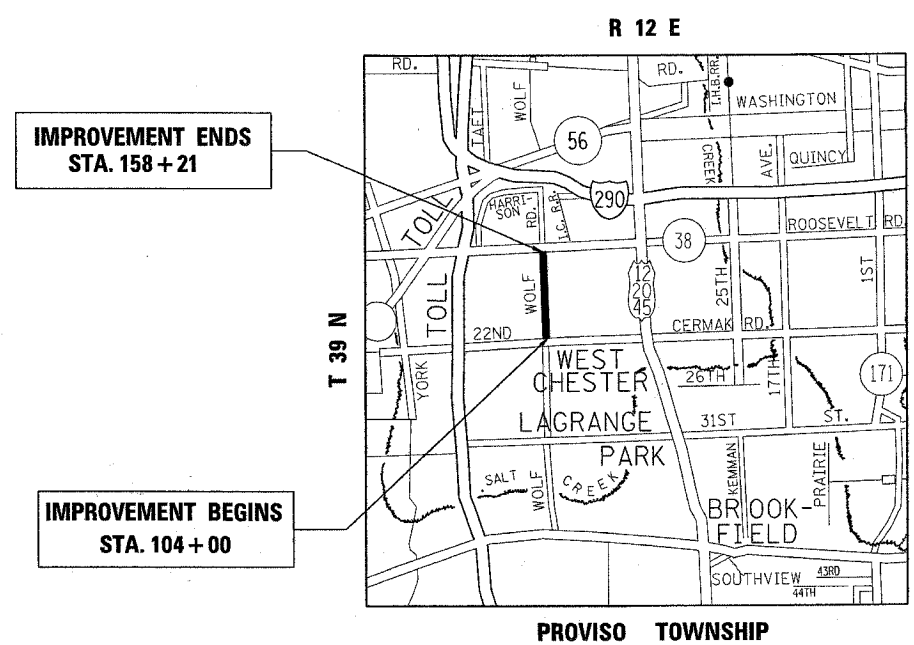

IMPROVEMENT ENDS
STA. 158 + 21

IMPROVEMENT BEGINS
STA. 104 + 00

TRAFFIC DATA:
ADT 2001 = 15800
SPEED LIMIT - 45 MPH

MAP SCALE : NO SCALE

GROSS & NET LENGTH OF IMPROVEMENT = 5421 FEET = 1.03 MILE

STATE OF ILLINOIS
DEPARTMENT OF TRANSPORTATION
DIVISION OF HIGHWAYS

SUBMITTED Oct 22 20 04

Denis Okup
DISTRICT ENGINEER

December 10, 20 04
Mike Nise
ENGINEER OF DESIGN AND ENVIRONMENT

December 10, 20 04
Victor Modera
DIRECTOR, DIVISION OF HIGHWAYS

**PRINTED BY THE AUTHORITY
OF THE STATE OF ILLINOIS**