

STATE OF ILLINOIS
DEPARTMENT OF TRANSPORTATION

ROUTE NO.	SECTION	COUNTY	SHEET NO.	SHEET NO. 1
		Will	12	5 SHEETS
FED. ROAD DIST. NO. 7	ILLINOIS	FED. AID PROJECT		

42767

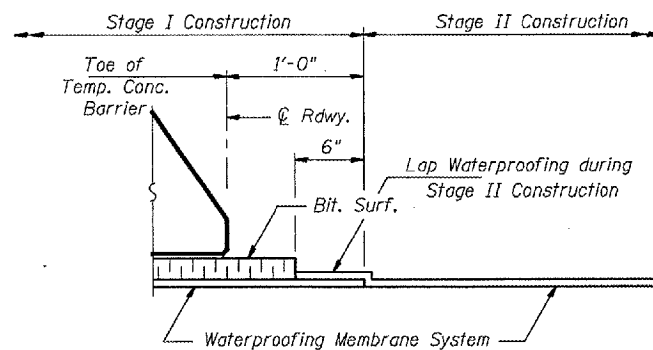
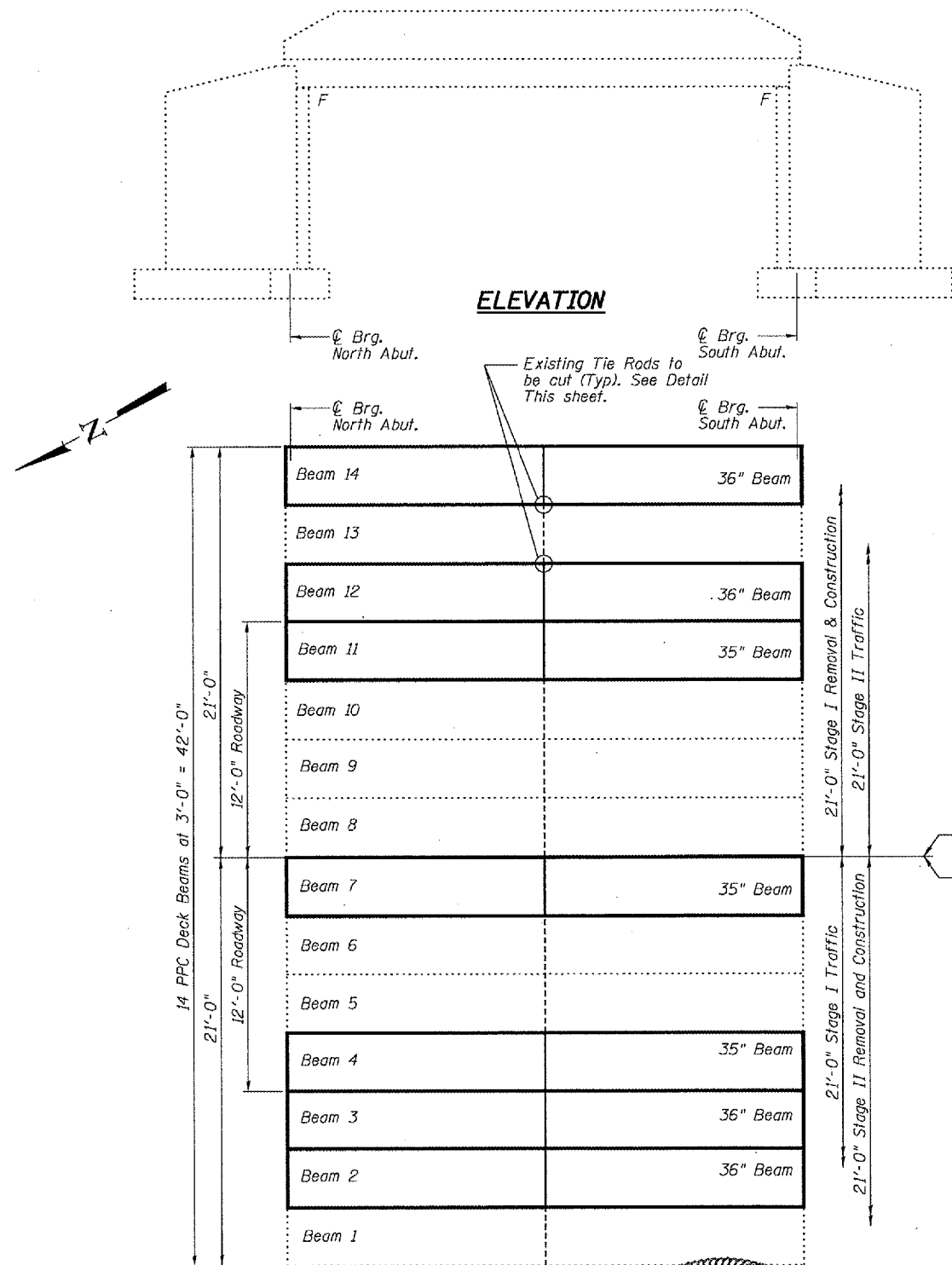

WATERPROOFING TREATMENT AT STAGE CONSTRUCTION

*Limits of Bituminous Concrete Surface Removal

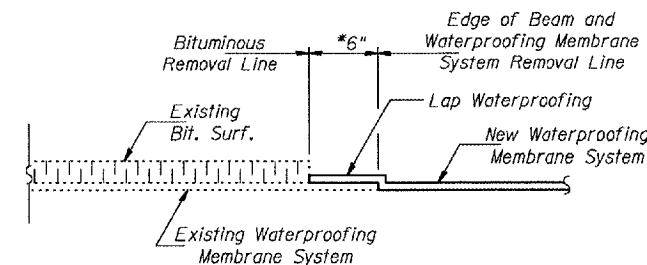

WATERPROOFING TREATMENT

GENERAL NOTES

Plan dimensions and details relative to existing structure have been taken from existing plans and are subject to nominal construction variations. It shall be the Contractor's responsibility to verify such dimensions and details in the field and make necessary approved adjustments prior to construction or ordering of materials. Such variations shall not be cause for additional compensation for a change in the scope of the work, however, the Contractor will be paid for the quantity actually furnished at the unit price bid for the work.

Any damage done to the bridge during beam removal shall be repaired by the Contractor. Cost to be included in the cost of "Removal of Existing P.P.C. Deck Beams".

Reinforcement bars shall conform to the requirements of AASHTO M-31 or M322 Grade 60.

The top surface of the beams shall be finished in accordance with Article 504.06 of the Standard Specifications except that the surface shall not be roughened by brooming. The finished surface shall be free of depressions or high spots with sharp corners, and the top edge of keys shall be rounded or chamfered a minimum of 1/4".

Temporary concrete barrier shall only be anchored into the overlay and not the PPC Deck Beams.

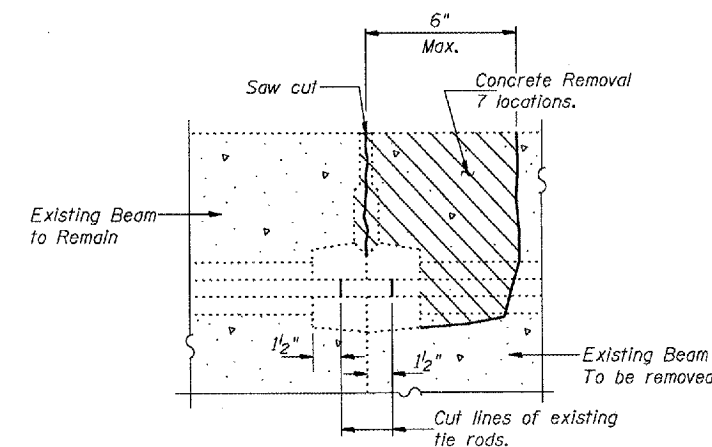

BEAM REMOVAL DETAIL AT TRANSVERSE TIES

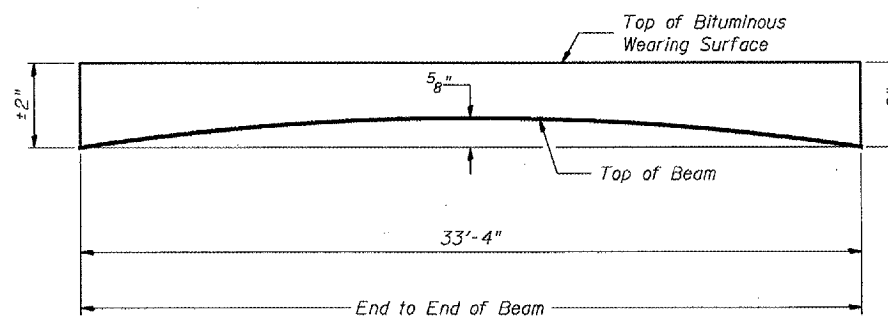

ANTICIPATED INITIAL CAMBER DIAGRAM

TOTAL BILL OF MATERIAL

ITEM	UNIT	QUANTITY
Precast Prestressed Concrete Deck Beams (17" Depth)	Sq. Ft.	692
Bituminous Concrete Surface Removal	Sq. Yd.	15.7
Removal of Existing PPC Deck Beams	Sq. Ft.	700
Bituminous Concrete Surface Course, Superpave Mix "D" N50	Tons	8.3
PC Mortar Fairing Course	Foot	333
Reinforcement Bars, Epoxy Coated	Pound	630
Waterproofing Membrane System	Sq. Yd.	93.5
Protective Coat	Sq. Yd.	14.2
Concrete Superstructure	Cu. Yd.	3.7
Concrete Removal	Cu. Yd.	3.7
Floor Drains	Each	5

DESIGN STRESSES

FIELD UNITS

f'c = 3,500 psi
f'y = 60,000 psi

DESIGN STRESSES

PRESTRESS UNITS

f'c = 5,000 psi
f'ci = 4,000 psi
f's = 270,000 psi (1/2" Low Relaxation Strands)
f'si = 201,960 psi (1/2" Low Relaxation Strands)

PLAN

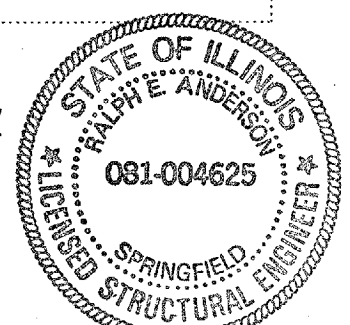

EXPIRES 11-30-06

DESIGNED	VICTOR H. VEHZ	December 3, 2004
CHECKED	David A. [Signature]	EXAMINED John A. Morris
DRAWN	[Signature]	PASSED Ralph E. Anderson
CHECKED	VHV PJS	

**PLAN AND ELEVATION
US 45 OVER JACKSON CREEK
WILL COUNTY
SN.099-2005**