

F.A.P. RTE.	SECTION	COUNTY	TOTAL SHEETS	SHEET NO.
742	37R-2	OGLE	389	34
STA.		TO STA.		
FED. ROAD DIST. NO.		ILLINOIS FED. AID PROJECT		

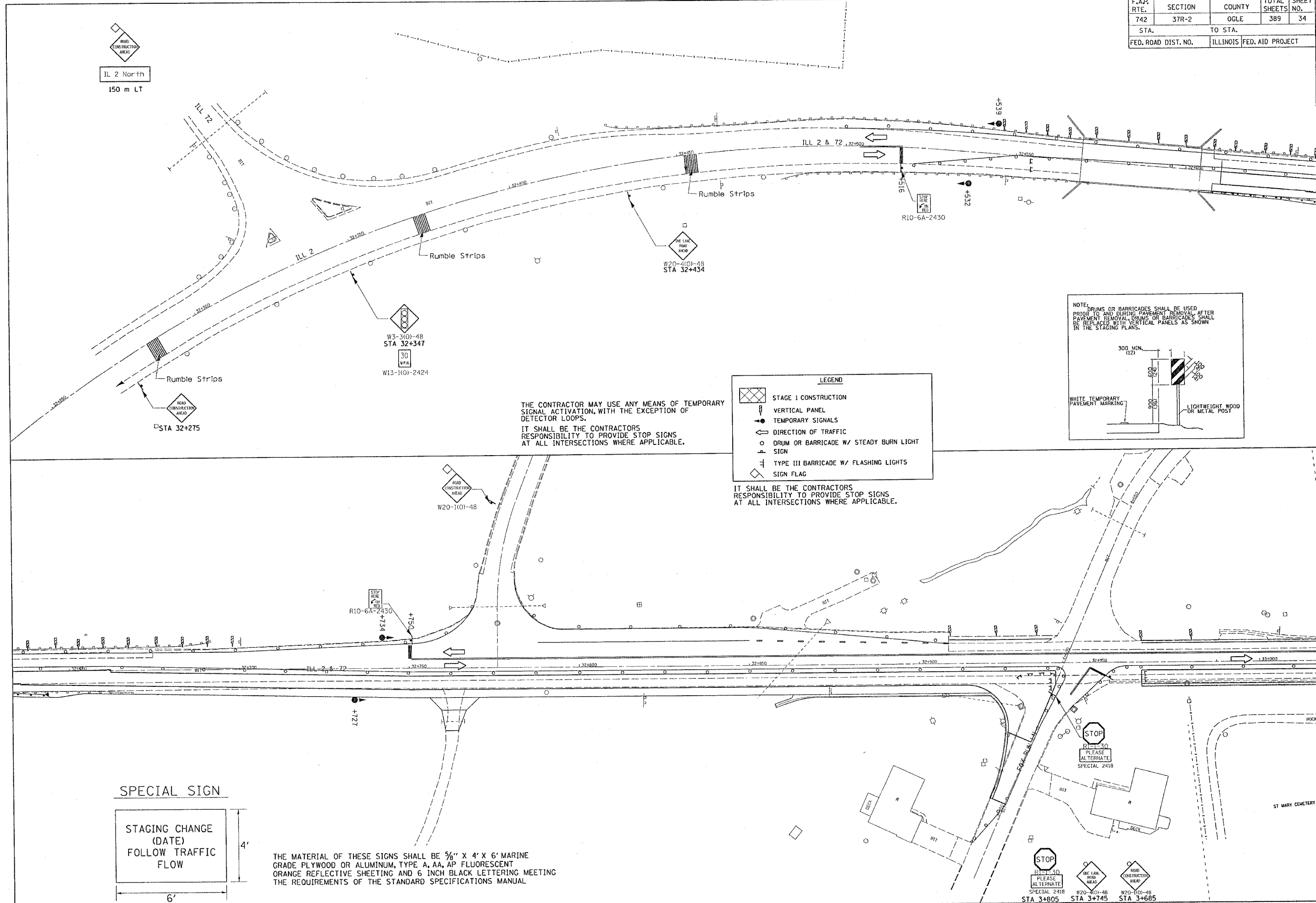

THE CONTRACTOR MAY USE ANY MEANS OF TEMPORARY SIGNAL ACTIVATION, WITH THE EXCEPTION OF DETECTOR LOOPS.
 IT SHALL BE THE CONTRACTORS RESPONSIBILITY TO PROVIDE STOP SIGNS AT ALL INTERSECTIONS WHERE APPLICABLE.

LEGEND

- STAGE I CONSTRUCTION
- VERTICAL PANEL
- TEMPORARY SIGNALS
- DIRECTION OF TRAFFIC
- DRUM OR BARRICADE W/ STEADY BURN LIGHT SIGN
- TYPE III BARRICADE W/ FLASHING LIGHTS
- SIGN FLAG

IT SHALL BE THE CONTRACTORS RESPONSIBILITY TO PROVIDE STOP SIGNS AT ALL INTERSECTIONS WHERE APPLICABLE.

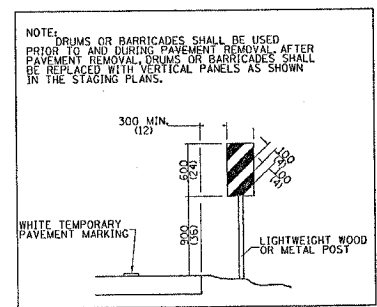

SPECIAL SIGN

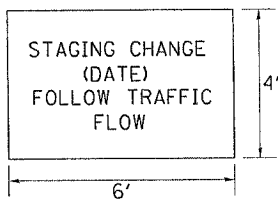

THE MATERIAL OF THESE SIGNS SHALL BE 5/8" X 4' X 6' MARINE GRADE PLYWOOD OR ALUMINUM, TYPE A, AA, AP FLUORESCENT ORANGE REFLECTIVE SHEETING AND 6 INCH BLACK LETTERING MEETING THE REQUIREMENTS OF THE STANDARD SPECIFICATIONS MANUAL

Map Out 18 11/16/05 2004
 c:\projects\m22858\stage1.dgn