

DRAINAGE DETAILS

F.A.P. RTE.	SECTION	COUNTY	TOTAL SHEETS	SHEET NO.
742	37R-2	OGLE	389	91
STA. 32+625		TO STA. 32+800		
FED. ROAD DIST. NO.		ILLINOIS FED. AID PROJECT		
CONTRACT #64157				



TOP ELEV. = LID ELEV

2.88m PIPE CULVERT
CLASS D TYPE 1 450mm

2 EACH END SECTION 450mm

6.40m PIPE CULVERT
CLASS D TYPE 1 450mm

MATCH LINE STA 32+625

MATCH LINE STA 32+800

- = EROSION CONTROL BLANKET
- = INLET PIPE PROTECTION
- = PERIMETER EROSION BARRIER
- = DITCH CHECK

2 EACH CORRUGATED STEEL PIPE
MULTIPLE END SECTIONS
EORS 1050mm (ARCH)

47.54m PIPE CULVERT CLASS D
TYPE 1 EQUIVALENT
ROUND-SIZE 1050mm (ARCH)

FINAL SURVEY	BY	DATE
SURVEY PLOTTED		
NOTE BOOK TEMPLATE		
AREAS CHECKED		
NO.		

ORIGINAL SURVEY	BY	DATE
SURVEY PLOTTED		
NOTE BOOK TEMPLATE		
AREAS CHECKED		
NO.		

Thu Sep 02 11:20:45 2004
c:\projects\m2808\6\drainage\dgn

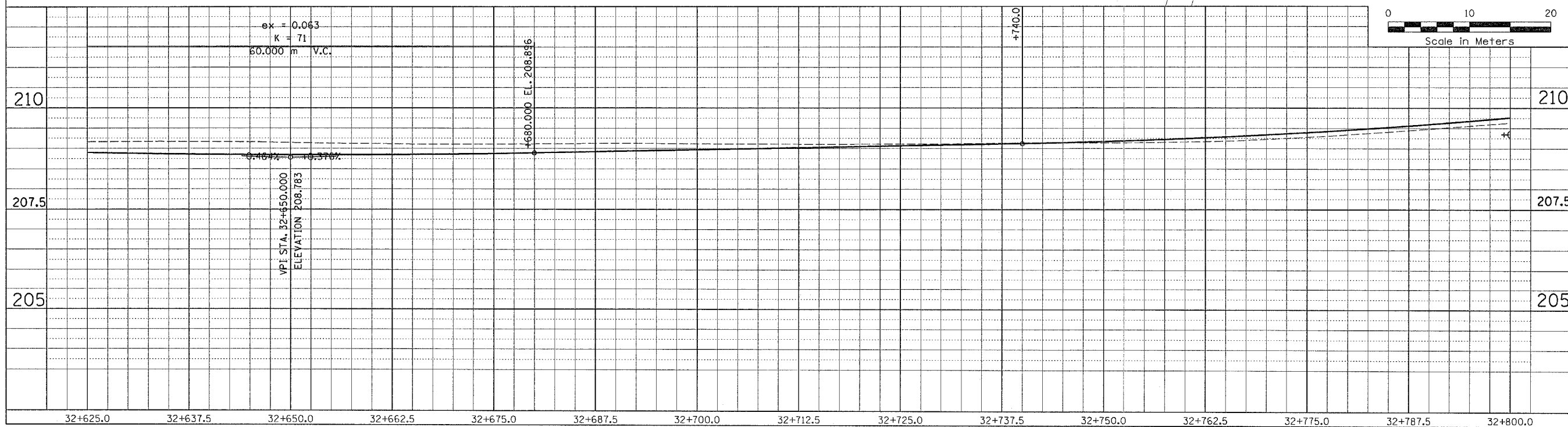

DRAINAGE DETAILS