

F.A. RTE.	SECTION	COUNTY	TOTAL SHEETS	SHEET NO.
(1R)TS	FAP330 (IL 17)	KANKAKEE	22	17
STA. _____		TO STA. _____		
FED. ROAD DIST. NO. _____		ILLINOIS FED. AID PROJECT		

CONTRACT NO. 66416

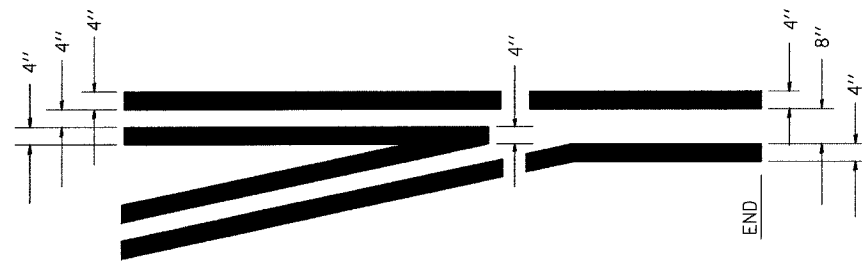

**TYPICAL APPLICATION
@ LEFT TURN LANES**

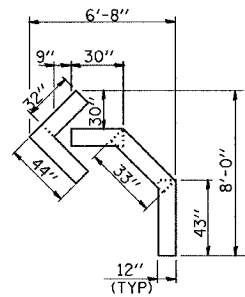
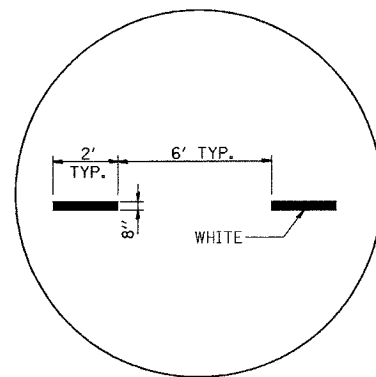

QUANTITY
12" LINE = 16 LIN. FT.
OR 4" LINE = 48 LIN. FT.

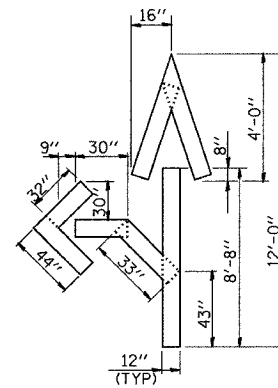

QUANTITY
12" LINE = 29 LIN. FT.
OR 4" LINE = 87 LIN. FT.

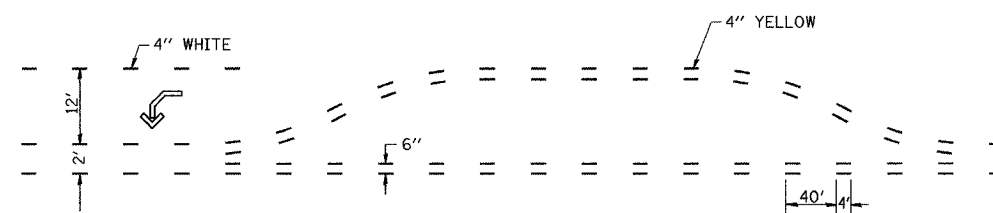

SHORT-TERM PAVEMENT MARKING FOR MEDIANS AND ARROWS

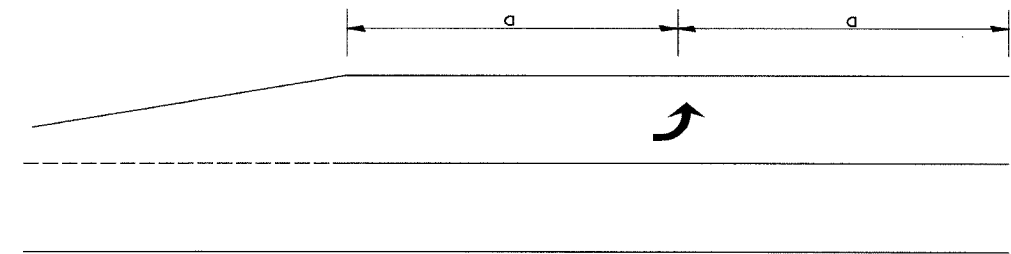

99' AND UNDER

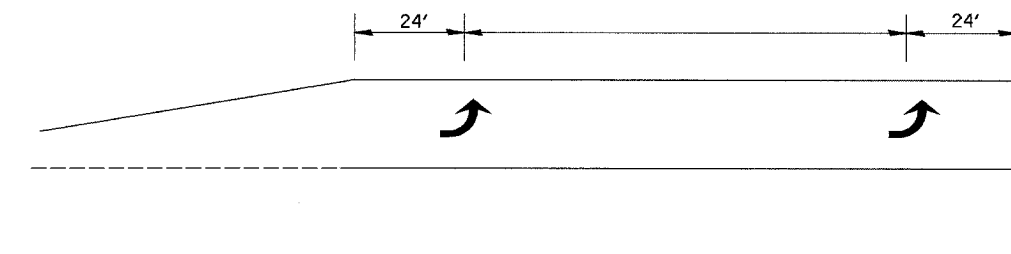

100' TO 149'

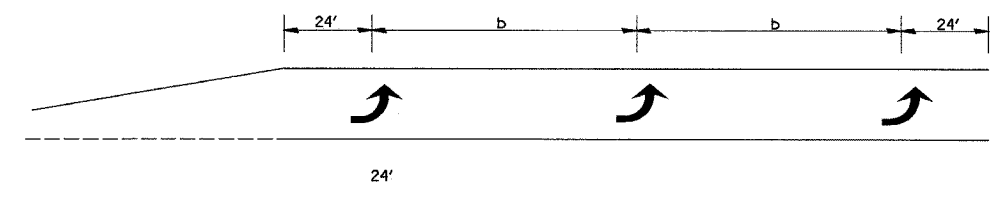

150' AND LONGER

**TYPICAL PLACEMENT OF ARROWS
IN TURN LANES**

IL ROUTE 17
AND CH 38 / LOWE ROAD
DETAILS
FAP ROUTE 330, FAU ROUTE 6209
SEC. NO. (1R)TS
KANKAKEE COUNTY