

STAGE I

F.A. RTE.	SECTION	COUNTY	TOTAL SHEETS	SHEET NO.
---	---	SANGAMON	44	16
STA.	TO STA.			
FED. ROAD DIST. NO.		ILLINOIS	FED. AID PROJECT	

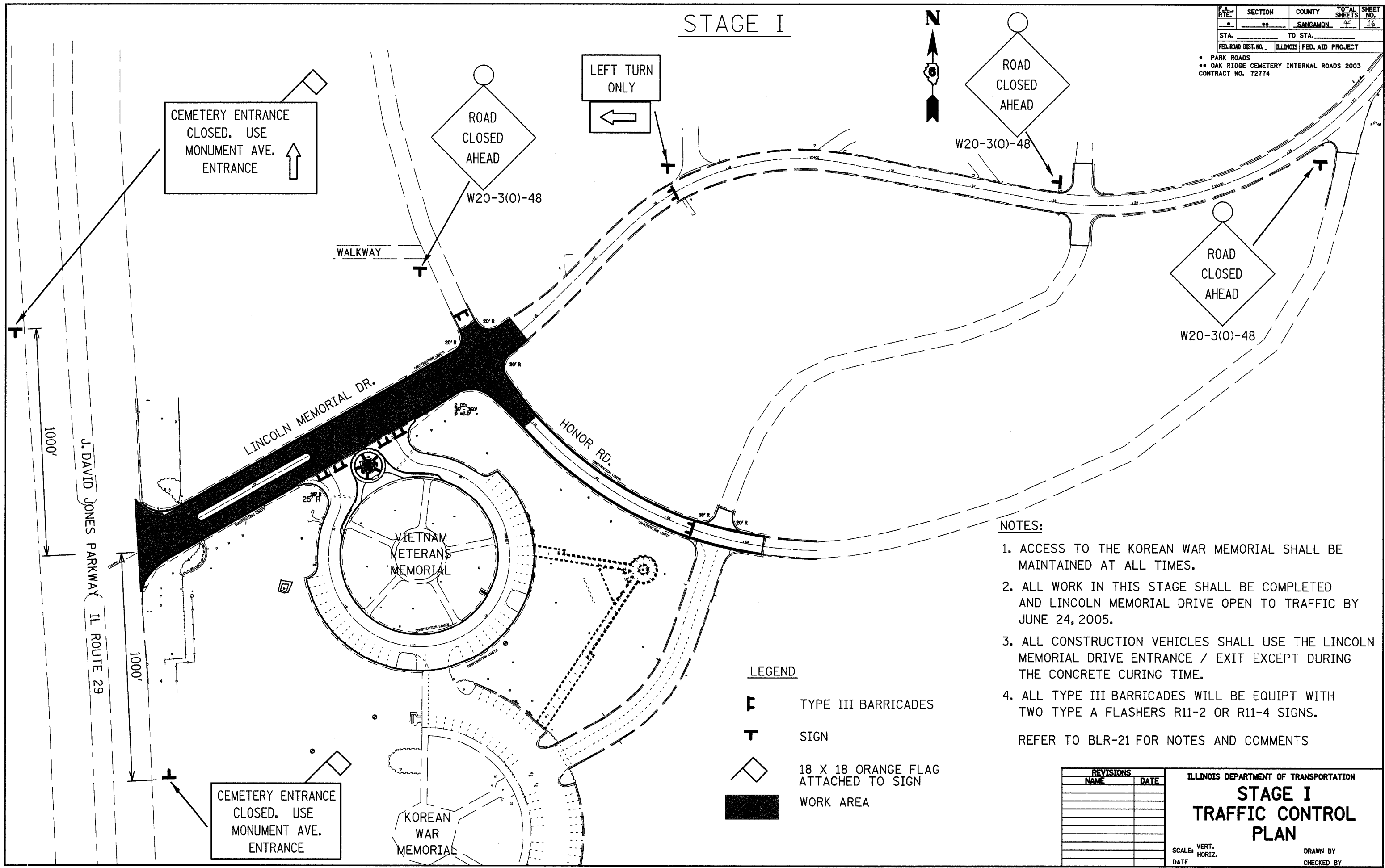

• PARK ROADS
 •• OAK RIDGE CEMETERY INTERNAL ROADS 2003
 CONTRACT NO. 72774



NOTES:

- ACCESS TO THE KOREAN WAR MEMORIAL SHALL BE MAINTAINED AT ALL TIMES.
 - ALL WORK IN THIS STAGE SHALL BE COMPLETED AND LINCOLN MEMORIAL DRIVE OPEN TO TRAFFIC BY JUNE 24, 2005.
 - ALL CONSTRUCTION VEHICLES SHALL USE THE LINCOLN MEMORIAL DRIVE ENTRANCE / EXIT EXCEPT DURING THE CONCRETE CURING TIME.
 - ALL TYPE III BARRICADES WILL BE EQUIPT WITH TWO TYPE A FLASHERS R11-2 OR R11-4 SIGNS.
- REFER TO BLR-21 FOR NOTES AND COMMENTS

LEGEND

- F** TYPE III BARRICADES
- T** SIGN
-  18 X 18 ORANGE FLAG ATTACHED TO SIGN
-  WORK AREA

REVISIONS	
NAME	DATE

ILLINOIS DEPARTMENT OF TRANSPORTATION
STAGE I
TRAFFIC CONTROL
PLAN

SCALE: VERT. _____
 HORIZ. _____

DATE _____ DRAWN BY _____
 CHECKED BY _____