

steffenmk
10/26/2004
c:\projects\74048d\02904p.dgn

FAP NO.	SECTION	COUNTY	TOTAL SHEETS	SHEET NO.
821		JEFFERSON	11	5

FED. ROAD DIST. NO. 7 ILLINOIS FED. AID PROJECT NO.
CONTRACT NO. 74048
• (13-2)RS-2,13ZRS-3

CURVE DATA
P.I. STA= 537+55.20
 Δ = 24° 34' 00.00" LT
D= 2° 20' 00.00"
R= 2,455.53
T= 534.64
L= 1,052.86
E= 57.53
S.E.=
P.C. STA= 532+20.56
P.T. STA= 542+73.42

CURVE DATA
P.I. STA= 555+72.53
 Δ = 20° 52' 55.00" RT
D= 1° 07' 60.00"
R= 5,055.51
T= 931.60
L= 1,842.52
E= 85.12
S.E.=
P.C. STA= 546+40.93
P.T. STA= 564+83.45

PROJECT BEGINS
STA. 543+46

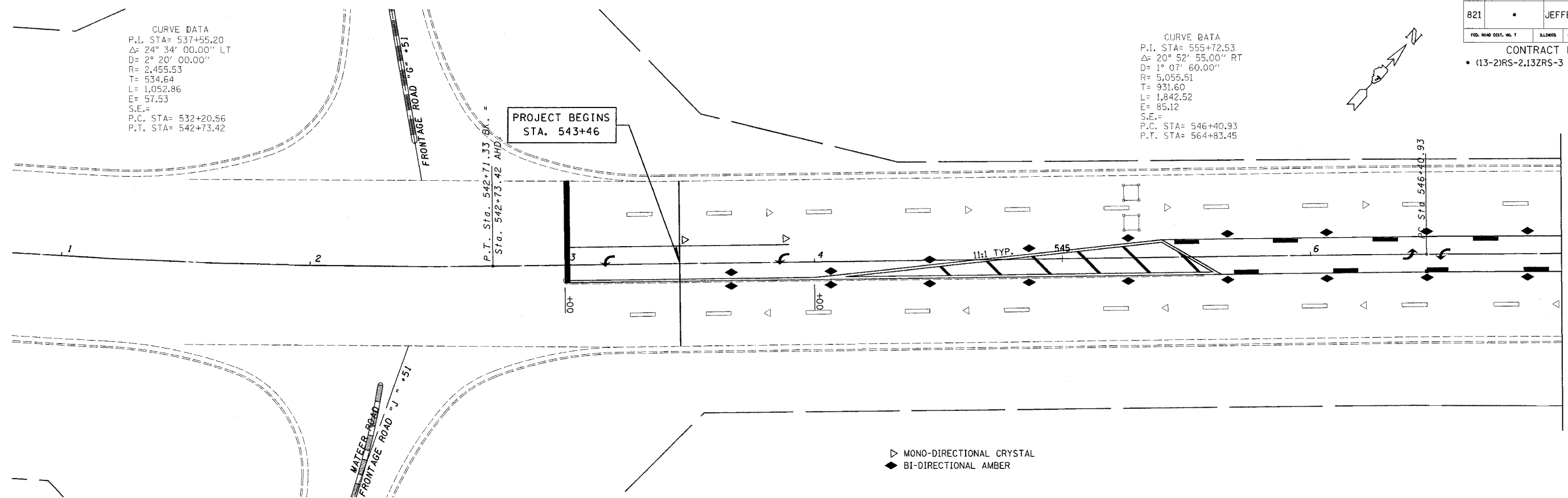
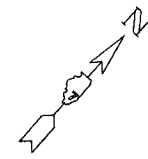

▷ MONO-DIRECTIONAL CRYSTAL
◆ BI-DIRECTIONAL AMBER

MATCHLINE STA 547+00

MATCHLINE STA 547+00

MATCHLINE STA 553+00

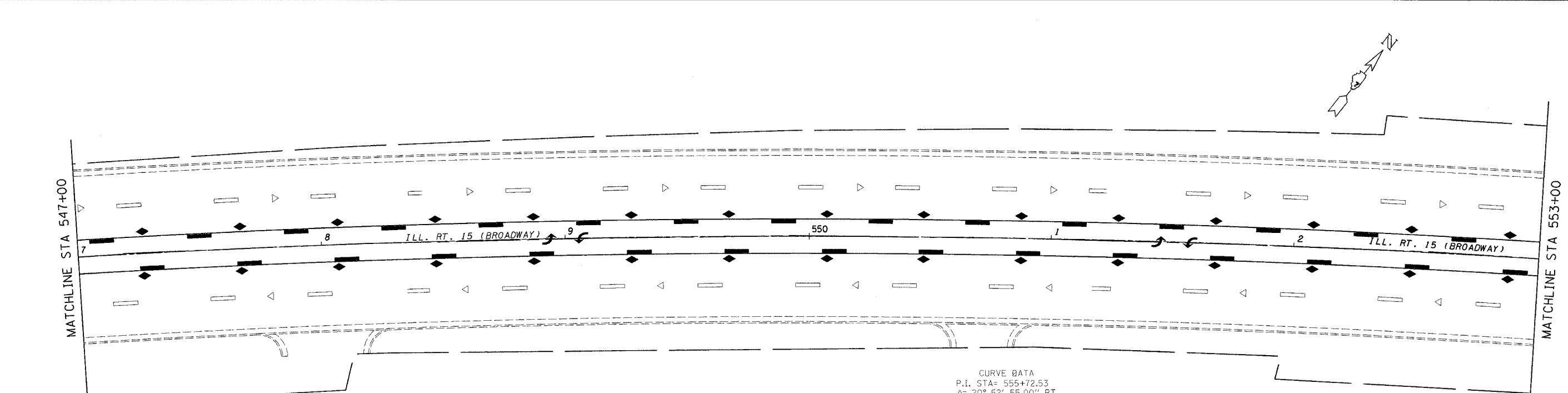

CURVE DATA
P.I. STA= 555+72.53
 Δ = 20° 52' 55.00" RT
D= 1° 07' 60.00"
R= 5,055.51
T= 931.60
L= 1,842.52
E= 85.12
S.E.=
P.C. STA= 546+40.93
P.T. STA= 564+83.45

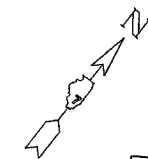

REVISIONS	
NAME	DATE

ILLINOIS DEPARTMENT OF TRANSPORTATION
**STA. 543 + 46
TO
STA. 553 + 00**
SCALE: VERT. _____
HORIZ. _____
DATE _____ DRAWN BY _____
CHECKED BY _____