

FAP RTE.	SECTION	COUNTY	TOTAL SHEETS	SHEET NO.
586	60R-2, 37R-1	MADISON	502	118
STA. 680+00		TO STA. 686+00		
CONTRACT NO.: 76301				

DATE: _____ BY: _____
 PROJECT: _____
 PLAN: _____
 NOTE BOOK NO.: _____
 DATE FILED: _____

DATE: _____ BY: _____
 PROFILE: _____
 GRADES CHECKED: _____
 STRUCTURE NOTATIONS CHECKED: _____

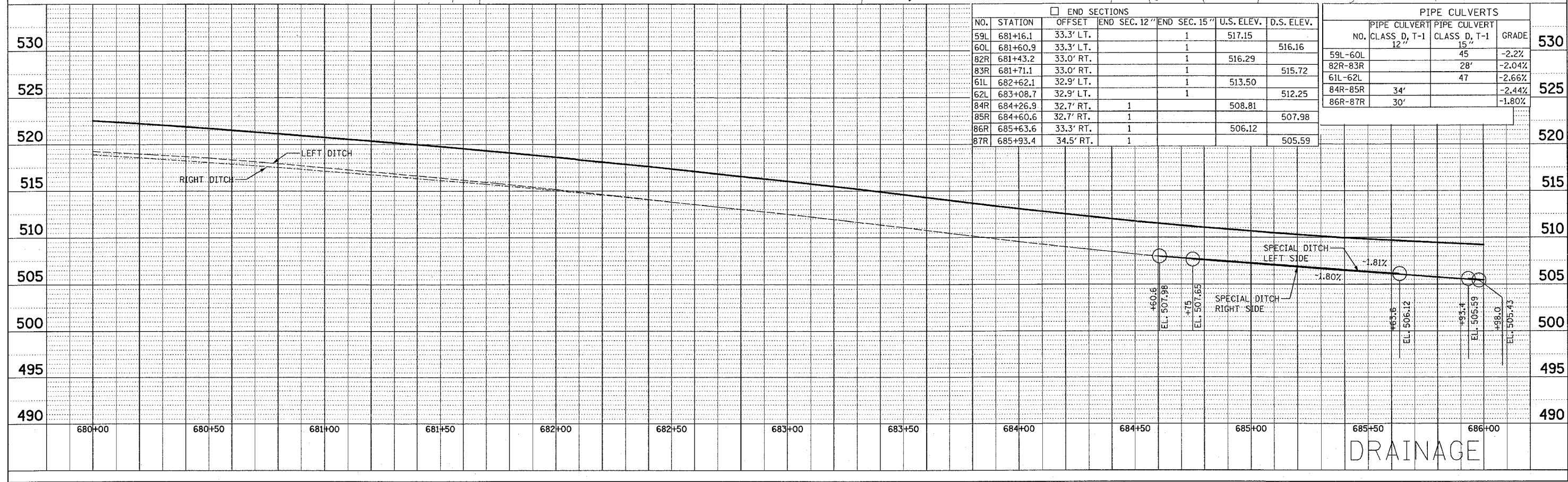
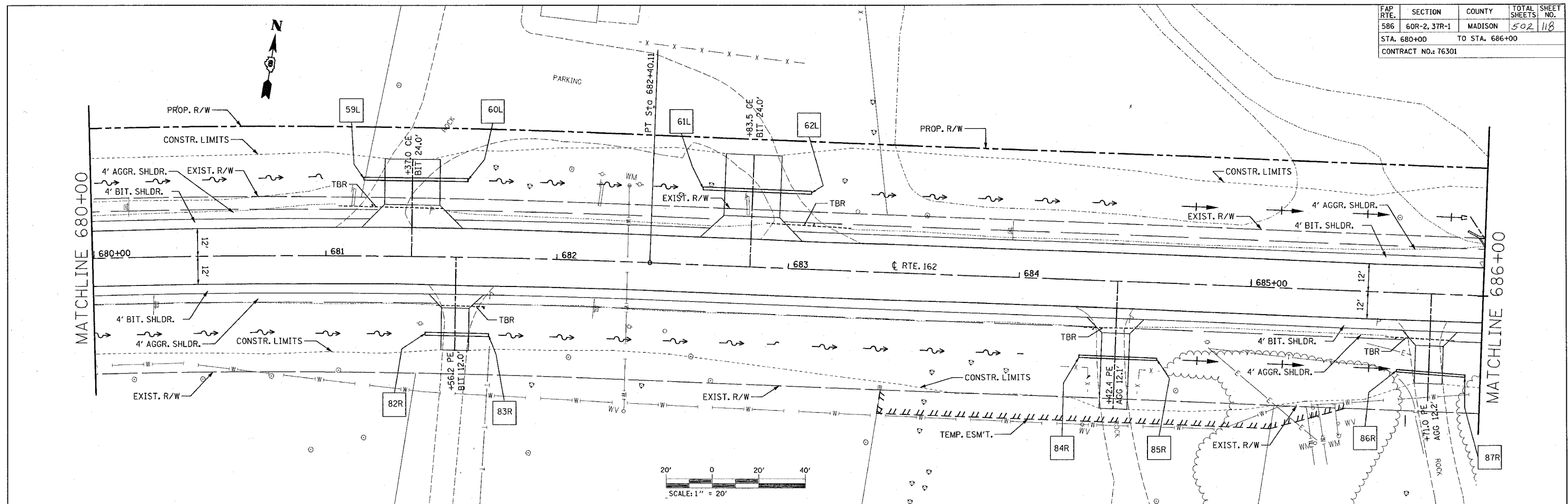

END SECTIONS						
NO.	STATION	OFFSET	END SEC. 12"	END SEC. 15"	U.S. ELEV.	D.S. ELEV.
59L	681+16.1	33.3' LT.		1	517.15	516.16
60L	681+60.9	33.3' LT.		1	516.29	515.72
82R	681+43.2	33.0' RT.		1	513.50	512.25
83R	681+71.1	33.0' RT.		1	508.81	507.98
61L	682+62.1	32.9' LT.		1	506.12	505.59
62L	683+08.7	32.9' LT.		1		
84R	684+26.9	32.7' RT.	1			
85R	684+60.6	32.7' RT.	1			
86R	685+63.6	33.3' RT.	1			
87R	685+93.4	34.5' RT.	1			

PIPE CULVERTS				
NO.	CLASS D, T-1	PIPE CULVERT CLASS D, T-1	PIPE CULVERT CLASS D, T-1	GRADE
59L-60L	12"	45'		-2.2%
82R-83R	28"	28'		-2.04%
61L-62L	47"			-2.66%
84R-85R	34'			-2.44%
86R-87R	30'			-1.80%

DRAINAGE