

FAP ROUTE	SECTION	COUNTY	TOTAL SHEETS	SHEET NO.
586	60R-2, 37R-1	MADISON	502	135
STA. 524+00		TO STA. 530+00		
EXISTING CONDITIONS: 76301				

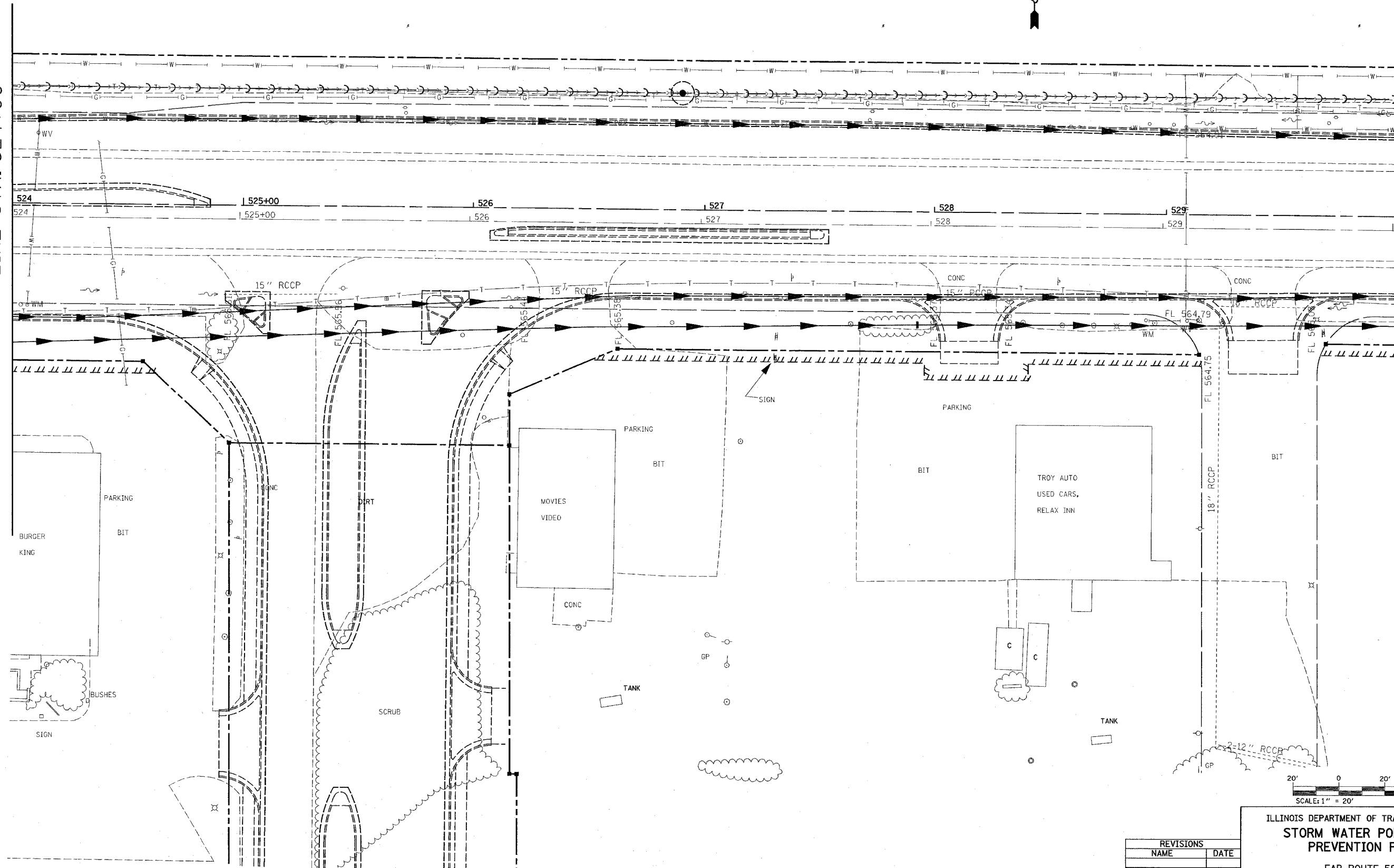

MATCHLINE STA. 524+00

MATCHLINE STA. 530+00



PLAN	NO. _____	DATE _____
NOTE BOOK	NO. _____	DATE _____
BY	_____	
PROJECT	_____	
FILE NAME	_____	

7/2/2004 8:30:59 AM
 C:\projects\586\60R-2,37R-1\182622.dwg LV1-53
 C:\projects\586\60R-2,37R-1\182622.dwg LV2-53
 C:\projects\586\60R-2,37R-1\182622.dwg LV3-53
 C:\projects\586\60R-2,37R-1\182622.dwg LV4-53
 C:\projects\586\60R-2,37R-1\182622.dwg LV5-53
 C:\projects\586\60R-2,37R-1\182622.dwg LV6-53
 C:\projects\586\60R-2,37R-1\182622.dwg LV7-53
 C:\projects\586\60R-2,37R-1\182622.dwg LV8-53
 C:\projects\586\60R-2,37R-1\182622.dwg LV9-53
 C:\projects\586\60R-2,37R-1\182622.dwg LV10-53
 C:\projects\586\60R-2,37R-1\182622.dwg LV11-53
 C:\projects\586\60R-2,37R-1\182622.dwg LV12-53
 C:\projects\586\60R-2,37R-1\182622.dwg LV13-53
 C:\projects\586\60R-2,37R-1\182622.dwg LV14-53
 C:\projects\586\60R-2,37R-1\182622.dwg LV15-53
 C:\projects\586\60R-2,37R-1\182622.dwg LV16-53
 C:\projects\586\60R-2,37R-1\182622.dwg LV17-53
 C:\projects\586\60R-2,37R-1\182622.dwg LV18-53
 C:\projects\586\60R-2,37R-1\182622.dwg LV19-53
 C:\projects\586\60R-2,37R-1\182622.dwg LV20-53
 C:\projects\586\60R-2,37R-1\182622.dwg LV21-53
 C:\projects\586\60R-2,37R-1\182622.dwg LV22-53
 C:\projects\586\60R-2,37R-1\182622.dwg LV23-53
 C:\projects\586\60R-2,37R-1\182622.dwg LV24-53
 C:\projects\586\60R-2,37R-1\182622.dwg LV25-53
 C:\projects\586\60R-2,37R-1\182622.dwg LV26-53
 C:\projects\586\60R-2,37R-1\182622.dwg LV27-53
 C:\projects\586\60R-2,37R-1\182622.dwg LV28-53
 C:\projects\586\60R-2,37R-1\182622.dwg LV29-53
 C:\projects\586\60R-2,37R-1\182622.dwg LV30-53
 C:\projects\586\60R-2,37R-1\182622.dwg LV31-53
 C:\projects\586\60R-2,37R-1\182622.dwg LV32-53
 C:\projects\586\60R-2,37R-1\182622.dwg LV33-53
 C:\projects\586\60R-2,37R-1\182622.dwg LV34-53
 C:\projects\586\60R-2,37R-1\182622.dwg LV35-53
 C:\projects\586\60R-2,37R-1\182622.dwg LV36-53
 C:\projects\586\60R-2,37R-1\182622.dwg LV37-53
 C:\projects\586\60R-2,37R-1\182622.dwg LV38-53
 C:\projects\586\60R-2,37R-1\182622.dwg LV39-53
 C:\projects\586\60R-2,37R-1\182622.dwg LV40-53
 C:\projects\586\60R-2,37R-1\182622.dwg LV41-53
 C:\projects\586\60R-2,37R-1\182622.dwg LV42-53
 C:\projects\586\60R-2,37R-1\182622.dwg LV43-53
 C:\projects\586\60R-2,37R-1\182622.dwg LV44-53
 C:\projects\586\60R-2,37R-1\182622.dwg LV45-53
 C:\projects\586\60R-2,37R-1\182622.dwg LV46-53
 C:\projects\586\60R-2,37R-1\182622.dwg LV47-53
 C:\projects\586\60R-2,37R-1\182622.dwg LV48-53
 C:\projects\586\60R-2,37R-1\182622.dwg LV49-53
 C:\projects\586\60R-2,37R-1\182622.dwg LV50-53
 C:\projects\586\60R-2,37R-1\182622.dwg LV51-53
 C:\projects\586\60R-2,37R-1\182622.dwg LV52-53
 C:\projects\586\60R-2,37R-1\182622.dwg LV53-53
 C:\projects\586\60R-2,37R-1\182622.dwg LV54-53
 C:\projects\586\60R-2,37R-1\182622.dwg LV55-53
 C:\projects\586\60R-2,37R-1\182622.dwg LV56-53
 C:\projects\586\60R-2,37R-1\182622.dwg LV57-53
 C:\projects\586\60R-2,37R-1\182622.dwg LV58-53
 C:\projects\586\60R-2,37R-1\182622.dwg LV59-53
 C:\projects\586\60R-2,37R-1\182622.dwg LV60-53
 C:\projects\586\60R-2,37R-1\182622.dwg LV61-53
 C:\projects\586\60R-2,37R-1\182622.dwg LV62-53
 C:\projects\586\60R-2,37R-1\182622.dwg LV63-53
 C:\projects\586\60R-2,37R-1\182622.dwg LV64-53
 C:\projects\586\60R-2,37R-1\182622.dwg LV65-53
 C:\projects\586\60R-2,37R-1\182622.dwg LV66-53
 C:\projects\586\60R-2,37R-1\182622.dwg LV67-53
 C:\projects\586\60R-2,37R-1\182622.dwg LV68-53
 C:\projects\586\60R-2,37R-1\182622.dwg LV69-53
 C:\projects\586\60R-2,37R-1\182622.dwg LV70-53
 C:\projects\586\60R-2,37R-1\182622.dwg LV71-53
 C:\projects\586\60R-2,37R-1\182622.dwg LV72-53
 C:\projects\586\60R-2,37R-1\182622.dwg LV73-53
 C:\projects\586\60R-2,37R-1\182622.dwg LV74-53
 C:\projects\586\60R-2,37R-1\182622.dwg LV75-53
 C:\projects\586\60R-2,37R-1\182622.dwg LV76-53
 C:\projects\586\60R-2,37R-1\182622.dwg LV77-53
 C:\projects\586\60R-2,37R-1\182622.dwg LV78-53
 C:\projects\586\60R-2,37R-1\182622.dwg LV79-53
 C:\projects\586\60R-2,37R-1\182622.dwg LV80-53
 C:\projects\586\60R-2,37R-1\182622.dwg LV81-53
 C:\projects\586\60R-2,37R-1\182622.dwg LV82-53
 C:\projects\586\60R-2,37R-1\182622.dwg LV83-53
 C:\projects\586\60R-2,37R-1\182622.dwg LV84-53
 C:\projects\586\60R-2,37R-1\182622.dwg LV85-53
 C:\projects\586\60R-2,37R-1\182622.dwg LV86-53
 C:\projects\586\60R-2,37R-1\182622.dwg LV87-53
 C:\projects\586\60R-2,37R-1\182622.dwg LV88-53
 C:\projects\586\60R-2,37R-1\182622.dwg LV89-53
 C:\projects\586\60R-2,37R-1\182622.dwg LV90-53
 C:\projects\586\60R-2,37R-1\182622.dwg LV91-53
 C:\projects\586\60R-2,37R-1\182622.dwg LV92-53
 C:\projects\586\60R-2,37R-1\182622.dwg LV93-53
 C:\projects\586\60R-2,37R-1\182622.dwg LV94-53
 C:\projects\586\60R-2,37R-1\182622.dwg LV95-53
 C:\projects\586\60R-2,37R-1\182622.dwg LV96-53
 C:\projects\586\60R-2,37R-1\182622.dwg LV97-53
 C:\projects\586\60R-2,37R-1\182622.dwg LV98-53
 C:\projects\586\60R-2,37R-1\182622.dwg LV99-53
 C:\projects\586\60R-2,37R-1\182622.dwg LV100-53

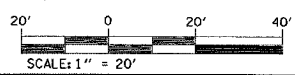

REVISIONS	
NAME	DATE

ILLINOIS DEPARTMENT OF TRANSPORTATION
STORM WATER POLLUTION PREVENTION PLAN
 FAP ROUTE 586
 SECTION 60R-2, 37R-1
 MADISON COUNTY
 DRAWN BY: _____

PLOT DATE: Friday July 02, 2004 @ 8:30:59 AM