

FAP ROUTE	SECTION	COUNTY	TOTAL SHEETS	SHEET NO
586	60R-2, 37R-1	MADISON	502	138
STA. 542+00		TO STA. 548+00		
EXISTING CONDITIONS: 76301				

PLAN	DATE
BY	
NO. OF WAYS CHECKED	
NO. OF WAYS CHECKED	
NO. OF WAYS CHECKED	
NO. OF WAYS CHECKED	
NO. OF WAYS CHECKED	
NO. OF WAYS CHECKED	
NO. OF WAYS CHECKED	
NO. OF WAYS CHECKED	

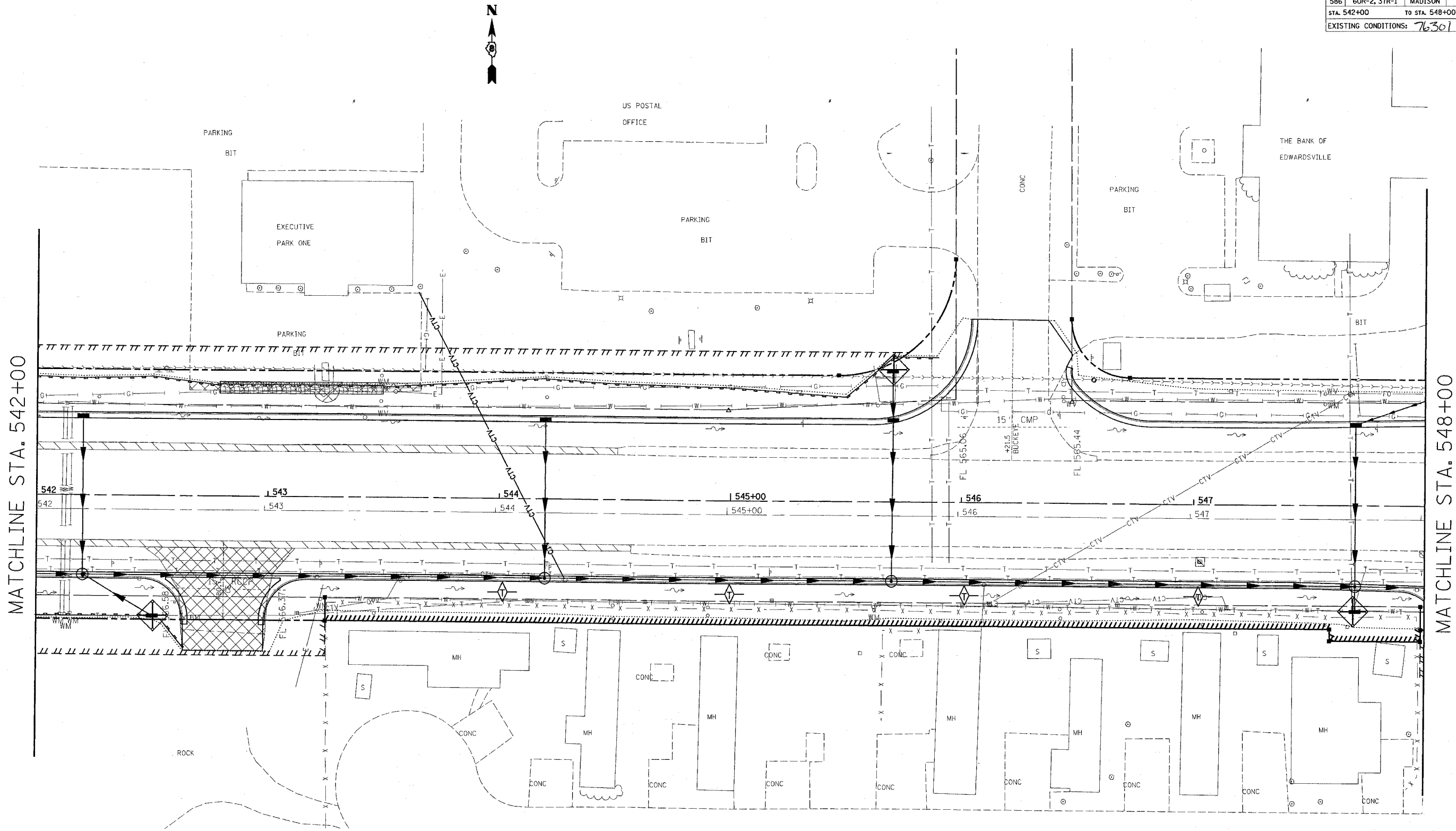

7/2/2004 8:30:59 AM
 C:\projects\61699\plan\p10885b.dgn LVL1-53
 C:\projects\61699\plan\p10885b.dgn LVL1-53
 C:\projects\61699\plan\p10885b.dgn LVL1-53
 C:\projects\61699\plan\p10885b.dgn LVL1-53
 C:\projects\61699\plan\p10885b.dgn LVL1-53
 C:\projects\61699\plan\p10885b.dgn LVL1-53
 C:\projects\61699\plan\p10885b.dgn LVL1-53
 C:\projects\61699\plan\p10885b.dgn LVL1-53
 C:\projects\61699\plan\p10885b.dgn LVL1-53
 C:\projects\61699\plan\p10885b.dgn LVL1-53

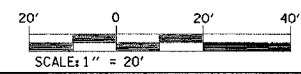

REVISIONS	
NAME	DATE

ILLINOIS DEPARTMENT OF TRANSPORTATION
STORM WATER POLLUTION PREVENTION PLAN
 FAP ROUTE 586
 SECTION 60R-2, 37R-1
 MADISON COUNTY
 DRAWN BY:
 PLOT DATE: Friday July 02, 2004 @ 8:30:59 AM