

LEGEND

- DUAL ENTRY PHASE
- OVERLAP
- PEDESTRIAN PHASE
- * NUMBER REFERS TO ASSOCIATED PHASE.

PROPOSED PHASE DESIGNATION DIAGRAM

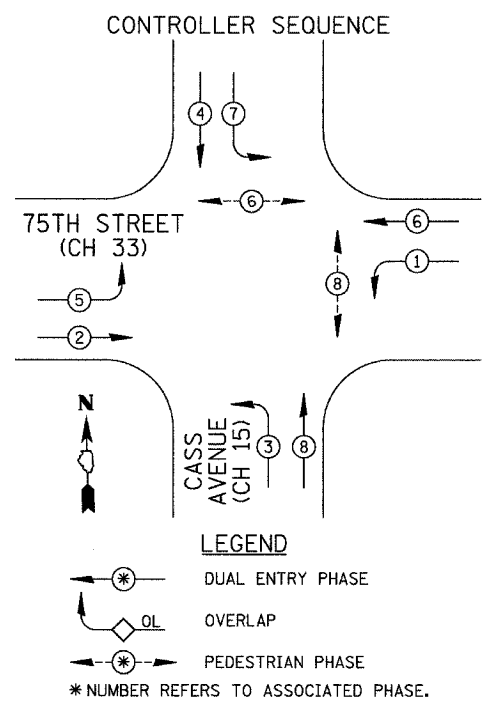

LEGEND

- DUAL ENTRY PHASE
- OVERLAP
- PEDESTRIAN PHASE
- * NUMBER REFERS TO ASSOCIATED PHASE.

EXISTING PHASE DESIGNATION DIAGRAM

SCHEDULE OF QUANTITIES

81400115	HANDHOLE TO BE ADJUSTED	EACH	2
85000200	MAINTENANCE OF EXISTING TRAFFIC SIGNAL INSTALLATION	EACH	1
87301215	ELECTRIC CABLE IN CONDUIT, SIGNAL NO. 14 2/C	FOOT	181
87301225	ELECTRIC CABLE IN CONDUIT, SIGNAL NO. 14 3/C	FOOT	352
X8810610	PEDESTRIAN SIGNAL HEAD, L.E.D., 1-FACE, BRACKET MOUNTED	EACH	4
X8810620	PEDESTRIAN SIGNAL HEAD, L.E.D., 2-FACE, BRACKET MOUNTED	EACH	2
88800100	PEDESTRIAN PUSHBUTTON	EACH	2
89502200	MODIFY EXISTING CONTROLLER	EACH	1
89502375	REMOVE EXISTING TRAFFIC SIGNAL EQUIPMENT	EACH	1

NOTE: REMOVE EXISTING TRAFFIC SIGNAL EQUIPMENT, SHALL CONSIST OF THE REMOVAL OF FOUR EXISTING (TEXT) 1-FACE BRACKET MOUNTED PEDESTRIAN SIGNAL INDICATIONS, TO BE REPLACED WITH SYMBOL PEDESTRIAN INDICATIONS.

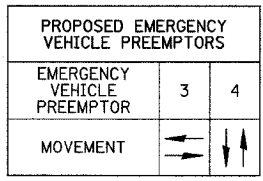
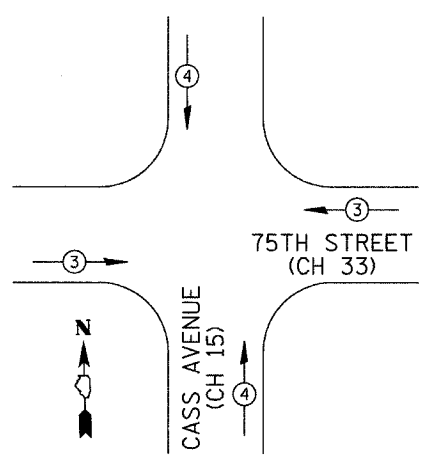

EMERGENCY VEHICLE PREEMPTION SEQUENCE
EXISTING - TO REMAIN

I.D.O.T. TRAFFIC SIGNAL INSTALLATION ELECTRICAL SERVICE REQUIREMENTS					TOTAL WATTAGE
TYPE	NO. LAMPS	WATTAGE		% OPERATION	
SIGNAL (RED)	16	135	-	0.50	1080
(YELLOW)	16	135	-	0.25	540
(GREEN)	16	135	-	0.25	540
ARROW	8	135	-	0.10	108
PED. SIGNALS	8	-	25	1.00	200
CONTROLLER	1	100	-	1.00	100
ILLUM. SIGN	-	-	-	0.05	-
FLASHER	-	-	-	-	-
ENERGY COSTS TO: DUPAGE COUNTY					2568

FOUNDATION (DEPTH)	FT. (m)	CABLE SLACK	FT. (m)	VERTICAL	FT. (m)
TYPE A - POST	4 (1.2)	HANDHOLE	6.5 (2.0)	ALL FOUNDATIONS	3.5 (1.0)
D - CONTROLLER	4 (1.2)	DOUBLE HANDHOLE	13 (4.0)	MAST ARM (L) POLE	20'-H-2=
E - MAST ARM POLE		SIGNAL POST	2 (1.0)	(6 m+L-0.6 m)=	
24" (600 mm)	10 (3.0)	CONTROLLER CABINET	1 (0.5)	BRACKET MOUNTED	13 (4.0)
30" (750 mm)	15 (4.6)	FIBER OPTIC	13 (4.0)	PEDESTRIAN PUSHBUTTON	4 (1.2)
		ELECTRIC SERVICE	1 (0.5)	ELECTRIC SERVICE	13.5 (4.1)
		GROUND CABLE	1 (0.5)	SERVICE TO GROUND	13.5 (4.1)
				POST MOUNTED	6 (1.8)

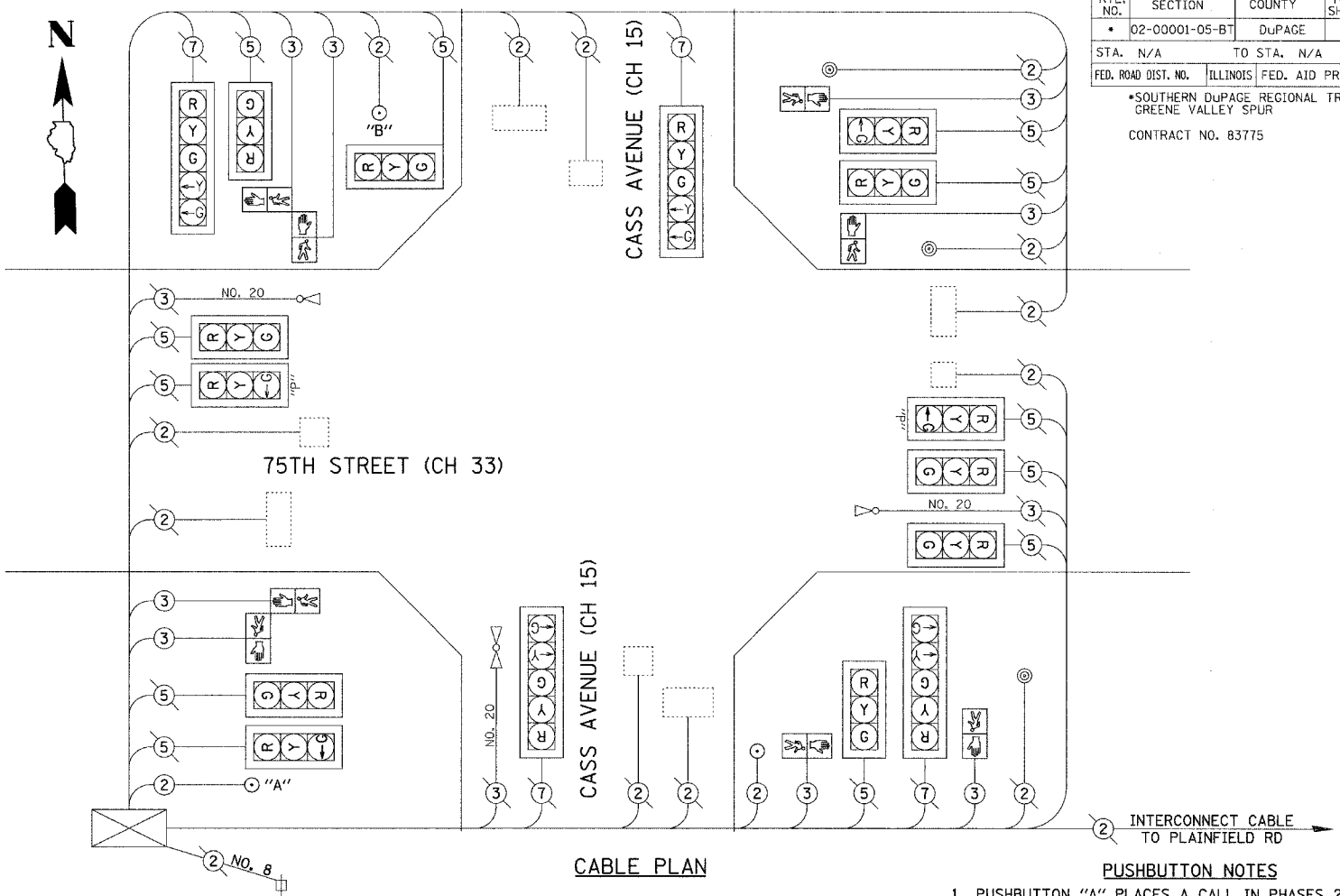

CABLE PLAN

EXISTING PROPOSED

		8" (200 mm) TRAFFIC SIGNAL SECTION
		12" (300 mm) TRAFFIC SIGNAL SECTION
		12" (300 mm) PEDESTRIAN SIGNAL SECTION
		12" (300 mm) PEDESTRIAN SIGNAL SECTION
		CONTROLLER CABINET
		SERVICE INSTALLATION
		TELEPHONE CONNECTION
		VEHICLE DETECTOR, INDUCTION LOOP
		MAGNETIC DETECTOR
		EMERGENCY VEHICLE LIGHT DETECTOR
		CONFIRMATION BEACON
		PEDESTRIAN PUSHBUTTON DETECTOR
		2 DENOTES NUMBER OF CONDUCTORS. ALL CABLE NO. 14 EXCEPT AS INDICATED. ALL LOOP DETECTOR CABLE TO BE SHIELDED.
		1 GROUND CABLE IN CONDUIT NO. 6 SOLID COPPER (GREEN)

CABLE PLAN LEGEND

EXISTING PROPOSED

		FIBER OPTIC CABLE IN CONDUIT NO. 62.5/125 2-MM12F SM12F
		SIGNAL FACE WITH BACKPLATE. "P" INDICATES PROGRAMMED HEAD.
		RAILROAD CONTROL CABINET
		ILLUMINATED SIGN "NO LEFT TURN"
		ILLUMINATED SIGN "NO RIGHT TURN"
		GROUND ROD AT HANDHOLE (H), DOUBLE HANDHOLE (H), OR CONTROLLER (C)
		GROUND ROD AT POST (P) OR MAST ARM POLE (MA)
		GROUND ROD AT ELECTRIC SERVICE INSTALLATION

PUSHBUTTON NOTES
1. PUSHBUTTON "A" PLACES A CALL IN PHASES 2 AND 4.
2. PUSHBUTTON "B" PLACES A CALL IN PHASES 4 AND 6.

REVISIONS	
NAME	DATE

ILLINOIS DEPARTMENT OF TRANSPORTATION
75TH STREET (CH 33) AND CASS AVENUE (CH 15)
CABLE PLAN, CONTROLLER SEQUENCE, EMERGENCY VEHICLE PREEMPTION SEQUENCE & SUMMARY OF QUANTITIES
SCALE: N/A
DATE: 5/10/04
DRAWN BY: SRH & BSL
DESIGNED BY: JM
CHECKED BY: JM & SRH