

MAIN LINE VOLUMES

RTE.	SECTION	COUNTY	TOTAL SHEETS	SHEET NO.
FAU 9878	93-00027-00-FP	WINNEBAGO	22	18
F.H.V.A. REG	ILLINOIS	PROJECT	M-5291 (8)	

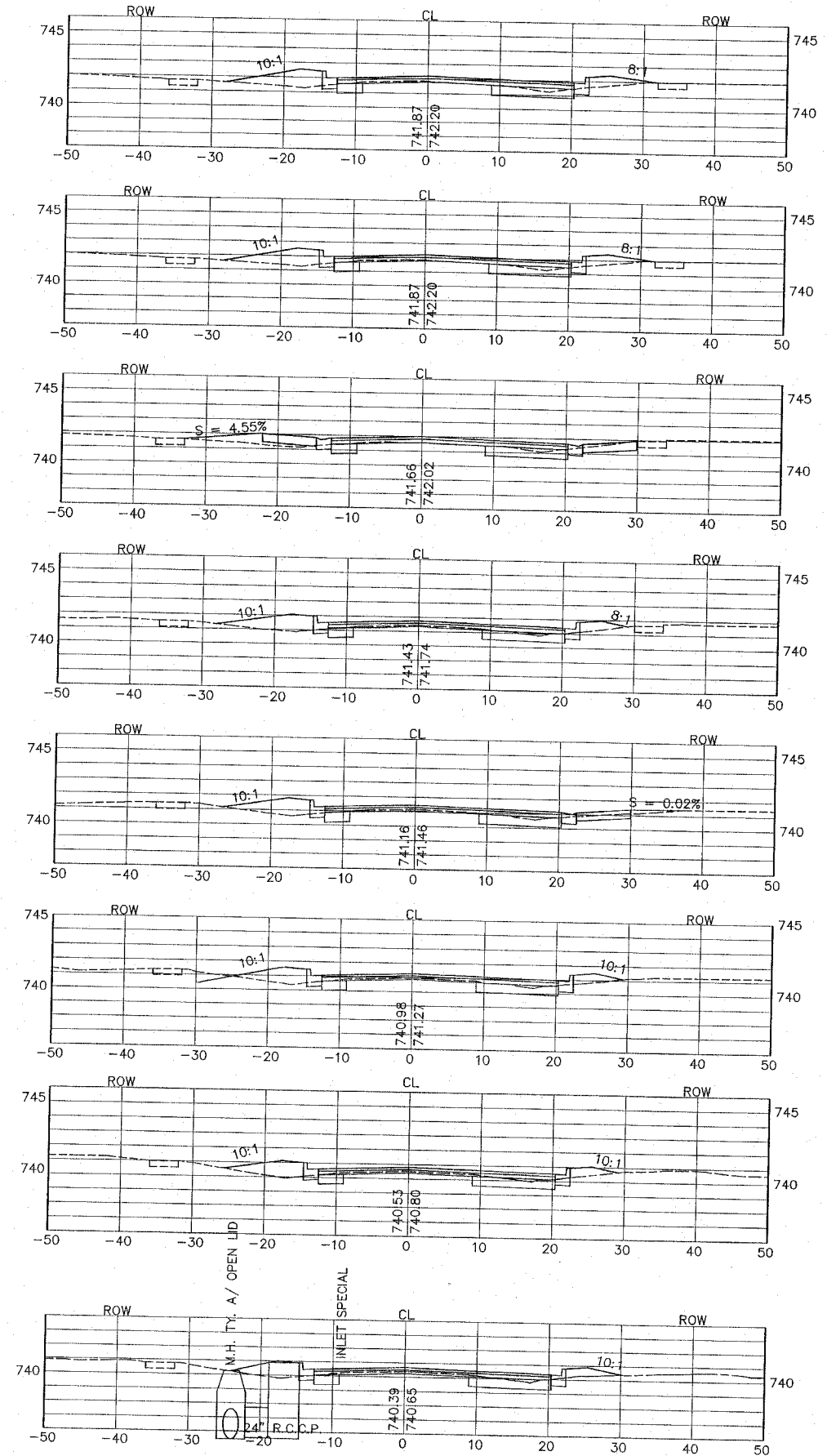

76+14

76+00

75+80.48

75+50

75+19.95

75+00

74+50

74+33.54

STA	CUT	FILL	BALANCED CUT	FILL	DIFFERENCE	RUNNING TOTAL CUT	FILL
53+00	30.40	17.40	28.15	16.11	12.04	28.15	16.11
53+20.18	35.90	7.70	61.39	23.24	38.15	63.54	39.35
54+00	45.60	47.50	75.46	90.98	15.52	139.00	130.33
54+20	76.10	31.40	114.54	72.87	41.67	253.54	163.15
54+40	69.90	21.70	137.04	49.17	87.87	491.50	212.31
54+60	59.10	28.10	119.44	46.11	73.33	610.94	285.62
54+78	38.30	30.80	90.19	54.54	35.65	601.21	321.96
55+00	42.40	15.70	74.72	43.06	31.67	700.93	356.02
55+20	46.80	19.00	81.48	32.13	49.35	782.41	385.15
55+36.39	45.30	14.00	84.17	31.39	52.78	865.58	419.54
55+50	45.40	11.80	89.98	24.22	65.76	955.56	444.28
55+75	46.80	15.10	95.37	24.91	70.46	1036.03	469.17
56+00	41.80	17.30	81.65	30.00	51.65	1117.68	490.17
56+20	40.00	15.80	76.11	30.66	45.45	1193.89	529.61
56+50	43.50	5.00	77.87	18.28	59.59	1271.76	549.67
56+75	41.40	10.70	78.81	14.64	64.07	1350.37	583.61
57+00	35.00	17.30	71.20	26.93	44.27	1421.55	598.54
57+14.30	28.70	16.40	59.44	31.20	28.24	1481.02	620.74
57+60	24.00	31.70	46.26	44.54	4.28	1530.28	665.28
57+81.39	24.30	31.80	45.19	55.81	-10.62	1575.46	723.89
57+84.60	27.90	8.10	47.86	45.37	2.49	1621.76	760.65
58+00	23.90	40.80	58.00	71.20	13.20	1726.76	872.22
58+50	35.50	36.00	34.44	52.60	18.16	1821.21	929.72
59+00	66.50	20.10	103.24	16.17	87.07	1924.45	948.88
59+17.59	45.00	0.00	89.44	9.63	79.81	2013.89	958.52
59+50	51.60	10.40	91.20	17.22	73.98	2105.05	975.74
59+86.30	46.90	8.20	52.22	12.89	39.33	2197.32	988.33
60+00	52.70	5.40	135.28	5.00	130.28	2332.59	993.33
60+34.62	93.40	0.00	141.67	3.70	137.97	2474.17	997.04
61+00	59.80	4.00	157.13	3.70	153.43	2631.30	1000.74
61+26.80	110.20	0.00	168.72	27.78	140.94	2801.02	1028.52
61+50	73.10	30.10	146.78	32.13	114.65	2947.78	1060.65
62+00	85.40	4.70	172.50	4.35	168.15	3120.28	1065.00
62+40	100.90	0.00	236.43	0.00	236.43	3356.71	1065.00
62+85	124.20	0.00	286.80	0.00	286.80	3643.51	1065.00
63+00	165.60	0.00	245.28	0.00	245.28	3888.84	1065.00
63+33.06	79.50	0.00	142.87	0.00	142.87	4031.71	1065.00
63+50	75.00	0.00	163.52	0.00	163.52	4197.22	1065.00
64+00	101.80	0.00	162.31	0.00	162.31	4359.54	1065.00
64+50	73.70	0.00	153.70	0.00	153.70	4483.24	1065.00
64+74.33	92.30	0.00	177.59	0.00	177.59	4660.84	1065.00
64+78.81	99.50	0.00	165.08	0.00	165.08	4840.93	1065.00
64+89.10	85.00	0.00	171.02	1.11	169.91	5011.85	1066.11
65+00	69.70	1.20	154.07	2.59	151.48	5166.02	1068.70
65+50	76.70	1.60	146.20	2.60	143.60	5312.22	1071.20
66+00	61.20	1.10	120.83	1.02	119.81	5433.06	1072.22
66+45.19	49.30	0.00	80.74	0.00	80.74	5523.80	1072.22
66+50	48.70	0.00	89.44	6.85	82.59	5613.24	1075.07
66+83.04	47.90	7.40	88.61	9.81	78.80	5701.85	1085.98
67+00	47.80	3.30	88.62	6.65	81.97	5790.37	1094.03
67+42.95	47.80	2.60	91.76	4.61	87.15	5882.13	1099.54
67+50	51.30	2.90	83.15	6.48	76.67	5975.28	1105.00
67+81.15	49.30	3.40	89.26	6.39	82.87	6064.54	1111.39
68+00	47.10	3.60	70.46	5.99	64.47	6135.00	1116.48
68+50	29.00	2.00	50.19	13.08	37.11	6185.19	1129.54
68+74.29	25.20	12.10	41.20	22.91	18.29	6228.39	1151.85
69+00	19.30	12.00	35.74	23.24	12.50	6262.13	1175.09
69+50	19.30	13.10	33.51	22.87	10.64	6296.74	1197.95
70+00	17.00	11.60	30.74	27.59	3.15	6326.48	1223.45
70+13.46	16.20	18.20	30.19	30.56	-0.37	6356.67	1258.11
70+50	16.40	14.80	26.85	29.72	-2.87	6383.92	1285.83
70+82.46	12.60	17.30	22.04	32.69	-10.65	6405.96	1318.92
71+00	11.20	18.00	21.67	34.44	-12.77	6427.22	1342.96
71+50	12.30	8.10	29.07	18.24	10.83	6456.30	1381.20
72+22	19.20	11.30	35.10	19.20	15.90	6491.48	1380.46
72+44.77	16.80	9.50	37.13	17.78	19.35	6520.81	1398.24
72+50	21.30	9.70	38.38	18.24	20.14	6557.59	1416.48
72+59.62	20.80	10.00	34.07	26.20	7.87	6591.67	1442.65
73+00	16.00	18.30	31.76	14.81	16.95	6614.35	1489.26
73+50	17.40	16.00	31.93	31.76	-0.83	6632.89	1474.44
74+00	49.30	0.00	61.76	14.81	46.95	6684.35	1489.26
74+33.54	14.20	15.10	58.90	13.89	45.01	6733.15	1503.13
74+50	13.50	14.90	36.85	27.59	9.26	6778.80	1530.74

DRIVEWAY COREOUT VOLUMES

LT/RT	STATION	SURFACE MATERIAL	VOLUMES CUBIC YARDS CUT	CUMULATIVE VOLUMES CUBIC YARDS CUT
LT	53+20.18	BIT.	10.03	10.03
LT	54+85.29	STN.	10.82	20.85
LT	55+66.72	STN.	9.85	30.70
RT	56+41.94	STN.	7.53	38.23
LT	56+59.52	STN.	7.07	45.30
LT	56+87.40	STN.	9.74	54.84
LT	57+74.30	BIT.	7.53	62.37
RT	57+84.61	BIT.	6.57	68.94
RT	57+94.90	STN.	6.57	75.51
LT	60+34.62	CONC.	20.35	95.86
RT	60+44.62	BIT.	8.00	103.86
RT	61+26.60	CONC.	23.02	126.88
LT	64+01.41	BIT.	17.59	144.83
LT	64+68.72	BIT.	10.17	155.00
RT	64+74.33	BIT.	17.59	172.59
LT	64+89.10	CONC.	6.79	179.38
RT	65+96.52	CONC.	6.82	186.20
RT	67+42.56	CONC.	6.70	192.90
RT	67+51.15	CONC.	8.46	201.36
LT	68+51.39	BIT.	9.95	211.31
LT	71+51.18	BIT.	6.82	218.13
RT	71+85.86	CONC.	8.00	226.13
RT	72+22	CONC.	7.07	233.20
RT	72+59.62	CONC.	7.07	240.27
RT	75+19.95	CONC.	6.82	247.09
LT	75+69.69	STN.	6.58	253.67
LT	75+80.48	STN.	7.00	260.67
RT	75+80.56	CONC.	6.70	267.37
RT	76+54.55	BIT.	6.80	274.17
LT	76+55.30	CONC.	3.02	277.19
RACE ST.				
LT	80+84	BIT.	5.83	283.02
LT	91+14	BIT.	4.54	287.56

SIDE STREET VOLUMES

STREET	SURFACE MATERIAL	VOLUMES CUBIC YARDS CUT	CUMULATIVE VOLUMES CUBIC YARDS CUT
RACE	BIT.	175.17	175.17
WEST	BIT.	131.88	307.05
GROVE	BIT.	235.12	542.17
COTTAGE	BIT.	144.41	686.58
CENTER	BIT.	137.84	824.42
PRAIRIE	BIT.	131.28	955.70

MISCELLANEOUS VOLUMES

GENERAL LOCATION	VOLUMES CUBIC YARDS	VOLUMES CUBIC YARDS
BEGIN	CUT	FILL
GROVE COTTAGE	111.11	0
COTTAGE CENTER	25.92	111.11
CENTER PRAIRIE	52.04	111.11
PRAIRIE END	45.37	123.33

HORIZONTAL SCALE: 1" = 10'
VERTICAL SCALE: 1" = 5'



REVISED PC 10/19/04
REVISED PC 10/17/04
REVISED 08/08/04

CES INC. CIVIL ENGINEERING SERVICES
700 WEST LOCUST ST., BELVIDERE, IL 61008
(815)-547-8435 FAX: (815)-544-0421

UNION STREET

DRAWN BY: A.J.R. DATE: 12/05/03
CHECKED BY: K.C.B. DATE: 12/05/03

SHEET 18

FILE: SHEET18.DWG