

**CONTRACT NO. 86603**

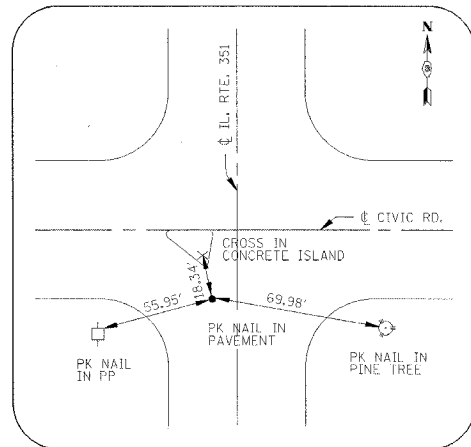

**CONTROL POINT #500**  
 PK NAIL IN PAVEMENT  
 STA. 45+45.71, 16.89' LT.  
 N. 48,305.71 E. 65,717.57

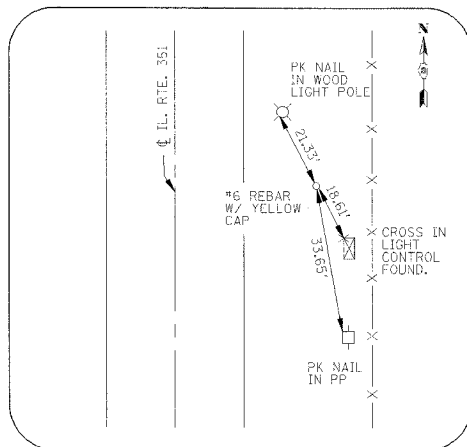

**CONTROL POINT #501**  
 #6 REBAR WITH YELLOW CAP  
 STA. 52+66.80, 72.77' RT.  
 N. 49,031.23 E. 65,757.87

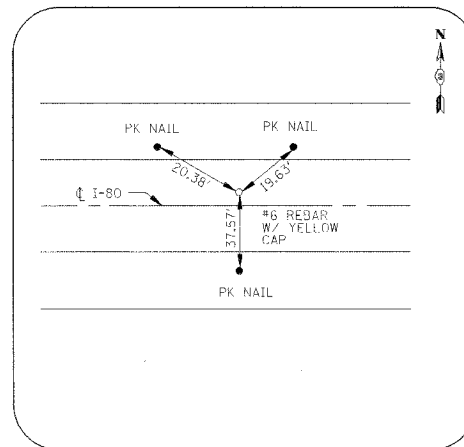

**CONTROL POINT #505**  
 #6 REBAR WITH YELLOW CAP  
 STA. 642+43.22, 13.47' LT.  
 N. 49,673.49 E. 64,285.93

CONTROL POINT COORDINATES		
POINT	NORTHING	EASTING
500	48305.71	65717.57
501	49031.23	65757.87
505	49673.49	64285.93

RAMP E COORDINATES		
POINT	NORTHING	EASTING
P.O.T.	50049.78	67478.83
P.C.1	50093.58	66681.78
P.I.1	50105.12	66471.86
P.T.1	50223.54	66298.14
P.C.2	50406.71	66031.21
P.I.2	50463.24	65948.28
P.T.2	50475.09	65848.63

RAMP F COORDINATES		
POINT	NORTHING	EASTING
P.C.1	50439.26	65844.36
P.I.1	50373.02	66401.45
P.T.1	50104.68	65908.78
P.C.2	50104.68	65908.78
P.I.2	50068.70	65842.72
P.T.2	50066.81	65767.51
P.C.3	50066.81	65767.51
P.I.3	50057.27	65534.47
P.T.3	50019.11	65304.38
P.C.4	50019.11	65304.38
P.I.4	49909.16	64551.56
P.T.4	49523.02	63896.03
P.C.5	49523.02	63896.03
P.I.5	49365.72	63639.63
P.T.5	49170.72	63410.61

RAMP G COORDINATES		
POINT	NORTHING	EASTING
P.O.T.	48920.04	65721.15
P.C.1	49377.37	65705.04
P.I.1	49631.50	65696.10
P.T.1	49780.12	65902.43
P.C.2	49780.12	65902.43
P.I.2	49920.44	66097.24
P.T.2	49925.35	66337.27
P.O.T.	49951.87	67632.57

ROUTE 351 COORDINATES		
POINT	NORTHING	EASTING
P.O.T.	47346.68	65800.23
P.I.	48344.28	65730.89
P.I.	48560.61	65717.81
P.C.1	49353.22	65663.28
P.I.1	49501.57	65653.08
P.T.1	49646.71	65620.70
P.C.2	49921.46	65559.41
P.I.2	50040.03	65532.96
P.T.2	50160.73	65546.78
P.C.3	50160.73	65546.78
P.I.3	50341.24	65567.45
P.T.3	50432.14	65724.76
P.C.4	50432.14	65724.76
P.I.4	50464.91	65781.46
P.T.4	50457.18	65846.49

I-80 COORDINATES		
POINT	NORTHING	EASTING
P.O.T.	48358.04	62673.92
P.C.	48782.13	63068.49
P.I.	49999.24	64200.84
P.T.	50000.02	65863.24
P.O.T.	50001.03	67999.90

RAMP H COORDINATES		
POINT	NORTHING	EASTING
P.C.1	49519.58	64113.57
P.I.1	49648.34	64410.00
P.T.1	49735.79	64721.13
P.C.2	49774.01	64858.88
P.I.2	49832.02	65065.27
P.T.2	49775.16	65271.98
P.C.3	49775.16	65271.98
P.I.3	49688.82	65585.84
P.T.3	49365.00	65619.05
P.O.T.	48909.77	65665.72

REVISIONS NAME	

ILLINOIS DEPARTMENT OF TRANSPORTATION  
**COORDINATE TABLES AND TIES**  
 F.A.I. 80 AT ILLINOIS ROUTE 351  
 SCALE: NONE  
 DATE: 09/04  
 DRAWN BY: JDK  
 CHECKED BY: MTD