

RTE.	SECTION	COUNTY	TOTAL SHEETS	SHEET NO.
FAI 80	(50-2)HBR	LA SALLE	460	36
STA. 653+75		TO STA. 663+50		
FED. ROAD DIST. NO.		ILLINOIS	FED. AID PROJECT	

CONTRACT NO. 86603

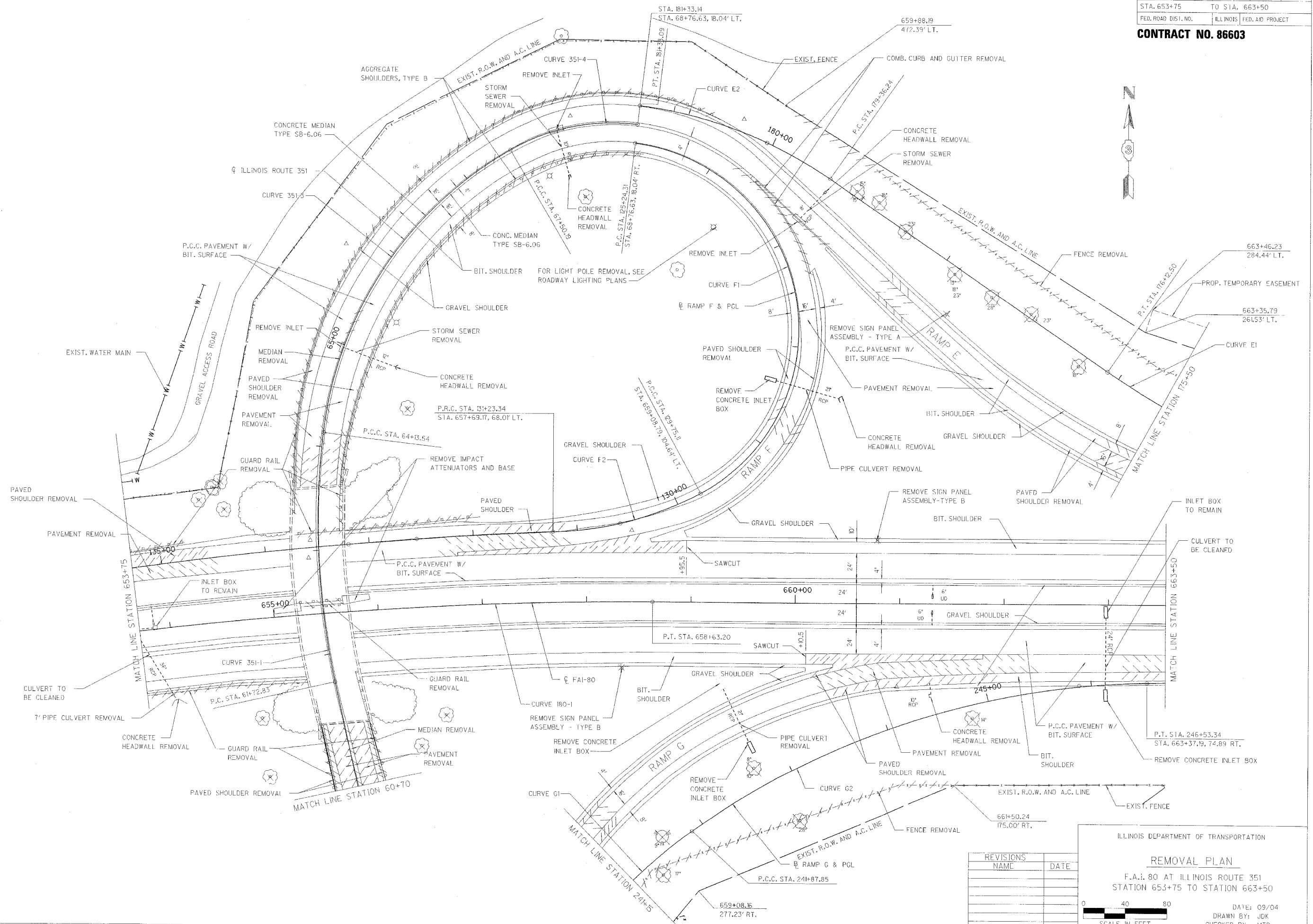

REVISIONS	NAME	DATE

ILLINOIS DEPARTMENT OF TRANSPORTATION

REMOVAL PLAN

F.A.I. 80 AT ILLINOIS ROUTE 351
STATION 653+75 TO STATION 663+50

DATE: 09/04
DRAWN BY: JJK
CHECKED BY: MTD

SCALE IN FEET

0 40 80