

RTE.	SECTION	COUNTY	TOTAL SHEETS	SHEET NO.
FAI 80	(50-2)HBR	LA SALLE	460	43
STA. 46+75		TO STA. 60+70		
FED. ROAD DIST. NO.		ILLINOIS	FED. AID PROJECT	

CONTRACT NO. 86603

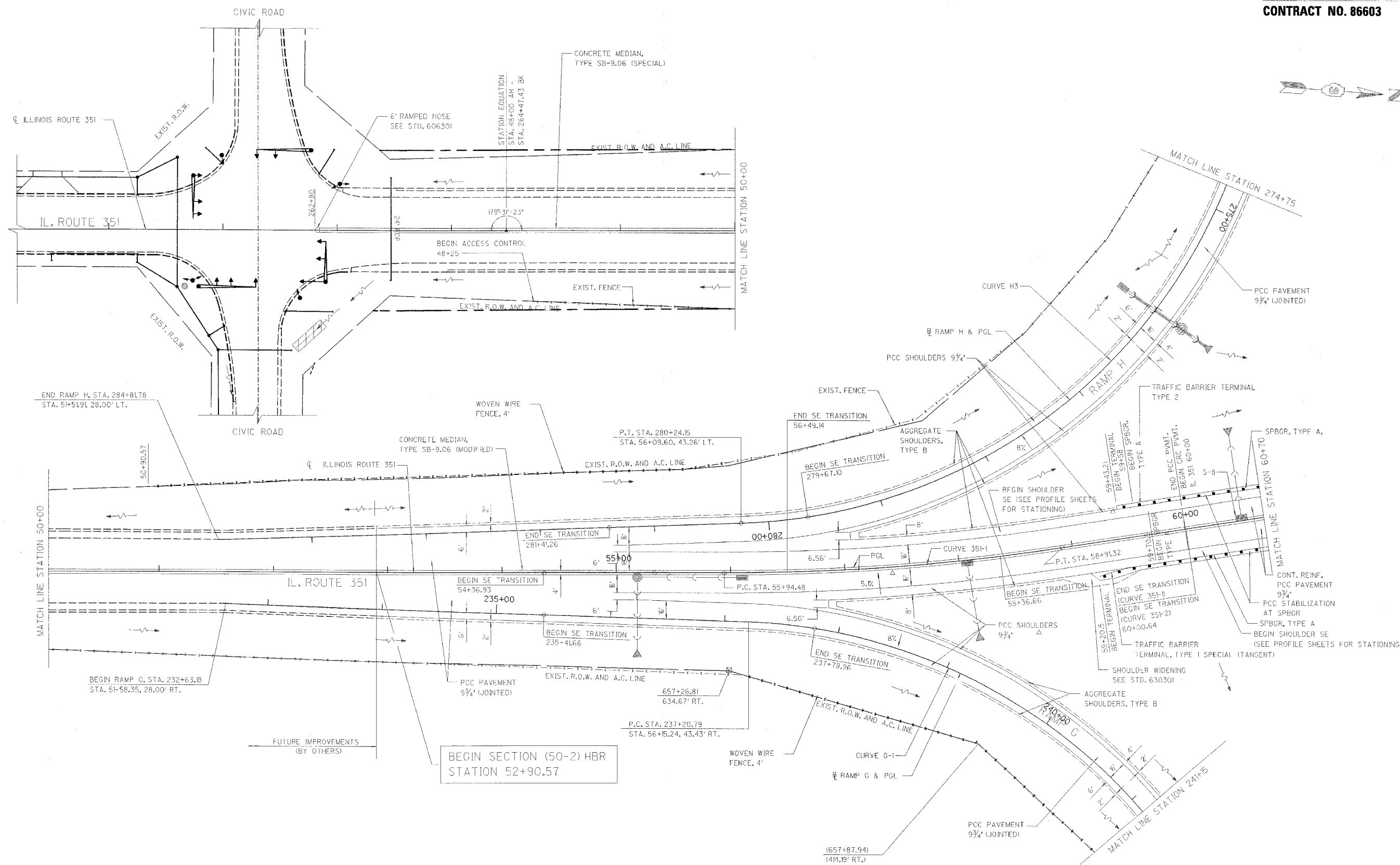

BEGIN SECTION (50-2) HBR  
STATION 52+90.57

REVISIONS	NAME	DATE

ILLINOIS DEPARTMENT OF TRANSPORTATION

**ROADWAY PLAN**

F.A.I. 80 AT ILLINOIS ROUTE 351  
STATION 46+75 TO STATION 60+70

DATE: 09/04  
DRAWN BY: JDK  
CHECKED BY: MTD

SCALE IN FEET