

RTE.	SECTION	COUNTY	TOTAL SHEETS	SHEET NO.
FAI 80	(50-2)HBR	LA SALLE	460	61
STA. 643+00	TO STA. 653+75			
FED. ROAD DIST. NO.	ILLINOIS	FED. AID PROJECT		

CONTRACT NO. 86603

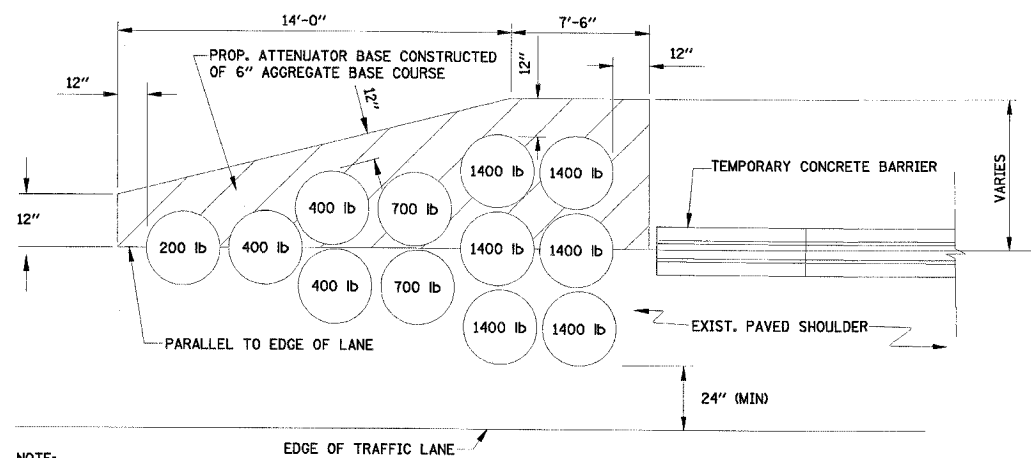

NOTE:
CONSTRUCTION AND REMOVAL OF ATTENUATOR
BASE SHALL BE INCLUDED IN THE COST OF
THE IMPACT ATTENUATOR INSTALLATION.

DETAIL B
IMPACT ATTENUATORS, TEMPORARY OR RELOCATED
(NON-REDIRECTIVE), TEST LEVEL 3

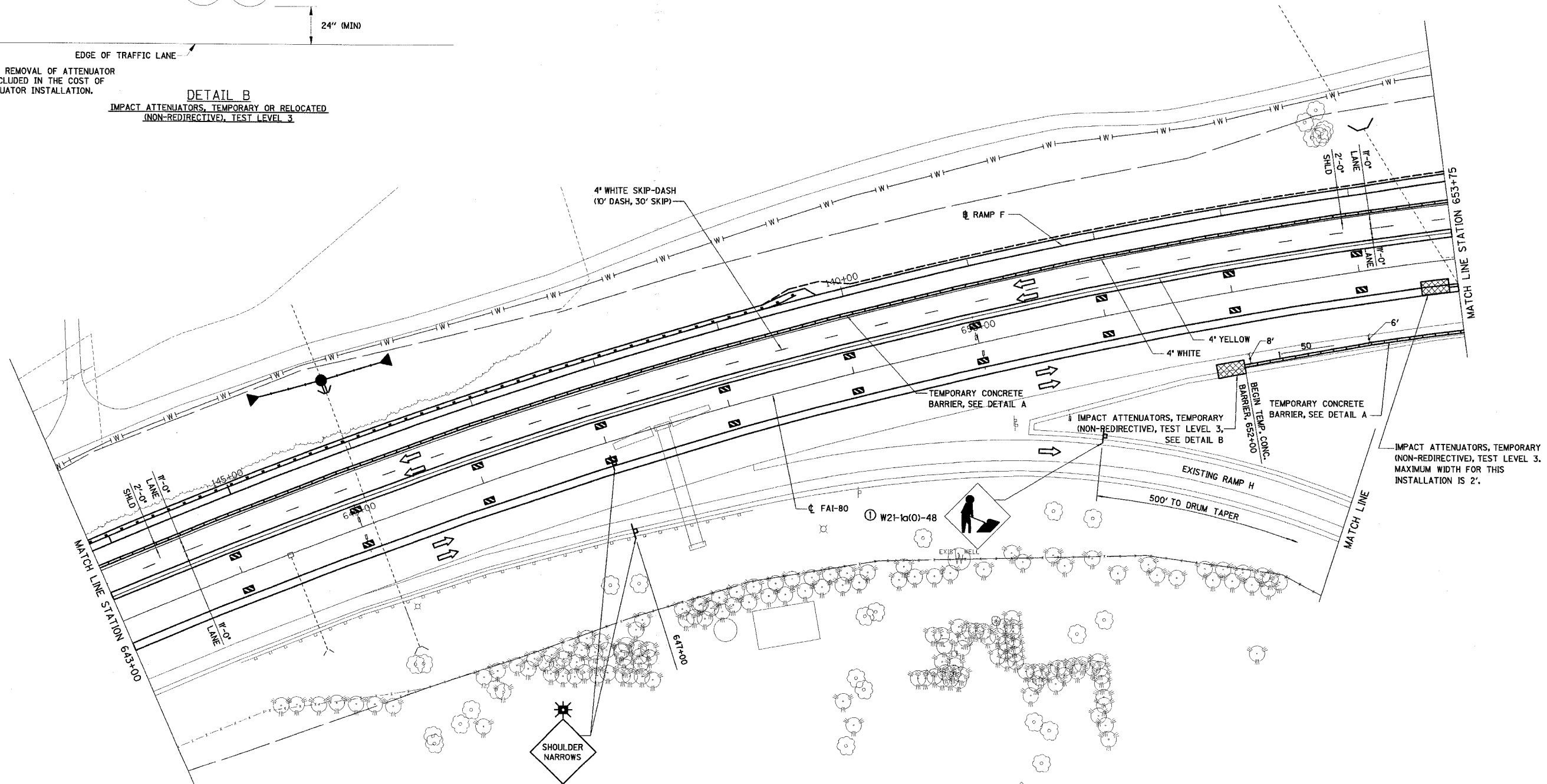

IMPACT ATTENUATORS, TEMPORARY
(NON-REDIRECTIVE), TEST LEVEL 3.
MAXIMUM WIDTH FOR THIS
INSTALLATION IS 2'.

① ONLY WHEN WORKERS ARE PRESENT.
DO NOT POST MOUNT.

REVISIONS	NAME	DATE

ILLINOIS DEPARTMENT OF TRANSPORTATION
STAGE II CONSTRUCTION PLAN
F.A.I. 80 AT ILLINOIS ROUTE 351
STATION 643+00 TO STATION 653+75

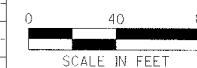

DATE: 09/04
DRAWN BY: MES
CHECKED BY: MTD

W - -48