

RTE.	SECTION	COUNTY	TOTAL SHEETS	SHEET NO.
FAI 80	(50-2)HBR	LA SALLE	440	63
STA. 663+50		TO STA. 676+50		
FED. ROAD DIST. NO.	ILLINOIS	FED. AID PROJECT		

CONTRACT NO. 86603

WORK ZONE
SPEED LIMIT 55
BEGINS
 XXXX FINE MINIMUM

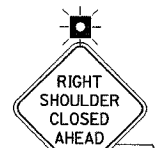

W2-1115(O)-3618
 R2-1-3648
 W2-1113(O)-3612
 R2-1106-3618

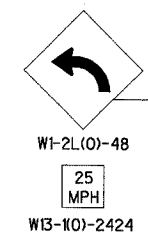
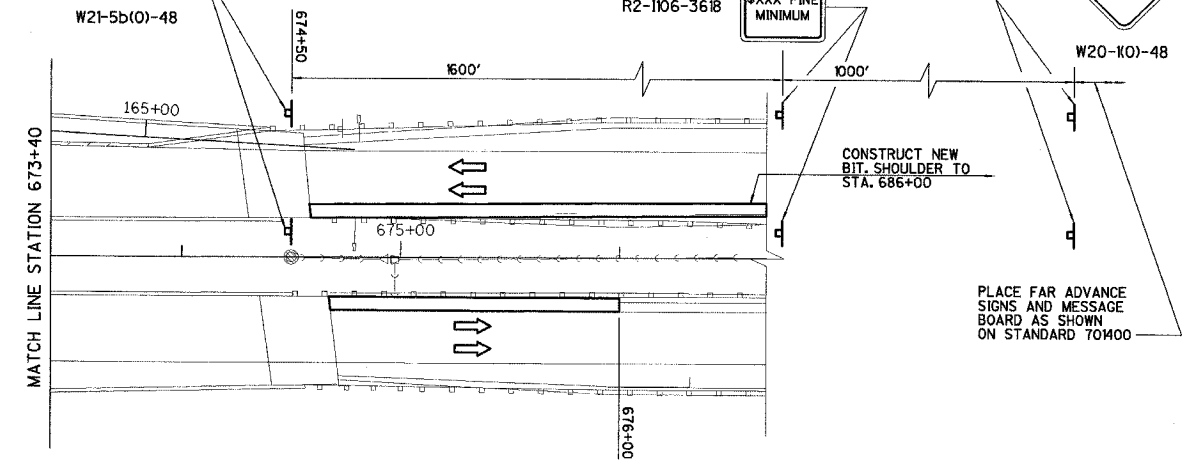

W1-2L(O)-48
 25 MPH
 W13-101-2424

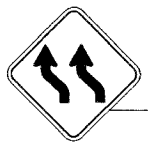
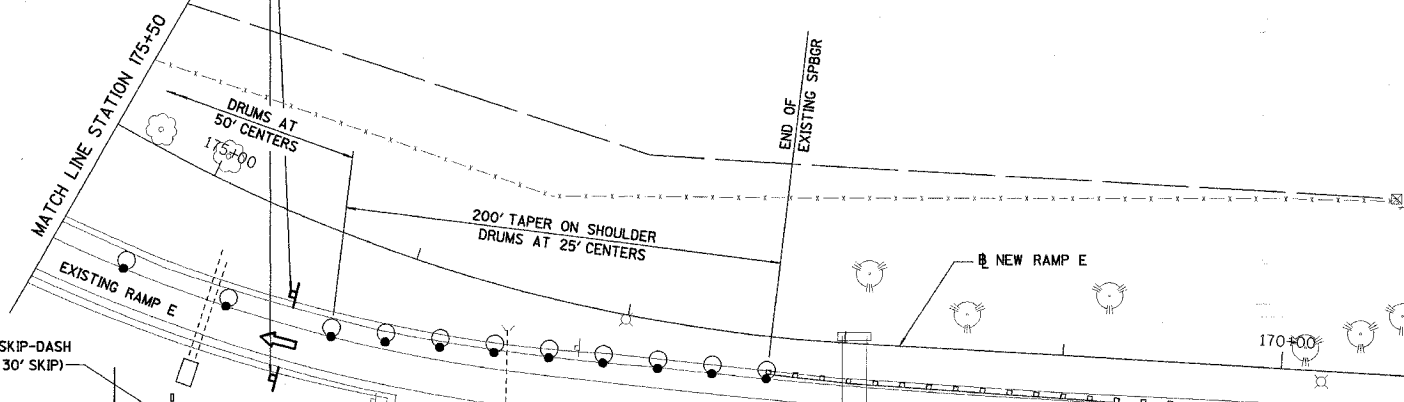

W1-4L (O)-48

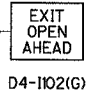

D4-1102(G)

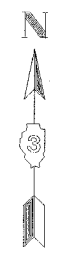
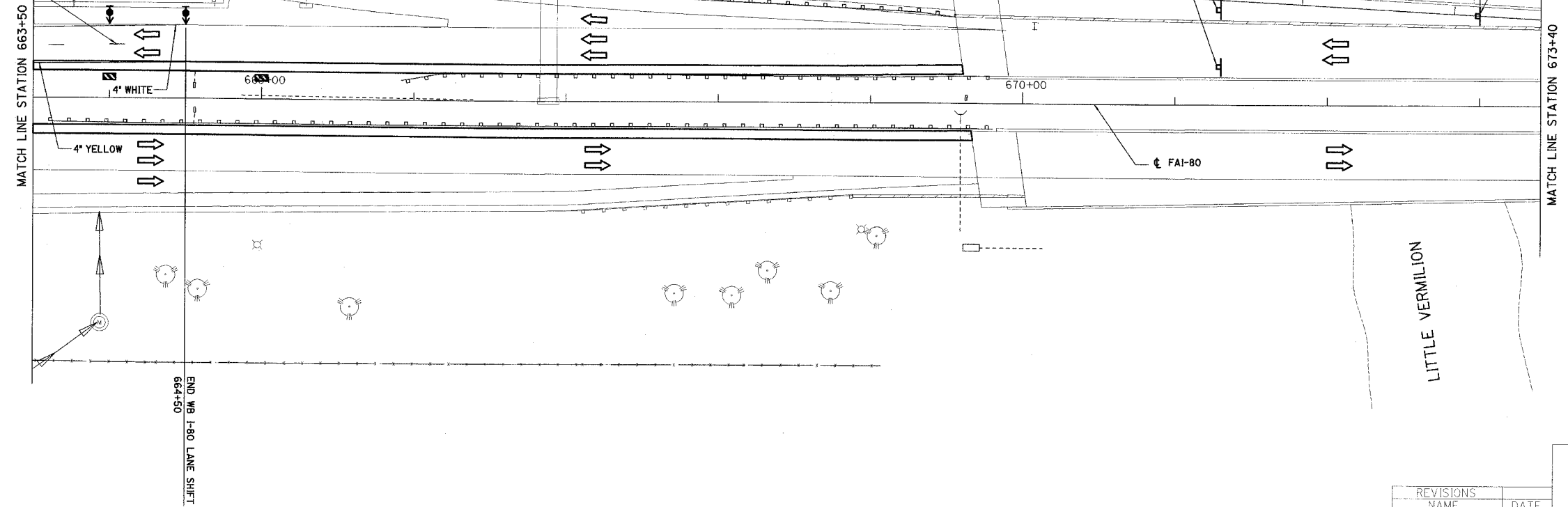

REVISIONS	NAME	DATE

ILLINOIS DEPARTMENT OF TRANSPORTATION

STAGE II CONSTRUCTION PLAN

F.A.I. 80 AT ILLINOIS ROUTE 351
 STATION 663+50 TO STATION 676+50

DATE: 09/04
 DRAWN BY: MES
 CHECKED BY: MTD

0 40 80
 SCALE IN FEET