

RTE.	SECTION	COUNTY	TOTAL SHEETS	SHEET NO.
FAI 80	(50-2)HBR	LA SALLE	460	64
STA. 52+95		TO STA. 60+70		
FED. ROAD DIST. NO.		ILLINOIS FED. AID PROJECT		

**CONTRACT NO. 86603**

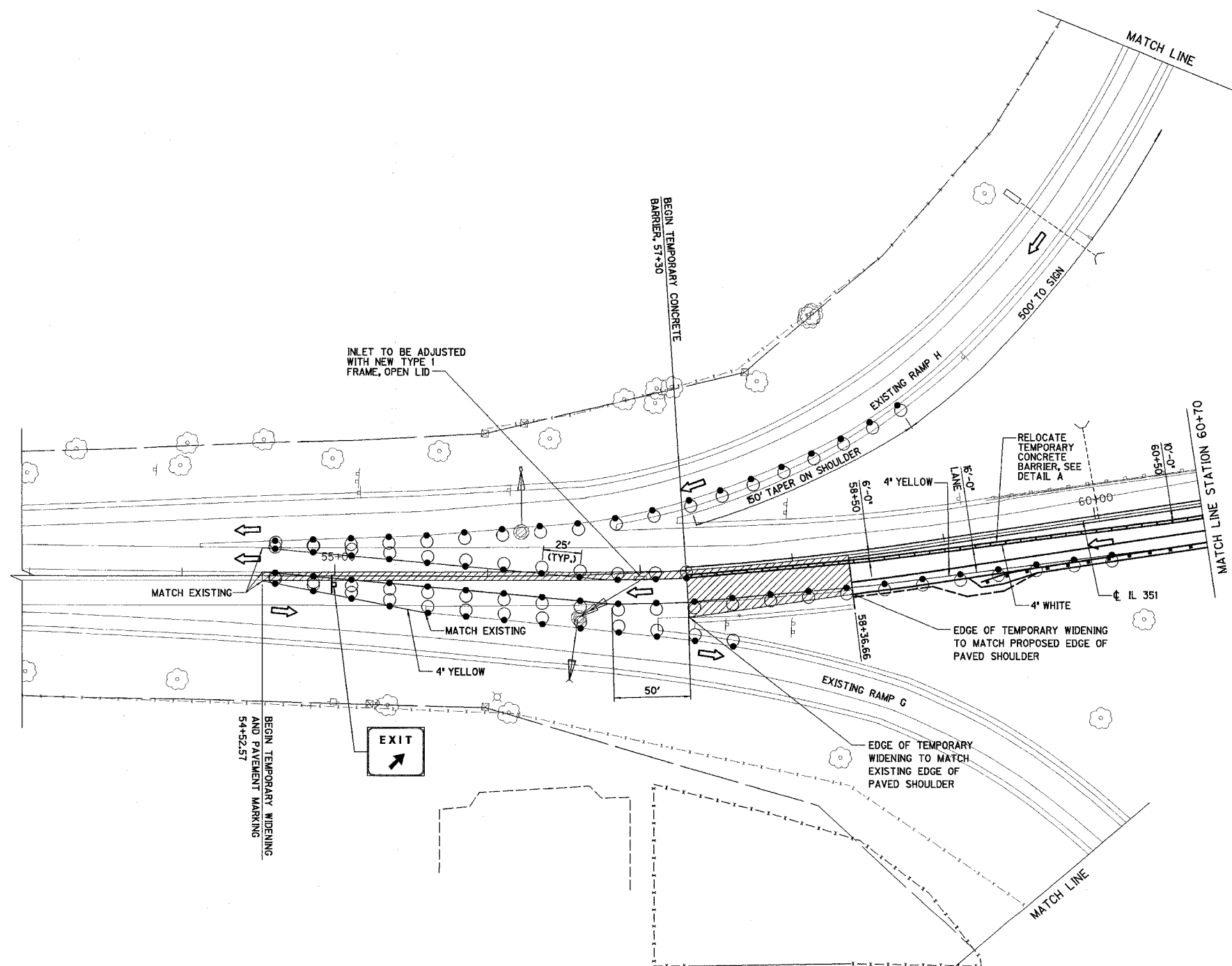

REVISIONS	NAME	DATE

ILLINOIS DEPARTMENT OF TRANSPORTATION

**STAGE II CONSTRUCTION PLAN**

F.A.I. 80 AT ILLINOIS ROUTE 351  
STATION 52+95 TO STATION 60+70

0 40 80  
SCALE IN FEET

DATE: 09/04  
DRAWN BY: MES  
CHECKED BY: MTD