

RTE.	SECTION	COUNTY	TOTAL SHEETS	SHEET NO.
FAI 80	(50-2)HR	LA SALLE	460	65
STA. 653+75		TO STA. 663+50		
FED. ROAD DIST. NO.		ILLINOIS	FED. AID PROJECT	

CONTRACT NO. 86603

**STAGE III NOTES**

- REFLECTORIZED TEMPORARY PAVEMENT MARKING TAPE SHALL BE PLACED THROUGHOUT TAPERS AND ALONG-SIDE THE WORK AREAS. THE EDGE LINE SHALL BE WHITE OR YELLOW AS SHOWN.
- MOUNT VERTICAL PANELS ON TOP OF TEMPORARY CONCRETE BARRIER AT 25' CENTERS WITH STEADY BURNING MONODIRECTIONAL LIGHTS ON TAPERS.
- TRAFFIC CONTROL SHALL BE ERECTED AS SHOWN AND ACCORDING TO TRAFFIC CONTROL AND PROTECTION STANDARDS T0402 AND T0411.
- SEE SPECIAL PROVISIONS FOR ADDITIONAL TRAFFIC CONTROL REQUIREMENTS.

**LEGEND**

- ▲ ARROW BOARD
- ➔ DIRECTION OF TRAFFIC
- ⊠ SIGN
- ⬆ DIRECTION INDICATOR BARRICADE WITH STEADY BURN MONODIRECTIONAL LIGHT
- ⊙ DRUM OR BARRICADE WITH STEADY BURN MONODIRECTIONAL LIGHT
- ▬ TEMPORARY CONCRETE BARRIER
- △ TYPE C MONODIRECTIONAL REFLECTOR
- ⚡ FLASHING LIGHT
- ▬ FLEXIBLE DELINEATOR
- ▨ TEMPORARY WIDENING
- ⊠ TYPE III BARRICADE
- ▩ IMPACT ATTENUATORS
- ▭ VERTICAL PANEL

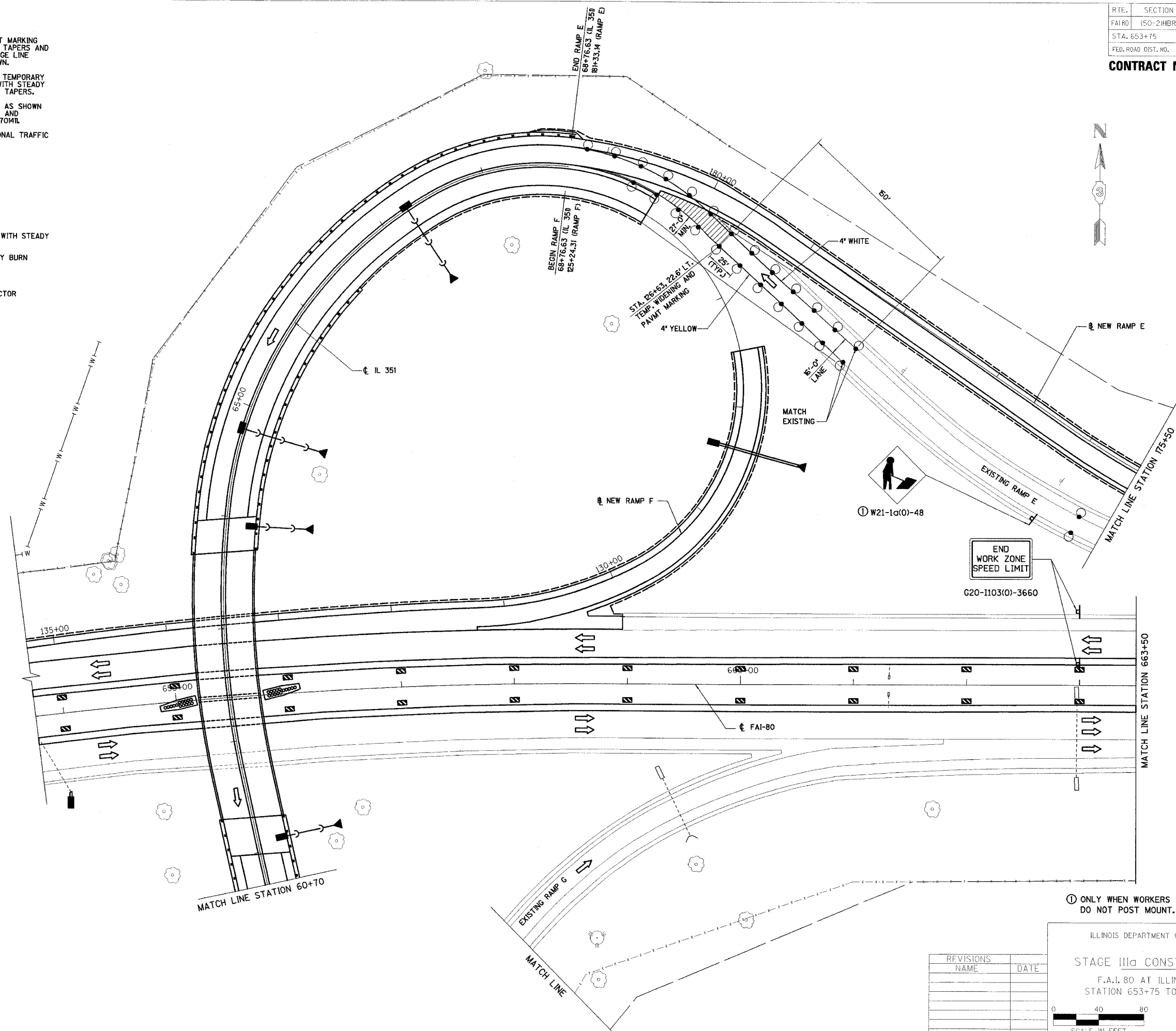

① W21-1a(0)-48

END WORK ZONE SPEED LIMIT  
G20-1103(0)-3660

① ONLY WHEN WORKERS ARE PRESENT. DO NOT POST MOUNT.

REVISIONS	NAME	DATE

ILLINOIS DEPARTMENT OF TRANSPORTATION  
**STAGE IIIa CONSTRUCTION PLAN**  
 F.A.I. 80 AT ILLINOIS ROUTE 351  
 STATION 653+75 TO STATION 663+50  
 DATE: 09/04  
 DRAWN BY: MES  
 CHECKED BY: MTD

