

RTE.	SECTION	COUNTY	TOTAL SHEETS	SHEET NO.
FAI 80	(50-2)HBR	LA SALLE	460	86
STA. 643+00		TO STA. 653+75		
FED. ROAD DIST. NO.	ILLINOIS	FED. AID PROJECT		

**CONTRACT NO. 86603**

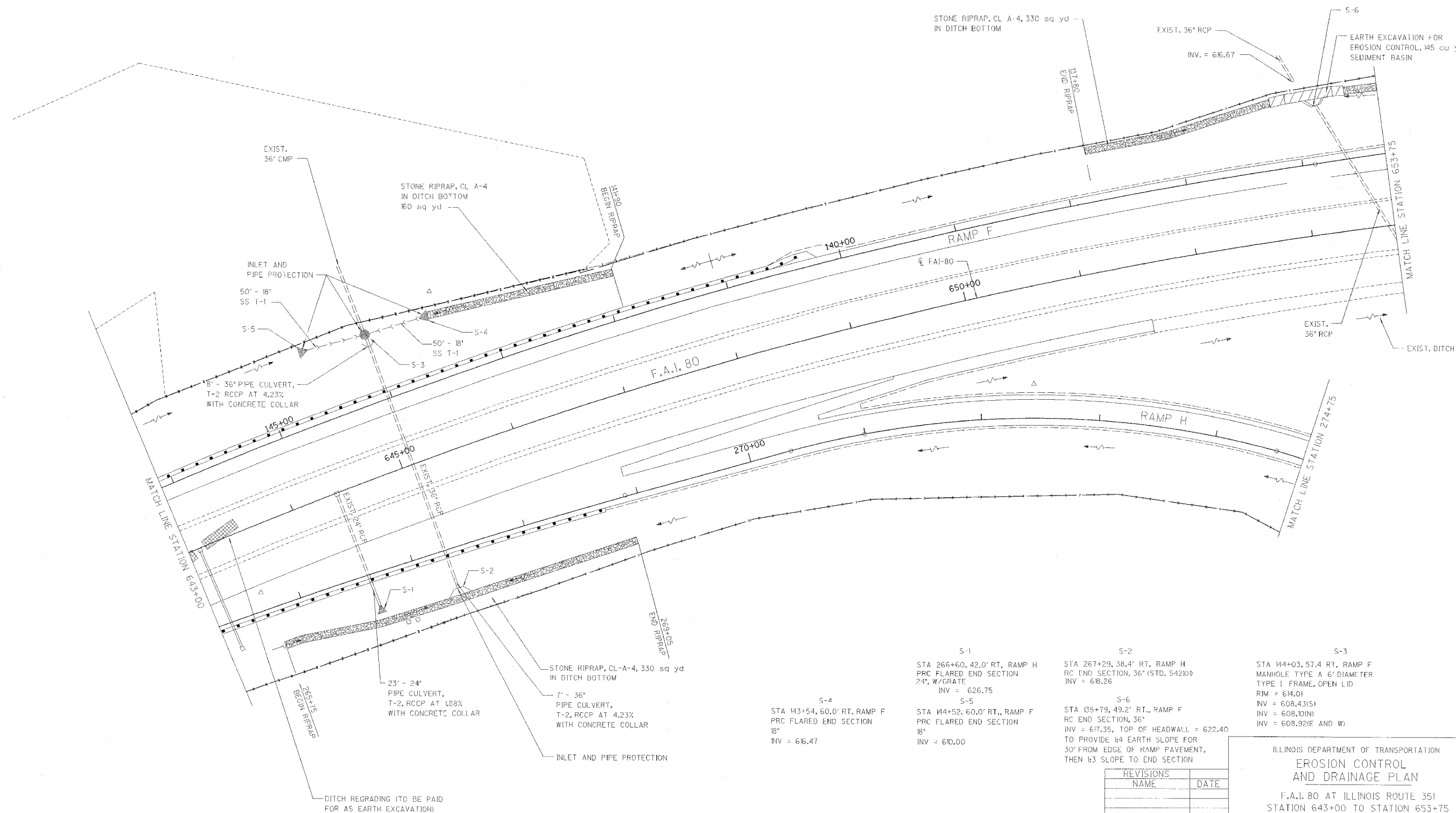

- S-1  
STA 266+60, 42.0' RT., RAMP H  
PRC FLARED END SECTION  
24" W/GRATE  
INV = 626.75
- S-2  
STA 267+29, 38.4' RT., RAMP H  
RC END SECTION, 36" (STD. 54200)  
INV = 618.26
- S-3  
STA 144+03, 57.4 RT., RAMP F  
MANHOLE TYPE A 6' DIAMETER  
TYPE I FRAME, OPEN LID  
RIM = 614.01  
INV = 608.43(S)  
INV = 608.10(N)  
INV = 608.32(E AND W)
- S-4  
STA 143+54, 60.0' RT., RAMP F  
PRC FLARED END SECTION  
18"  
INV = 616.47
- S-5  
STA 144+52, 60.0' RT., RAMP F  
PRC FLARED END SECTION  
18"  
INV = 610.00
- S-6  
STA 135+19, 49.2' RT., RAMP F  
RC END SECTION, 36"  
INV = 617.35, TOP OF HEADWALL = 622.40  
TO PROVIDE 1:4 EARTH SLOPE FOR  
30' FROM EDGE OF RAMP PAVEMENT,  
THEN 1:3 SLOPE TO END SECTION

REVISIONS	
NAME	DATE

ILLINOIS DEPARTMENT OF TRANSPORTATION  
**EROSION CONTROL  
AND DRAINAGE PLAN**  
F.A.I. 80 AT ILLINOIS ROUTE 351  
STATION 643+00 TO STATION 653+75

DATE: 09/04  
DRAWN BY: JDK  
CHECKED BY: MID

