

RTE.	SECTION	COUNTY	TOTAL SHEETS	SHEET NO.
FA180	(50-2)HBR	LA SALLE	460	111
STA.		TO STA.		
FED. ROAD DIST. NO.		ILLINOIS FED. AID PROJECT		

CONTRACT NO. 86603

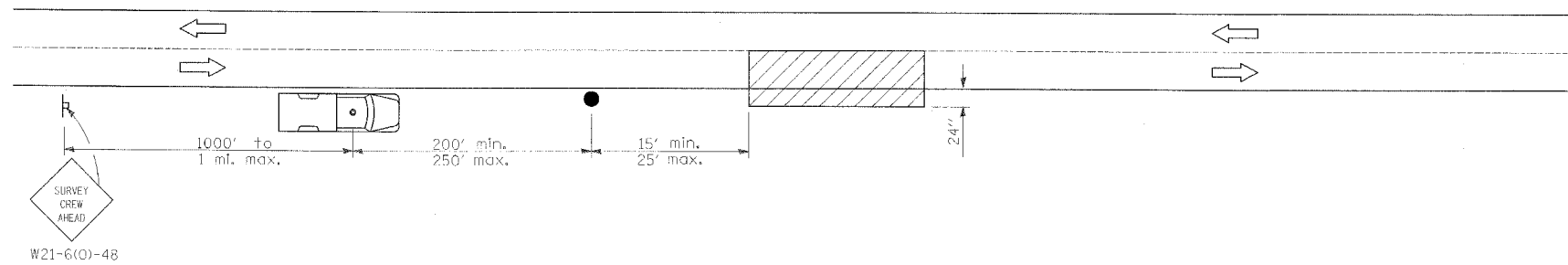

SYMBOLS

 Work area

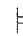
 Sign on portable or permanent support

 Truck with flashing amber light and dual emergency flashers

 Flagger with traffic control sign

TYPICAL APPLICATIONS

Utility operations

REVISIONS	NAME

ILLINOIS DEPARTMENT OF TRANSPORTATION

DETAIL FOR NIGHTTIME LIGHTING INSPECTION

F.A.I. 80 AT ILLINOIS ROUTE 351

SCALE: NONE
DATE: 09/04

DRAWN BY: JDK
CHECKED BY: MTD