

RTE.	SECTION	COUNTY	TOTAL SHEETS	SHEET NO.
FA180	(50-2)HBR	LA SALLE	460	125
STA.		TO STA.		
FED. ROAD DIST. NO.		ILLINOIS	FED. AID PROJECT	

**CONTRACT NO. 86603**

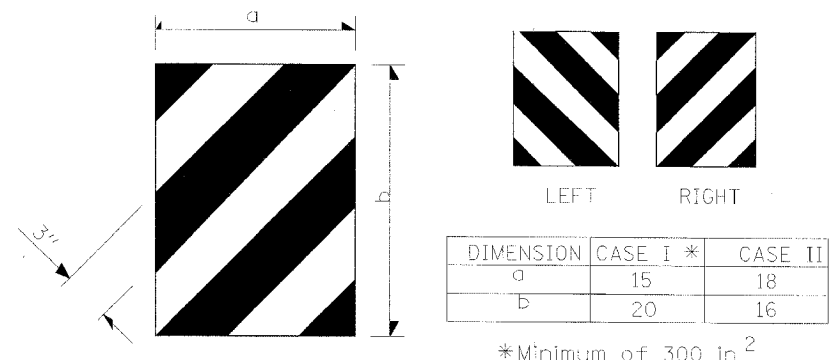

**TERMINAL MARKER DETAILS**  
Color: Black / Yellow reflectorized

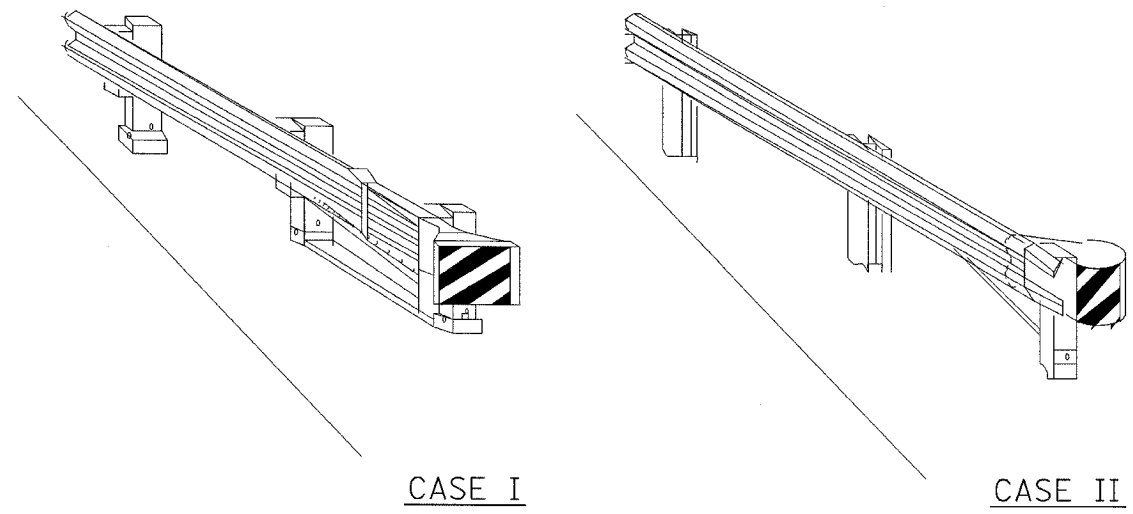
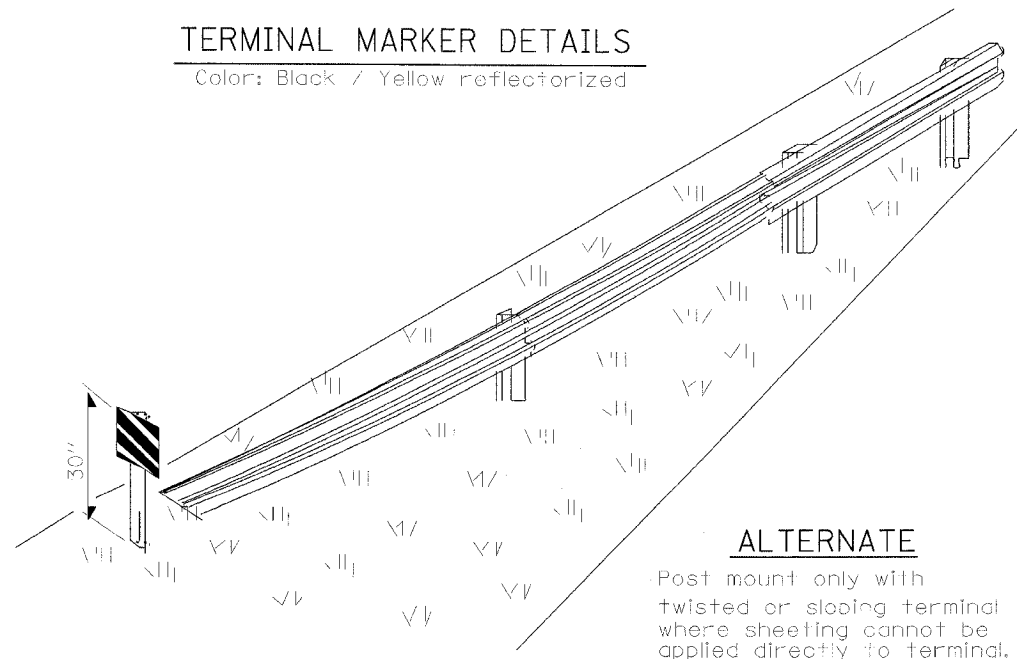

**ALTERNATE**  
Post mount only with twisted or sloping terminal where sheeting cannot be applied directly to terminal.

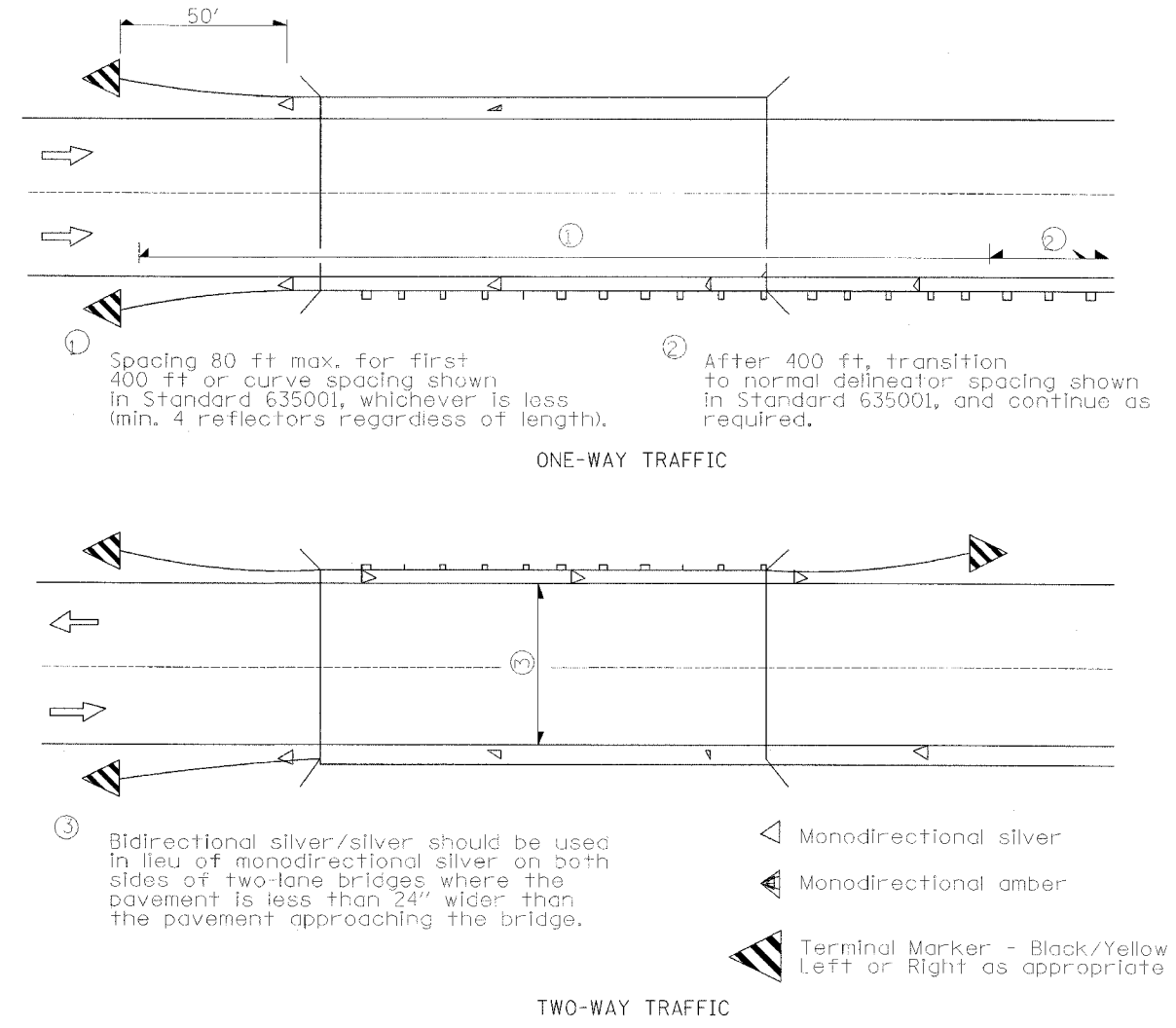

**GUARDRAIL / BARRIER WALL / BRIDGE RAIL REFLECTIORS**

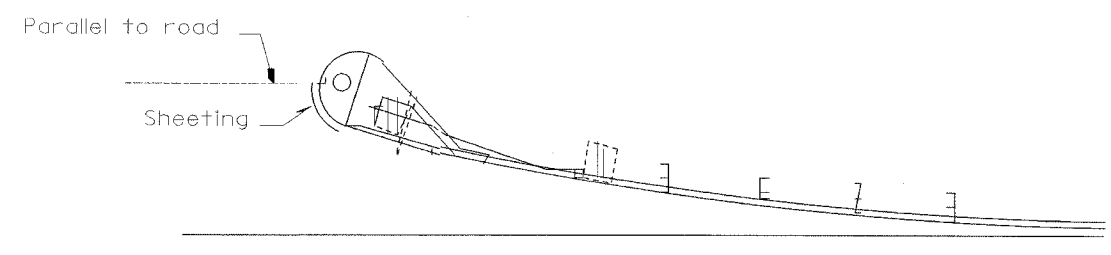

**SHEETING POSITION: CASE II**

REVISIONS	NAME

ILLINOIS DEPARTMENT OF TRANSPORTATION

**REFLECTOR AND TERMINAL MARKER PLACEMENT**

F.A.I. 80 AT ILLINOIS ROUTE 351

SCALE: NONE      DRAWN BY: JDK  
DATE: 09/04      CHECKED BY: MTD