

PLAN
WALKWAY AND HANDRAIL SKETCH
(Road plan beneath truss varies)

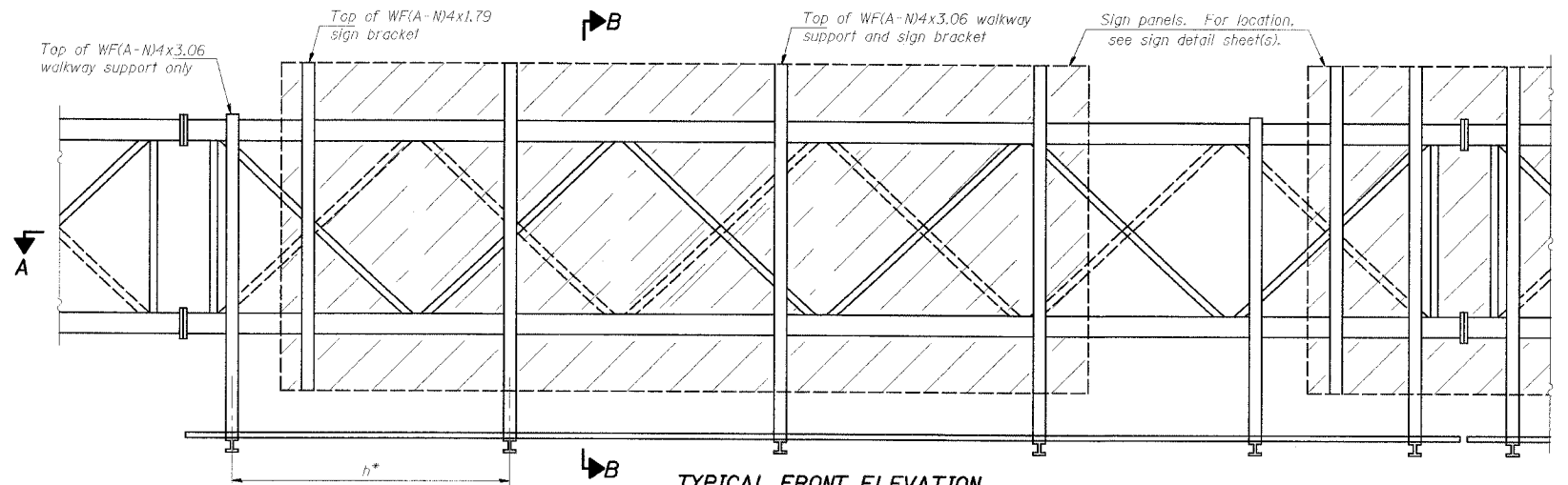

TYPICAL FRONT ELEVATION
With lights and handrail omitted for clarity.
For Section B-B, see Base Sheet OS-A-10.

BRACKET TABLE

Sign Width		Number Brackets Required
Greater Than	Less Than or Equal To	
	8'-0"	2
8'-0"	14'-0"	3
14'-0"	20'-0"	4
20'-0"	26'-0"	5
26'-0"	32'-0"	6

**Alternate angle for safety chain attachment

Standard Aluminum Grating, see Details T and W

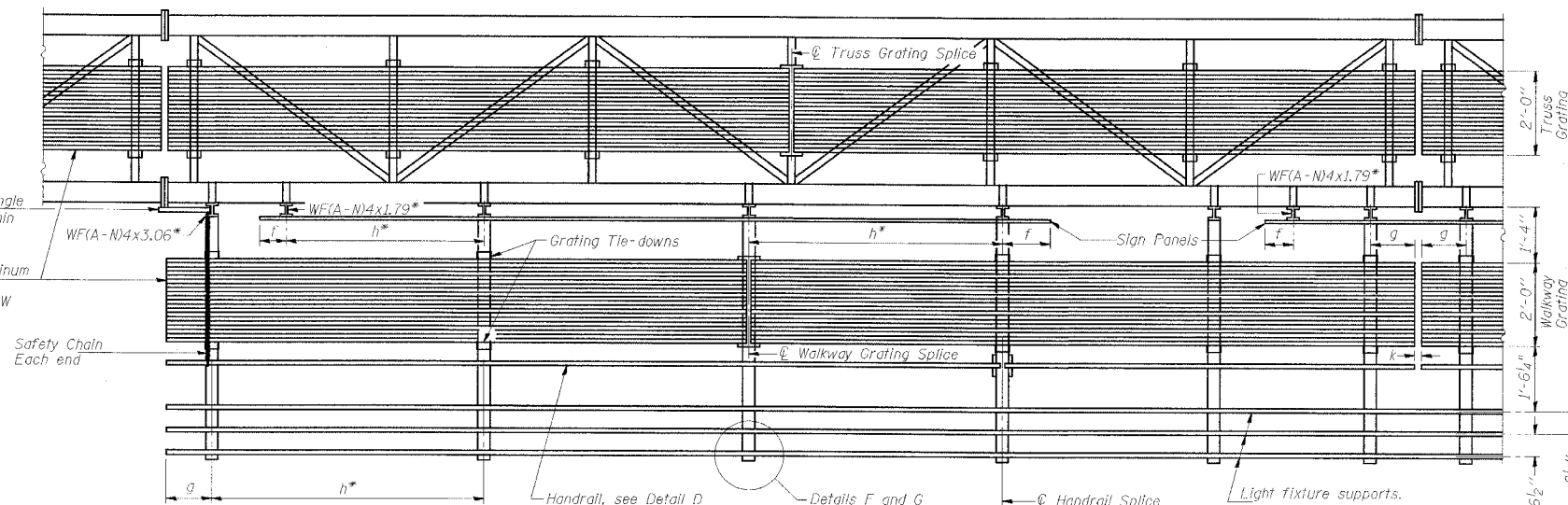

SECTION A-A

Handrail and walkway shall span a minimum of three brackets between splices and/or gap joints. Place all sign and walkway brackets as close to panel points as practical. Grating, handrail and light support splices placed as needed.

Truss grating to facilitate inspection shall run full length (center to center of support frames) ±12" on overhead trusses. Cost of truss grating is included in "Overhead Sign Structure".

Walkway and Truss Grating width dimensions are nominal and may vary ±1/2" based on available standard widths.

Notes: *Space walkway brackets WF(A-N)4x3.06 and sign brackets WF(A-N)4x1.79 for efficiency and within limits shown:

- f = 12" maximum, 4" minimum (End of sign to center of nearest bracket)
- g = 12" maximum, 4" minimum (End of walkway grating to center of nearest support bracket)
- h = 6'-0" maximum center to center sign and/or walkway support brackets, WF(A-N)4x1.79 or WF(A-N)4x3.06
- k = 2" maximum gap between adjacent walkway grating sections and handrail ends

**If walkway bracket at safety chain location is behind sign, add angle to bracket, see Alternate Safety Chain Attachment on Base Sheet OS-A-11.

For Details T and W, Section B-B and Grating Splice Details, see Base Sheet OS-A-10. For Details D, F, G and P and Handrail Splice Details, see Base Sheet OS-A-11.

Structure Number	Station	a	b	c	d	e	Walkway Grating and Handrail Lengths
350501080R076.4	643+14	19'-6"	52'-6"	25'-0"	-	-	52'-6"
350501080L077.0	674+70	16'-3"	35'-6"	24'-3"	-	-	35'-6"

NUMBER	REVISION	DATE

REVISIONS NAME

ILLINOIS DEPARTMENT OF TRANSPORTATION
OVERHEAD SIGN STRUCTURES
ALUMINUM WALKWAY DETAILS

350501080R076.4, STATION 643+14
350501080L077.0, STATION 674+70

SCALE: NONE DRAWN BY: DWH
DATE: 09/04 CHECKED BY: MTD/FMA